

# THRU-HOLE (THM) & SURFACE MOUNT (SMT) 20mm EZ-OUT HOLDERS

- Top loading for compact applications
- Finger pressure against lever will release battery
- No tools required
- Holds battery securely under shock and vibration applications
- Nylon base material UL Rated 94V-0, impervious to most industrial solvents
- Operating Temperature Range: -60°F to 293°F (-50°C to 146°C)

## THM EZ-OUT COIN CELL HOLDER

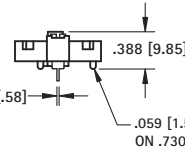
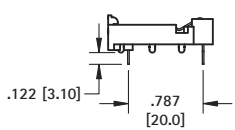
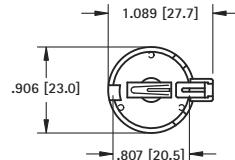

Mounting Detail

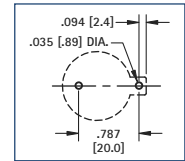

- Designed for manual insertion of battery.
- Mounts securely for wave soldering

**MATERIAL:**

Contacts: .016 (.40) Phosphor Bronze, Tin Plate  
Base: Nylon UL Rated 94V-0

CAT. NO.	BATTERY REFERENCE
1066	BR2025, CR2032

## SMT AUTO-IN/EZ-OUT COIN CELL HOLDER

AVAILABLE ON TAPE AND REEL

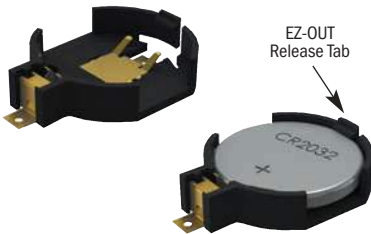

- Designed for automatic vertical insertion of battery via a vacuum or mechanical pick-and-place device
- Compatible with vacuum and mechanical pick & place assembly systems
- All conductive polystyrene carrier tape meets ANSI/EIA-481 standards

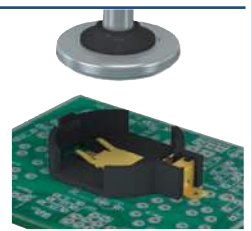
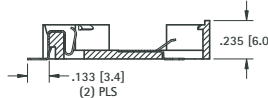
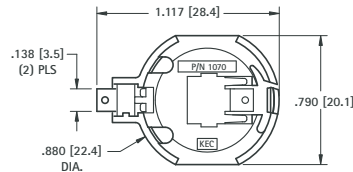

Pad Layout

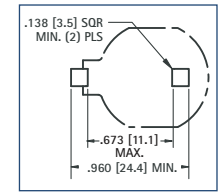

**MATERIAL:**

Contacts: .009 (.23) Phosphor Bronze, Gold Plate (Flash)  
Base: High temperature Nylon 4/6, UL Rated 94V-0

CAT. NO.	ON TAPE & REEL	BATTERY REFERENCE
1070	1070TR	CR2032

Tape & Reel Spec's: 44mm Wide, 24mm Pitch, 13 inch reel (400 pieces per reel)

# THRU-HOLE MOUNT (THM) VERTICAL COIN CELL HOLDERS

- Accepts all manufactures of 20mm coin cell batteries
- Retains cells securely, withstands shock and vibration
- Polarity clearly marked
- Mounts securely for wave soldering
- Operating Temperature Range: -60°F to 293°F (-50°C to 146°C)

## COMPACT

- Molded notch prevents improper insertion of 2032 size cells

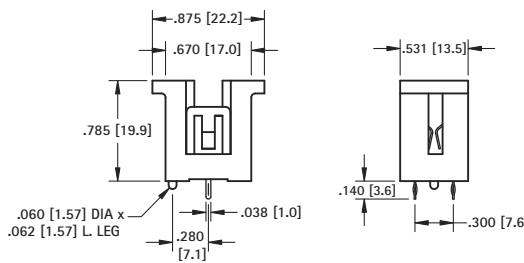
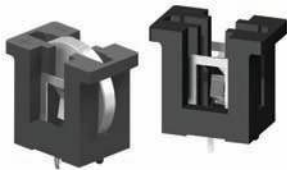

Mounting Detail

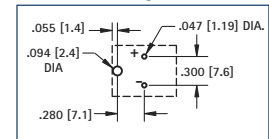

**MATERIAL:**

Contacts: .012 (.30) Spring Steel, Tin-Nickel Plate  
Base: PBT, UL Rated 94V-0

CAT. NO.	BATTERY REFERENCE
1067	CR2016, DL2020, CL2025, CR2032

## SLIMLINE

- Polarized holder, protects circuit from improper insertion of cells.

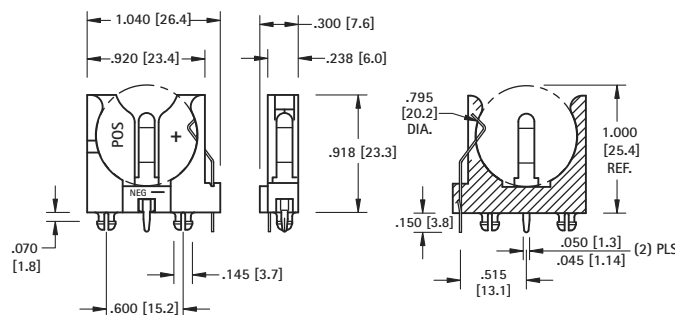

Mounting Detail

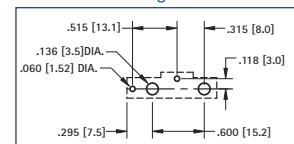

**MATERIAL:**

Contacts: .016 (.40) Spring Steel, Tin-Nickel Plate  
Base: PBT, UL Rated 94V-0

CAT. NO.	BATTERY REFERENCE
1065	BR2012, CR2016, DL2020, CL2025, CR2032