

ASSEMBLY PART LIST				
ITEM NO.	DESCRIPTION	QTY/ASSY	MATERIAL	COLOR
1	HOUSING	1	PBT G.F.	GRAY
2	GASKET	1	SILICONE	RED BROWN
3	SECONDARY LOCKING	1	PBT G.F.	BLACK
4	ALIGNMENT PLATE	1	PBT G.F.	GREEN
5	REAR SEAL COVER	1	PBT G.F.	GREEN
6	MAT SEAL	1	SILICONE	BLUE
7	COIL SPRING	4	STAINLESS STEEL	/

INSPECTION BALLOON NUMBERS LOG	
THE LAST BALLOON NUMBER USED	9
THE BALLOON NUMBER ADDED	
THE BALLOON NUMBER REMOVED	

NOTES: VALID UNLESS OTHERWISE SPECIFIED

1. GENERAL:

- 1.1 MATING CONNECTOR INFORMATION REFER TO MOLEX SD-64319-001
- 1.2 APPLICATION SPECIFICATION SEE: 5018203231-AS
- 1.3 PRODUCT SPECIFICATION SEE: 5018203231-PS
- 1.4 HEADER INTERFACE DRAWING REFER TO MOLEX DWG SD-98644-006
- 1.5 PACKAGING SPECIFICATION PER MOLEX DRAWING 5018209000-PK
- 1.6 DATA MUST BE SUBMITTED UNDER THE MOLEX PART NUMBER TO IMDS (COMPANY ID#13255)

2. DESIGN - MATERIALS: SEE ASSEMBLY PART LIST TABLE

3. DESIGN - GEOMETRY:

- 3.1 THE 3-D CAD DATA IS BASIC (WITHOUT TOLERANCE) AND MUST BE TAKEN FROM THE DATA FILE AT ITS LATEST REVISION.
- 3.2 THE 3-D CAD DATA IS MASTER FOR THIS PART AND IS TO BE USED TO ESTABLISH DIMENSIONAL INFORMATION NOT SHOWN ON THIS DRAWING. ANY DIMENSIONS UNDERLINED INDICATE A CONFLICT WITH THE MODEL.
- 3.3 PRODUCT DESIGN MODEL NUMBER(S): 501820323X CUSTOMER MODEL FROM MOLEX PLM SYSTEM.
- 3.4 GENERAL TOLERANCE SEE TITLE BLOCK.
- 3.5 LASER MARKING TEXT, FONT: ARIAL, SIZE 4mm

4. DESIGN - MANUFACTURING:

- 4.1 SHIPPED PARTS WITH GASKET ASSEMBLED.
- 4.2 ALIGNMENT PLATE IN PRE-LOCK POSITION DURING DELIVERY.

REVISION	ECTR #	DATE	DESCRIPTIONS
C	622486	2019/8/16	Page1: Notes: Remove 4.1 ANY PROCESS LUBRICANT REMAINING ON THE TERMINAL MUST NOT VARNISH OR DEGRADE ITS ELECTRICAL PERFORMANCE AS DEFINED IN THE PRODUCT SPEC. PROCESS LUBRICANTS SHALL BE APPROVED BY THE RESPONSIBLE ENGINEER. Page2: Notes: Revise the 5th notes for screw torque recommendation
B1	612043	2019/2/14	RELEASE FOR GENERAL MARKET NO MODIFICATION FOR CONTENT
B	603954	2018/9/10	Add header coding table on pg2. Revise laser marking content definition. Revise note for screw torque recommendation. Revise panel recommendation layout: 10.75±0.1 was 10.4±0.1 7.6±0.1 was 7.2±0.1 16.25±0.1(2x) was 16.1±0.1(2x) add radius R1.0 MAX (4x) see revision marker (B) for changes
A	600397	2018/6/11	INITIAL RELEASE

REVISION LOG

THIS DRAWING CONTAINS INFORMATION THAT IS PROPRIETARY TO MOLEX ELECTRONIC TECHNOLOGIES, LLC AND SHOULD NOT BE USED WITHOUT WRITTEN PERMISSION													
SYMBOLS		DIMENSION UNITS	SCALE	CURRENT REV DESC: INITIAL RELEASE			molex						
▽ = 0	0	mm	2:1	EC NO: 622486			SALES DARWING CMC 32P PANEL MOUNT HEADER						
▽ = 0	0	GENERAL TOLERANCES (UNLESS SPECIFIED)		DRWN: NPENG01 2019/08/16									
▽ = 0	0	ANGULAR TOL ± 2.0°		CHK'D: HWBAI 2019/08/21			PRODUCT CUSTOMER DRAWING						
▽ = 0	0	4 PLACES ±		APPR: JDENG02 2019/08/22									
▽ = 0	0	3 PLACES ±		INITIAL REVISION:			DOCUMENT NUMBER 5018203231-SD						
▽ = 0	0	2 PLACES ±		DRWN: HWBAI 2018/05/23									
▽ = 0	0	1 PLACE ± 0.2		APPR: CBQIU 2018/07/04			DOC TYPE DOC PART REVISION PSD 000 C						
▽ = 0	0	0 PLACES ± 0.2		DRAFT WHERE APPLICABLE MUST REMAIN WITHIN DIMENSIONS									
▽ = 0	0	THIRD ANGLE PROJECTION		DRAWING		SERIES		MATERIAL NUMBER		CUSTOMER		SHEET NUMBER	
				A1-SIZE		501820		SEE TABLE		GENERAL MARKET		1 OF 2	

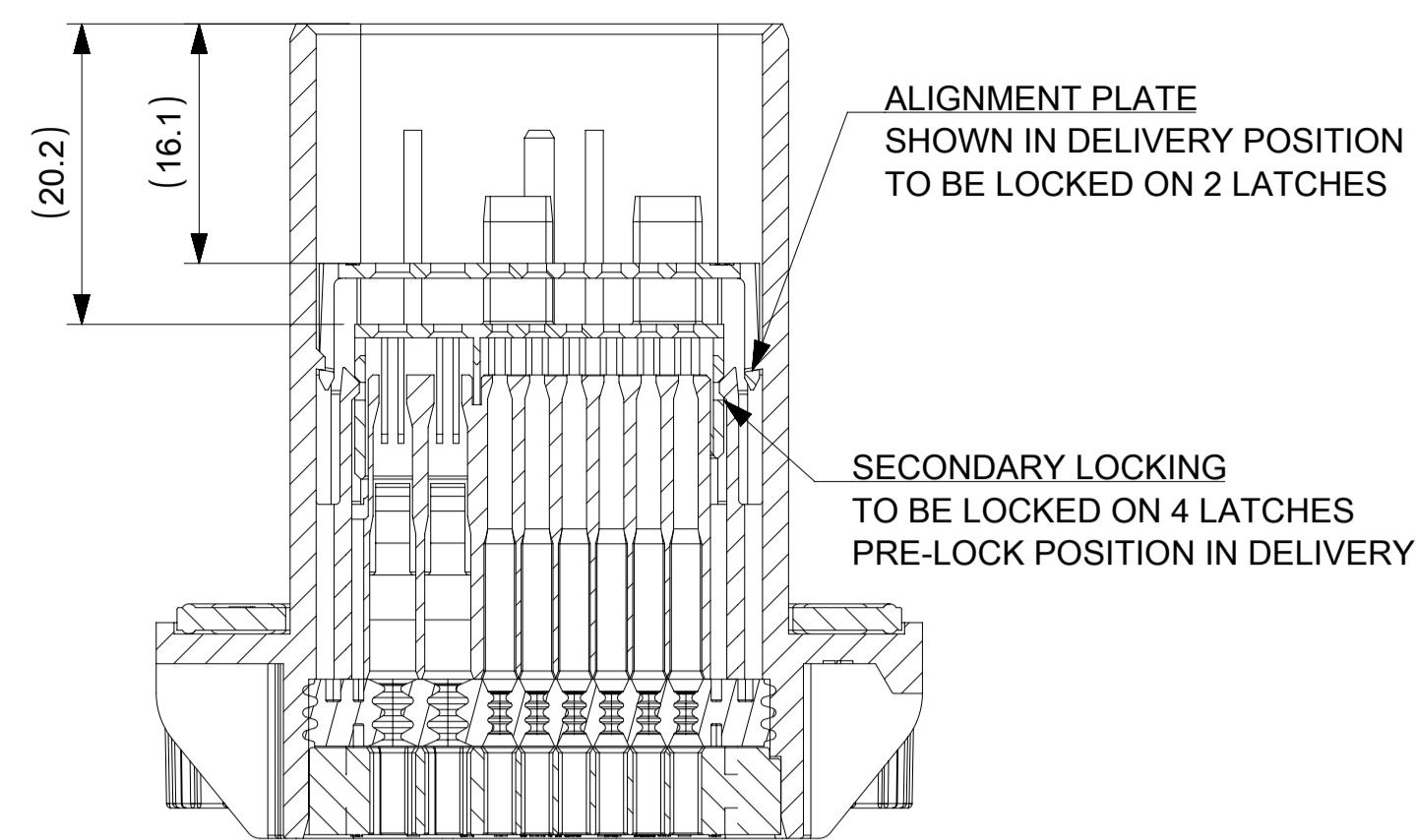

SECTION A-A

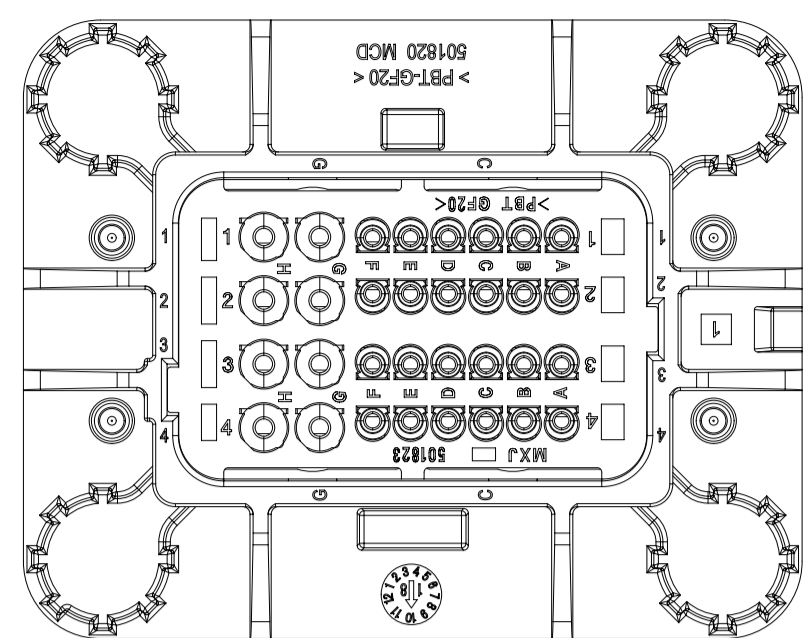

REAR SEAL COVER
TO BE LOCKED FULLY ON 4 LATCHES

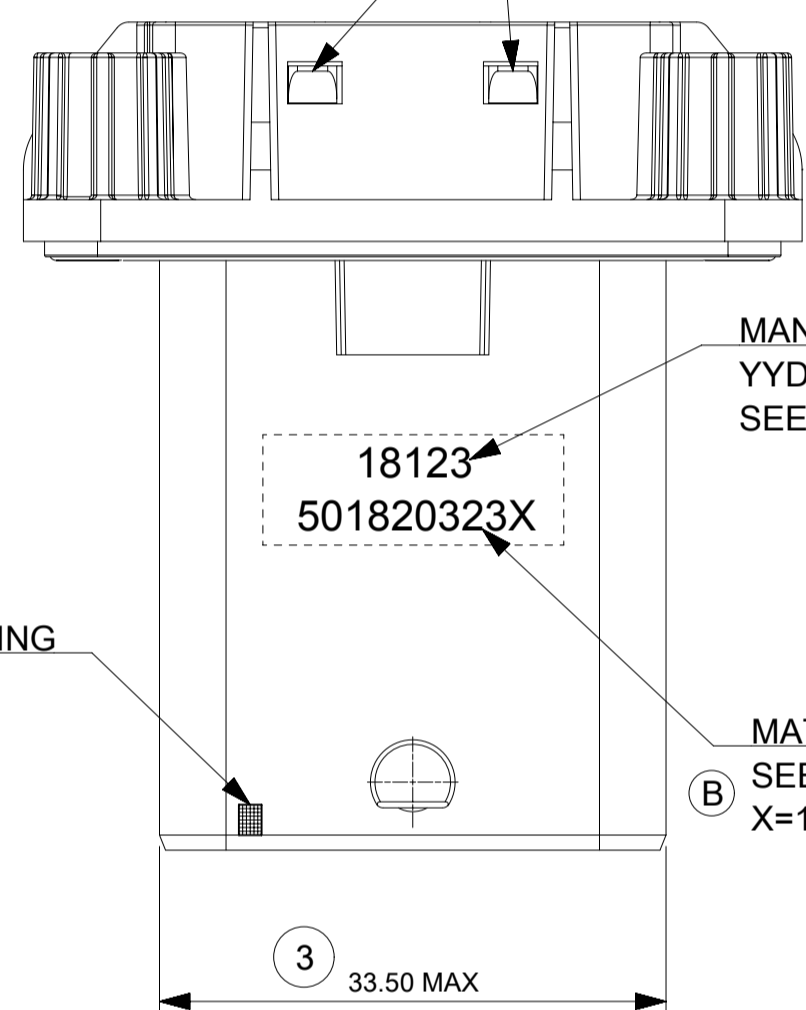

MANUFACTURING DATE
YYDD (YEAR+JULIAN DATE)
SEE NOTE 3.5

MATERIAL NO.
SEE NOTE 3.5
X=1,2,3,5 REFER TO CODING

WHITE LINE MARKING
ON EACH SIDE OF
CONNECTOR

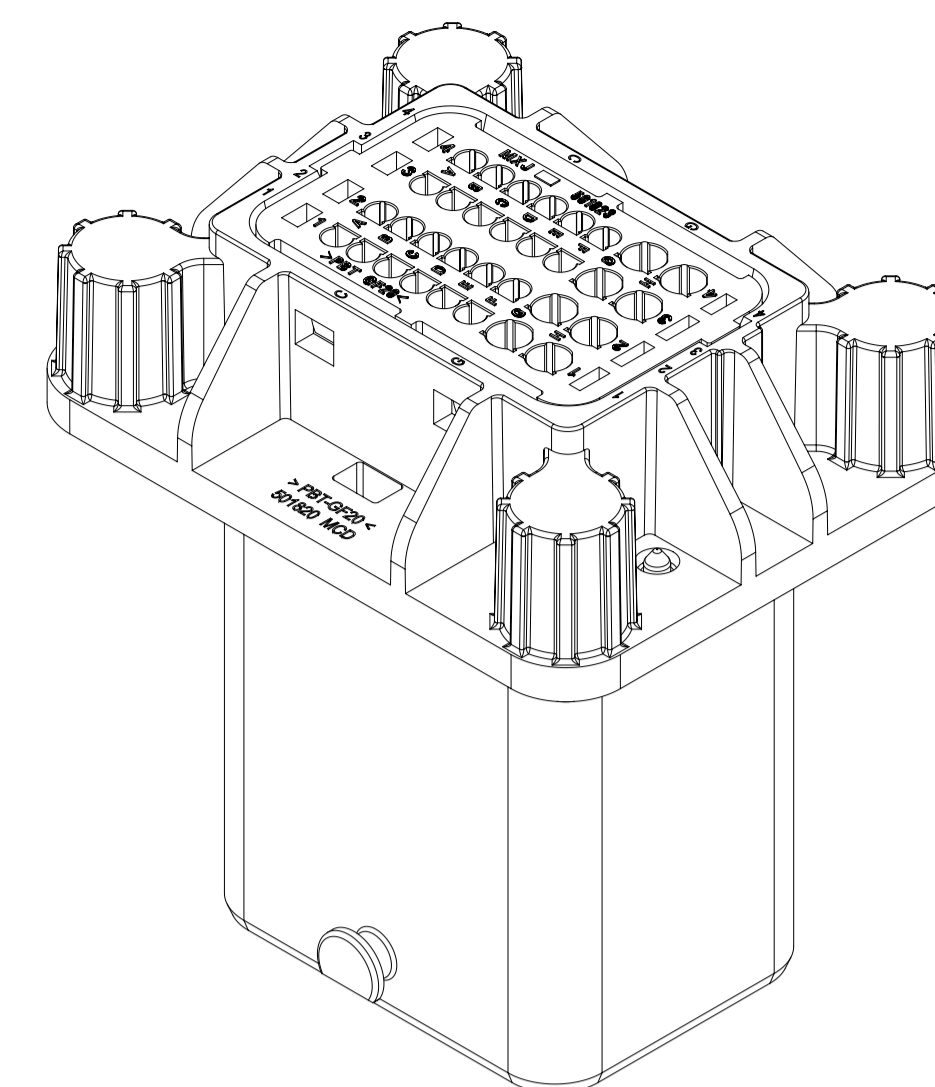
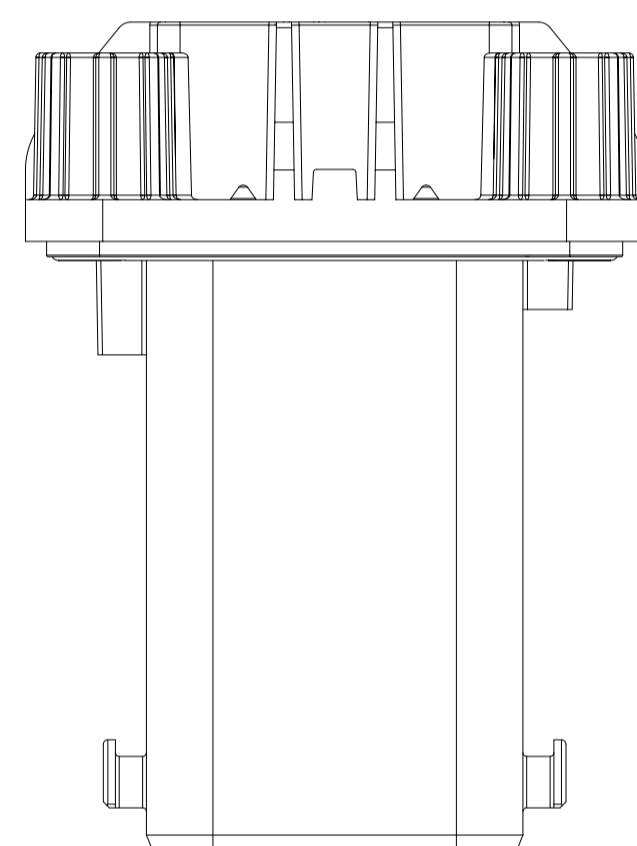
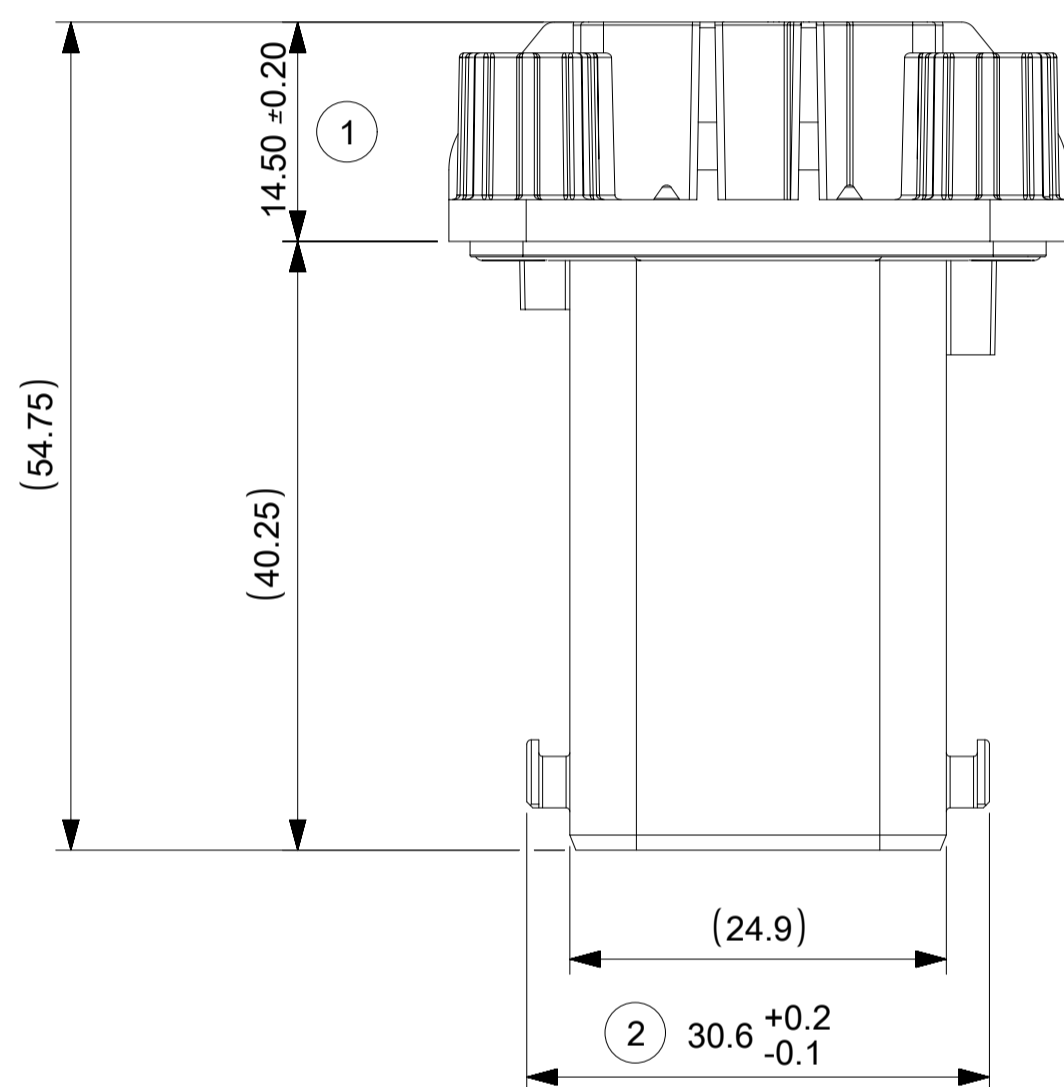

PANEL LAYOUT RECOMMENDATION

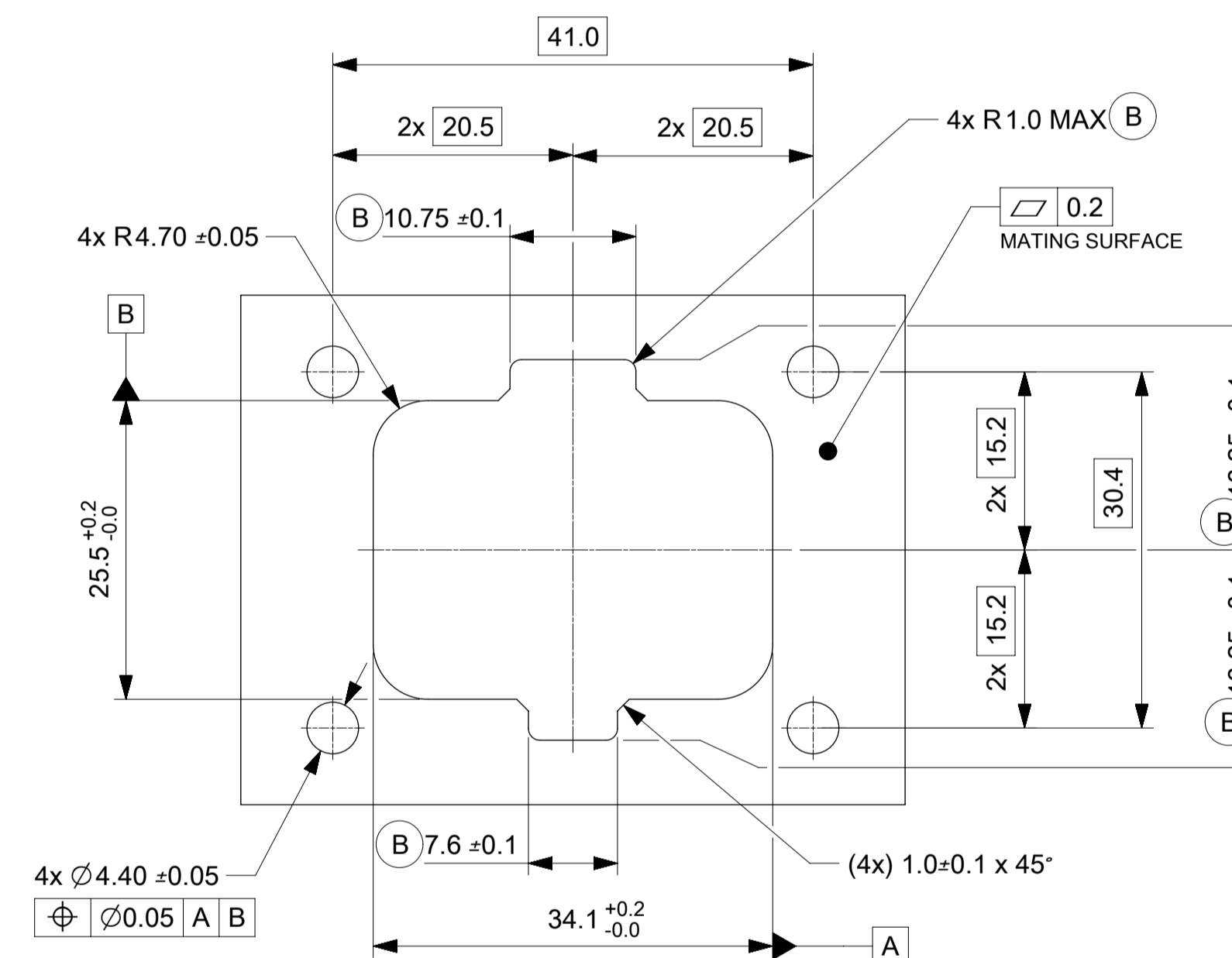

NOTES:

- MATERIAL: STAINLESS STEEL OR ALUMINIUM.
- REQUIRED MATING SURFACE FINISH: Ra 3.0µm MAX OR POLISHED
- RECOMMENDED PANEL THICKNESS FOR MATING AREA: t=3.0~4.0mm
- REQUIRED SCREW:
NAME: CROSS RECESSED ROUND HEAD SELF-TAPPING SCREW TYPE F
SPECIFICATION: ST4.2X13, REFER TO GB/T845-1985 Q2724213
- RECOMMENDED FASTEN TORQUE: 1.4 N·m, MORE DETAILS REFER TO 5018203231-AS-CH

HEADER CODING TABLE

MOLEX P/N	CODING	COLOR (RCPT TPA)	DIM. A	DIM. B	DIM. C	DIM. D	STATUS
5018203231	1	BLACK	9.1	4.3	5.9	4.3	RELEASED
TBD	2	GREY	7.5	5.9	9.1	5.9	NOT TOOLED
TBD	3	BROWN	5.9	7.5	9.1	9.1	NOT TOOLED
TBD	5	BLUE	4.3	7.5	5.9	5.9	NOT TOOLED

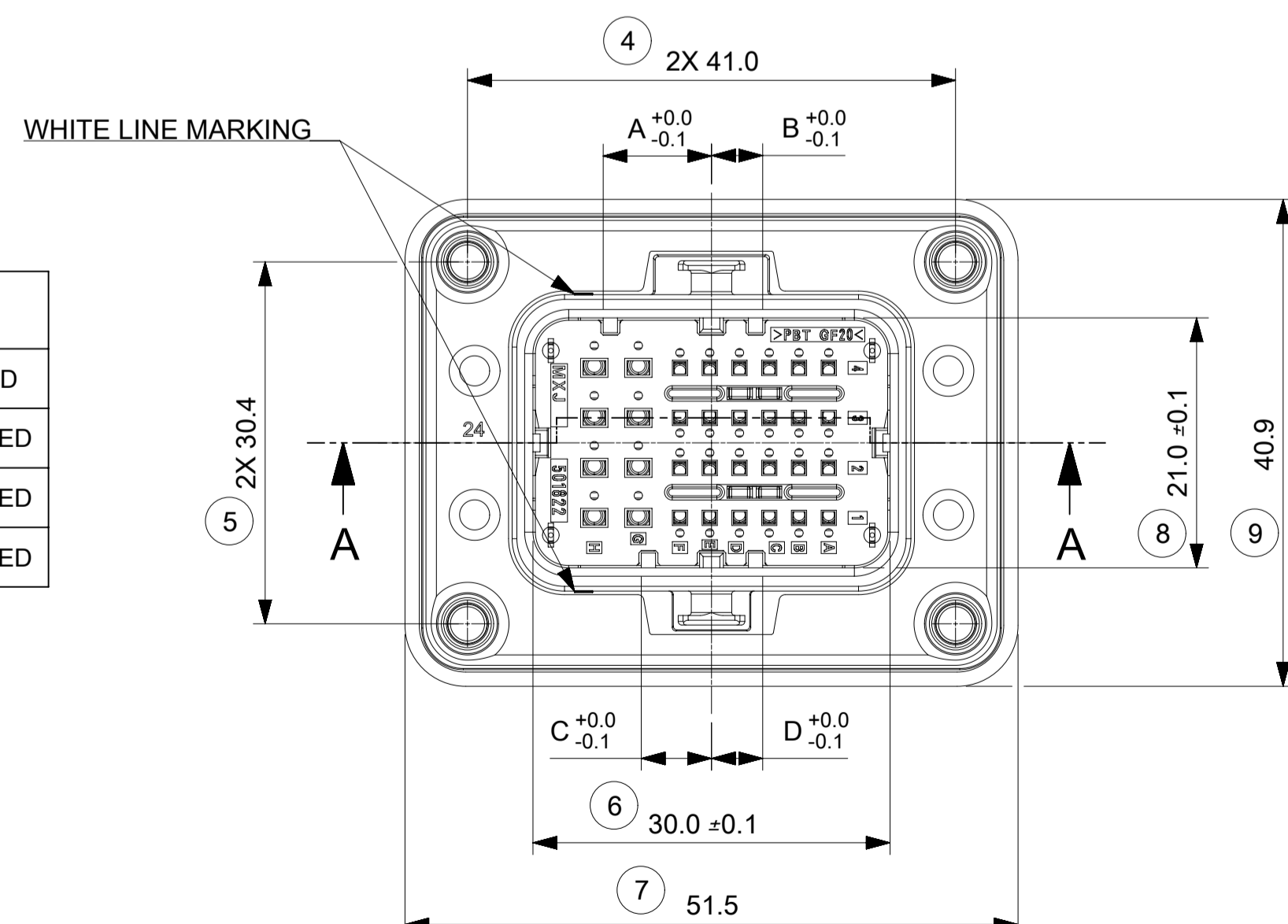

SYMBOLS		THIS DRAWING CONTAINS INFORMATION THAT IS PROPRIETARY TO MOLEX ELECTRONIC TECHNOLOGIES, LLC AND SHOULD NOT BE USED WITHOUT WRITTEN PERMISSION	
DIMENSION UNITS	SCALE	CURRENT REV DESC: INITIAL RELEASE	
mm	2:1	SALES DARWING CMC 32P PANEL MOUNT HEADER	
GENERAL TOLERANCES (UNLESS SPECIFIED)		PRODUCT CUSTOMER DRAWING	
ANGULAR TOL	± 2.0°	DOCUMENT NUMBER: 5018203231-SD	
4 PLACES	±	DOC TYPE: PSD	
3 PLACES	±	DOC PART: 000	
2 PLACES	±	REVISION: C	
1 PLACE	± 0.2	MATERIAL NUMBER: SEE TABLE	
0 PLACES	± 0.2	CUSTOMER: GENERAL MARKET	
DRAFT WHERE APPLICABLE MUST REMAIN WITHIN DIMENSIONS		THIRD ANGLE PROJECTION	SHEET NUMBER: 2 OF 2
		DRAWING: A1-SIZE	SERIES: 501820
		EC NO: 622486	DRWN: NPENG01
		2019/08/16	2019/08/21
		CHK'D: HWBAI	2019/08/22
		APPR: JDENG02	2018/07/04
		INITIAL REVISION:	2018/05/23
		DRWN: HWBAI	2018/07/04
		APPR: CBQIU	