

| LOC | DIST | REVISIONS |     |                            |           |     |      |
|-----|------|-----------|-----|----------------------------|-----------|-----|------|
| GP  | 00   | P         | LYR | DESCRIPTION                | DATE      | DMN | APVD |
|     |      | A         |     | RELEASED PER ECO-12-013192 | 09OCT2012 | BJM | MRS  |
|     |      | A1        |     | RELEASED PER ECO-13-014600 | 20SEP2013 | PP  | SH   |
|     |      | A2        |     | REVISED PER ECR-17-016799  | 01DEC2017 | IT  | SH   |

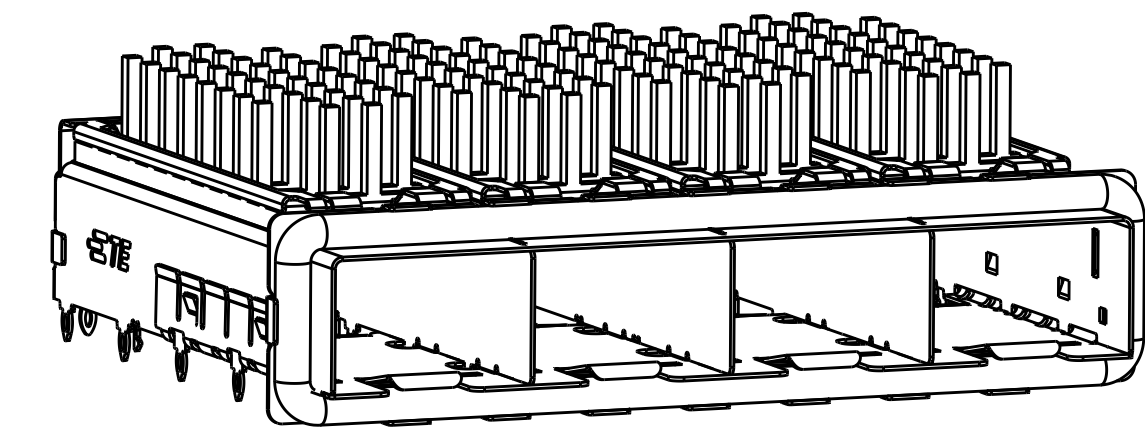

2198241-1,2,3,4  
FINISHED ASSEMBLY WITH  
PIN TYPE HEAT SINK

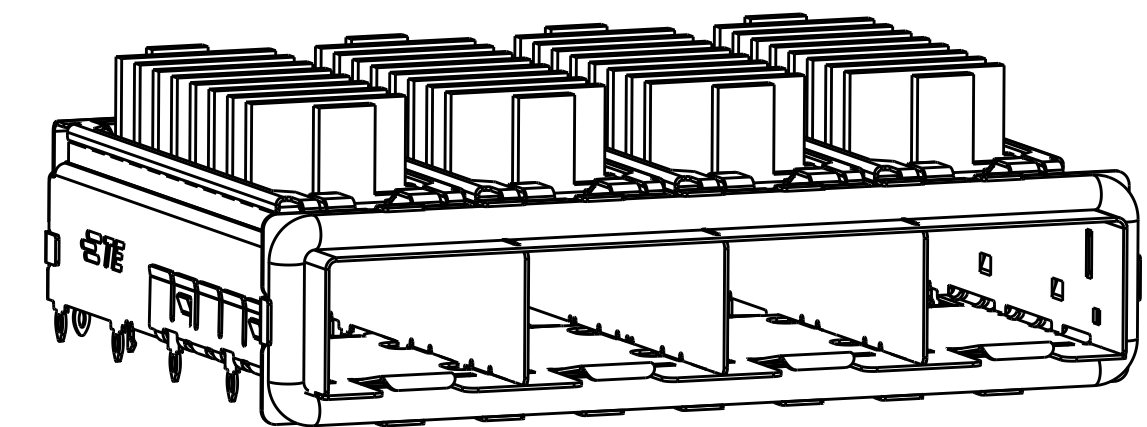

2198241-5,6,7,8  
FINISHED ASSEMBLY WITH  
FIN TYPE HEAT SINK

- 1 MATERIAL:  
CAGE ASSEMBLY: 0.25mm THICK NICKEL SILVER ALLOY  
GASKET RETENTION PLATE: STAINLESS STEEL  
EMI GASKET: PLATED FILLED SILICONE  
HEATSINK CLIP: STAINLESS STEEL  
HEATSINK: ALUMINUM
- 2 FINISH:  
HEATSINK: ELECTROLESS NICKEL  
HEATSINK CLIP: PASSIVATE
- 3 PADS AND VIAS CHASSIS GROUND.
- 4 DATUM AND BASIC DIMENSION ESTABLISHED BY CUSTOMER.
- 5. MATES WITH SFP MSA COMPLIANT TRANSCEIVERS.
- 6. INTERPRETATION OF DATUM REFERENCE FRAME IN ACCORDANCE WITH SECT 4.4.1.1 OF ASME Y14.5M-1994.
- 7 REFERENCE APPLICATION SPEC. 114-13120, HOLE A, FOR RECOMMENDED DRILL HOLE DIAMETER AND PLATING THICKNESS.
- 8 REFERENCE APPLICATION SPEC. 114-13120, HOLE B, FOR RECOMMENDED DRILL HOLE DIAMETER AND PLATING THICKNESS.
- 9 HOLE PATTERN REPEATS FOR EACH PORT. SPACING BETWEEN PORTS IS 14.25mm.

- 10 MINIMUM PC BOARD THICKNESS:  
SINGLE SIDED: 1.5mm
- 11. CERTAIN MATING TRANCEIVERS MAY REQUIRE ADDITIONAL PCB THICKNESS THAT WOULD NEED TO BE DETERMINED BY THE CUSTOMER.
- 12. PRODUCT COMPLIES WITH SPECIFICATION SFF-8433 IMPROVED PLUGGABLE FORM FACTOR FOR SFP+ GANGED CAGES.
- 13 DIMENSION APPLIES PRIOR TO INSERTION OF SFP MODULE.

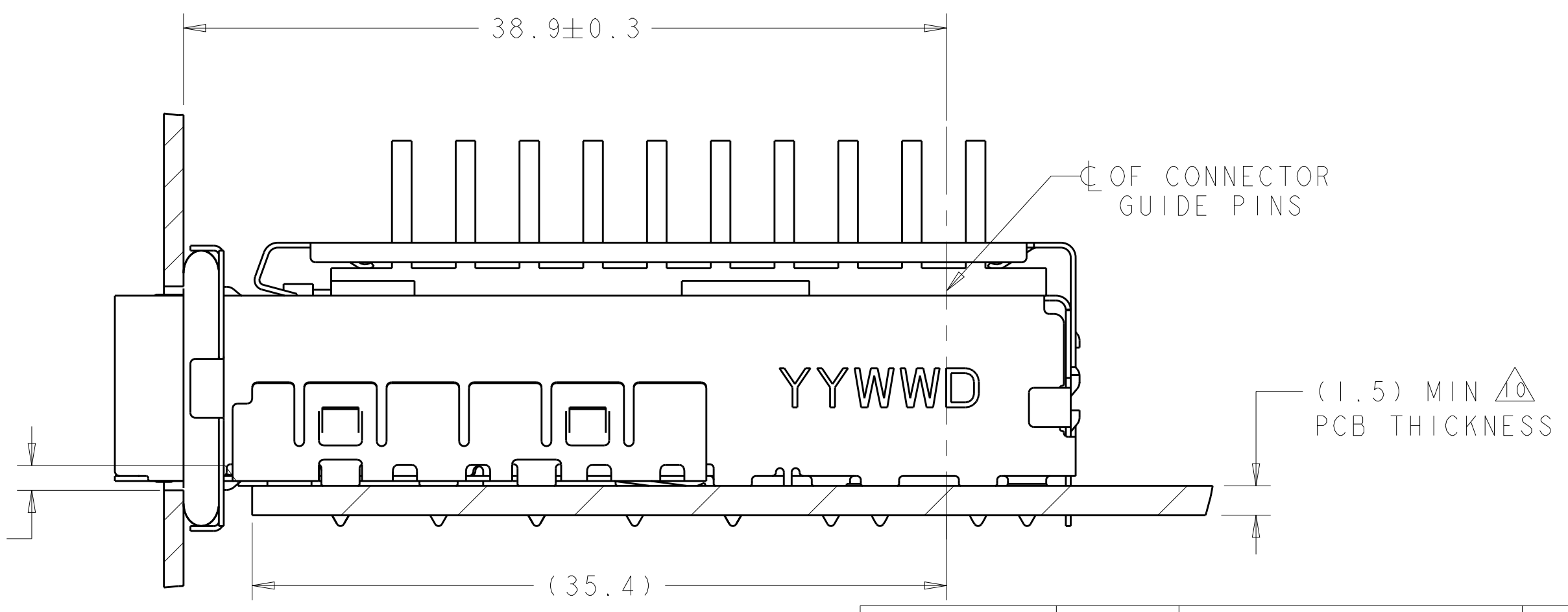
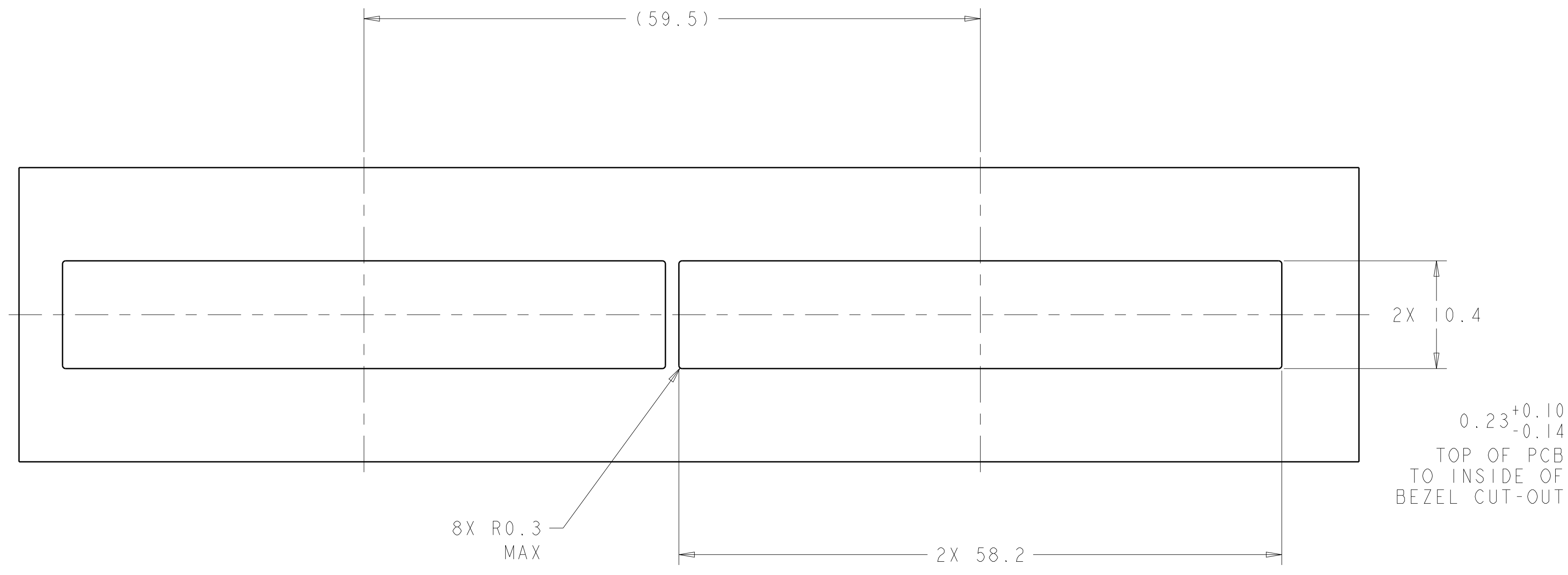
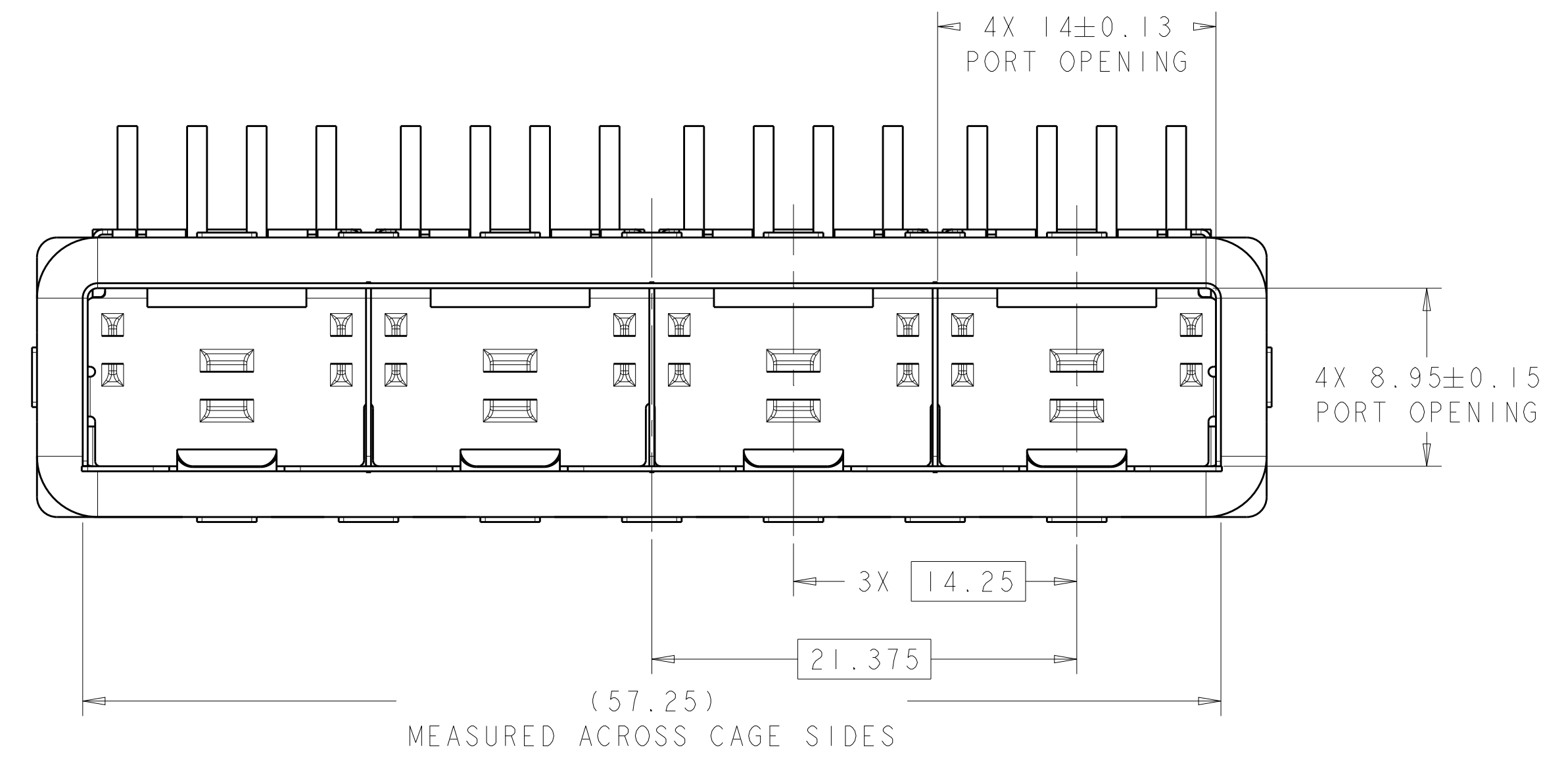
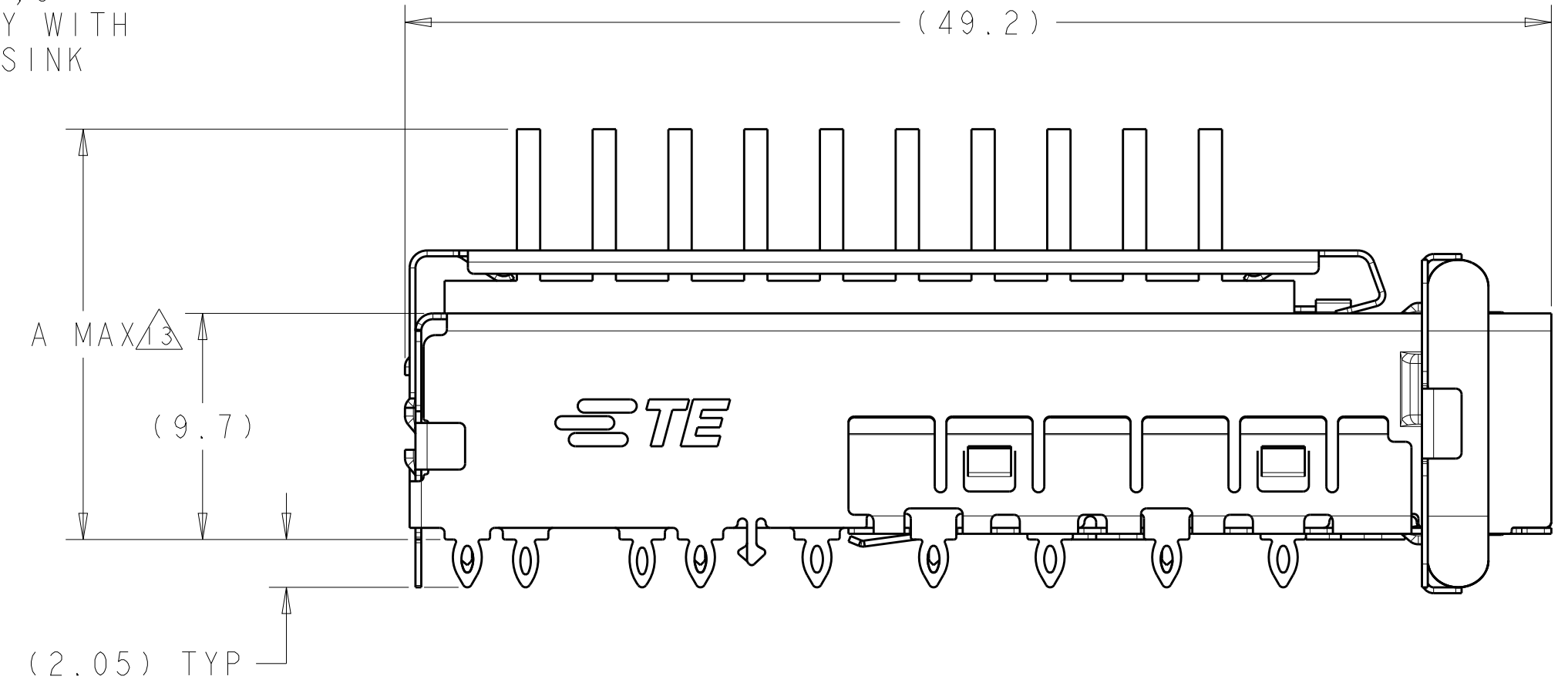

RECOMMENDED BEZEL CUT-OUT  
SINGLE SIDED APPLICATIONS  
SCALE 3:1

2198241  
MOUNTED ON PC BOARD  
SHOWN THRU RECOMMENDED BEZEL

|           |       |                   |             |
|-----------|-------|-------------------|-------------|
| FIN TYPE  | 22.5  | NETWORKING, TALL  | 2198241-8   |
| FIN TYPE  | 18.1  | NETWORKING, SHORT | 2198241-7   |
| FIN TYPE  | 15.5  | SAN               | 2198241-6   |
| FIN TYPE  | 13.2  | PCI               | 2198241-5   |
| PIN TYPE  | 22.5  | NETWORKING, TALL  | 2198241-4   |
| PIN TYPE  | 18.1  | NETWORKING, SHORT | 2198241-3   |
| PIN TYPE  | 15.5  | SAN               | 2198241-2   |
| PIN TYPE  | 13.2  | PCI               | 2198241-1   |
| HEAT SINK | A MAX | APPLICATION       | PART NUMBER |

THIS DRAWING IS A CONTROLLED DOCUMENT.

DMN: B. MATTHEWS, 20OCT2011  
 CHK: M. SCHMITT, 20OCT2011  
 APVD: M. SCHMITT, 20OCT2011

NAME: SFP+ ENHANCED 1X4 CAGE ASSEMBLY, PRESS FIT, EMI GASKET WITH HEATSINK

PRODUCT SPEC: 108-2364  
 APPLICATION SPEC: 114-13120

SIZE: A1  
 CAGE CODE: 00779  
 DRAWING NO: 2198241

Customer Drawing SCALE: 6:1 SHEET: 1 OF 2 REV: A2

| REV.  | DATE | BY | APPROV. | DESCRIPTION |
|-------|------|----|---------|-------------|
| GP 00 |      |    |         | SEE SHEET 1 |

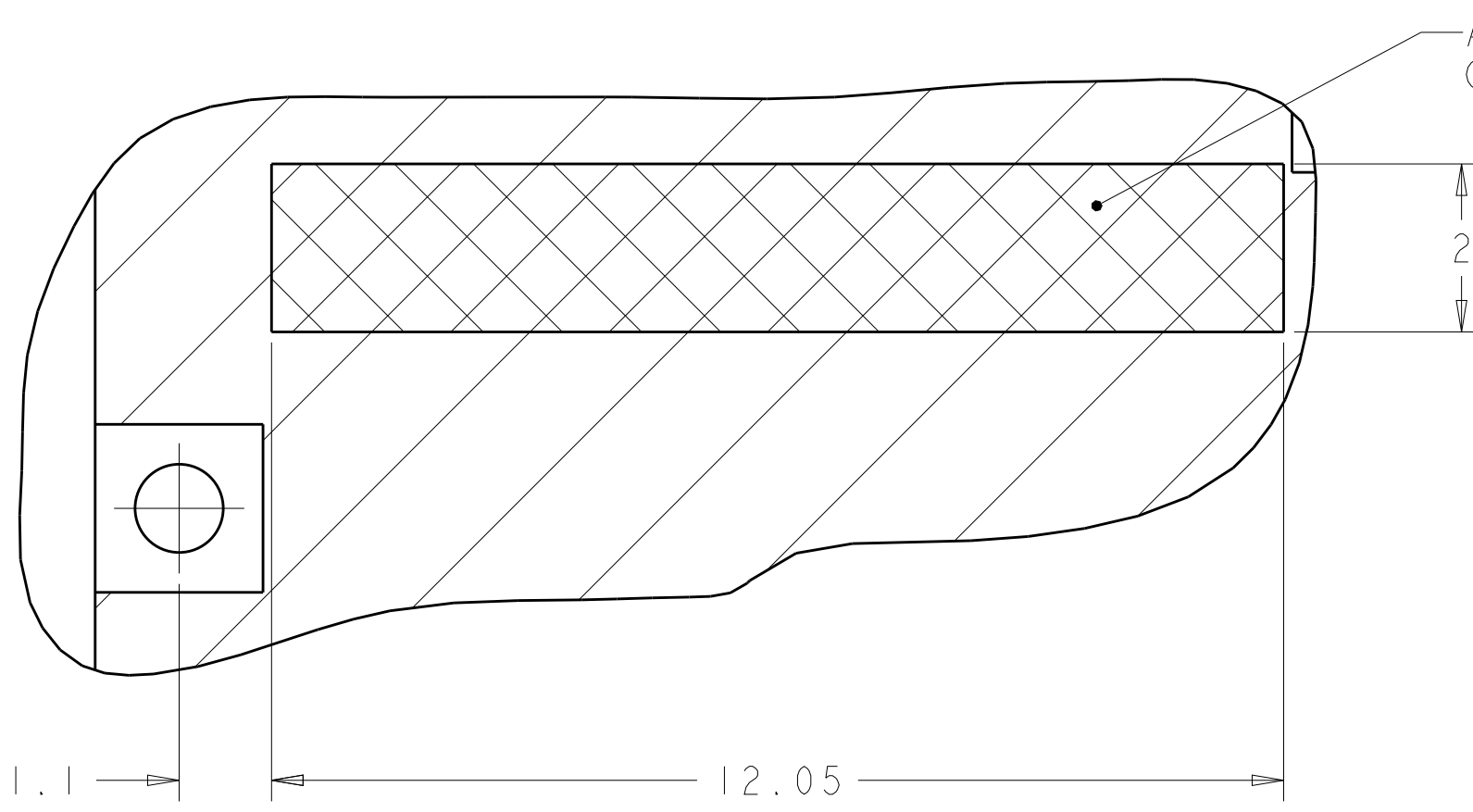

THIS AREA DENOTES COMPONENT KEEP-OUT (TRACES ALLOWED)

SEE DETAIL F

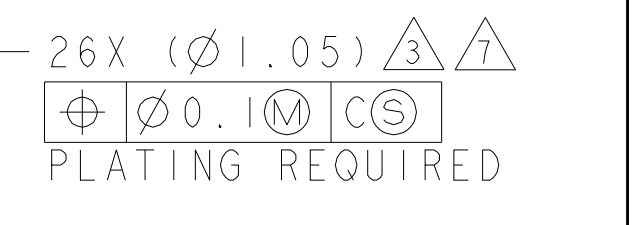
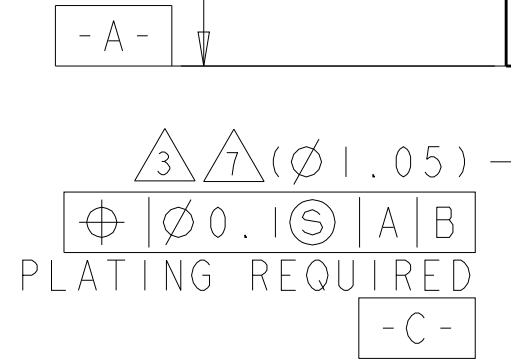
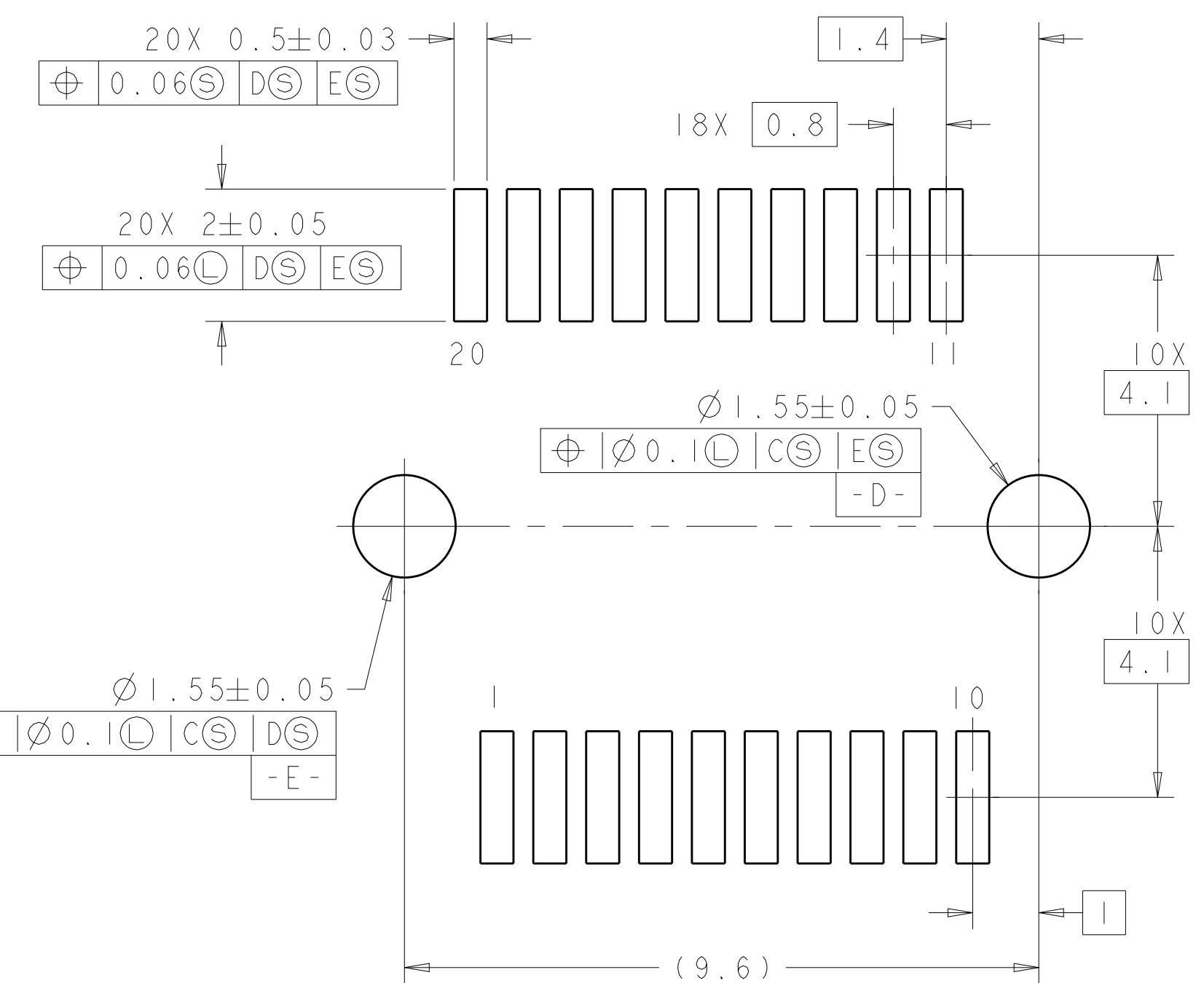
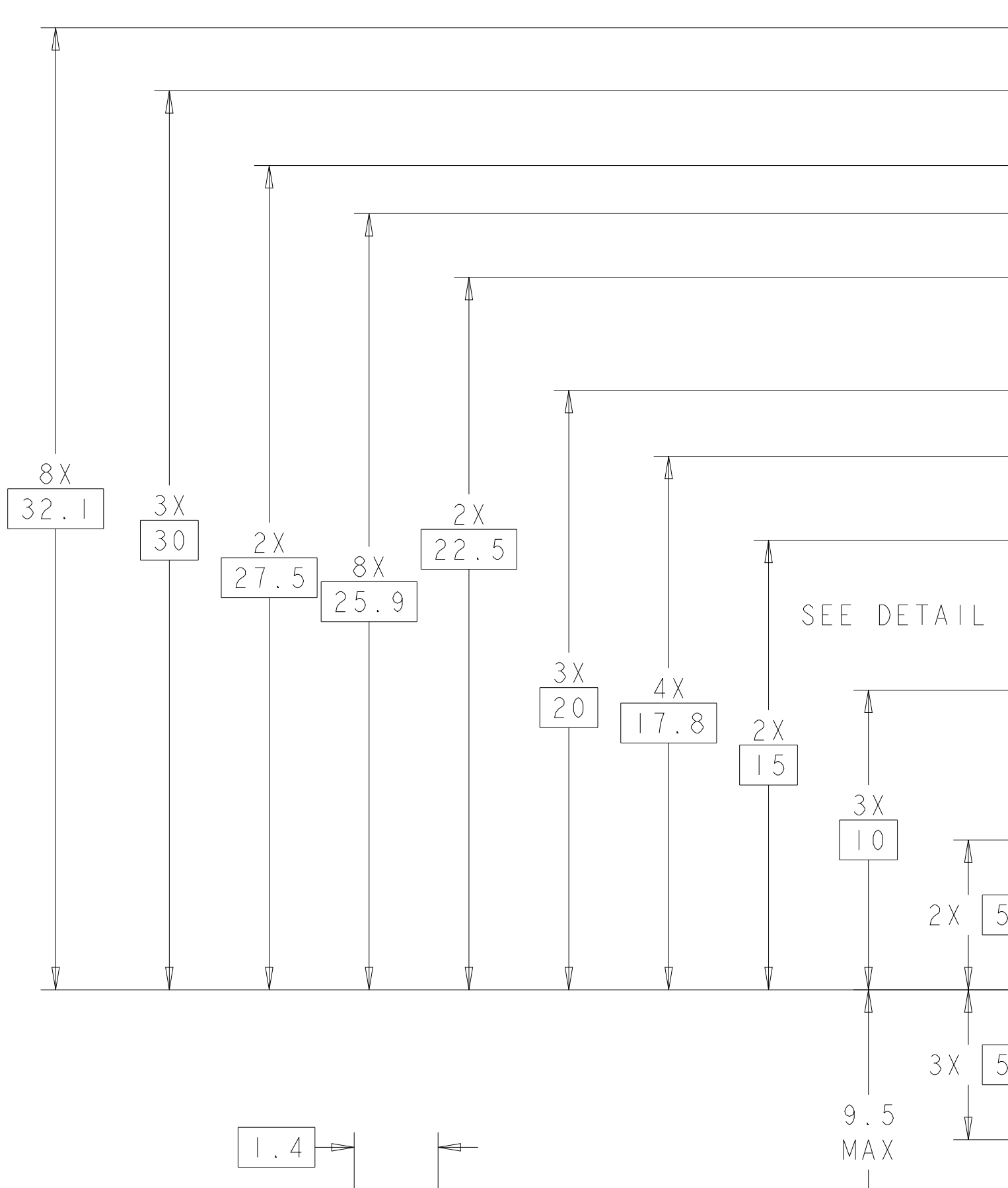
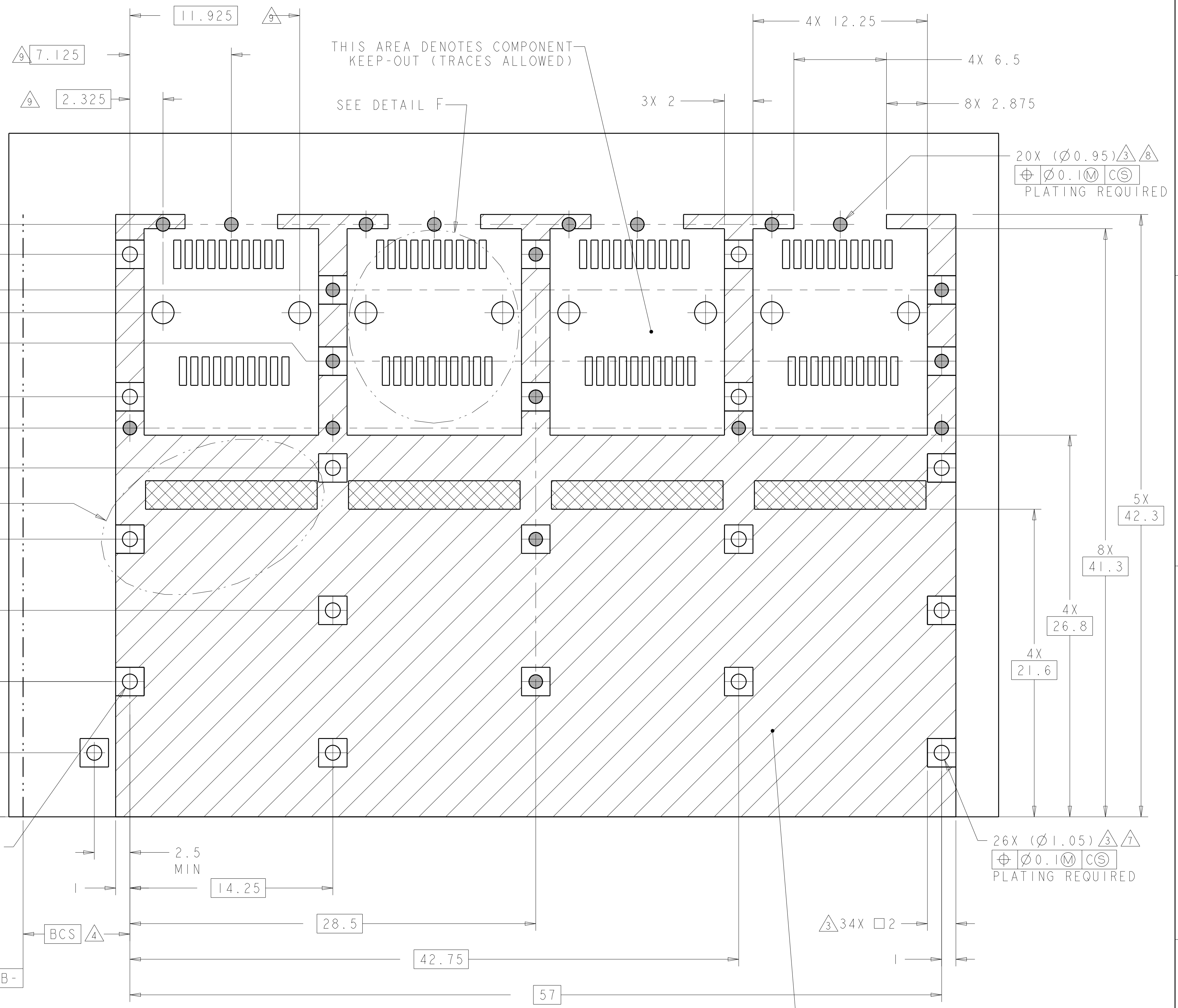

RECOMMENDED PCB CONFIGURATION WITH KEEP-OUT AREAS

CROSS-HATCHED AREA DENOTES COMPONENT AND TRACE KEEP-OUT (EXCEPT CHASSIS GROUND)

THIS DRAWING IS A CONTROLLED DOCUMENT.

DWN: B. MATTHEWS 20OCT2011  
 CHK: M. SCHMITT 20OCT2011  
 APPV: M. SCHMITT 20OCT2011

TE Connectivity

NAME: SFP+ ENHANCED 1X4 CAGE ASSEMBLY, PRESS FIT, EMI GASKET WITH HEATSINK

PRODUCT SPEC: 108-2364  
 APPLICATION SPEC: 114-13120

SIZE: A100779C=2198241  
 CAGE CODE: 100779  
 DRAWING NO: 2198241

RESTRICTED TO: -

MATERIAL: -  
 FINISH: -

Customer Drawing

SCALE: 4:1  
 SHEET: 2 OF 2  
 REV: A2