

LOC	DIST	REV	DATE	BY	APPD
ES	00	1	29JUN2009	IL	SY
		3	30JUN2009	IL	SY
		A		IL	SY

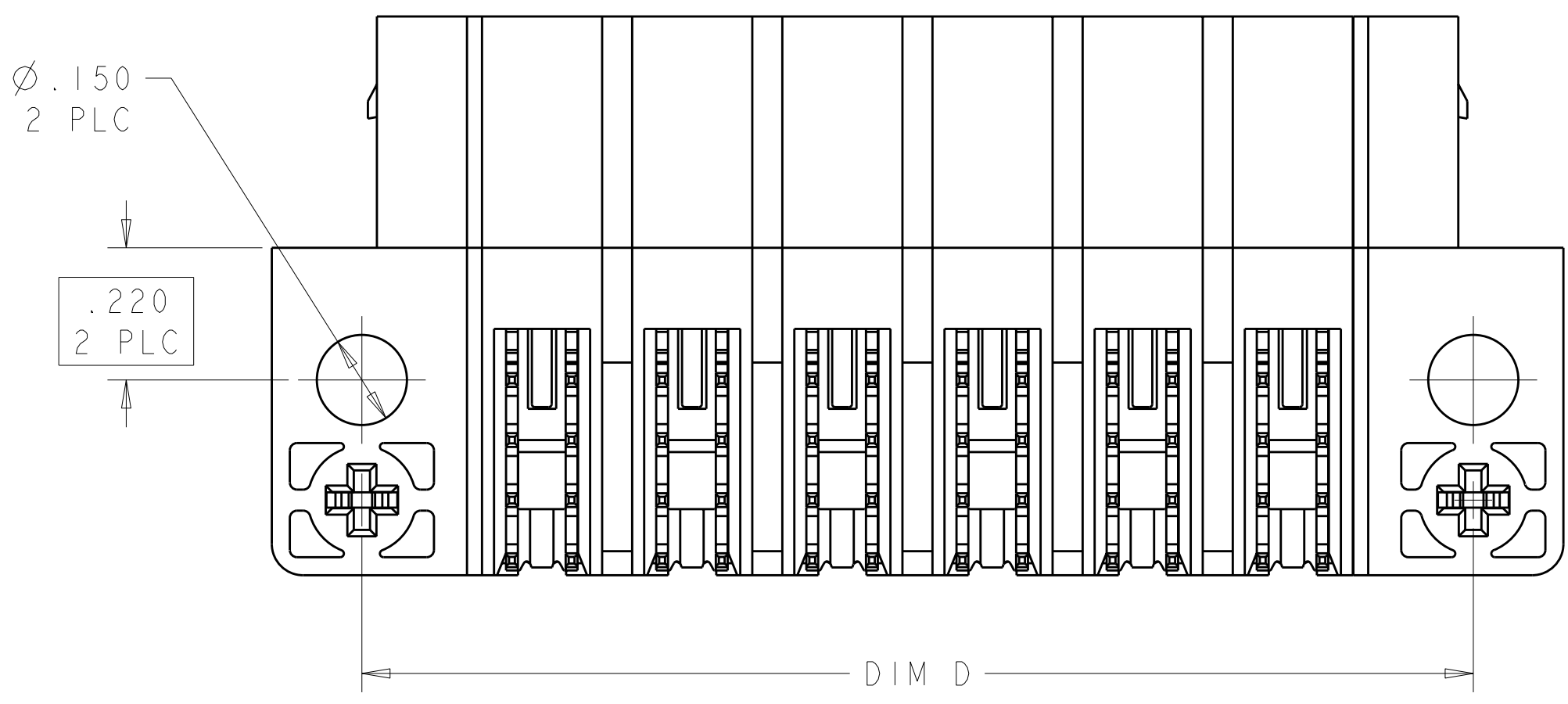

- 1 "AMP" PART NUMBER AND DATE CODE TO BE MARKED IN AREA SHOWN. PARTS UNDER 2.00 INCHES LONG MAY BE MARKED ON BOTH SIDES.
- 2 MATERIAL: HOUSING - GLASS FILLED HIGH TEMP THERMO PLASTIC, UL 94 V-0
POWER CONTACT - HIGH CONDUCTIVITY COPPER ALLOY.
- 3 CONTACT PLATING: POWER CONTACTS: .000050 - .000100 Ni UNDER ALL)
.000030 MIN Au ON CONTACT AREA
.000100 - .000200 Sn AT PCB INTERFACE.
- 4 MECHANICAL CONNECTOR KEEP OUT ZONE. WHEN PLACING CONNECTORS END-TO-END, ALLOW ADDITIONAL 0.1 CLEARANCE BETWEEN CONNECTORS FOR LATCH ACTIVATION.
- 5 DATUM AND BASIC DIMENSIONS ESTABLISHED BY CUSTOMER.
- 6 PCB - ALL HOLE DIAMETERS ARE FINISHED HOLE SIZES.
- 7 PCB - .0453±.0010 DRILLED HOLES PLATED WITH .0003 MIN Sn OVER .001 TO .003 Cu PLATING TO ACHIEVE A .040 DIA HOLE.

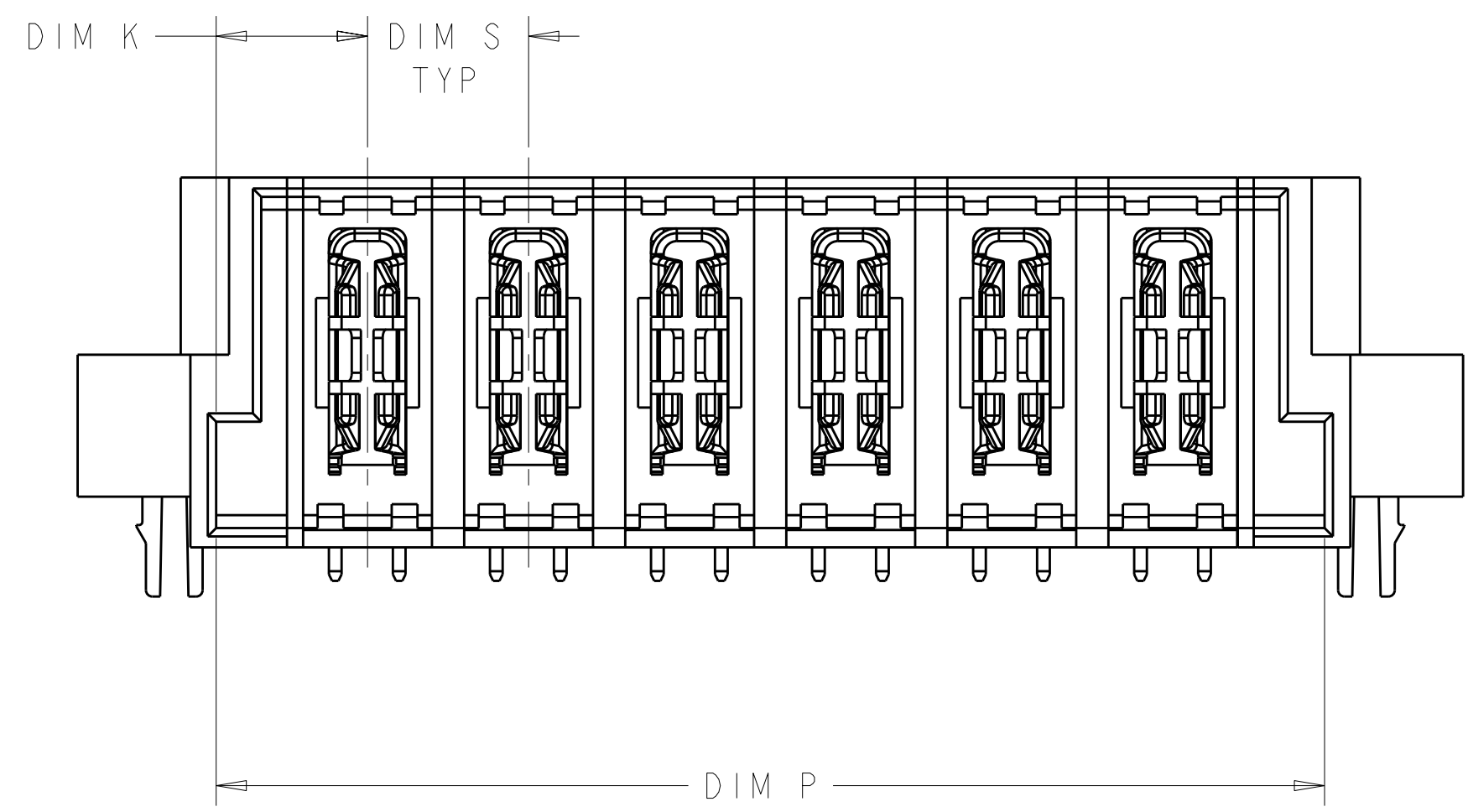
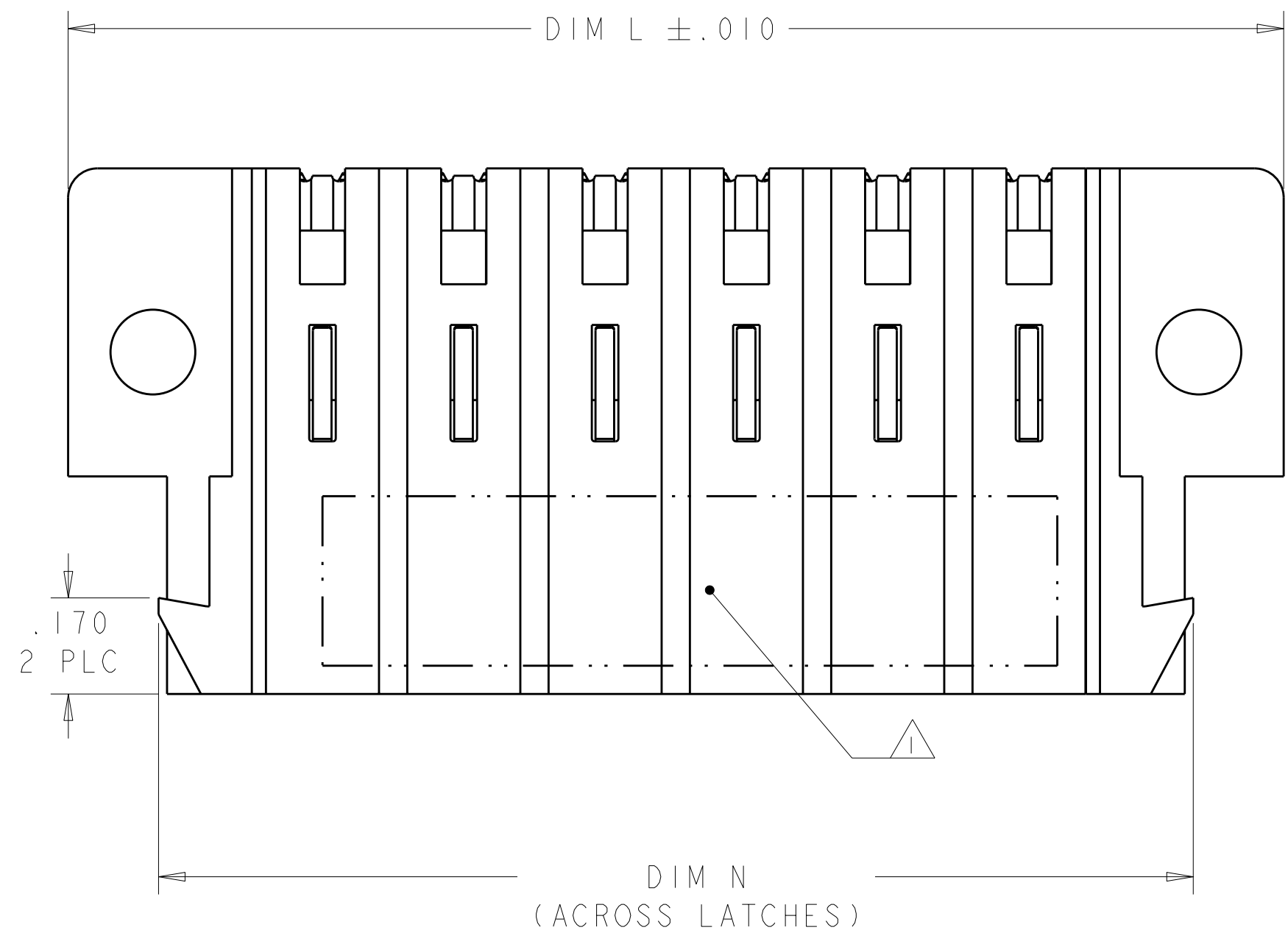
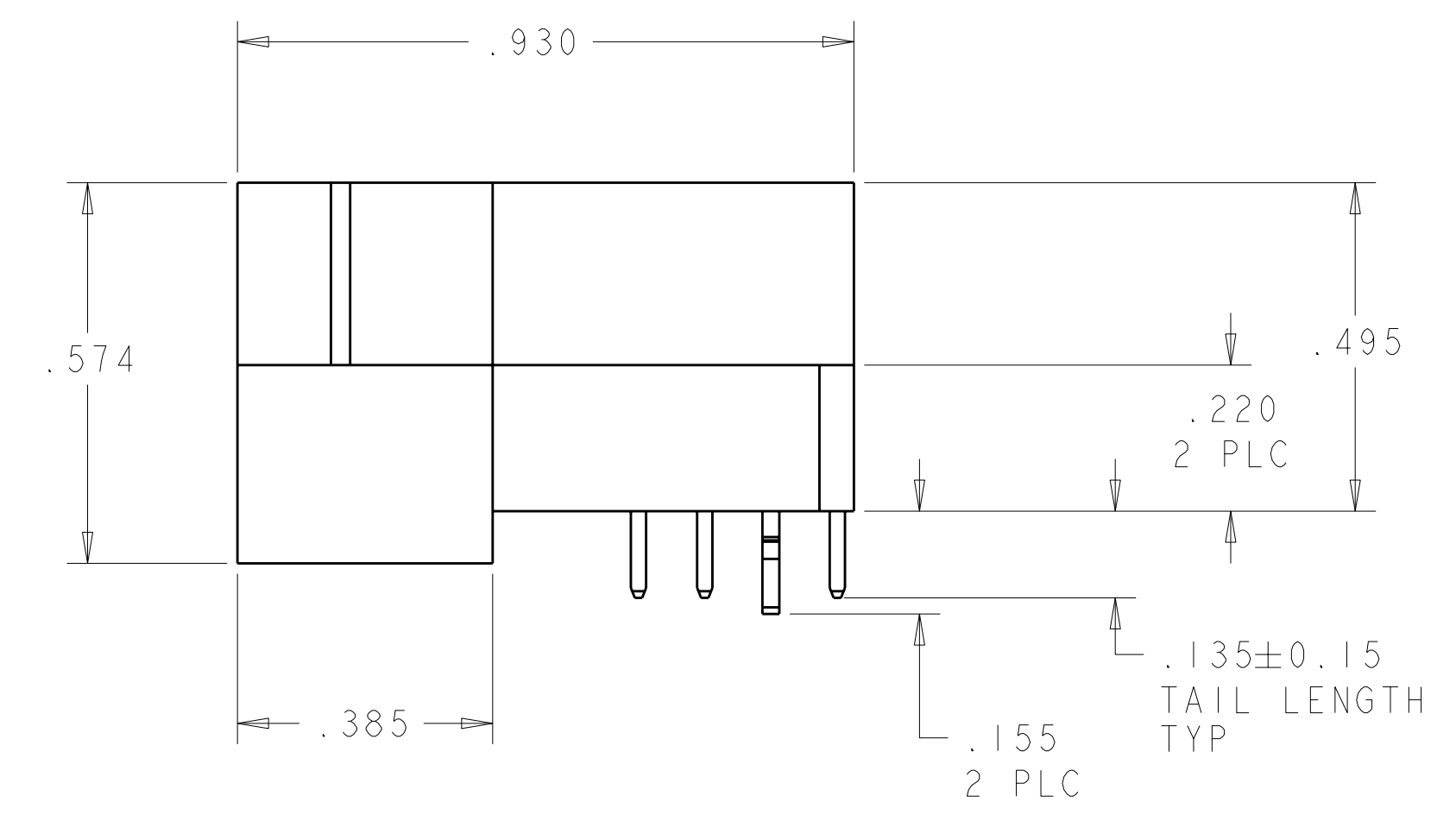

.135	1.720	1.830	1.850	.250	2.150	.235	TRAY	6P	1892109-4
DIM T	DIM P	DIM N	DIM D	DIM S	DIM L	DIM K	PACKING TYPE	DESCRIPTION	PART NUMBER

DIMENSIONS: INCHES TOLERANCES UNLESS OTHERWISE SPECIFIED: 9 PLC ±. 1 PLC ±.01 2 PLC ±.01 3 PLC ±.005 4 PLC ±.0020 ANGLES ±.0°		DWN: L.LEE 29JUN2009 CHK: S.ZHAO 30JUN2009 APVD: S.YAO PRODUCT SPEC: 108-1973 APPLICATION SPEC: 114-13038 WEIGHT: - CUSTOMER DRAWING		Tyco Electronics incorporated Shanghai, P.R.China, 200233 NAME: RIGHT ANGLE HEADER ASSEMBLY W/ END LATCHES POWER CONTACT MULTI-BEAM XL SIZE: A1 CAGE CODE: 00779 DRAWING NO: C=1892109-4 RESTRICTED TO: - SCALE: 4:1 SHEET 1 OF 2 REV A	
--	--	--	--	--	--

LOC	DIST	REVISIONS			
ES	00	REV	DATE	BY	APPD
-	-	SEE SHEET 1	-	-	-

PART NUMBER	ROWS	POWER						
		P1	P2	P3	P4	P5	P6	
1892109-4	D		TM	TM	TM	TM	TM	TM
	C							
	B							
	A		HD					HD
6P								

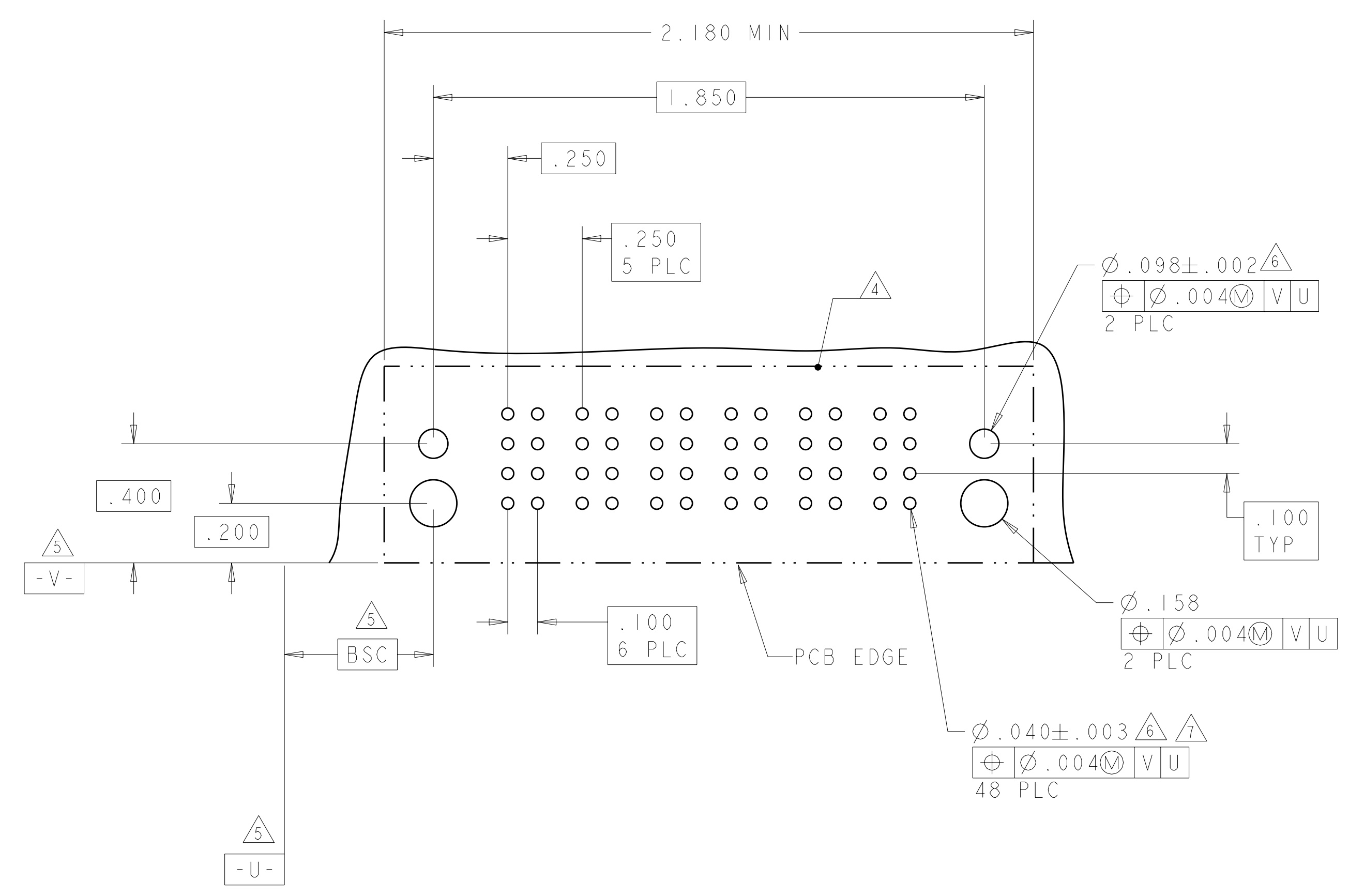

HOLD DOWN		HD
STANDARD MBXL POWER CONTACT (3 BEAM), TAIL LENGTH=.135		TM
DESCRIPTION		CODE
<small>THIS DRAWING IS UNPUBLISHED. RELEASED FOR PUBLICATION. ALL RIGHTS RESERVED. THIS IS SUBJECT TO CHANGE WITHOUT NOTICE AND WITHOUT OBLIGATION. SHOULD BE CONTACTED FOR THE LATEST REVISION.</small>		DWN: L. LEE 29 JUN 2009 CHK: S. ZHAO 30 JUN 2009 APVD: S. YAO
DIMENSIONS: INCHES 		Tyco Electronics Tyco Electronics incorporated Shanghai, P.R.China. 200233
TOLERANCES UNLESS OTHERWISE SPECIFIED: 9 PLC ±. 2 PLC ±.01 5 PLC ±.005 4 PLC ±.0020 ANGLES ±.0°		NAME: S. YAO PRODUCT SPEC: 108-1973 APPLICATION SPEC: 114-13038 WEIGHT: - FINISH: -
MATERIAL: - FINISH: -		SIZE: A CAGE CODE: 00779 DRAWING NO: C=1892109-4 RESTRICTED TO: - CUSTOMER DRAWING: - SCALE: 4:1 SHEET 2 OF 2 REV A