

09	P	30.43	16.79	24.99	8.23	12.17	10.99	5.85	19.02	10.46	1.10	0.8
	S	30.43	16.21	24.99	7.77	12.17	11.21	6.05	19.02	10.46	1.10	0.8
SHELL SIZE		A +0,76 0	B +0,25 0	C ±0,12	D +0,25 0	E +0,76 0	F MAX	G +0,15 0	H +0,51 0	J +0,51 0	K ±0,2	L +0,22 0

NOTE:- 1) INSIDE DIMENSIONS OF THE MALE AND OUTSIDE DIMENSIONS OF THE FEMALE CONNECTOR

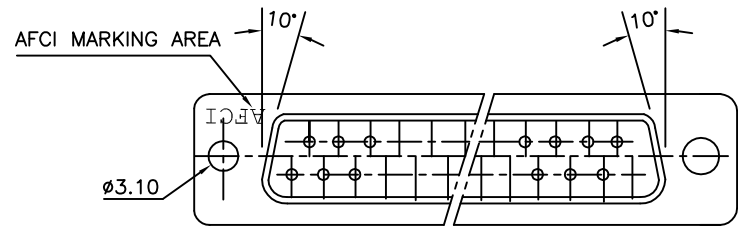
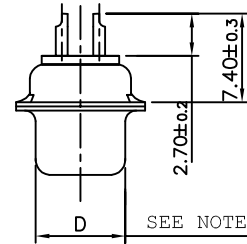
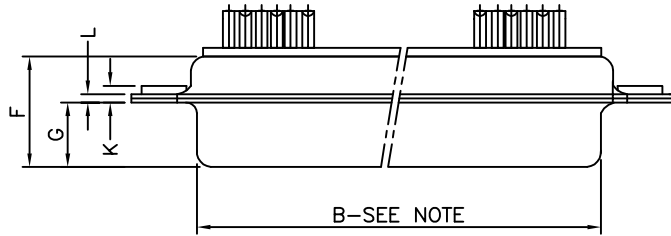
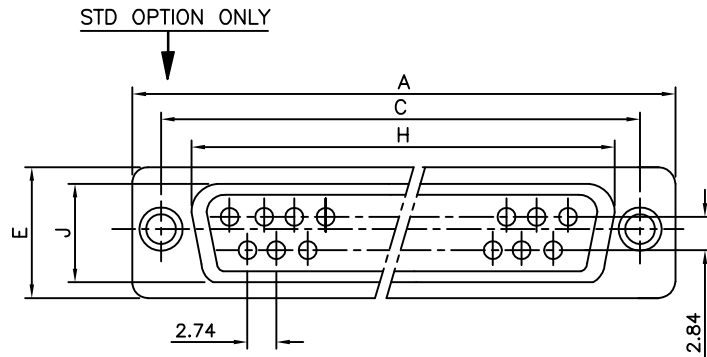

VIEW OF MATING FACE

ORDERING INFORMATION

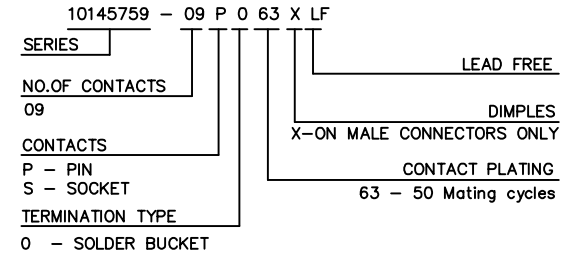

TECHNICAL SPECIFICATIONS

INSULATOR MATERIAL : THERMOPLASTIC UL94 HB
 CONTACT MATERIAL : COPPER ALLOY
 FOR OTHER PRODUCT SPECIFICATION & TECHNICAL DETAILS REFER GS-12-1525
 "This LF product meets European Union Directives and other -
 - country regulations as described in GS-47-0004"

mat'l. code		surface		tolerance		projection		product family	
SEE NOTES		ISO 1302		ISO 406 ISO 1101		mm		D-SUB	
ltr	ecn no	dr	date	tolerances unless otherwise specified		mm		title	
A		GM	2019-06-10	angles	.0±0.30	mm		D-SUB SOLDER BUCKET	
B	ELX-I-35111	GM	2019-10-15	0°±x'	.00±0.10	scale N.T.S.		ECONOMY VERSION CONNECTOR	
				dr	GREGAR MATHEW 2019-06-10	Amphenol FCi		dwg no	
				eng	GREGAR MATHEW 2019-06-10			sheet 1 of 1 size	
				chr	SREERAJ K R 2019-10-15			10145759	
				appd	SANOJ P K 2019-10-15			type	
sheet	revision	B							
index	sheet	1							