



ANATECH ELECTRONICS INC
RF & Microwave Filters & Products

1621 MHz Ceramic Bandpass Filter

Part Number: AM1621B1338



Electrical specifications

Center Frequency: 1621 MHz
Bandwidth: 10.5 MHz
VSWR: 1.5:1
Input / Output Impedance: 50 Ohms
Passband: 1615.75-1626.25 MHz
Passband Insertion Loss: 2.0 dB max
Passband Ripple: 0.5 dB max
Rejection: 55 dB min at 244-380 MHz
Rejection 2: 55 dB min at 2483.5-2690 MHz
Power Handling: 1 W

Mechanical

Mounting Method: SMT
Dimensions: 13 x 12 x 4.5 mm

Environmental

Operating Temperature: -20°C to +70°C
Storage Temperature: -50°C to +90°C

This product is RoHs compliant.

Outline Drawing:

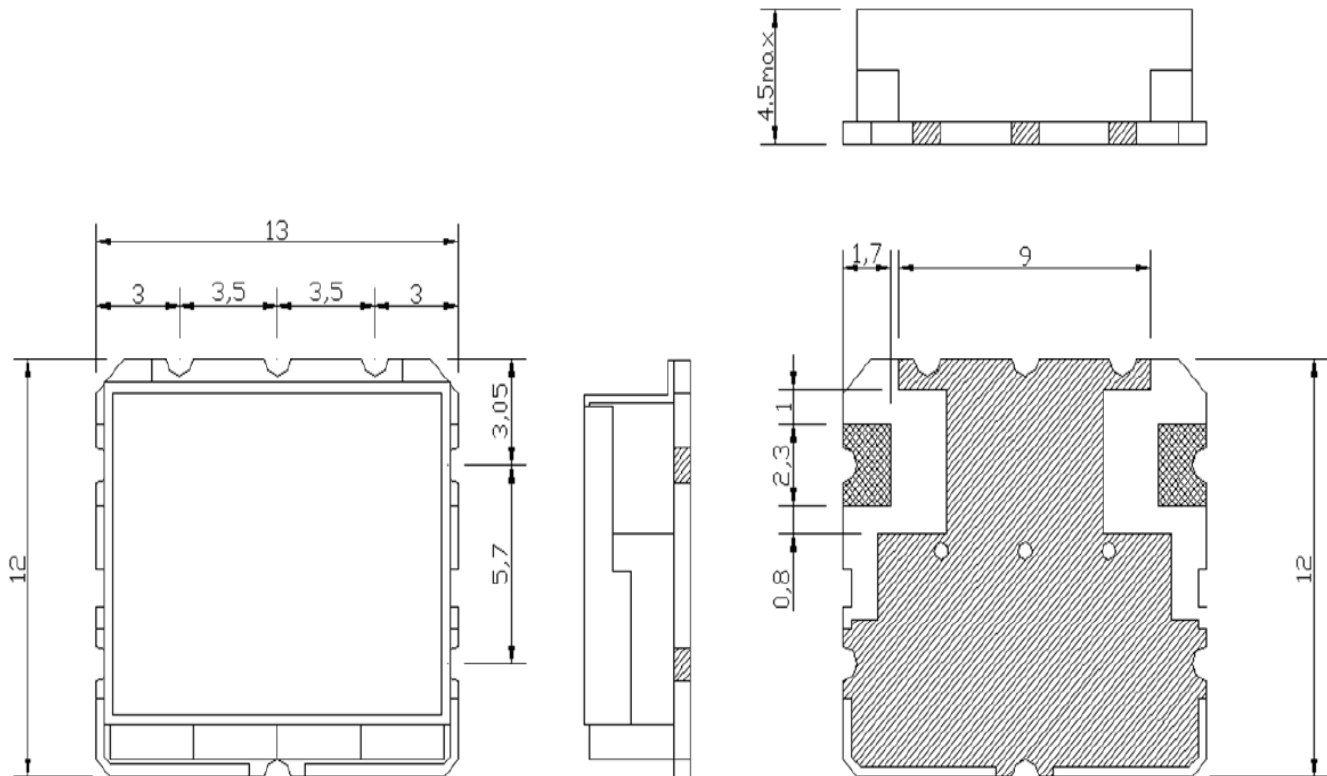

Tolerance: +/-0.01 inches [+/- 0.3mm]

Angles: +/- 1 Deg.

*Tolerance as shown unless otherwise specified in the datasheet electrical specification tables above.

*When max dimensions are called out the above tolerances do not apply as long as it is under the max call out.



ANATECH ELECTRONICS INC
RF & Microwave Filters & Products

1621 MHz Ceramic Bandpass Filter

Part Number: AM1621B1338



Response Plot:

