

RECOMMENDED PCB LAYOUT
COMPONENT SIDE

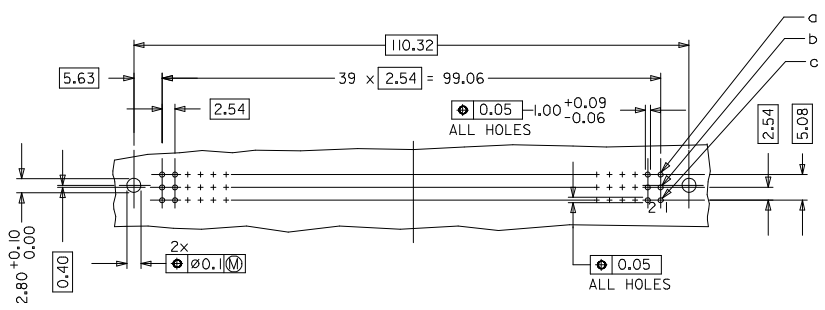

NOTES:

- 1) MATERIALS: THERMOPLASTIC POLYESTER, GLASS FILLED, UL94V-0.
COLOUR: PEBBLE GREY RAL 7032
TERMINAL - PHOSPHOR BRONZE
- 2) FINISH: CONTACT AREA

PERFORMANCE LEVEL 2: SLECTIVE GOLD (Au), THICKNESS = 0.6 MICROMETER,
OVER NICKEL, THICKNESS = 1.25 MICROMETER MIN

PRESS-IN AREA : Au FLASH, OVER NICKEL, THICKNESS = 1.25 MICROMETER MIN OVERALL

WRAP AREA : Au FLASH, OVER NICKEL, THICKNESS = 1.25 MICROMETER MIN OVERALL

TRANSFER PLUGGING AREA :
PERFORMANCE LEVEL 2 : SLECTIVE GOLD (Au), THICKNESS = 0.6 MICROMETER,
OVER NICKEL, THICKNESS = 1.25 MICROMETER MIN OVERALL
- 3) MATERIAL NUMBER, BATCH CODE UL AND CSA MARKING TO BE PRINTED ON THE CONNECTOR
- 4) CUT FACES OF TIP WITHOUT PLATING PERMITTED
- 5) PRODUCT SPECIFICATION : PS: 36515-001

DETAIL Z DETAIL Y

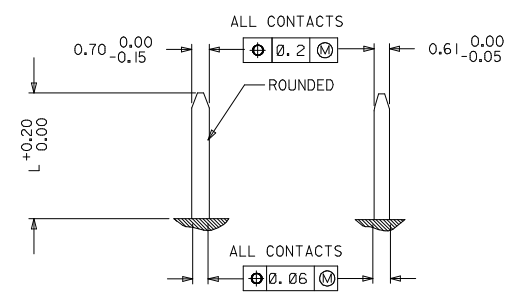

| | |
|-----------------|-----|
| | L |
| NORMAL CONTACTS | 4.8 |

RoHS COMPLIANT

| | | | | | | | | | |
|---|-------------------------------|--|------------|--|--------------------|----------------------|-------------------------------|----------------------------|--|
| EC NO: 2007-077Z DRAWN: JAVENG 2008/06/07 CHKD: SUDHR 2008/06/19 APPR: KRASAD 2009/01/22 | QUALITY SYMBOLS ▽=0 ▽=0 | GENERAL TOLERANCES (UNLESS SPECIFIED) | | DIMENSION STYLE MM ONLY | | SCALE 2:1 | DESIGN UNITS METRIC | THIRD ANGLE PROJECTION | |
| | | 4 PLACES ± --- ± --- 3 PLACES ± 0.05 ± --- 2 PLACES ± 0.1 ± --- 1 PLACE ± 0.15 ± --- ANGULAR ± 2 ° | mm INCH | DRAWN BY SS | DATE 1999/11/23 | CHECKED BY GJLOWE | DATE 1999/11/23 | ASSEMBLY, DIN 41612 | |
| DRAFT WHERE APPLICABLE MUST REMAIN WITHIN DIMENSIONS | SIZE 1 | MATERIAL NO. 36514-0002 | | APPROVED BY GJLOWE | | DATE 1999/11/23 | MOLEX INCORPORATED | | |
| | | DOCUMENT NO. SD-36514-002 | | MOLEX INCORPORATED | | | | | |
| | | SHEET NO. 1 OF 1 | | THIS DRAWING CONTAINS INFORMATION THAT IS PROPRIETARY TO MOLEX INCORPORATED AND SHOULD NOT BE USED WITHOUT WRITTEN PERMISSION | | | | | |