

NOTES: (b)

1. RoHS COMPLIANT
2. FOR WAVESOLDERING (SOLDER BATH TEMPERATURE 260°C FOR 5 SEC. AND SOLDER PREHEAT 100°C FOR 30 SEC.)
3. METALSHELLS: STEEL; min. 315µm TIN over 40-80µm NICKEL
4. INSULATOR: HIGH TEMPERATURE PLASTIC UL 94 V-0; BLACK
5. CONTACTS: COPPER ALLOY; PLATING (SEE PART NO.):
 PLEASE ADD A for GOLD FLASH over NICKEL (PREFERRED TYPE)
 PLEASE ADD B for 20µm HARD GOLD over min. 50µm NICKEL
 PLEASE ADD C for 30µm HARD GOLD over min. 50µm NICKEL
 CONTACTS TAILS PRETINNED
6. THREADED SPACER CLIPS: COPPER ALLOY; min. 200µm TIN over 80µm NICKEL
 PCB-HOLE: $\varnothing 3,1 \pm 0,1$; PCB THICKNESS 1,6mm
7. COLLARS: COPPER ALLOY; min. 200µm TIN over 80µm NICKEL
8. CAPACITANCE: 2 x 1300pF $\pm 20\%$
9. DIELECTRIC WITHSTANDING VOLTAGE: 300 VDC
10. P.C.B. HOLE DRILLINGS SEE SHEET 2
11. MAXIMUM TORQUE VALUE FOR THREAD: 6 in.LB
12. CONNECTOR IS PART MARKED: **241□26500X CONEC ABC**

Directive 2002/95/EC RoHS compliant

THIS DRAWING MAY NOT BE COPIED OR REPRODUCED IN ANY WAY, AND MAY NOT BE PASSED ON TO A THIRD PARTY WITHOUT WRITTEN PERMISSION. OWNERSHIP AND COPYRIGHT OF CONEC GmbH

DO NOT ALTER CAD DRAWING BY HAND

		tolerance		dim. in mm	
		date	name		
		drawn	06.05.13	Henneboel	
		appd.	06.05.13	Fischer	
		norm			
		d-old	24K1A930		
6 x b	A4743	06.05.2013	K.H.		
a	Original				
rev.	description	date	name		

scale:	2:1 (5:1)	
material:	SEE NOTES	
title:	D-SUB PI FILTER MALE 25pos. SOLDER PIN STRAIGHT with threaded spacer clip	
dwg no:	(b) 24K1A1439	DIN-A3
part no:	(b) 241□26500X	sh:1/2
	(see note 5)	

P.C.B. HOLE DRILLINGS
(P.C.B. TOP SIDE)

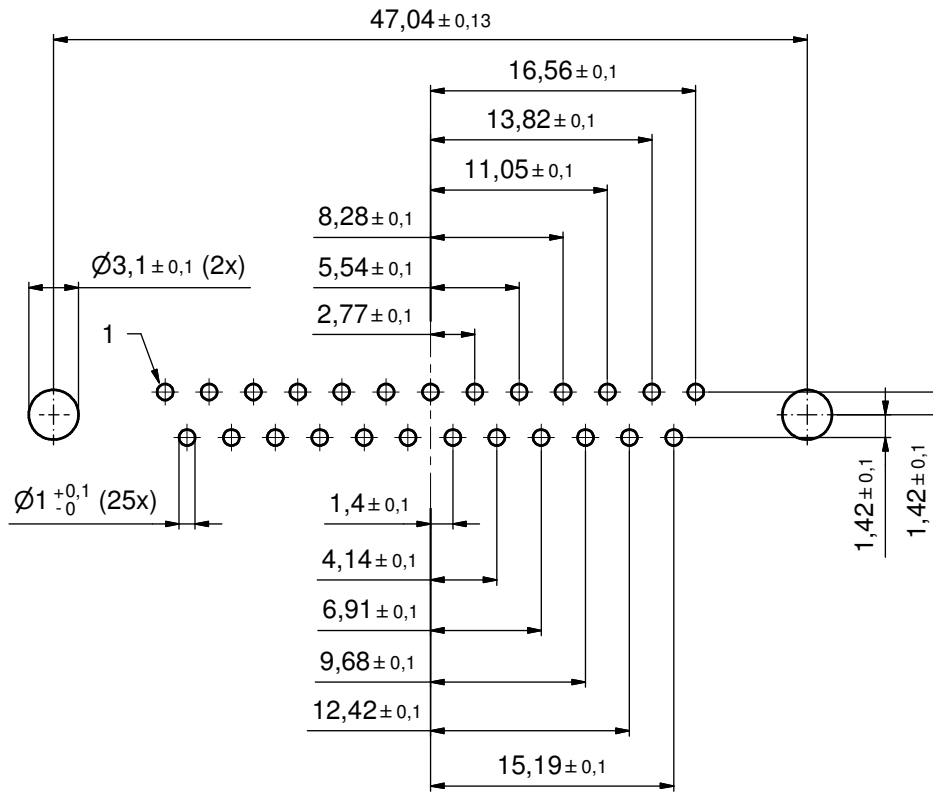

P.C.B. HOLE DRILLINGS
(P.C.B. TOP SIDE)

THIS DRAWING MAY NOT BE COPIED OR REPRODUCED IN ANY WAY, AND MAY NOT BE PASSED ON TO A THIRD PARTY WITHOUT WRITTEN PERMISSION. OWNERSHIP AND COPYRIGHT OF CONEC GmbH DO NOT ALTER CAD DRAWING BY HAND				tolerance		scale: 2:1
				dim. in mm		material: SEE NOTES
	drawn	06.05.13	Henneboel	title:		
	appd.	06.05.13	Fischer	P.C.B. HOLE DRILLINGS		
	norm			D-SUB PI FILTER MALE 25pos. SOLDER PIN with thread spacer clip		
	d-old	24K1A930		dwg no:		DIN-A3
	a	Original			24K1A1439	
rev.	description	date	name	part no: SEE SHEET 1		
			CONEC [®]		sh:2/2	