

MATERIALS AND FINISHES

BODY: BRASS  
PLATED TRI-M

CENTER CONTACT: BRASS  
PLATED SILVER

INSULATOR: TEFLON

INSULATING SPACER: TEFLON

COUPLING NUT: BRASS  
PLATED NICKEL

O-RINGS: SILICONE RUBBER

PERFORMANCE REQUIREMENTS:  
FREQUENCY RANGE: 0-3800MHZ  
IMPEDANCE: 50 OHM  
WITHSTAND VOLTAGE(AC): 1500V @0.5mA  
VSWR: TYPE X TYPE T  
≤1.08(0-1GHz)  
≤1.10(1-2.2GHz)  
≤1.13(2.2-3GHz) ≤1.13(0-3.8GHz)  
PIM3(2X20W): ≤ -155dBc@1800MHZ  
WATER-PROOF: IP68 WHEN MATED

SEE TABLE: CONNECTORS SHIPPED  
WITH POLYETHYLENE DUST  
CAPS ON INTERFACE

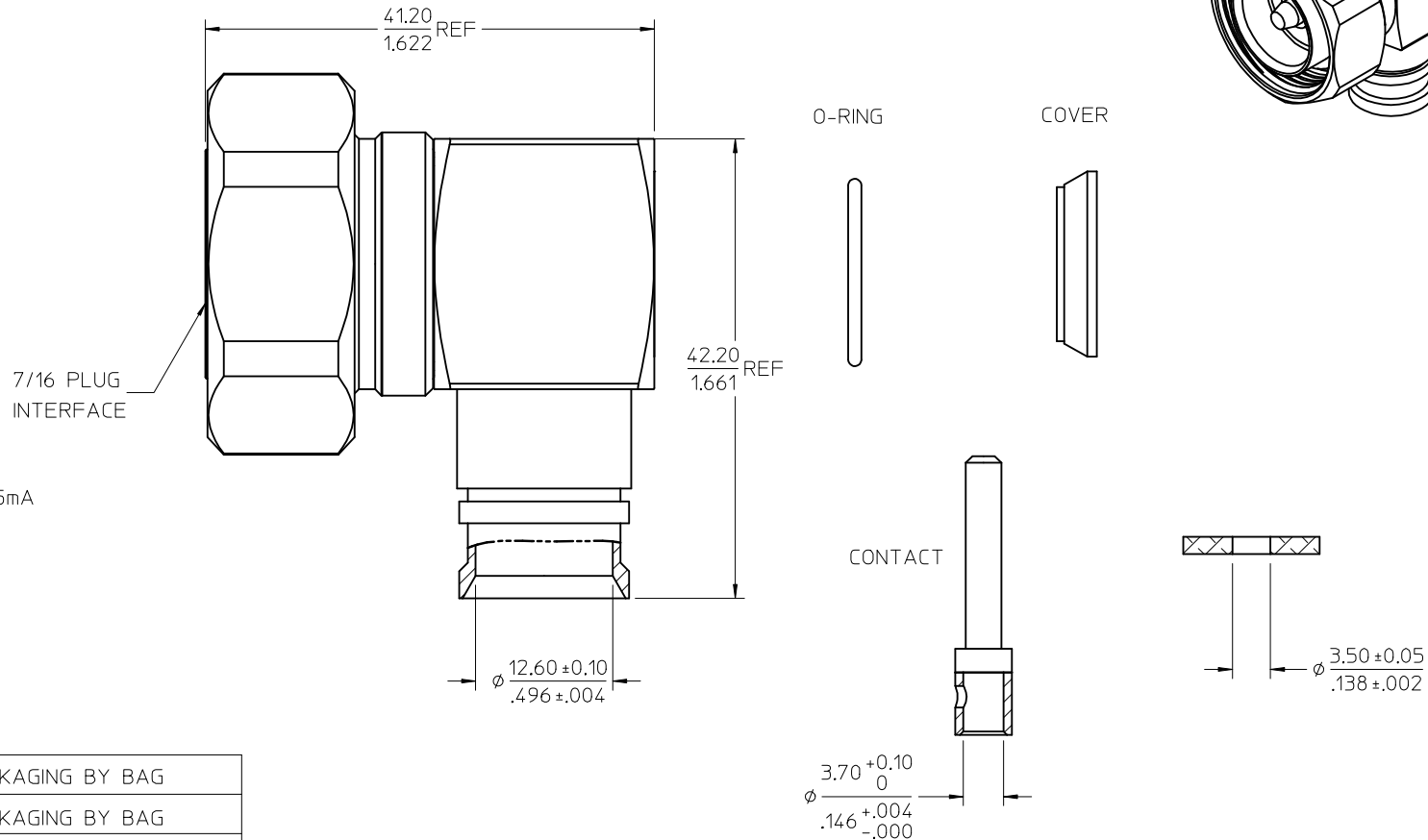
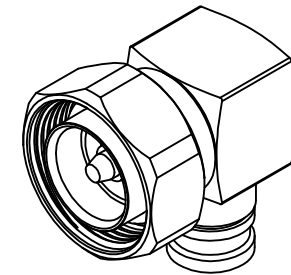

73134-2863	YES	PACKAGING BY BAG
73134-2862	YES	PACKAGING BY BAG
73134-2861	NO	PACKAGING BY BAG
73134-2860	NO	BLANK
PART NO.	DUST CAP	PACKAGING

IEC60169-4	INTERFACE
SPECIFICATION	DESCRIPTION

CHG: INNER CONTACT AND PACKAGING UPDATE EC NO: URF2017-0067 DRWN:YHUANG11 2016/09/13 CHKD: APPR:MYE08 2016/09/29 REV:	QUALITY SYMBOLS ▽=0 ▽=0	GENERAL TOLERANCES (UNLESS SPECIFIED)	DIMENSION STYLE MM/IN	SCALE	DESIGN UNITS METRIC	THIRD ANGLE PROJECTION															
		<table border="1"> <tr> <th></th> <th>mm</th> <th>INCH</th> </tr> <tr> <td>4 PLACES</td> <td>± ---</td> <td>± ---</td> </tr> <tr> <td>3 PLACES</td> <td>± ---</td> <td>± ---</td> </tr> <tr> <td>2 PLACES</td> <td>± ---</td> <td>± ---</td> </tr> <tr> <td>1 PLACE</td> <td>± ---</td> <td>± ---</td> </tr> </table>		mm	INCH	4 PLACES	± ---	± ---	3 PLACES	± ---	± ---	2 PLACES	± ---	± ---	1 PLACE	± ---	± ---	DRAWN BY: LCHEN03 DATE: 2015/07/02 CHECKED BY: YHUANG11 DATE: 2015/07/02 APPROVED BY: DATE:	TITLE 7/16 PLUG R/A,SOLDERING FOR 1/2*SF CABLE 7/16-P		
		mm	INCH																		
	4 PLACES	± ---	± ---																		
3 PLACES	± ---	± ---																			
2 PLACES	± ---	± ---																			
1 PLACE	± ---	± ---																			
	ANGULAR ± 2 °	DRAFT WHERE APPLICABLE MUST REMAIN WITHIN DIMENSIONS	MATERIAL NO. SEE TABLE	DOCUMENT NO. SD-73134-286	SHEET NO. 1 OF 2																
			THIS DRAWING CONTAINS INFORMATION THAT IS PROPRIETARY TO MOLEX INCORPORATED AND SHOULD NOT BE USED WITHOUT WRITTEN PERMISSION																		

STEP 1

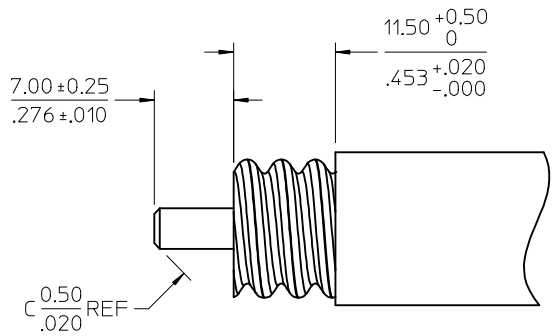

1/2SF CABLE  
RECOMMENDED STRIP DIMENSIONS

STEP 2

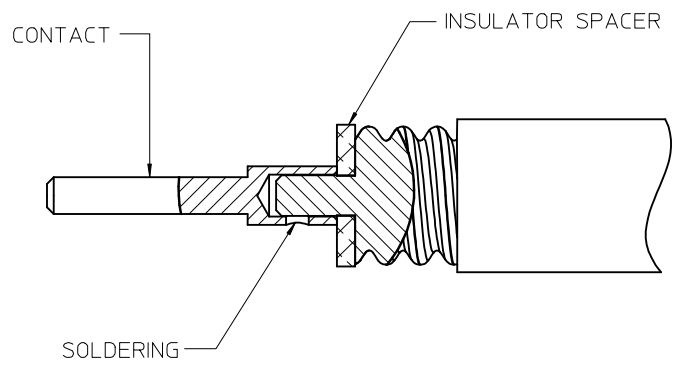

STEP 4

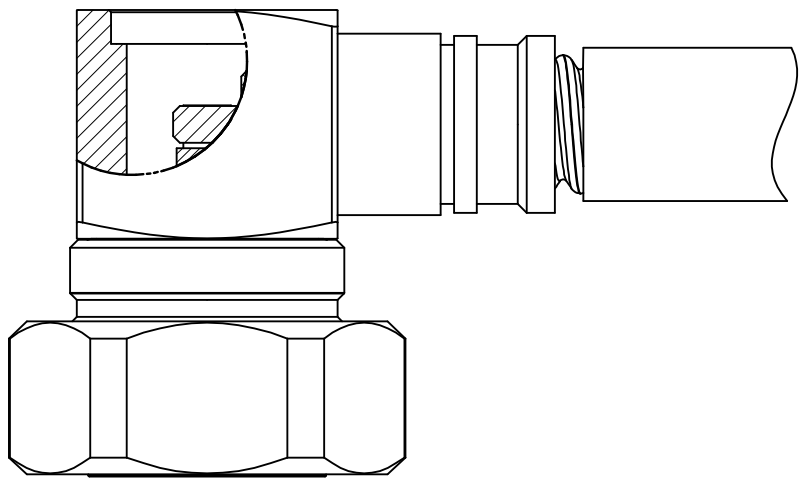
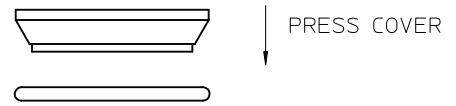

STEP 3

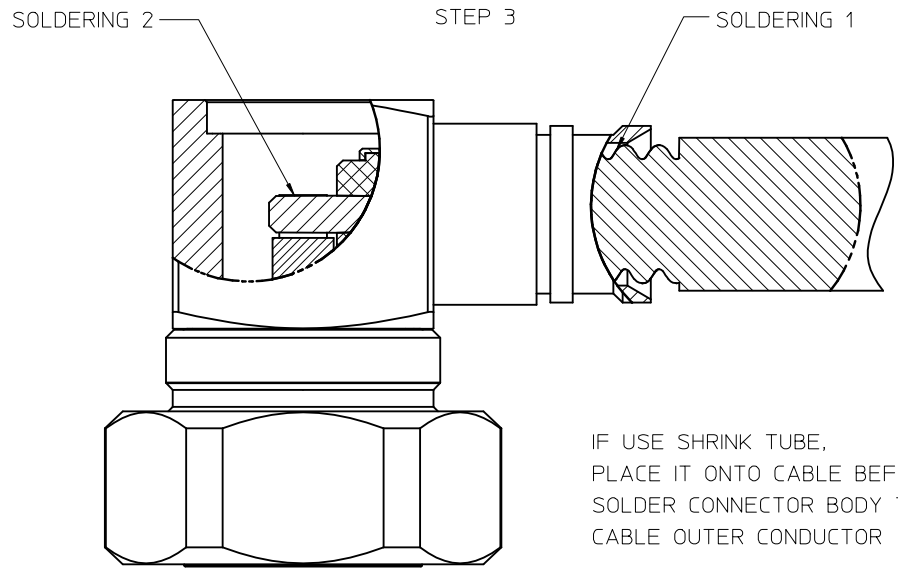

CHG: SEE SHEET 1 EC NO: URF2017-0067 DRAWN: HUANG11 2016/09/13 CHKD: APPR: MYE08 2016/09/29	DESCRIPTION	QUALITY SYMBOLS	GENERAL TOLERANCES (UNLESS SPECIFIED)	DIMENSION STYLE	SCALE	DESIGN UNITS	THIRD ANGLE PROJECTION																
		$\nabla = 0$ $\nabla = 0$ $\nabla = 0$	<table border="1"> <tr> <th></th> <th>mm</th> <th>INCH</th> </tr> <tr> <td>4 PLACES</td> <td>± ---</td> <td>± ---</td> </tr> <tr> <td>3 PLACES</td> <td>± ---</td> <td>± ---</td> </tr> <tr> <td>2 PLACES</td> <td>± ---</td> <td>± ---</td> </tr> <tr> <td>1 PLACE</td> <td>± ---</td> <td>± ---</td> </tr> <tr> <td>0 PLACE</td> <td>± ---</td> <td>± ---</td> </tr> </table>		mm	INCH	4 PLACES	± ---	± ---	3 PLACES	± ---	± ---	2 PLACES	± ---	± ---	1 PLACE	± ---	± ---	0 PLACE	± ---	± ---	MM/IN	3:1
	mm	INCH																					
4 PLACES	± ---	± ---																					
3 PLACES	± ---	± ---																					
2 PLACES	± ---	± ---																					
1 PLACE	± ---	± ---																					
0 PLACE	± ---	± ---																					
B2	REV	ANGULAR ± 2°	DRAFT WHERE APPLICABLE MUST REMAIN WITHIN DIMENSIONS	DRAWN BY: LCHEN03 DATE: 2015/07/02 CHECKED BY: YHUANG11 DATE: 2015/07/02 APPROVED BY: _____ DATE: _____	TITLE 7/16 PLUG R/A, SOLDERING FOR 1/2SF CABLE 7/16-P		SHEET NO. 2 OF 2																
MATERIAL NO. SEE TABLE			DOCUMENT NO. SD-73134-286																				
THIS DRAWING CONTAINS INFORMATION THAT IS PROPRIETARY TO MOLEX INCORPORATED AND SHOULD NOT BE USED WITHOUT WRITTEN PERMISSION																							