

PRODUCT NUMBER SEE SHEET 2

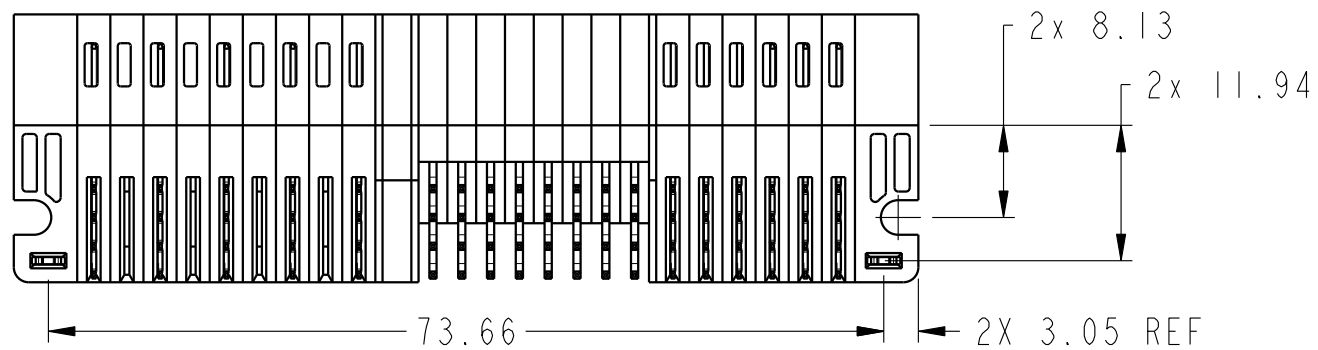

spec ref	dr	2017/06/01	projection	MM	size	A3	scale	3:2
tolerance std	eng	2019/06/10			ecn no	ELX-DG-33863-1	rel level	Released
ISO 406 ISO 1101	chr	-						
surface	appr	2019/06/11	Amphenol FCI		title	9LP + 32S + 6LP		rev
ISO 1302			linear	0.X	±0.5	RA STB PLUG		D
			angular	0°	±2°	cat. no.	Product - Customer Drw	
					dwg no	10106262-0F08001		sheet 1 of 3

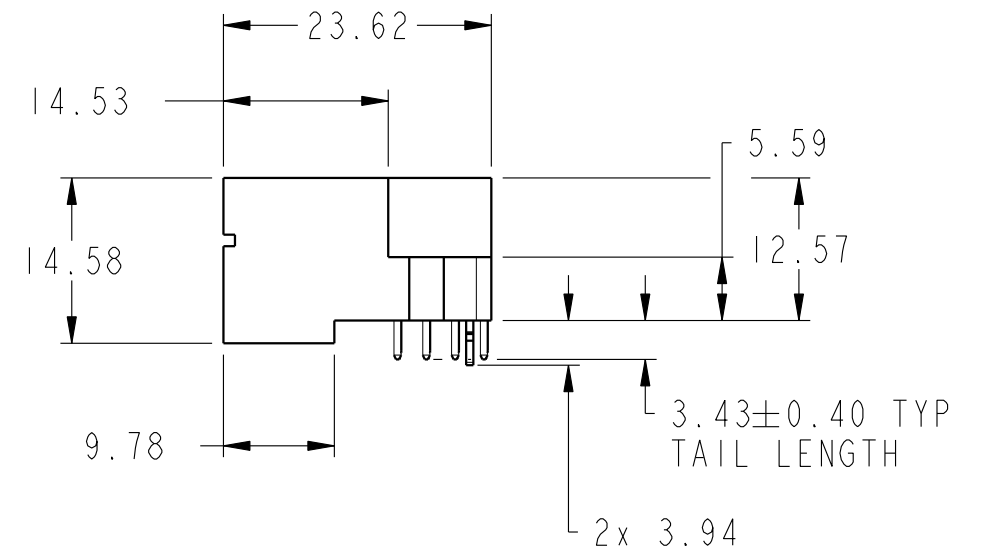
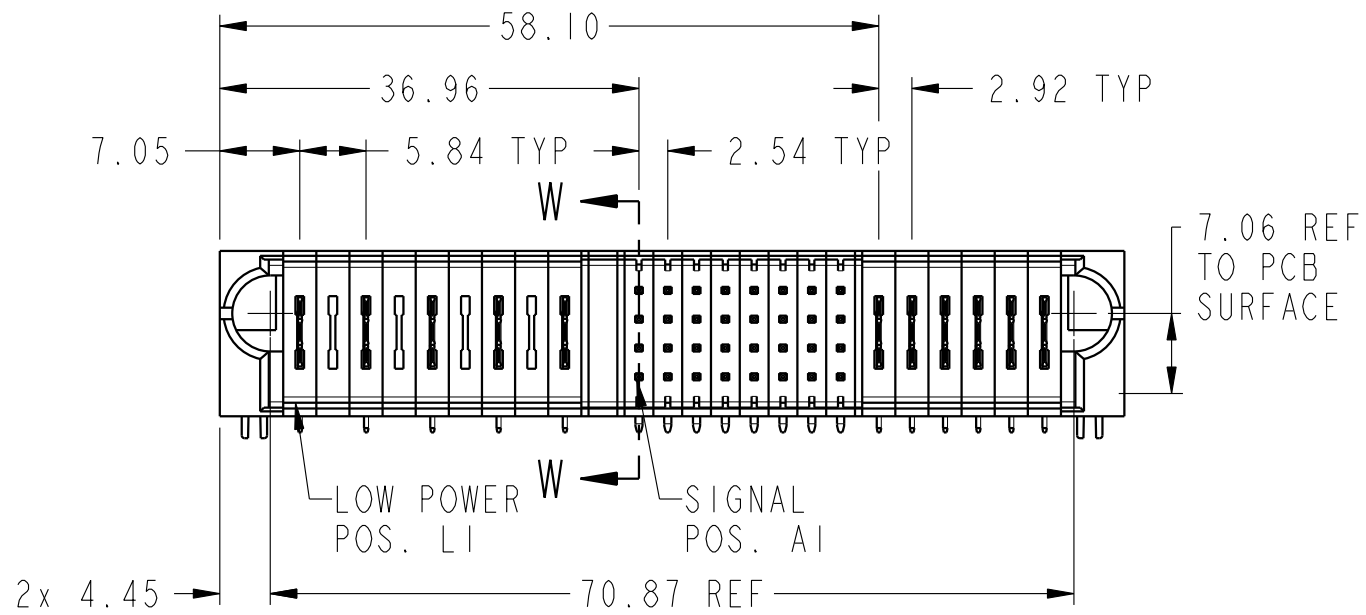
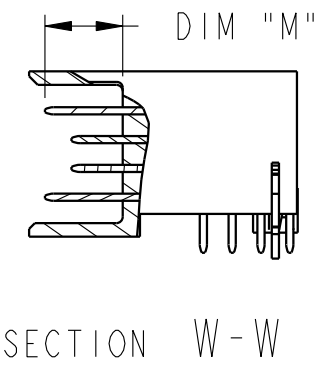
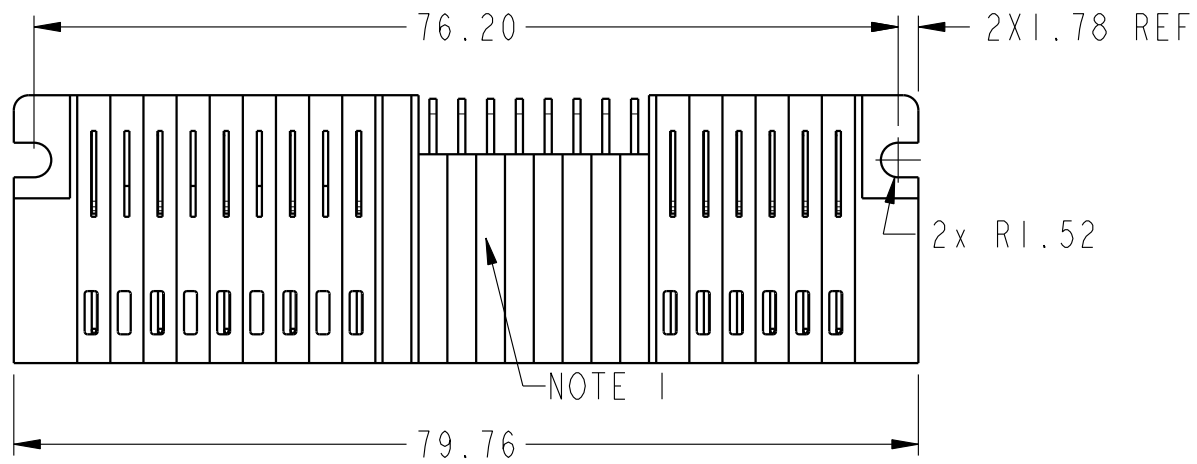
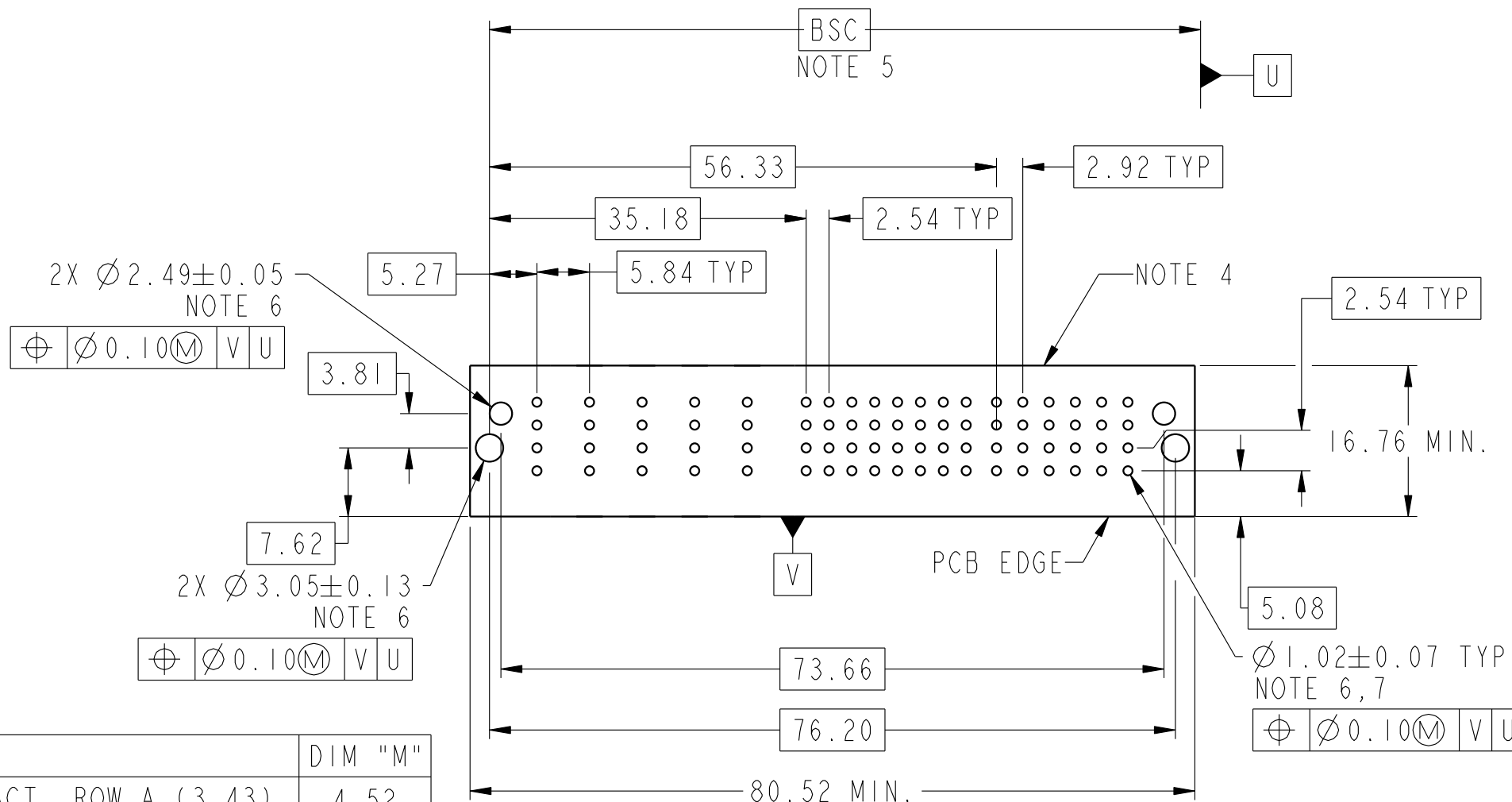
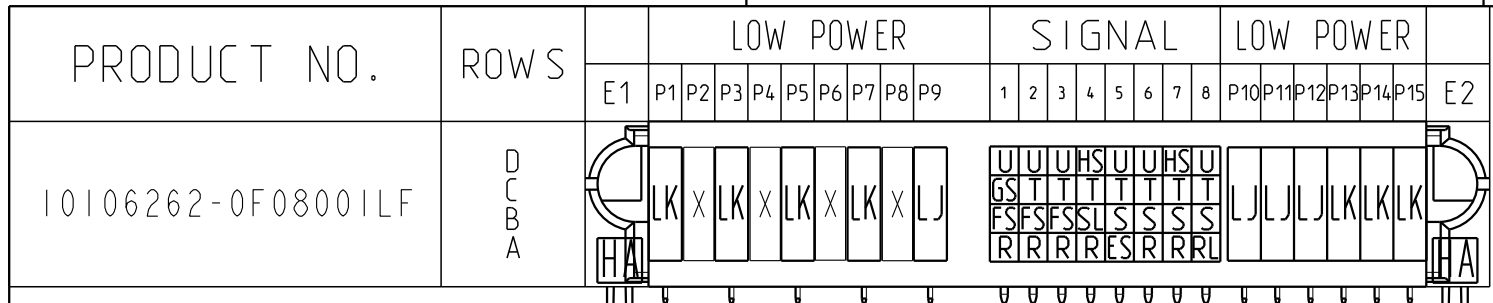

CODE	DESCRIPTION	DIM "M"
ES	MLBF2 SIGNAL CONTACT, ROW A (3.43)	4.52
FS	MLBF2 SIGNAL CONTACT, ROW B (3.43)	4.52
GS	MLBF2 SIGNAL CONTACT, ROW C (3.43)	4.52
HA	METAL HOLD DOWN	NA
HS	MLBF2 SIGNAL CONTACT, ROW D (3.43)	4.52
LJ	MFBL LOW POWER CONTACT (3.43)	NA
LK	STD LOW POWER CONTACT (3.43)	NA
R	STD SIGNAL CONTACT, ROW A (3.43)	6.86
RL	MFBL SIGNAL CONTACT, ROW A (3.43)	7.82
S	STD SIGNAL CONTACT, ROW B (3.43)	6.86
SL	MFBL SIGNAL CONTACT, ROW B (3.43)	7.82
T	STD SIGNAL CONTACT, ROW C (3.43)	6.86
U	STD SIGNAL CONTACT, ROW D (3.43)	6.86
X	OMITTED	NA

spec ref	dr	2017/06/01
tolerance std	eng	2019/06/10
ISO 406	chr	-
ISO 1101	appr	Zheng, Pei-Min 2019/06/11
TOLERANCES UNLESS OTHERWISE SPECIFIED		
surface	linear	0.X ±0.5
		0.XX ±0.25
	angular	0° ±2°

projection	MM	size	A3	scale	3:2
product family	PwrBlade+	ecn no	ELX-DG-33863-1	rel level	Released
Amphenol FCI	title	9LP + 32S + 6LP		dwg no	10106262-0F08001
	RA STB PLUG	cat. no.	Product - Customer Drw	rev	D
sheet 2 of 3			PDS: Rev :D		

Amphenol FCI

© 2016 AFCI

NOTES:

- 1) PRODUCT MARK:
PART NUMBER AND DATE CODE TO BE MARKED ON THIS SURFACE .
THE MARK CAN BE OMITTED IF THERE IS NOT ENOUGH SPACE ON THIS SURFACE.
- 2) MATERIALS:
-HOUSING : HIGH TEMP THERMOPLASTIC WITH GLASS FIBER, UL94V-0, BLACK.
-POWER CONTACT : HIGH CONDUCTIVITY COPPER ALLOY.
-SIGNAL CONTACT : COPPER ALLOY.
- 3) PLATING SPECIFICATION : 10116351
- 4) DENOTES CONNECTOR KEEP OUT ZONE.
- 5) DATUM AND BASIC DIMENIONS ARE ESTABLISHED BY CUSTOMER.
- 6) ALL HOLE DIAMETERS ARE FINISHED HOLE SIZES.
- 7) 1.15+/-0.025MM DRILLED HOLE PLATED WITH 0.00762MM MIN SN
OVER 0.0254-0.0762MM CU PLATING TO ACHIEVE A 1.02+/-0.07MM HOLE.
- 8) THE HOUSING WILL WITHSTAND EXPOSURE TO 265 °C PEAK TEMPERATURE
FOR 10 SECONDS IN A WAVE SOLDER APPLICATION.
- 9) THIS PRODUCT MEETS EUROPEAN UNION DIRECTIVES AND OTHER COUNTRY
REGULATIONS AS DESCRIBED IN GS-47-0004.
- 10) PRODUCT SPECIFICATION : GS-12-658.
APPLICATION SPECIFICATION : GS-20-141.
PRODUCT PACKAGE SPECIFICATION: GS-14-1502.

Amphenol
FCi

© 2016 AFCI

spec ref		dr	Rainbow Zhan	2017/06/01	projection	MM	size	A3	scale	3:2		
tolerance std		eng	Rainbow Zhan	2019/06/10		←→	ecn no		ELX-DG-33863-1			
ISO 406 ISO 1101		chr	-	-			product family		PwrBlade+		rel level	Released
surface	linear	0.X	±0.5		Amphenol FCi	title	9LP + 32S + 6LP		dwg no	10106262-0F08001	rev	D
		0.XX	±0.25									
0.XXX	±0.10											
ISO 1302	angular	0°	±2°		cat. no.	Product - Customer Drw		sheet 3 of 3				