

## Mechanical Dimensions: Inches [mm]

Tolerances  $\pm 0.012$  [0.3] Unless Otherwise Specified

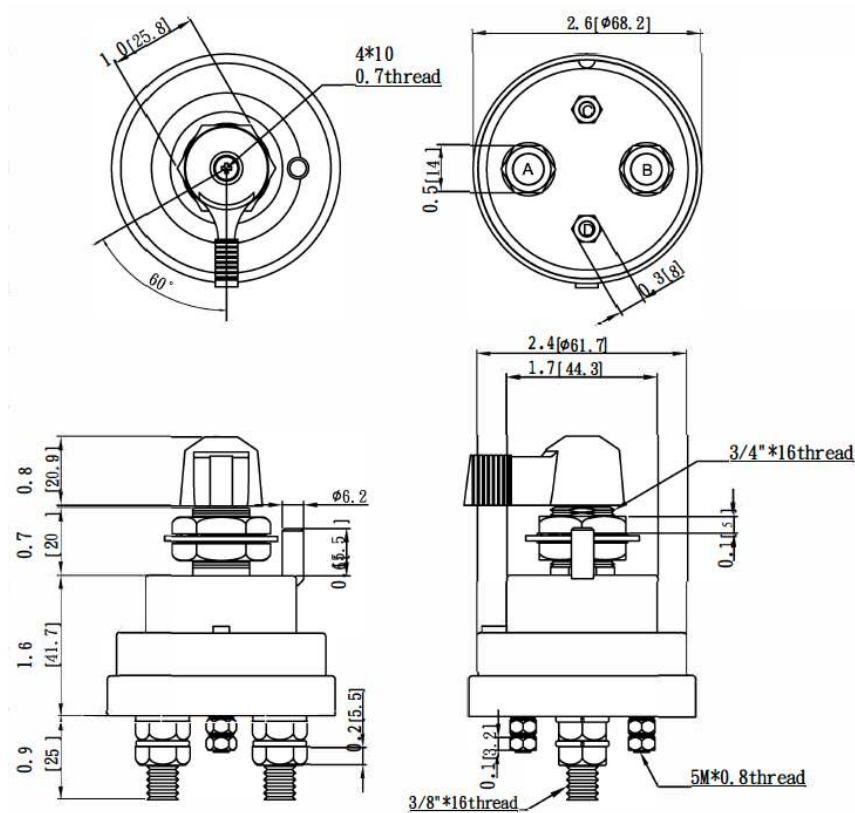

## Mounting Hole

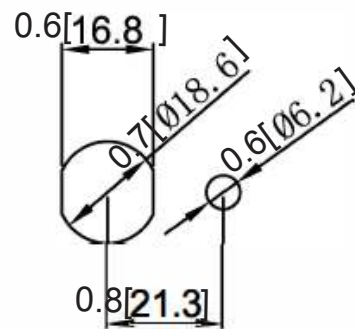

## Circuit Diagram

**DPST:** For battery and alternator or generator field circuit.

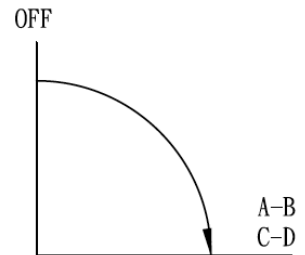

## Electrical Specifications

<b>Continuous Rating</b>	180A 6-36VDC (Large Studs), 20A 6-36VDC (Small Studs)
<b>Intermittent Rating</b>	1000A for 15secs intervals
<b>Insulation Resistance</b>	DC 500V 100M ohm Min
<b>Dielectric Strength</b>	AC 1000V 1 minute
<b>Operation Temperature</b>	-40°C~85°C

## Material Specifications

- Zinc diecast construction
- Sealed with O-rings at base and mounting stem
- Copper, Silver plated terminals

Rev	Date of issue	Revision Notes	Designed	Approved
A	11-21-2019	Initial Drawing	RC	OF