

REVISIONS					
P	LTR	DESCRIPTION	DATE	DWN	APVD
B		REVISED PER ECO-14-015720	16OCT2014	DD	WW
B1		REVISED PER ECO-20-012417	14SEP2020	AP	WW
B2		REVISED PER ECN-22-145617	23JUN2022	AP	MT

NOTES:

MATERIAL: TYPE I - CA260 BRASS FULL HARD.
MATERIAL: TYPE II - CA425 ALLOY EXTRA HARD.
APPLICATIONS OF TERMINALS MUST MEET ALL REQUIREMENTS DEFINED IN COAF-14A121-A
FOR TERMINAL CRIMPING SPECIFICATIONS SEE ES-E43B-144T4-A

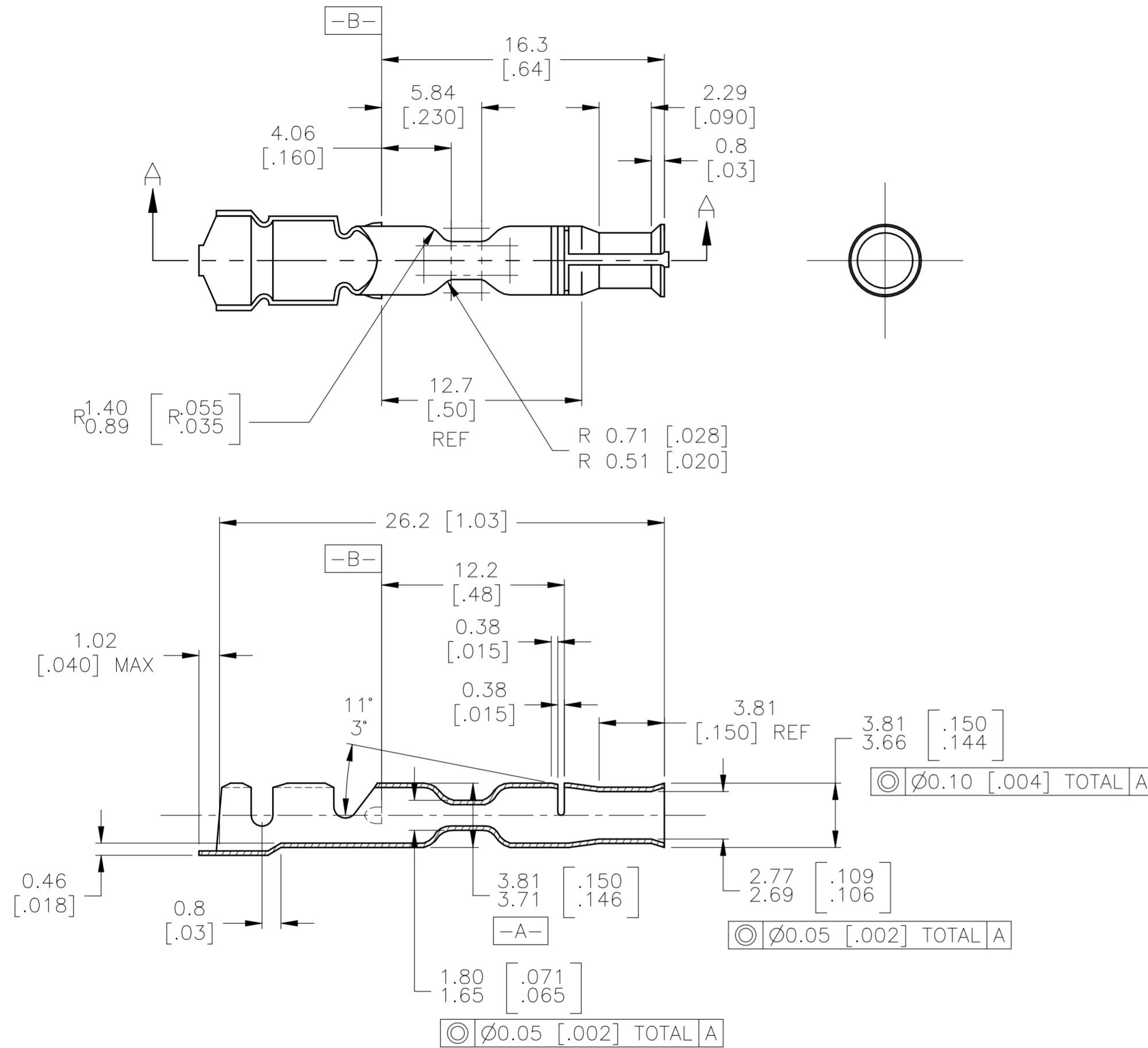

SECTION A-A

	16	HOT TIN DIP	I	D9AB-14488-PA	1438248-4
	14	HOT TIN DIP	II	D1AB-14488-CA	1438248-3
OBSOLETE	13	HOT TIN DIP	I	D9AB-14488-MA	1438248-2
OBSOLETE	18	HOT TIN DIP	I	D9AB-14488-NA	1438248-1
GRIP CODE		FINISH	MATERIAL TYPE	CUSTOMER P/N	TE ELECTRONICS P/N

THIS DRAWING IS A CONTROLLED DOCUMENT.		DWN	11 JUNE 2003		TE Connectivity		
DIMENSIONS: mm		CHK	DM REVAK 11 JUNE 2003		NAME		
TOLERANCES UNLESS OTHERWISE SPECIFIED:		APVD	DM REVAK 11 JUNE 2003		TERMINAL-PIN RECEPTACLE (STRAIGHT)		
0 PLC ± - 1 PLC ± - 2 PLC ± 0.25 3 PLC ± 0.13 4 PLC ± - ANGLES ± 3°		PRODUCT SPEC			SIZE CAGE CODE DRAWING NO RESTRICTED TO		
MATERIAL SEE TABLE		FINISH ESB-MIP9-A		WEIGHT	0.000000	A2 00779 C=1438248	
CUSTOMER DRAWING				SCALE	4:1	SHEET 1 OF 1	
				REV	B2		