

NOTES:

1. MATERIALS AND FINISHES(PLATING THICKNESS IN MICRO-INCHES):
 BODY - BERYLLIUM COPPER, WHITE BRONZE PLATING (COPPER-TIN-ZINC)
 CONTACT - BERYLLIUM COPPER, GOLD PLATING
 INSULATOR - PTFE
2. ELECTRICAL:
 A. IMPEDANCE: 50 OHM
 B. FREQUENCY RANGE: DC 0- 4 GHz
 C. VSWR(RETURN LOSS): 1.5 MAX.
 C. DIELECTRIC WITHSTANDING VOLTAGE: 1000 VRMS, MIN
3. MECHANICAL:
 A. DURABILITY: 500 CYCLES MIN.
 B. TEMPERATURE RANGE: -40°C TO +155°C
4. OTHER
 A. CRIMPED FERRULE: HEX CRIMP SIZE .128"
 B. SOLDER CONTACT CONDUCTOR

THIRD ANGLE PROJ.

REVISIONS

REV	DESCRIPTION	DATE	ECO	APPR
A	RELEASE TO MFG.	8/8/06	46108	CISSY
B	CHANGE NOTE 3 "0.005" TO "0.12"; 13.28 WAS 13.36; 9.03 WAS 10.11; ADD NOTE WITH ARROWS ITEM 2 & ITEM 1 MUST BOTT AGAINST ITEM 6 AS SHOWN, AND ITEM 6 WAS CHANGED	9-16-06	46257	JEKY
C	TRANSFER TO ARFA	29-Mar-11	48515	SH
D	FERRULE, BARREL WERE CHANGED/RD-DA11070801L2	06-Jul-11	48694	SH
E	NO CHANGE TO COD	14-Oct-17	05562	MZ

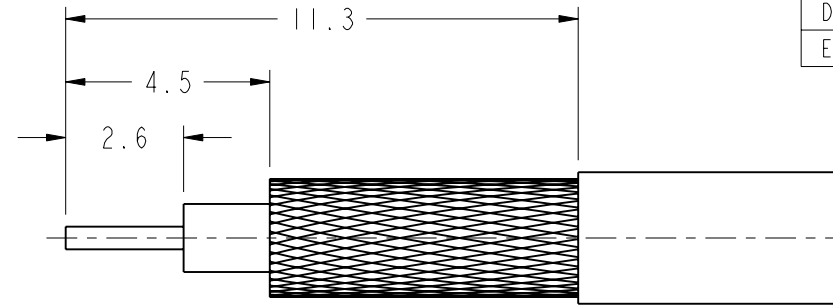

RECOMMENDED
CABLE STRIPPING DIM'S

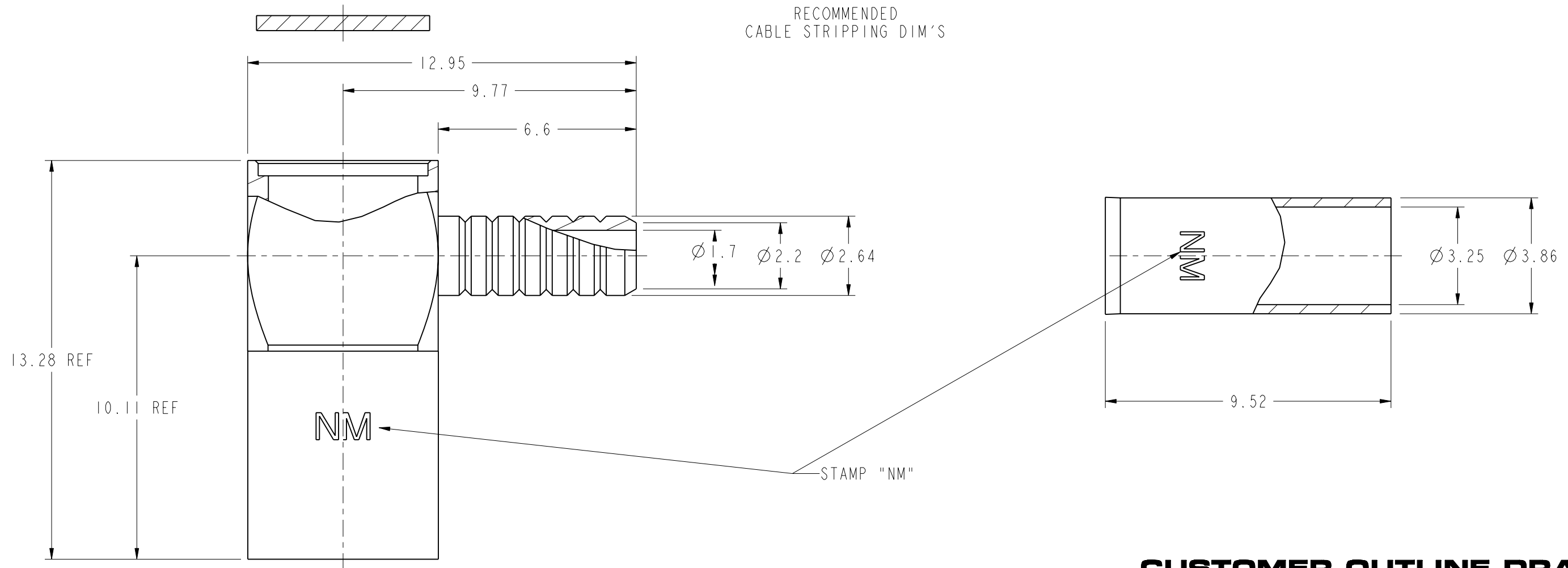

CUSTOMER OUTLINE DRAWING
ALL OTHER SHEETS ARE FOR INTERNAL USE ONLY

UNLESS OTHERWISE SPECIFIED, DIMENSIONS ARE IN METRIC AND TOLERANCES ARE:
 <0.5mm ±0.05mm 0.5 - 6mm ±0.1mm 6 - 30mm ±0.2mm 30 - 120mm ±0.3mm ANGLES ±1°

NOTICE - These drawings, specifications, or other data (1) are, and remain the property of Amphenol corp. (2) must be returned upon request; and (3) are confidential and not to be disclosed to any person other than those to whom they are given by Amphenol Corp. the furnishing of these drawings, specifications, or other data by Amphenol Corp., or to any other person for any purpose is not to be regarded by implication or otherwise in any manner licensing, granting rights to permitting such holder or any other person to manufacture, use or sell any product, process or design, patented or otherwise, that may in any way be related to or disclosed by said drawings, specifications, or other data.

MATERIAL	DRAWN	DATE	TITLE	Amphenol RF Danbury CT USA, Tainan, Taiwan, Shenzhen, China www.amphenolrf.com
	K. SONG	23-Oct-17		
REFERENCE 903-289-51A	ENGINEER	DATE	SCALE: 7.0:1.0	DRAWING NO. 903-NM289P-51A
	GEFFERY	16-Sep-06		SHEET 2 OF 2
FINISH	APPROVED	DATE	DWG SIZE	PART NO. 903-NM289P-51A
	S. HSIEH	24-Oct-17		
	CAD FILE		REV	
			E	