

© - TE Connectivity. All Rights Reserved.

REVISIONS				
P	LTR	DESCRIPTION	DATE	APVD
	F1	REVISED PER ECN-22-156403	03JUN2022	RK CSD

AMP
WIRE RANGE

26 AWG
STRANDED

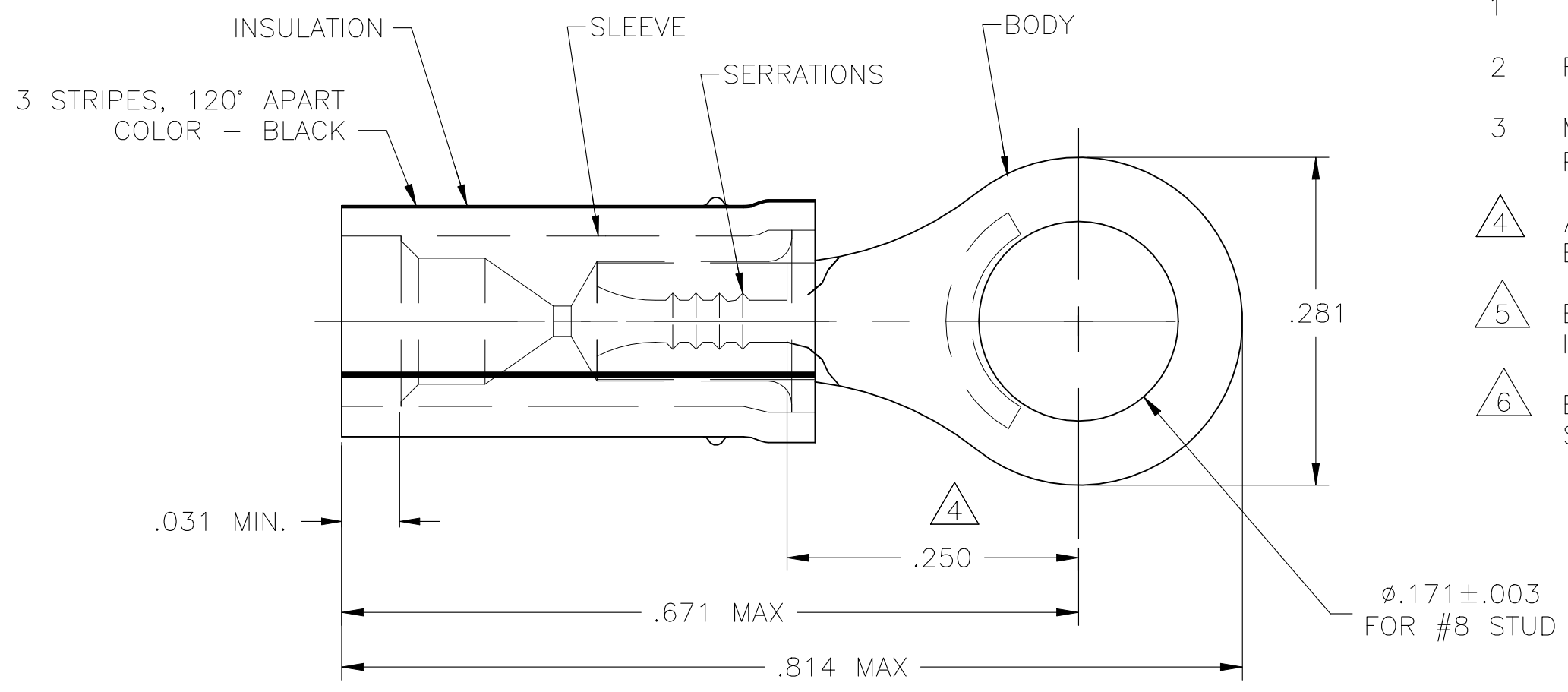

- 1 TONGUE MATERIAL THK: $.027 \pm .001$.
- 2 FOR $.026$ TO $.055$ WIRE INS. OD.
- 3 MUST BE CRIMPED WITH 22-18 OR 22-16. PIDG (RED) TOOL.
- 4 APPLIED FROM EDGE OF METAL WIRE BARREL TO CENTER OF STUD HOLE.
- 5 BODY & SLEEVE: CU PER ASTM B152 INSULATION: NYLON, COLOR - YELLOW.
- 6 BODY; TIN PLATE PER ASTM B545 SLEEVE: NI PLATE PER QQ-N-290.

M7928/1-4 CLASS 1	1	WIRE TERMINAL	53051
MILITARY P/N AND CLASS	QTY	PACKAGE TYPE	PART NO

**AMP INCORPORATED
CUSTOMER SERVICE SYSTEMS**

MAX RECOMMENDED OPERATING TEMPERATURE:
105°C [221°F]

VOLTAGE RATING:
300V MAX

CIRCULAR MIL AREA:
0.12-0.15mm² [238-304]
STRANDED

FOR ADDITIONAL PRODUCT INFORMATION OR COPIES OF DRAWINGS AND TECHNICAL DOCUMENTS
PRODUCT INFORMATION CENTER
1-800-522-6752

FOR APPLICATION TOOLING ASSISTANCE CENTER
TOOLING INFORMATION
1-800-722-1111

FOR ORDER ENTRY
1-800-526-5142

THIS DRAWING IS A CONTROLLED DOCUMENT FOR AMP INCORPORATED. IT IS SUBJECT TO CHANGE AND THE CONTROLLING ENGINEERING ORGANIZATION SHOULD BE CONTACTED FOR THE LATEST REVISION.

THIS DRAWING IS A CONTROLLED DOCUMENT.

DIMENSIONS: INCHES

TOLERANCES UNLESS OTHERWISE SPECIFIED:

0 PLC	± -
1 PLC	± -
2 PLC	± .008
3 PLC	± -
4 PLC	± -
ANGLES	± -

MATERIAL

FINISH

5

6

DWN JR RUTH 28OCT08

CHK TOM MICHIELUTTI 28OCT08

APVD TOM MICHIELUTTI 28OCT08

NAME

PRODUCT SPEC

APPLICATION SPEC

WEIGHT -

SIZE A3 CAGE CODE 00779 DRAWING NO C-53051 RESTRICTED TO -

CUSTOMER DRAWING SCALE 8:1 SHEET 1 OF 1 REV F1

STE TE Connectivity

TERMINAL, PIDG, RING TONGUE,
INSULATION RESTRICTING
WIRE SIZE: 26