



COAXIAL

# Adapter

## SF-35M50+

50Ω DC to 26.5 GHz SMA Female to 3.5mm-Male

### FEATURES

- Flat response
- Excellent VSWR, 1.08 typ
- Low cost adapters, available from stock
- Rugged stainless steel body, passivated
- 3.5 mm connector mates with SMA, K and 2.92 mm connectors



Generic photo used for illustration purposes only

<b>Model No.</b>	SF-35M50+
<b>Case Style</b>	DJ1735
<b>Connectors</b>	SMA Female to 3.5mm-M

### +RoHS Compliant

The +Suffix identifies RoHS Compliance. See our website for methodologies and qualifications

### APPLICATIONS

- Connector saver
- Cable extender

### ELECTRICAL SPECIFICATIONS $T_{AMB}=25^{\circ}C$

Parameter	Condition (GHz)	Min.	Typ.	Max.	Units
Frequency Range	-	DC	-	26.5	GHz
Insertion Loss	DC - 26.5	-	0.1	—	dB
VSWR	DC - 8	-	1.04	1.25	:1
	DC - 18	-	1.08	1.25	
	DC - 26.5	-	1.10	1.26	

### ABSOLUTE MAXIMUM RATINGS

Parameter	Ratings
Operating Temperature	-55°C to 85°C
Storage Temperature	-55°C to 85°C

Permanent damage may occur if any of these limits are exceeded.

REV. B  
ECO-016626  
SF-35M50+  
MCL NY  
230125





COAXIAL

# Adapter

**SF-35M50+**

Mini-Circuits

50Ω DC to 26.5 GHz SMA Female to 3.5mm-Male

## OUTLINE DRAWING

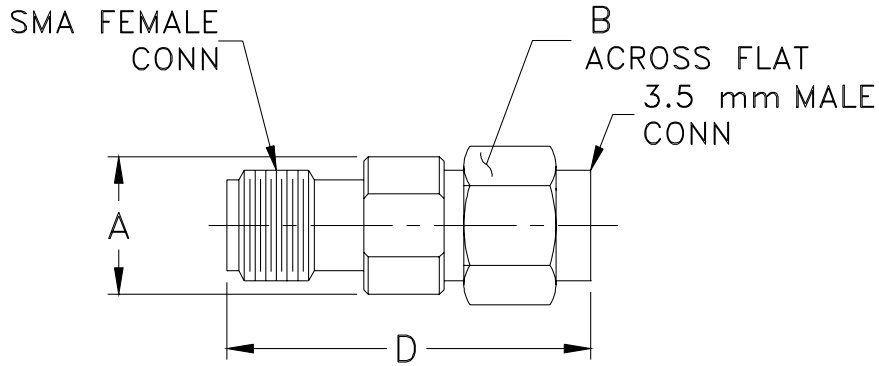

## OUTLINE DIMENSIONS (Inch/mm)

A	B	C	D	E	wt
.311	.31	--	.83	--	grams
7.90	8	--	21	--	3.0



COAXIAL

# Adapter

## SF-35M50+

Mini-Circuits

50Ω DC to 26.5 GHz SMA Female to 3.5mm-Male

### TYPICAL PERFORMANCE DATA

Frequency (GHz)	Insertion Loss (dB)	VSWR (:1)	
		SMA-F	3.5mm-M
0.05	0.01	1.00	1.00
0.1	0.01	1.00	1.00
0.5	0.00	1.01	1.00
1	0.01	1.01	1.01
2	0.02	1.03	1.01
3	0.03	1.02	1.02
4	0.04	1.02	1.04
5	0.04	1.04	1.07
10	0.08	1.11	1.08
15	0.10	1.01	1.04
16	0.09	1.06	1.09
18	0.14	1.18	1.20
20	0.09	1.06	1.15
22	0.13	1.07	1.05
24	0.12	1.04	1.04
25	0.14	1.09	1.07
26	0.16	1.10	1.11
26.5	0.34	1.16	1.17

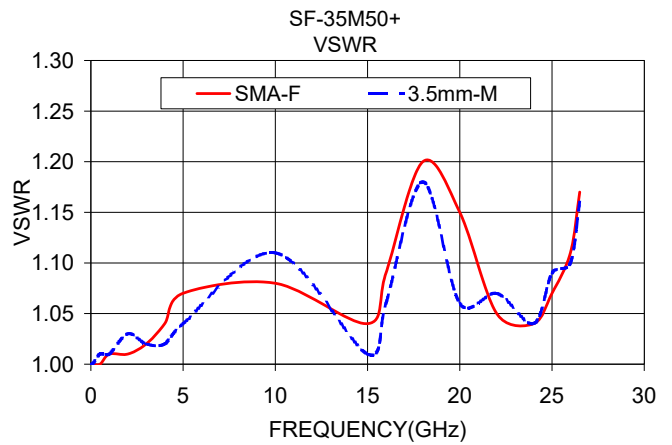
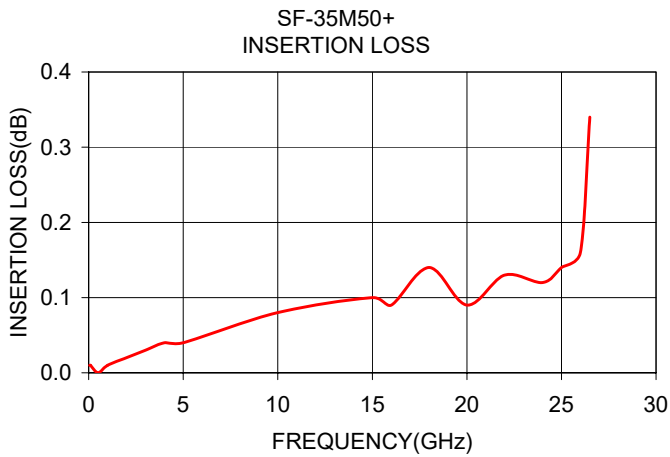

#### NOTES

- A. Performance and quality attributes and conditions not expressly stated in this specification document are intended to be excluded and do not form a part of this specification document.
- B. Electrical specifications and performance data contained in this specification document are based on Mini-Circuit's applicable established test performance criteria and measurement instructions.
- C. The parts covered by this specification document are subject to Mini-Circuits standard limited warranty and terms and conditions (collectively, "Standard Terms"); Purchasers of this part are entitled to the rights and benefits contained therein. For a full statement of the standard terms and the exclusive rights and remedies thereunder, please visit Mini-Circuits' website at [www.minicircuits.com/terms/viewterm.html](http://www.minicircuits.com/terms/viewterm.html)

