

THIS DRAWING IS UNPUBLISHED. RELEASED FOR PUBLICATION BY AMP INCORPORATED. ALL INTERNATIONAL RIGHTS RESERVED. COPYRIGHT 1983

LOC	QTY	REV	DATE	APP
G	14			
REVISED PER 0720-0230-93				

METPRIO
DIMENSIONS LISTED IN mm [INCHES]

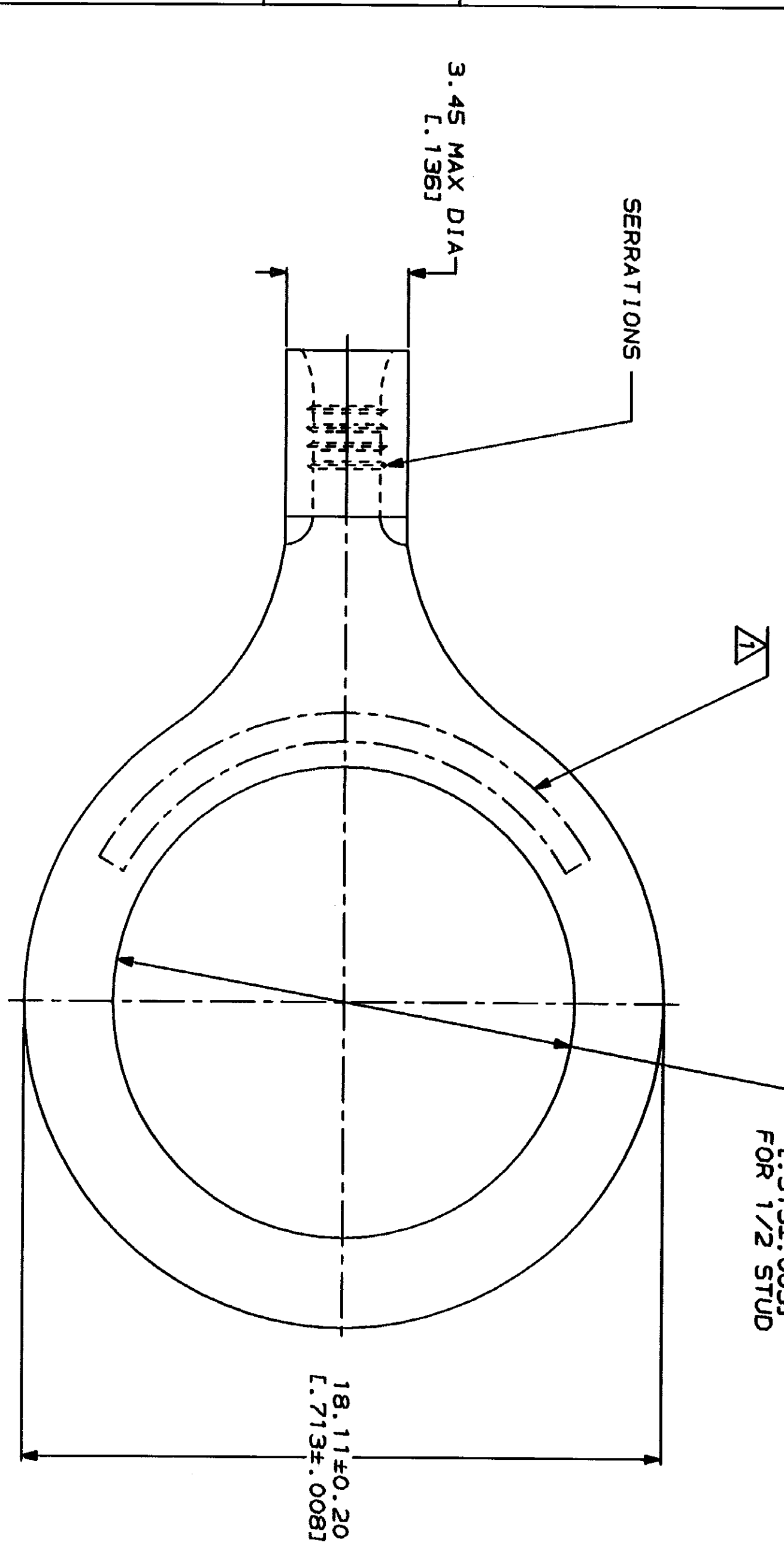

AMP WIRE RANGE 22-16 AWG STRAINED	UL E13288 Listed
● LR7189 Certified	MILITARY P/N AND CLASS
NOT CERTIFIED	NOT APPLICABLE

△ STAMP AMP 22-18* APPROX AS SHOWN
22-16 TERMINALS ARE STAMPED 22-18 IN
ACCORDANCE WITH MILITARY SPECIFICATION
MIL-T-7928, COMMERCIAL WIRE RANGE IS 22-16

AMP INCORPORATED
CUSTOMER SERVICE SYSTEMS

FOR ADDITIONAL
PRODUCT INFORMATION OR
COPIES OF DRAWINGS
AND TECHNICAL DOCUMENTS

FOR APPLICATION
TOOLING INFORMATION
FOR ORDER ENTRY

MAX RECOMMENDED OPERATING
TEMPERATURE: 170°C MAX

VOLTAGE RATING:
NOT APPLICABLE

WIRE CROSS SECTIONAL AREA RANGE:
0.26-1.65mm² [509-3,260] CIR MILS
STRAINED

DO NOT SCALE PRINT.
UNLESS SPECIFIED
DIMENSIONS IN mm FINISHES
TOLERANCES ON:
2 PLC DEC # -
3 PLC DEC # -
ANGLES -
MATERIAL
COPPER PER
ASTM B-152
ANNEALED

FINISH
TIN PLATE
0.00254 [L.000100] MIN
THK PER MIL-T-10727

DR 2-4-93
TA BRINKMAN

CHK 2-4-93
DA PATTERSON

APPO 2-4-93
DE MILLER

AMP
AMP Incorporated
Harrisburg, PA 17185-3508

NAME
TERMINAL, RING TONGUE,
BUDGET

APPLICATION SPEC
SCALE 8:1
CAGE CODE 00779
DRAWING NO C-328970
SHEET 1 OF 1

AMP 1471-6 REV 3-82 28-FEB-94 15:14:37 0922453 /files/dept123/dwd123/w_bodies/w_22-16 CUSTOMER DRAWING