

LOC	DIST	REVISONS	DATE	DATE	DATE
CM	O	ECO-07-012878	20JUN07	KW	DB
FP	LINK	DESCRIPTION			
L	L	ECO-07-012878			

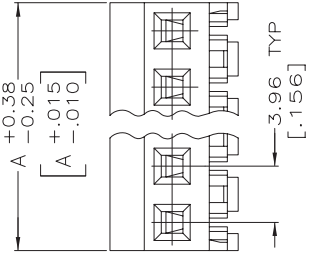
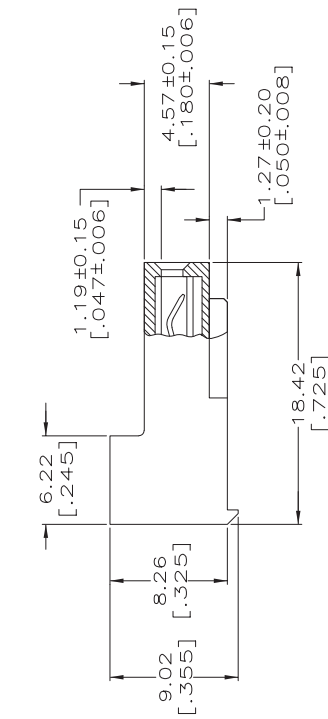
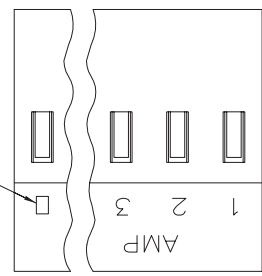

1. MATERIAL: CONNECTOR - NYLON UL94V-2 (ORANGE). CONTACTS - 0.30[.012] THICK COPPER ALLOY. PLATING - 0.00038[.000015] GOLD IN CONTACT AREA. 0.00203[.000080] MIN THICKNESS BRIGHT TIN LEAD IN SLOT AREA FOR 641153-2 THRU 2-641153-4 OR MATTE WHISKER MITIGATED TIN IN SLOT AREA FOR 3-641153-2 THRU 5-641153-4 OVER NICKEL UNDERPLATE.

2. CONTACTS ACCEPT 18 AWG WIRE WITH 2.41[.095] MAX INSULATION DIAMETER.

3. CONTACTS MUST ACCEPT 1.14±0.03[.045±.001] SQUARE POST AND REMAIN LOCKED IN POSITION.

4. IDENTIFICATION NUMBER FOR LAST CIRCUIT MAY NOT APPEAR ON ALL ASSEMBLIES.

5. DIMENSIONS IN BRACKETS ARE IN INCHES.

6. HOUSING FEATURES ARE: CLOSED END WITHOUT LOCKING RAMP.

NOTE DELETED.

NOTE DELETED.

FINISH	DIM A	NO. OF CIRCUITS	PART NO.
TIN	95.10 [3.744]	24	5-641153-4
TIN	91.14 [3.588]	23	5-641153-3
TIN	87.17 [3.432]	22	5-641153-2
TIN	83.21 [3.276]	21	5-641153-1
TIN	79.25 [3.120]	20	5-641153-0
TIN	75.29 [2.964]	19	4-641153-9
TIN	71.32 [2.808]	18	4-641153-8
TIN	67.36 [2.652]	17	4-641153-7
TIN	63.40 [2.496]	16	4-641153-6
TIN	59.44 [2.340]	15	4-641153-5
TIN	55.47 [2.184]	14	4-641153-4
TIN	51.51 [2.028]	13	4-641153-3
TIN	47.55 [1.872]	12	4-641153-2
TIN	43.59 [1.716]	11	4-641153-1
TIN	39.62 [1.560]	10	4-641153-0
TIN	35.66 [1.404]	9	3-641153-9
TIN	31.70 [1.248]	8	3-641153-8
TIN	27.74 [1.092]	7	3-641153-7
TIN	23.77 [0.936]	6	3-641153-6
TIN	19.81 [0.780]	5	3-641153-5
TIN	15.85 [0.624]	4	3-641153-4
TIN	11.89 [0.468]	3	3-641153-3
TIN	7.92 [0.312]	2	3-641153-2
TIN	95.10 [3.744]	24	2-641153-4
TIN	91.14 [3.588]	23	2-641153-3
TIN	87.17 [3.432]	22	2-641153-2
TIN	83.21 [3.276]	21	2-641153-1
TIN	79.25 [3.120]	20	2-641153-0
TIN	75.29 [2.964]	19	1-641153-9
TIN	71.32 [2.808]	18	1-641153-8
TIN	67.36 [2.652]	17	1-641153-7
TIN	63.40 [2.496]	16	1-641153-6
TIN	59.44 [2.340]	15	1-641153-5
TIN	55.47 [2.184]	14	1-641153-4
TIN	51.51 [2.028]	13	1-641153-3
TIN	47.55 [1.872]	12	1-641153-2
TIN	43.59 [1.716]	11	1-641153-1
TIN	39.62 [1.560]	10	1-641153-0
TIN	35.66 [1.404]	9	641153-9
TIN	31.70 [1.248]	8	641153-8
TIN	27.74 [1.092]	7	641153-7
TIN	23.77 [0.936]	6	641153-6
TIN	19.81 [0.780]	5	641153-5
TIN	15.85 [0.624]	4	641153-4
TIN	11.89 [0.468]	3	641153-3
TIN	7.92 [0.312]	2	641153-2

THIS DRAWING IS A CONTROLLED DOCUMENT.	DATE	BY	REV
	2-12-91	B. LEWIS	1
	2-12-91	OK SWING	2
		APPRO	
		NAME	
		PRODUCT SPEC	
		APPLICATION SPEC	
		WEIGHT	
		SIZE	
		GAGE CODE	
		DRAWING NO	
		RESTRICTED TO	

