

| PART NUMBER | REV | FIRST USED |
|-------------|-----|------------|
| 567972-1 | A | 854040-3 |

| | | | | | |
|--------------------|----------------|-------------|---------------------|-------------------------------------|-----------|
| TERMINAL NAME: PIN | | 286943 | VISIBLE PAD LTR | CRIMP DATA (NON-AMP TERM-CUST SPEC) | |
| | | | | CRIMP HEIGHT | WIRE SIZE |
| | | | | A .027 ±.002 [0.69 ±0.05mm] | 28 |
| AMP P/N | | MFG P/N | | B NOT | USED |
| 286943 | | 120190-0292 | | C NOT | USED |
| | | | | D NOT | USED |
| | | | | CRIMP SIZE | TYPE |
| | | | | WIRE .042 [1.07mm] | F |
| | | | | INSUL .055 [1.40mm] | F |
| | | | | | RANGE |
| | | | | | .040 MAX |
| WIRE STRIP LENGTH | TERM APPL SPEC | FEED | APPL INSTRUCTION | SET UP GAGE | LAYOUT |
| .094-.125 | NONE | .300 | SEE CUSTOMER MANUAL | NONE | L2519 |

| | | | | | |
|-----------------|---|---|------------|-----------------------------|----|
| SIM TO HDM NONE | | | | | |
| | | | | | 70 |
| | | | | | 69 |
| | | | | | 68 |
| | | | | | 67 |
| | | | | | 66 |
| | | | | | 65 |
| | | | | | 64 |
| | | | | | 63 |
| | | | | | 62 |
| | | | | | 61 |
| | | | | | 60 |
| | | | | | 59 |
| | | | | | 58 |
| | | | | | 57 |
| REF | - | B | 694433-8 | PAWL, FEED | 56 |
| | | | | | 55 |
| | | | | | 54 |
| | | | | | 53 |
| | | | | | 52 |
| 1 | - | A | 811242-2 | BUMPER, HOLDDOWN | 51 |
| 1 | - | A | 690753-1 | SPACER, TONKER | 50 |
| | | | | | 49 |
| 1 | - | A | 690602-6 | CAM, PRE-FEED 1.62 STROKE | 48 |
| | | | | | 47 |
| | | | | | 46 |
| 1 | - | A | 690191-1 | PLUG, NYLON | 45 |
| 1 | - | C | 455673-1 | RAM | 44 |
| 1 | - | A | 690125-1 | WASHER, LAMINATED | 43 |
| 1 | - | A | 690124-1 | WASHER, RAM | 42 |
| 1 | - | A | 7-21002-9 | BOLT, CRIMPER (5/16x1.00) | 41 |
| 1 | - | A | 23241-6 | BALL, STEEL | 40 |
| 1 | - | A | 690170-1 | SPRING, COMPRESSION | 39 |
| 1 | - | C | 690142-5 | DISC, INSULATION | 38 |
| 1 | - | D | 354777-1 | WIRE DISC, PLASTIC | 37 |
| 1 | - | A | 22480-5 | WASHER, SPRING | 36 |
| 1 | - | B | 690212-1 | POST, RAM | 35 |
| 1 | - | B | 692776-1 | SUPPORT, TERMINAL | 34 |
| 1 | - | C | 462544-1 | PLATE, BASE SPECIAL | 33 |
| 1 | - | A | 690432-3 | SCREW, ADJUSTMENT | 32 |
| 1 | - | B | 462543-1 | BLOCK, SCREW SPECIAL | 31 |
| 1 | - | B | 455689-1 | BLOCK, STRIP GUIDE ADJ | 30 |
| 1 | - | C | 455671-1 | PLATE, STRIP GUIDE | 29 |
| 1 | - | C | 1-455888-0 | SPACER, FRONT SHEAR DEP | 28 |
| 2 | - | A | 1-22284-0 | SPRING, DRAG | 27 |
| 1 | - | B | 690546-1 | LEVER, DRAG RELEASE | 26 |
| 1 | - | B | 240792-1 | DRAG, TERMINAL | 25 |
| 1 | - | D | 6-690504-4 | GUIDE, STRIP (REAR) | 24 |
| 1 | - | A | 690438-1 | GUIDE, STRIP (FRONT) | 23 |
| | | | | | 22 |
| 1 | - | A | 463756-1 | GUIDE, SCRAP | 21 |
| | | | | | 20 |
| REF | - | C | 462615-1 | STRIPPER | 19 |
| | | | | | 18 |
| | | | | | 17 |
| | | | | | 16 |
| | | | | | 15 |
| | | | | | 14 |
| | | | | | 13 |
| 1 | - | A | 5-22280-0 | SPRING, SHEAR | 12 |
| 1 | - | B | 1-690461-6 | STOP, SHEAR (FRONT) | 11 |
| 1 | - | B | 462548-1 | HOLDER, SHEAR (FRONT) SP | 10 |
| 1 | - | B | 462547-1 | SHEAR, FLOAT (FRONT) SP | 9 |
| 1 | - | C | 662182-8 | ANVIL | 8 |
| 1 | - | C | 1-240641-7 | SPACER, DEPRESSOR (REAR) | 7 |
| | | | | | 6 |
| 1 | - | A | 462838-1 | DEPRESSOR, SHEAR (FRONT) SP | 5 |
| 1 | - | B | 2-238011-3 | SPACER, BLOCK CRIMPER | 4 |
| 1 | - | C | 5-683453-2 | CRIMPER, INSULATION | 3 |
| 1 | - | C | 455888-1 | SPACER, CRIMPER | 2 |
| 1 | - | C | 456401-5 | CRIMPER, WIRE | 1 |

| | | | | | |
|-----|---|---|------------|------------------------------------|-----|
| 2 | - | C | 7-354779-2 | PIN, WIRE DISC (.3350)C | 129 |
| | | | | | 128 |
| | | | | | 127 |
| | | | | | 126 |
| 1 | - | A | 986950-1 | WASHER, FLAT PRECISION | 125 |
| 1 | - | A | 217238-3 | GENERAL INSTRUCTION PACKAGE | 124 |
| | | | | | 123 |
| | | | | | 122 |
| 1 | - | A | 4-21028-0 | PIN, SLT SPR (ø.093x.75) ST 60E PL | 121 |
| 1 | - | B | 690701-2 | PLATE, SERIAL NO. | 120 |
| 2 | - | A | 21899-2 | WASHER, FLAT (#10) 5 G ADJ BLK | 119 |
| | | | | | 118 |
| 2 | - | A | 21024-5 | WASHER, LOCK (#10) ADJ BLOCK | 117 |
| | | | | | 116 |
| | | | | | 115 |
| 2 | - | A | 21024-2 | WASHER, LOCK (#4) FRONT STP GUIDE | 114 |
| REF | - | A | 21024-4 | WASHER, LOCK (#8) FEED FINGER | 113 |
| 2 | - | A | 21024-4 | WASHER, LOCK (#8) DEP-HOLD | 112 |
| REF | - | A | 21024-4 | WASHER, LOCK (#8) STRIPPER | 111 |
| | | | | | 110 |
| | | | | | 109 |
| 1 | - | A | 21018-5 | NUT, HEX (#6) HOLD DOWN | 108 |
| | | | | | 107 |
| | | | | | 106 |
| | | | | | 105 |
| | | | | | 104 |
| 1 | - | A | 21009-2 | SCR, SKT 5ET (1/4-20x.25 LW) RAM | 103 |
| | | | | | 102 |
| 4 | - | A | 21017-2 | SCR, DRIVE (#2x.19) ID PLATE | 101 |
| 1 | - | B | 819347-1 | PLATE, IDENTIFICATION | 100 |
| 2 | - | A | 3-21002-0 | SCR, BHC (10-32x.88) DRAG | 99 |
| 1 | - | A | 22733-8 | SCR, BHC (8-32x.38 LW) ANVIL | 98 |
| | | | | | 97 |
| 1 | - | A | 3-21000-8 | SCR, SHC (10-32x.88) MOUNTING | 96 |
| 1 | - | A | 2-21002-7 | SCR, BHC (10-32x.50) 5G ADJ BLK | 95 |
| 6 | - | A | 2-21002-2 | SCR, BHC (8-32x.50) SHEAR-TERM SUP | 94 |
| | | | | | 93 |
| | | | | | 92 |
| 1 | - | A | 1-21002-7 | SCR, SHC (6-32x.50) CAM | 91 |
| 4 | - | A | 2-21000-7 | SCR, SHC (8-32x.50) SCR BLK | 90 |
| | | | | | 89 |
| | | | | | 88 |
| | | | | | 87 |
| REF | - | A | 2-22603-0 | SCR, HEX HD (8-32x.31) FEED FINGER | 86 |
| 2 | - | A | 1-21000-3 | SCR, SHC (4-40x.25) F ST GUIDE | 85 |
| REF | - | A | 22733-9 | SCR, BHC (8-32x.50 SL) STRIPPER | 84 |
| | | | | | 83 |
| | | | | | 82 |
| 1 | - | A | 3-22603-1 | SCR, HEX (10-32x.38) 5G ADJ BL | 81 |
| | | | | | 80 |
| | | | | | 79 |
| | | | | | 78 |
| 2 | - | B | 463310-9 | BLADE, STRIPPING (#28) | 77 |
| | | | | | 76 |
| | | | | | 75 |
| 1 | - | A | 690603-1 | SPRING, ASSIST | 74 |
| 1 | - | A | 23030-1 | SCR, SKT CAP (6-32x.25) CP DSC | 73 |
| | | | | | 72 |
| | | | | | 71 |

| QTY | REQD PER ASSY | U/M | DWG SIZE | PART NO | DESCRIPTION | ITEM NO |
|------------|---------------|-----|----------|---------|-------------|---------|
| PARTS LIST | | | | | | |

| | | | |
|-----------------|-------|-----|--------|
| REVISION RECORD | | TE | 4-04 |
| A | REV D | CE | APR 01 |
| P | F | APP | DATE |

| | | | | |
|--|--|-------------------------------|-----------|------------------|
| DIMENSIONS IN INCHES. DO NOT SCALE PRINT. TOLERANCES UNLESS OTHERWISE SPECIFIED: | | MATL | HT TR | FIN |
| 2 PLC DEC ± | | DR | 21MAR01 | APP |
| 3 PLC DEC ± | | CHK | C.ERISMAN | T.ELBIN |
| 4 PLC DEC ± | | REL | | |
| ANGLES ± | | AMP Incorporated | | |
| SURF TEXTURE: ✓ | | Harrisburg, PA 17105-3608 | | |
| REMOVE BURRS, BREAK SHARP EDGES R.015 MAX | | STRIPPER CRIMPER APPLICATOR | | |
| SCALE | | DWG NO | | MACHINE REF |
| D | | 567972 | | STRIPPER CRIMPER |
| CASE CODE 00779 | | CUSTOMER AND ASSEMBLY DRAWING | | SHEET 1 OF 1 |
| | | | | REV A1 |

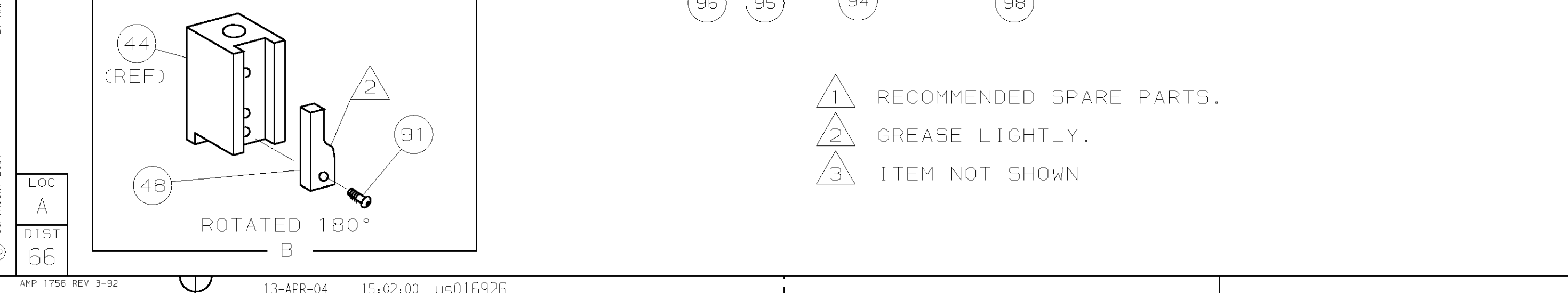
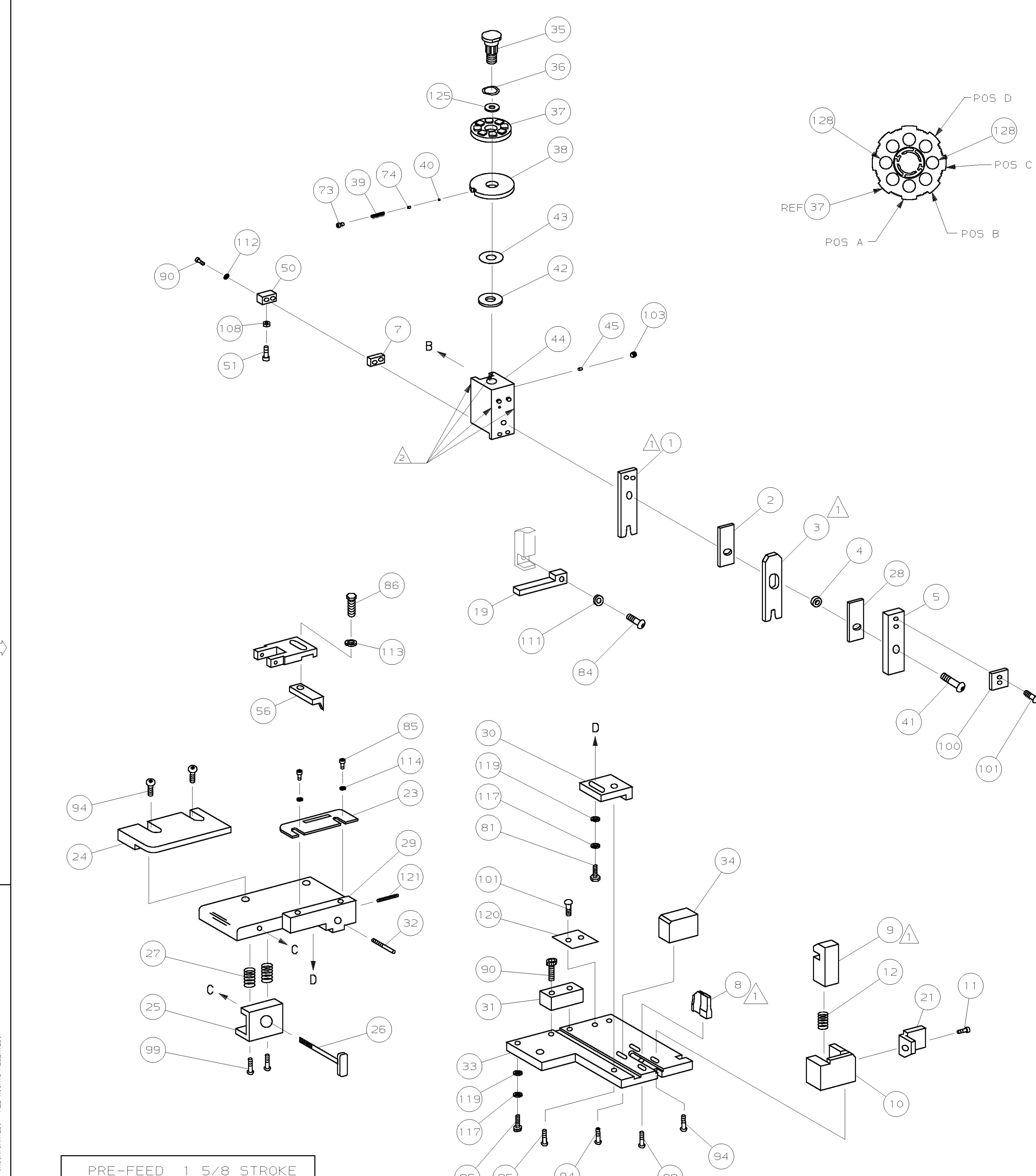

THIS DRAWING IS A CONTROLLED DOCUMENT.

THIS DRAWING IS UNCLASSIFIED... RELEASED FOR PUBLICATION... BY AMP INCORPORATED. ALL RIGHTS RESERVED.

567972