

PART NUMBER	REV	FIRST USED
567964-1	A	854040-3

TERMINAL NAME: (NON-AMP TERM-AMP SPEC)		CRIMP DATA (NON-AMP TERM-CUST SPEC)			
AMP P/N	MFG P/N	VISIBLE PAD LTR	CRIMP HEIGHT	WIRE SIZE	
286843	20168-A01/10K	A	.023 ±.002 [0.58 ±0.05mm]	28	
		B	NOT	USED	
		C	NOT	USED	
		D	NOT	USED	
CRIMP	SIZE	TYPE	RANGE		
WIRE	.042 [1.07mm]	F	28		
INSUL	.070 [1.78mm]	F	.056 MAX		
WIRE STRIP LENGTH	TERM APPL SPEC	FEED	APPL INSTRUCTION	SET UP GAGE	LAYOUT
.0938-.1250	NONE	.235	SEE CUSTOMER MANUAL	NONE	L2320

SIM TO HDM NONE

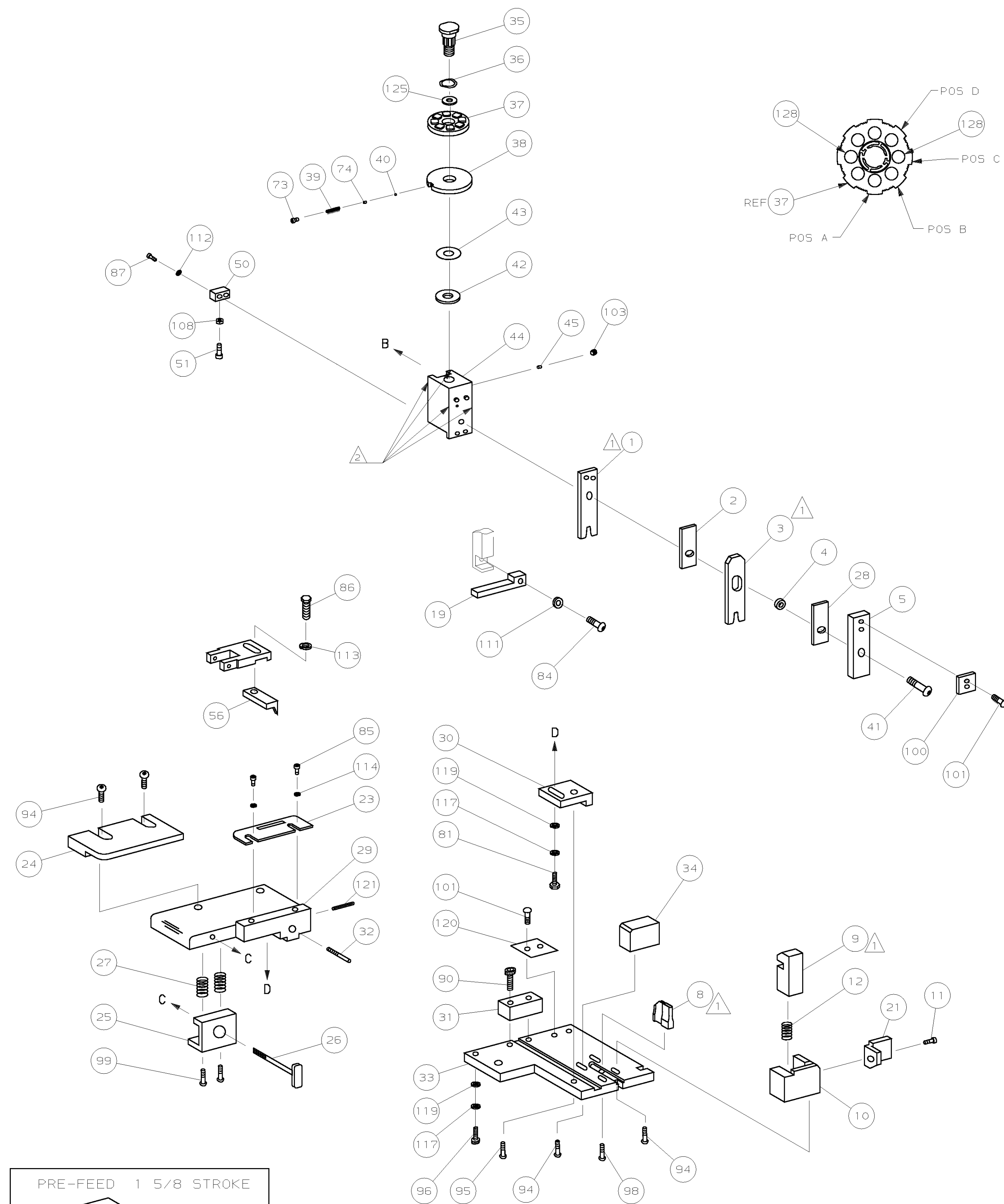

QTY	REV	REF	DESCRIPTION	ITEM NO
2	-	C	8-354779-0 PIN, WIRE DISC (.3390)C	129
				128
				127
				126
1	-	A	986950-1 WASHER, FLAT PRECISION	125
1	-	A	217238-3 GENERAL INSTRUCTION PACKAGE	124
				123
				122
1	-	A	4-21028-0 PIN, SLT SPR (ø.093x.75) ST 60E PL	121
1	-	B	690701-2 PLATE, SERIAL NO.	120
2	-	A	21899-2 WASHER, FLAT (#10) 5 G ADJ BLK	119
				118
2	-	A	21024-5 WASHER, LOCK (#10) ADJ BLOCK	117
				116
				115
2	-	A	21024-2 WASHER, LOCK (#4) FRONT STP GUIDE	114
REF	-	A	21024-4 WASHER, LOCK (#8) FEED FINGER	113
2	-	A	21024-4 WASHER, LOCK (#8) DEP-HOLD	112
REF	-	A	21024-4 WASHER, LOCK (#8) STRIPPER	111
				110
				109
1	-	A	21018-5 NUT, HEX (#6) HOLD DOWN	108
				107
				106
				105
1	-	A	21009-2 SCR, SKT 5ET (1/4-20x.25 LW) RAM	104
				103
				102
4	-	A	21017-2 SCR, DRIVE (#2x.19) ID PLATE	101
1	-	B	819347-1 PLATE, IDENTIFICATION	100
2	-	A	3-21002-0 SCR, BHC (10-32x.88) DRAG	99
1	-	A	22733-8 SCR, BHC (8-32x.38 LW) ANVIL	98
				97
1	-	A	3-21000-8 SCR, SHC (10-32x.88) MOUNTING	96
1	-	A	2-21002-7 SCR, BHC (10-32x.50) 5G ADJ BLK	95
6	-	A	2-21002-2 SCR, BHC (8-32x.50) SHEAR-TERM SUP	94
				93
				92
1	-	A	1-21002-7 SCR, SHC (6-32x.50) CAM	91
2	-	A	2-21000-7 SCR, SHC (8-32x.50) SCR BLK	90
				89
				88
2	-	A	2-21000-7 SCR, SHC (8-32x.48) DEP-HOLD DOWN	87
REF	-	A	2-22603-0 SCR, HEX HD (8-32x.31) FEED FINGER	86
2	-	A	1-21000-3 SCR, SHC (4-40x.25) F ST GUIDE	85
REF	-	A	22733-9 SCR, BHC (8-32x.50 SL) STRIPPER	84
				83
				82
1	-	A	3-22603-1 SCR, HEX (10-32x.38) 5G ADJ BL	81
				80
				79
				78
2	-	B	463310-9 BLADE, STRIPPING (#28)	77
				76
				75
1	-	A	690603-1 SPRING, ASSIST	74
1	-	A	23030-1 SCR, SKT CAP (6-32x.25) CP DSC	73
				72
				71

QTY RECD PER ASSY	U/M	DWG SIZE	PART NO	DESCRIPTION	ITEM NO

QTY RECD PER ASSY		PARTS LIST	
REV	DESCRIPTION	DATE	BY
A	REVISED	MEH 1/00	
P	REVISION RECORD		

QTY	REV	REF	DESCRIPTION	ITEM NO
				70
				69
				68
				67
				66
				65
				64
				63
				62
				61
				60
				59
				58
				57
REF	-	B	694433-8 PAWL, FEED	56
				55
				54
				53
				52
1	-	A	811242-2 BUMPER, HOLDDOWN	51
1	-	A	690753-1 SPACER, TONKER	50
				49
1	-	A	690602-6 CAM, PRE-FEED 1.62 STROKE	48
				47
				46
1	-	A	690191-1 PLUG, NYLON	45
1	-	C	455673-1 RAM	44
1	-	A	690125-1 WASHER, LAMINATED	43
1	-	A	690124-1 WASHER, RAM	42
1	-	A	7-21002-9 BOLT, CRIMPER (5/16x1.00)	41
1	-	A	23241-6 BALL, STEEL	40
1	-	A	690170-1 SPRING, COMPRESSION	39
1	-	C	690142-1 DISC, INSULATION	38
1	-	D	354777-1 WIRE DISC, PLASTIC	37
1	-	A	22480-5 WASHER, SPRING	36
1	-	B	690212-1 POST, RAM	35
1	-	B	690786-1 SUPPORT, TERMINAL	34
1	-	C	462544-1 PLATE, BASE SPECIAL	33
1	-	A	690432-3 SCREW, ADJUSTMENT	32
1	-	B	462543-1 BLOCK, SCREW SPECIAL	31
1	-	B	455689-1 BLOCK, STRIP GUIDE ADJ	30
1	-	C	455671-1 PLATE, STRIP GUIDE	29
1	-	C	1-455888-9 SPACER, FRONT SHEAR DEP	28
2	-	A	1-22284-0 SPRING, DRAG	27
1	-	B	690546-1 LEVER, DRAG RELEASE	26
1	-	B	240792-1 DRAG, TERMINAL	25
1	-	D	6-690504-4 GUIDE, STRIP (REAR)	24
1	-	A	690438-1 GUIDE, STRIP (FRONT)	23
				22
1	-	A	463756-1 GUIDE, SCRAP	21
				20
REF	-	C	462615-1 STRIPPER	19
				18
				17
				16
				15
				14
				13
1	-	A	5-22280-0 SPRING, SHEAR	12
1	-	B	1-690461-6 STOP, SHEAR (FRONT)	11
1	-	B	462548-1 HOLDER, SHEAR (FRONT) SP	10
1	-	B	462547-1 SHEAR, FLOAT (FRONT) SP	9
1	-	C	662182-6 ANVIL	8
				7
				6
1	-	A	462838-1 DEPRESSOR, SHEAR (FRONT) SP	5
1	-	B	2-238011-0 SPACER, BLOCK CRIMPER	4
1	-	C	2-683453-0 CRIMPER, INSULATION	3
1	-	C	455888-2 SPACER, CRIMPER	2
1	-	C	1-456401-7 CRIMPER, WIRE	1

QTY RECD PER ASSY	U/M	DWG SIZE	PART NO	DESCRIPTION	ITEM NO

QTY RECD PER ASSY		PARTS LIST	
REV	DESCRIPTION	DATE	BY
A	REVISED	MEH 1/00	
P	REVISION RECORD		

CUSTOMER AND ASSEMBLY DRAWING

THIS DRAWING IS A CONTROLLED DOCUMENT.

RELEASE FOR PUBLICATION JAN 21 2000
 BY AMP INCORPORATED. ALL RIGHTS RESERVED.
 AMP 1756 REV 3-92
 LOC A
 DIST 66
 AMP 1756 REV 3-92

- 1 RECOMMENDED SPARE PARTS.
- 2 GREASE LIGHTLY.
- 3 ITEM NOT SHOWN
- 4 CUT TO LENGTH AT ASSY

