

# S CN BN - J 1 2 75 - SO PMR

SUNTSU

CONNECTOR

BNC

Connector Type  
Jack

Rows  
1

Connectors  
per Row  
2

Impedance  
75

Contact Termination  
Solder

Mounting Style  
PCB Mount  
Receptacle RA

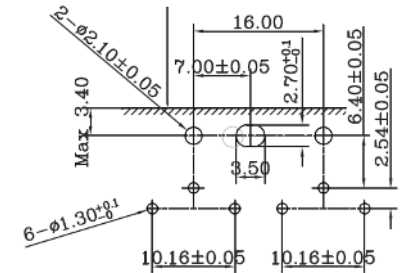
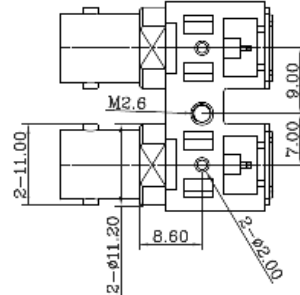
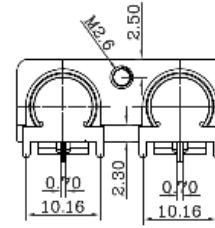
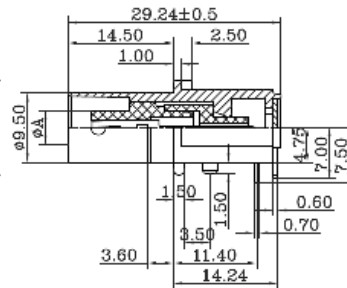
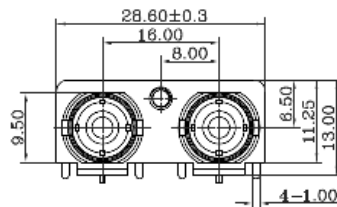

Recommended  
Mounting  
Layout

1. Materials:

- a) Body: Zinc Nickel Plated
- b) Contact: Brass Nickel Plated
- 2. Normal Impedance: 75Ω
- 3. Frequency Range: 0-4 GHz
- 4. Max Peak Voltage: 500V
- 5. Dielectric Strength: 1500V RMS
- 6. Insulation Resistance: 5000MΩ/Min



TWO BNC FEMALE PCB MOUNT  
90°

Document History			
Edits Made	Date	Edited By	Approved By
Initial Release	03/23/2022	B. Gibbons	KH Mun

Part No.	SCNBN-J1275-SOPMR		
Scale	Not drawn to scale		
Unit	mm		
Drawn	B. Gibbons	03/23/2022	
Tolerance	0.5-15 = ±0.15 15-30 = ±0.30 30-120 = ±0.60 >120 = ±1.00		
Pages	1/1		