

REVISIONS					
P	LTR	DESCRIPTION	DATE	DWN	APVD
A		INITIAL RELEASE	28AUG2022	PT	SZ

Description:
M2.6*0.45
4-40 UNC
Thru Hole ϕ 3.1

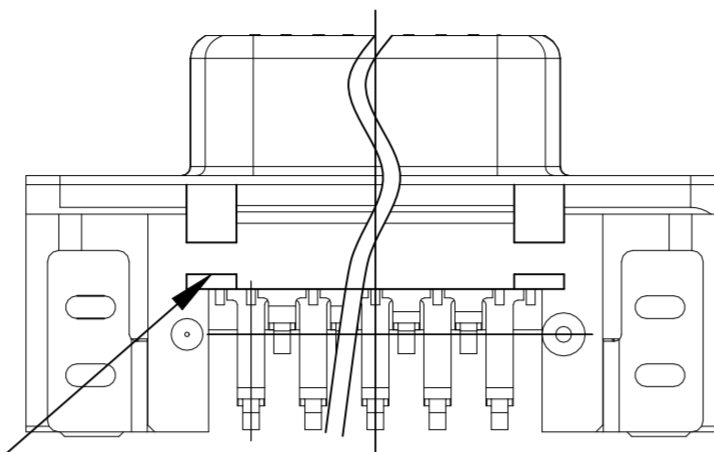

15pin Detail drawing

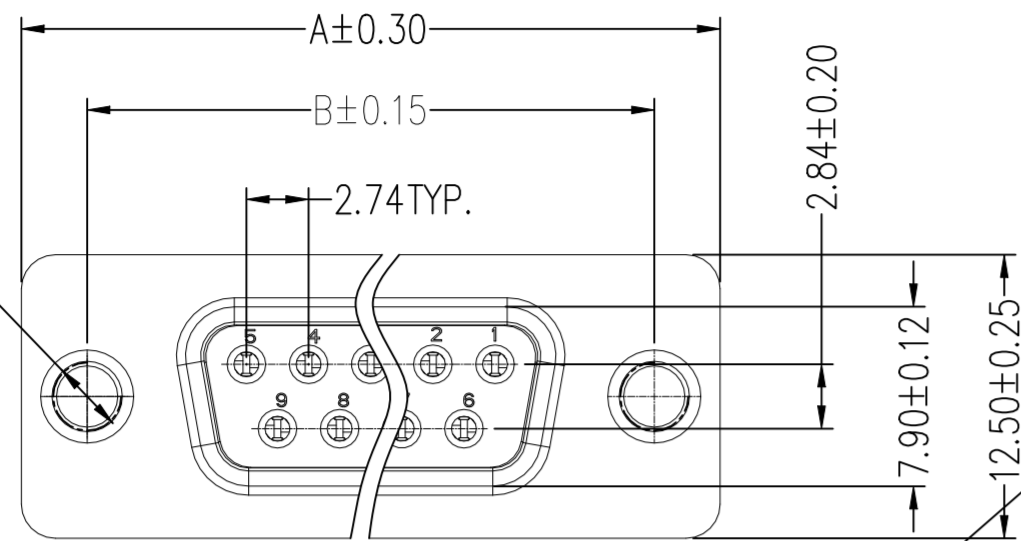
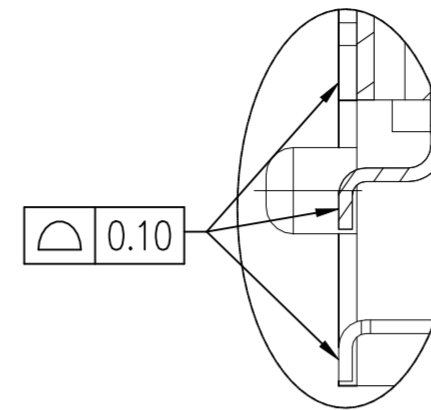

Detail A
Scale 2:1

NOTES:

- Current Rating: 3.0A
 - Contact Resistance: 25m Ω Max
 - Withstand Voltage: 500V AC
 - Insulation Resistance: 1000M Ω Min
 - Operation Temperature: -55°C to +105°C
 - Insulator Material:
High temperature plastics, UL94V-0, Black
 - Contact Material: Copper alloy
 - Contact Plating:
30u" Gold on contact area,
120~200u" Tin on solder area,
50u" Nickel underplating overall.
 - Shell: Steel, Nickel plated
Revit/Fixed Plate: Brass, Tin over Nickel plated
- Recommended Process:
IR soldering, Peak temperature: 260 \pm 5°C, 5s

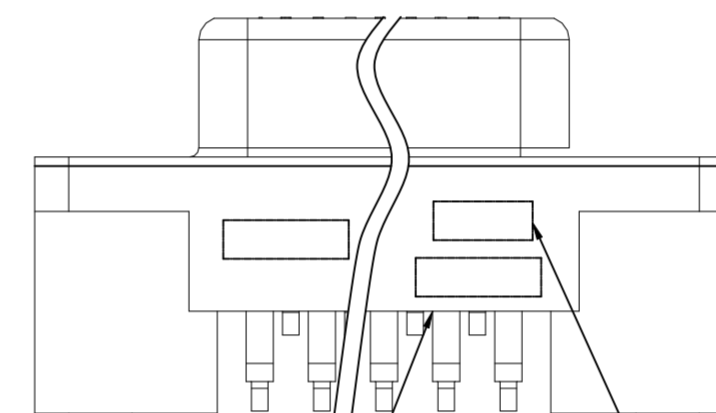
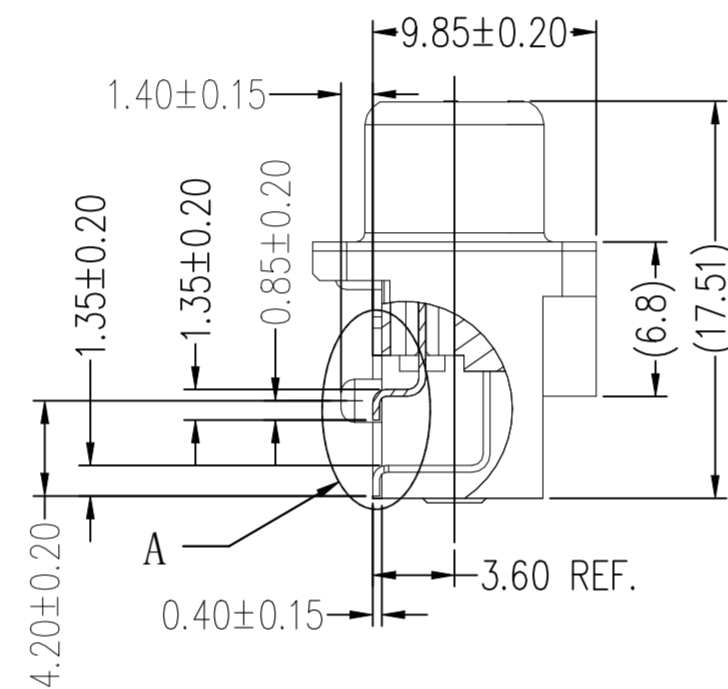
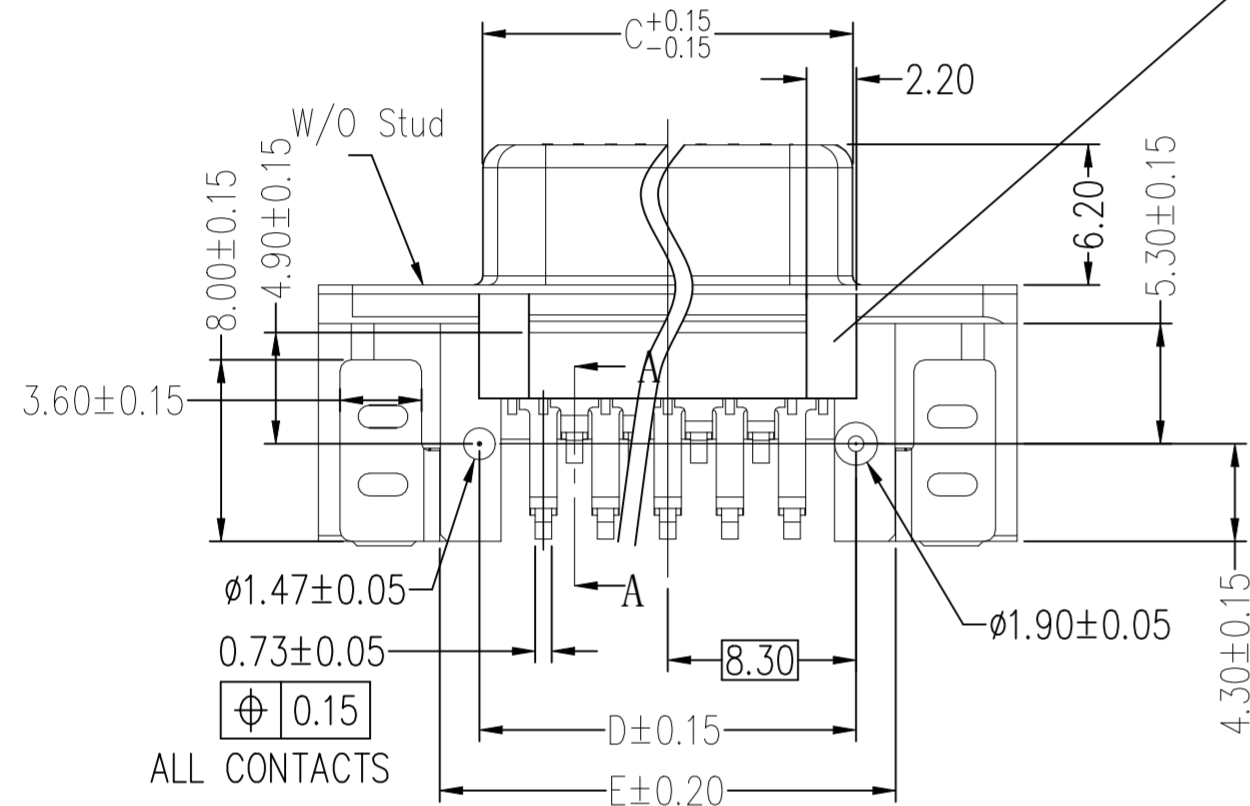

TE PART NO
(X-2394032-X)
DATE CODE
(YYWW)

15P	39.20	33.32	24.66	24.90	28.40
9P	30.80	25.00	16.33	16.60	20.10
PINS	A	B	C	D	E

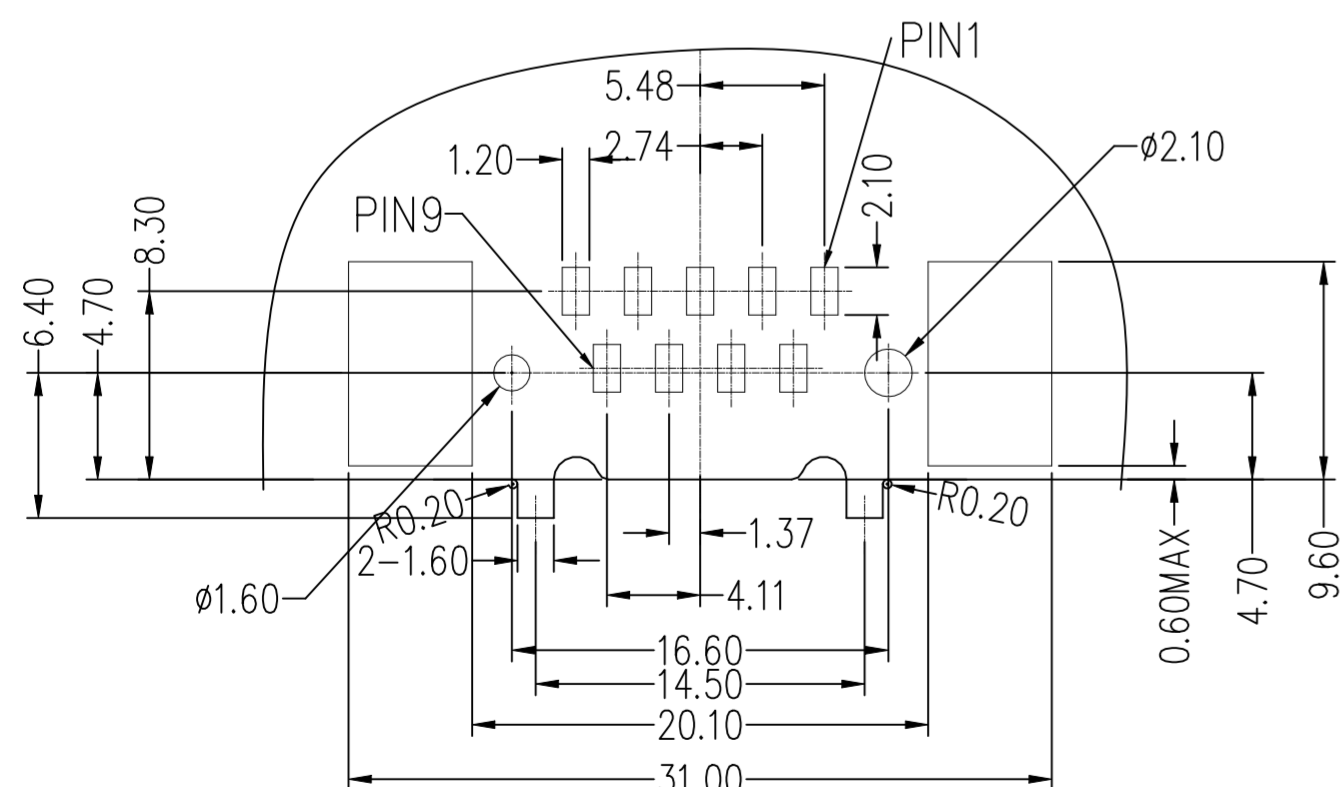

RECOMMENDED P.C.B LAYOUT For 9 position
(COMPONENT SIDE)

RECOMMENDED PCB LAYOUT 1
(COMPONENT SIDE VIEW)

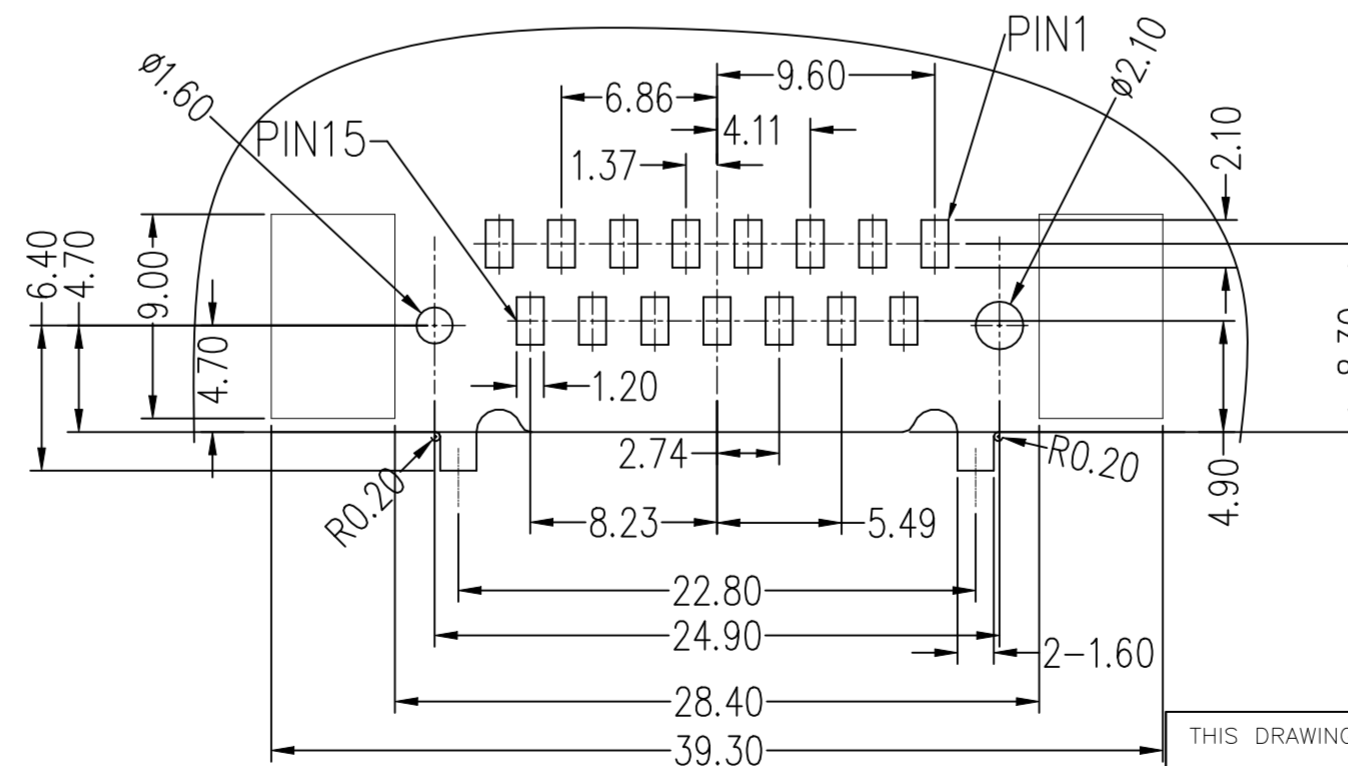

RECOMMENDED P.C.B LAYOUT For 15 position
(COMPONENT SIDE)

15P	M2.6*0.45	3-2394032-3	4-2394032-3
	4-40 UNC	3-2394032-2	4-2394032-2
	Thru Hole ϕ 3.1	3-2394032-1	4-2394032-1
9P	M2.6*0.45	1-2394032-3	2-2394032-3
	4-40 UNC	1-2394032-2	2-2394032-2
	Thru Hole ϕ 3.1	1-2394032-1	2-2394032-1
Pos.	DESCRIPTION	REEL PACKING	TRAY PACKING

PRODUCT FAMILY TABLE

THIS DRAWING IS A CONTROLLED DOCUMENT.		DWN	-	TE Connectivity	
DIMENSIONS: mm		CHK	-	NAME	
TOLERANCES UNLESS OTHERWISE SPECIFIED:		APVD	-	D-SUB HEADER, REC, SMT	
0 PLC \pm -		PRODUCT SPEC	108-94000	SIZE	A2
1 PLC \pm -		APPLICATION SPEC	-	CAGE CODE	00779
2 PLC \pm 0.25		WEIGHT	-	DRAWING NO	C=2394032
3 PLC \pm -		CUSTOMER DRAWING	-	SCALE	1:1
4 PLC \pm -		RESTRICTED TO	-	SHEET	1 of 5
ANGLES \pm -		REV	A		
FINISH					

P	LTR	DESCRIPTION	DATE	DWN	APVD
-	-	SEE SHEET 1	-	-	-

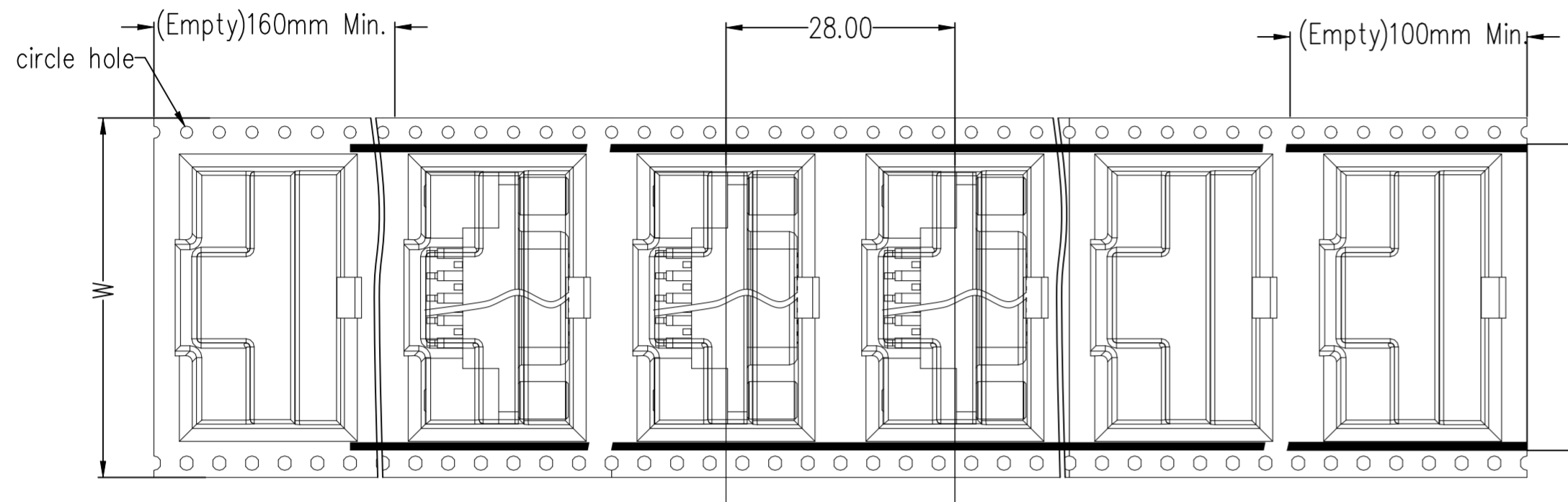

Direction of pull in

Direction of pull out

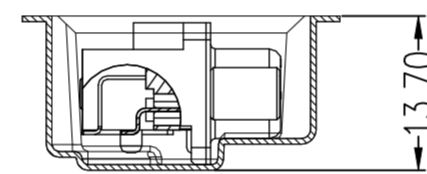
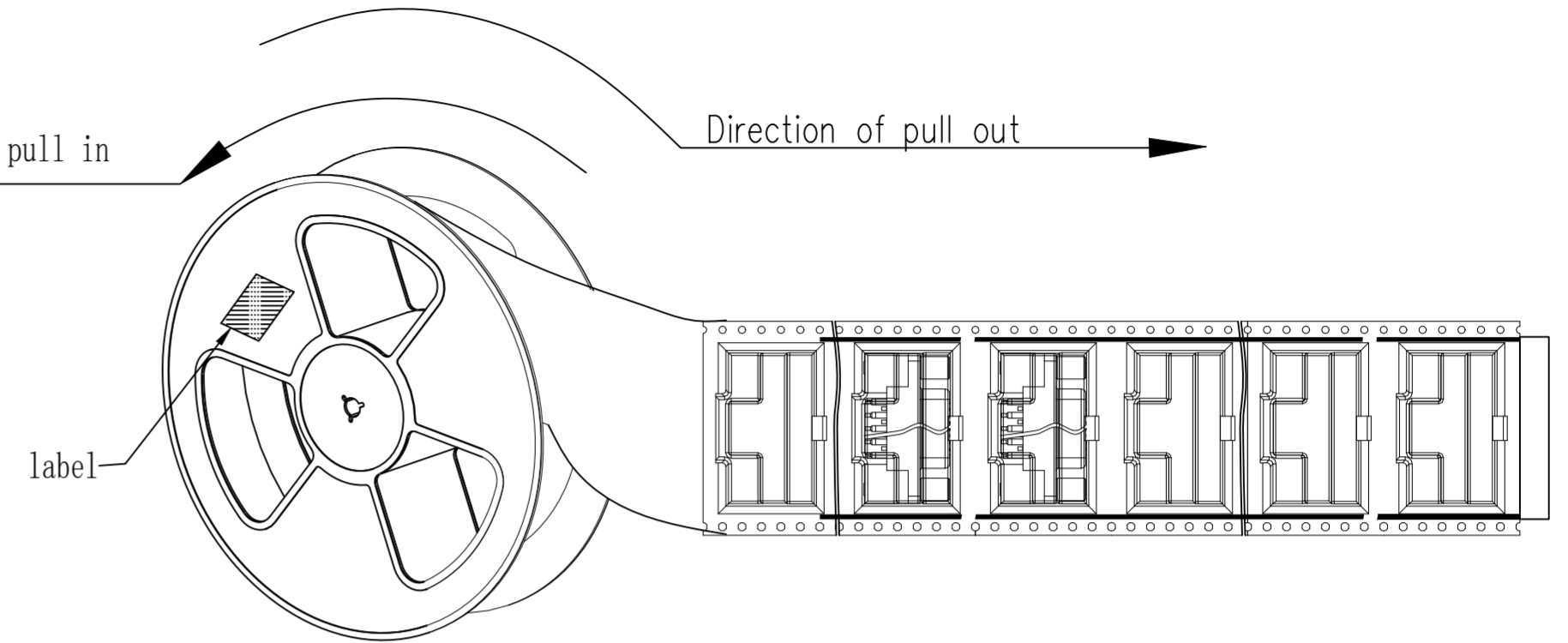

Cutaway view

PIN	W
9P	44.0±0.30
15P	56.0±0.30

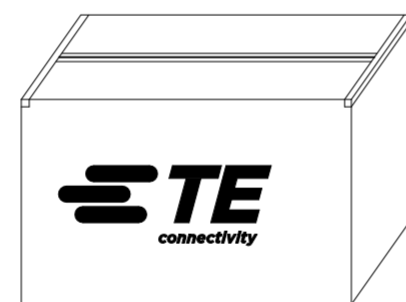

Seal, pack, label.



Put reel into outer box, pay attention to the unified label direction.

THIS DRAWING IS A CONTROLLED DOCUMENT.		DWN	-	TE TE Connectivity	
DIMENSIONS: mm		CHK	-		
TOLERANCES UNLESS OTHERWISE SPECIFIED:		APVD	-	NAME	
0 PLC	± -	PRODUCT SPEC	-	D-sub Header, Plug, SMT	
1 PLC	± -	APPLICATION SPEC	-	SIZE	CAGE CODE
2 PLC	± 0.25			A2	00779
3 PLC	± -			DRAWING NO	
4 PLC	± -			C=2394032	
ANGLES	± -	WEIGHT	-	RESTRICTED TO	
MATERIAL	FINISH	CUSTOMER DRAWING		SCALE	SHEET
				1:1	4 of 5
				REV	A

REVISIONS					
P	LTR	DESCRIPTION	DATE	DWN	APVD
-	-	SEE SHEET 1	-	-	-

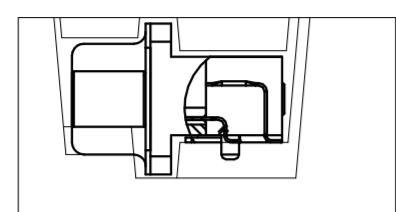

Product piping diagram

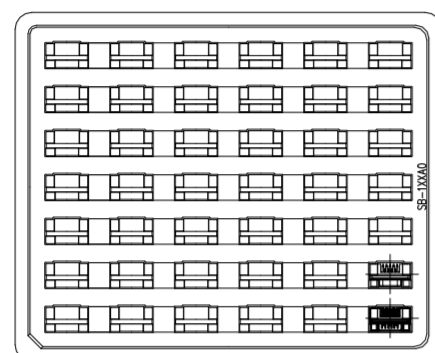

No. 1

put the product into the tray

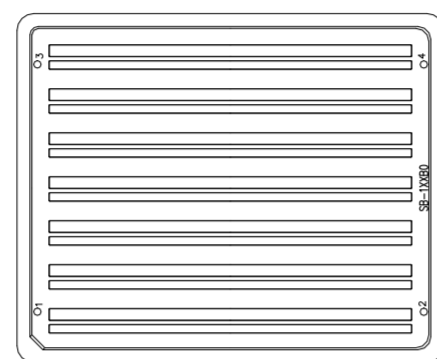
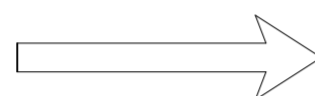

No. 2

Cover the tray

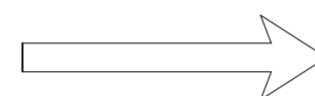

Quantity label

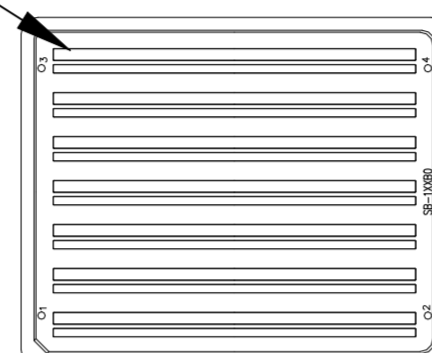

No. 3

Label on top left corner of tray

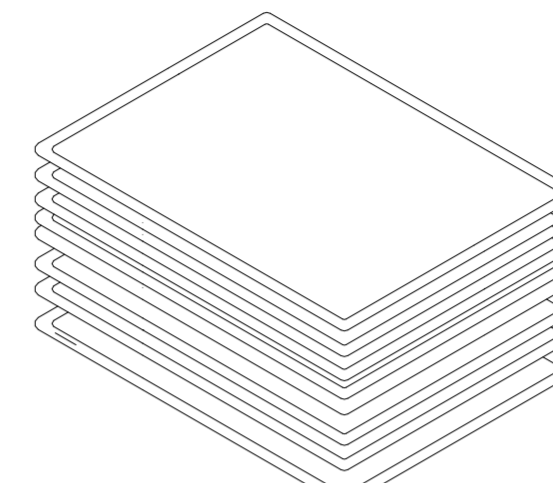
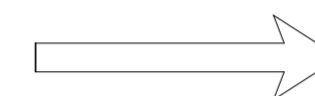

No. 4

the top and bottom of each put a piece of paper board,

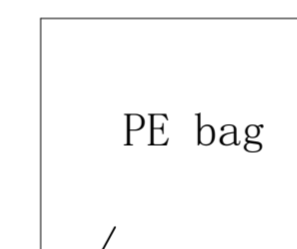

PE bag



No. 5

A waterproof PE bag should be set inside the carton, and then the tray should be put into the carton Sealed with a bag of desiccant.

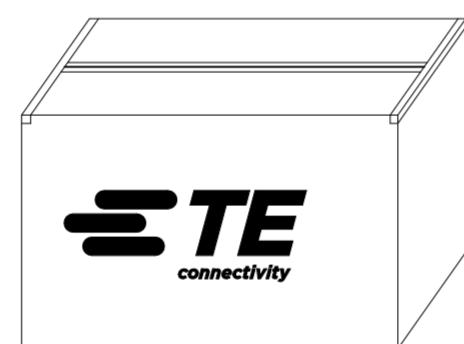

No. 6

Seal and label on the top left corner of the carton side

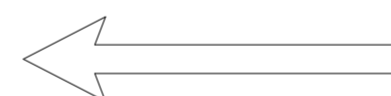

Explain:

1. Put the product into the tray as shown in the figure
2. Pay attention to the consistency of label style position and direction;

THIS DRAWING IS A CONTROLLED DOCUMENT.		DWN	-	TE Connectivity	
DIMENSIONS: mm		CHK	-		
TOLERANCES UNLESS OTHERWISE SPECIFIED:		APVD	-	NAME	
0 PLC ± -		PRODUCT SPEC	-	D-sub Header, Plug, SMT	
1 PLC ± -		APPLICATION SPEC	-	SIZE	A2
2 PLC ± 0.25		WEIGHT	-	CAGE CODE	00779
3 PLC ± -		CUSTOMER DRAWING	-	DRAWING NO	C=2394032
4 PLC ± -		SCALE	1:1	SHEET	5 of 5
ANGLES ± -		RESTRICTED TO	-	REV	A
FINISH					