

MATERIALS AND FINISHES

BODY ZINC  
PLATED TIN

CENTER CONTACT BRASS  
PLATED GOLD

OUTER CASING HIGH  
TEMPERATURE PLASTIC  
KEYING SEE TABLE  
COLOR SEE TABLE

INSULATOR PA46

CAP BRASS  
PLATED NICKEL

PACKAGING BY TRAY

RETENTION SPECIFICATION

THE FAKRA CONNECTOR SHROUD  
WILL WITHSTAND A LONGITUDINAL  
FORCE OF 110 N (24.75 LBS)

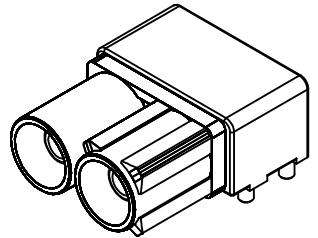
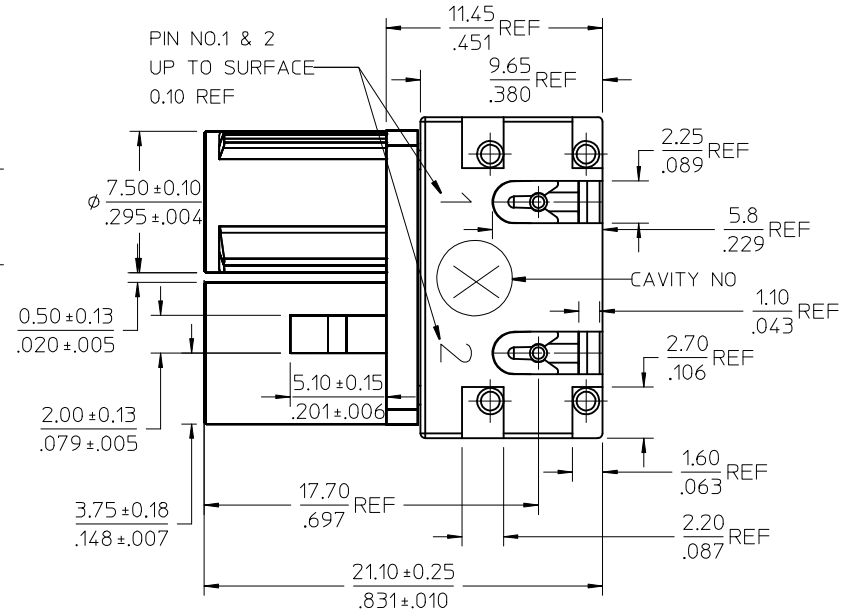
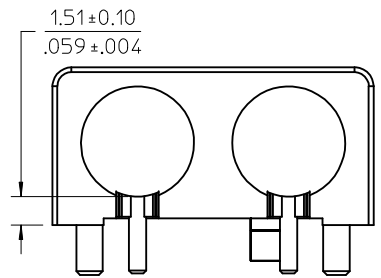
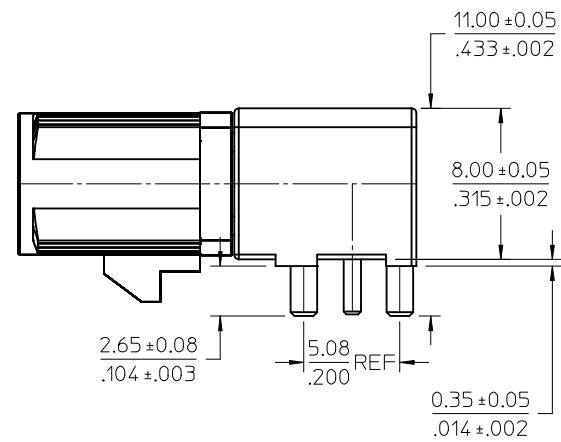
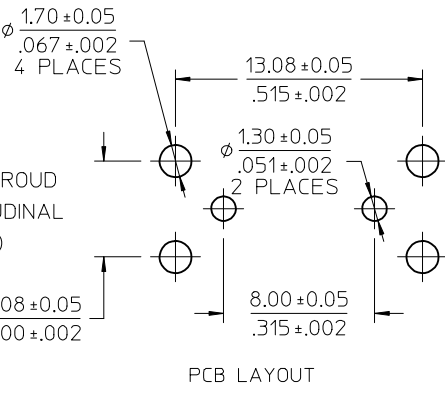
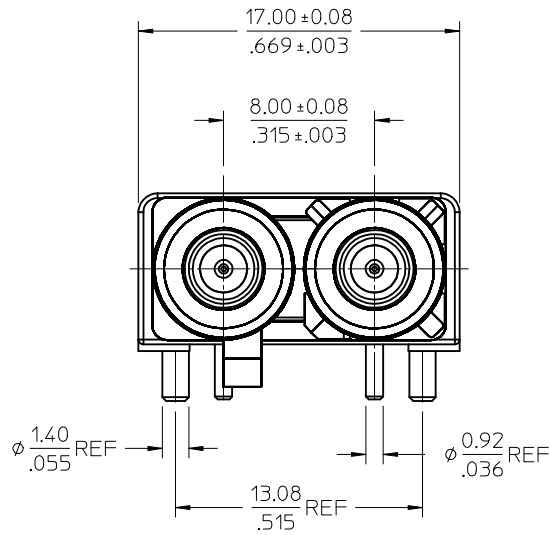

|                          |                         |
|--------------------------|-------------------------|
| PS-89675-3310            | PRODUCT SPECIFICATION   |
| MIL-STD-348A, FIG. 311.1 | INTERFACE SPECIFICATION |
| SPECIFICATION            | DESCRIPTION             |

|  |     |             |
|--|-----|-------------|
| CHG: NEW RELEASED<br>EC NO: URF2010-0019<br>DRWN: MCHANOS<br>CHKD: 2009/07/14<br>APPR: MHIUANG<br>2009/07/14 | REV | DESCRIPTION |
|  | A   |             |
|  |     |             |
|  |     |             |

|                 |                          |
|-----------------|--------------------------|
| QUALITY SYMBOLS | $\nabla=0$<br>$\nabla=0$ |
|-----------------|--------------------------|

|                                       |   |          |    |      |          |        |         |          |        |         |          |        |          |         |        |          |
|---------------------------------------|---|----------|----|------|----------|--------|---------|----------|--------|---------|----------|--------|----------|---------|--------|----------|
| GENERAL TOLERANCES (UNLESS SPECIFIED) | <table border="1"> <tr> <td></td> <td>mm</td> <td>INCH</td> </tr> <tr> <td>4 PLACES</td> <td>± .005</td> <td>± .0002</td> </tr> <tr> <td>3 PLACES</td> <td>± .003</td> <td>± .0001</td> </tr> <tr> <td>2 PLACES</td> <td>± .002</td> <td>± .00008</td> </tr> <tr> <td>1 PLACE</td> <td>± .001</td> <td>± .00004</td> </tr> </table> |          | mm | INCH | 4 PLACES | ± .005 | ± .0002 | 3 PLACES | ± .003 | ± .0001 | 2 PLACES | ± .002 | ± .00008 | 1 PLACE | ± .001 | ± .00004 |
|                                       | mm  | INCH     |    |      |          |        |         |          |        |         |          |        |          |         |        |          |
| 4 PLACES                              | ± .005  | ± .0002  |    |      |          |        |         |          |        |         |          |        |          |         |        |          |
| 3 PLACES                              | ± .003  | ± .0001  |    |      |          |        |         |          |        |         |          |        |          |         |        |          |
| 2 PLACES                              | ± .002  | ± .00008 |    |      |          |        |         |          |        |         |          |        |          |         |        |          |
| 1 PLACE                               | ± .001  | ± .00004 |    |      |          |        |         |          |        |         |          |        |          |         |        |          |
| ANGULAR                               | ± 2°  |          |    |      |          |        |         |          |        |         |          |        |          |         |        |          |
| DRAFT WHERE APPLICABLE                | MUST REMAIN WITHIN DIMENSIONS   |          |    |      |          |        |         |          |        |         |          |        |          |         |        |          |

|                 |            |
|-----------------|------------|
| DIMENSION STYLE | MM/IN      |
| DRAWN BY        | JOYCE      |
| DATE            | 2009/04/27 |
| CHECKED BY      | KERRIE     |
| DATE            | 2009/04/27 |
| APPROVED BY     | MISEN      |
| DATE            | 2009/04/27 |
| MATERIAL NO.    | SEE TABLE  |

|   |              |                        |
|---|--------------|------------------------|
| SCALE   | DESIGN UNITS | THIRD ANGLE PROJECTION |
|   | METRIC       |                        |
| TITLE   |              |                        |
| SMB JACK, FAKRA DUAL R/A PCB, UPSIDE DOWN 50 OHMS, SMB-J/PCB  |              |                        |
| MOLEX INCORPORATED  |              |                        |
| MATERIAL NO.  | DOCUMENT NO. | SHEET NO.              |
| SEE TABLE   | SD-73403-529 | 1 OF 2                 |
| THIS DRAWING CONTAINS INFORMATION THAT IS PROPRIETARY TO MOLEX INCORPORATED AND SHOULD NOT BE USED WITHOUT WRITTEN PERMISSION |              |                        |

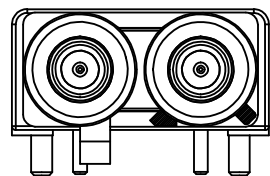

CODE-A

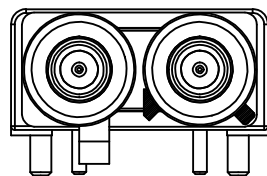

CODE-B

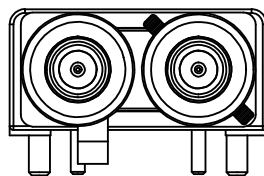

CODE-C

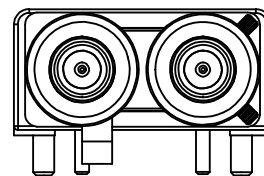

CODE-D

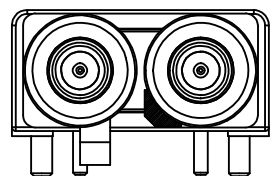

CODE-E

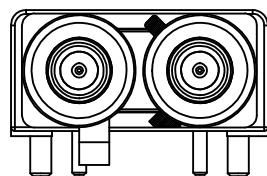

CODE-F

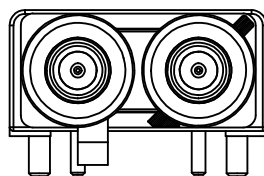

CODE-G

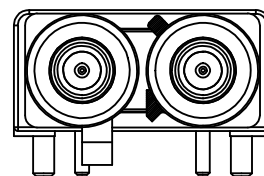

CODE-H

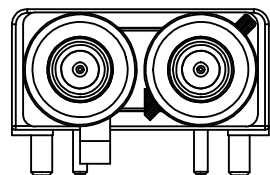

CODE-I

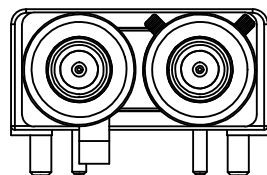

CODE-K

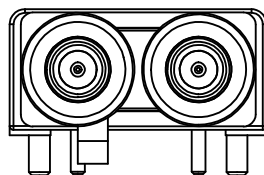

CODE-Z

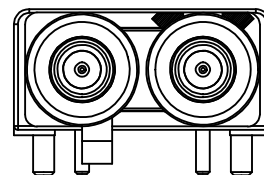

CODE-L

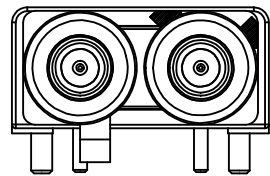

CODE-M

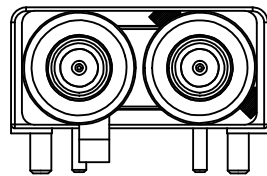

CODE-N

|             |                |            |
|-------------|----------------|------------|
| N           | PASTEL GREEN   | 73403-5303 |
| M           | PASTEL ORANGE  | 73403-5302 |
| L           | CARMINE RED    | 73403-5301 |
| Z           | WATER BLUE     | 73403-5300 |
| K           | CURRY YELLOW   | 73403-5299 |
| I           | BEIGE          | 73403-5298 |
| H           | VIOLET         | 73403-5297 |
| G           | GRAY           | 73403-5296 |
| F           | BROWN          | 73403-5295 |
| E           | GREEN          | 73403-5294 |
| D           | BORDEAUXVIOLET | 73403-5293 |
| C           | BLUE           | 73403-5292 |
| B           | CREAM WHITE    | 73403-5291 |
| A           | BLACK          | 73403-5290 |
| KEYING CODE | COLOR          | PART NO.   |

|   |                               |  |   |                     |      |          |       |       |          |       |       |          |       |       |         |       |       |                          |                                 |                        |
|---|-------------------------------|--|---|---------------------|------|----------|-------|-------|----------|-------|-------|----------|-------|-------|---------|-------|-------|--------------------------|---------------------------------|------------------------|
| SEE SHEET 1<br>EC NO: URF2010-0019<br>DRAWN: CHANOS 2009/07/14<br>CHKD: 2009/07/14<br>APPR: MHIANG 2009/07/14<br>REV: A | QUALITY SYMBOLS<br>▽=0<br>▽=0 | GENERAL TOLERANCES (UNLESS SPECIFIED)<br><table border="1"> <tr> <td></td> <td>mm</td> <td>INCH</td> </tr> <tr> <td>4 PLACES</td> <td>± ---</td> <td>± ---</td> </tr> <tr> <td>3 PLACES</td> <td>± ---</td> <td>± ---</td> </tr> <tr> <td>2 PLACES</td> <td>± ---</td> <td>± ---</td> </tr> <tr> <td>1 PLACE</td> <td>± ---</td> <td>± ---</td> </tr> </table> |   | mm                  | INCH | 4 PLACES | ± --- | ± --- | 3 PLACES | ± --- | ± --- | 2 PLACES | ± --- | ± --- | 1 PLACE | ± --- | ± --- | DIMENSION STYLE<br>MM/IN | SCALE<br>DESIGN UNITS<br>METRIC | THIRD ANGLE PROJECTION |
|   |                               | mm   | INCH  |                     |      |          |       |       |          |       |       |          |       |       |         |       |       |                          |                                 |                        |
|   | 4 PLACES                      | ± ---  | ± ---   |                     |      |          |       |       |          |       |       |          |       |       |         |       |       |                          |                                 |                        |
|   | 3 PLACES                      | ± ---  | ± ---   |                     |      |          |       |       |          |       |       |          |       |       |         |       |       |                          |                                 |                        |
| 2 PLACES  | ± ---                         | ± ---  |   |                     |      |          |       |       |          |       |       |          |       |       |         |       |       |                          |                                 |                        |
| 1 PLACE   | ± ---                         | ± ---  |   |                     |      |          |       |       |          |       |       |          |       |       |         |       |       |                          |                                 |                        |
|   |                               | DRAWN BY DATE<br>JOYCE 2009/04/27  | TITLE<br>SMB JACK, FAKRA DUAL<br>R/A PCB, UPSIDE DOWN<br>50 OHMS, SMB-J/PCB |                     |      |          |       |       |          |       |       |          |       |       |         |       |       |                          |                                 |                        |
|   |                               | CHECKED BY DATE<br>KERRIE 2009/04/27   | APPROVED BY DATE<br>MISEN 2009/04/27  | MOLEX INCORPORATED  |      |          |       |       |          |       |       |          |       |       |         |       |       |                          |                                 |                        |
|   |                               | MATERIAL NO.<br>SEE TABLE  | DOCUMENT NO.<br>SD-73403-529  | SHEET NO.<br>2 OF 2 |      |          |       |       |          |       |       |          |       |       |         |       |       |                          |                                 |                        |

DRAFT WHERE APPLICABLE  
MUST REMAIN  
WITHIN DIMENSIONS

THIS DRAWING CONTAINS INFORMATION THAT IS PROPRIETARY TO MOLEX INCORPORATED AND SHOULD NOT BE USED WITHOUT WRITTEN PERMISSION

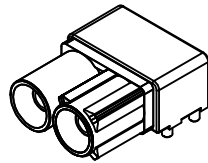

P/N 73403-529X

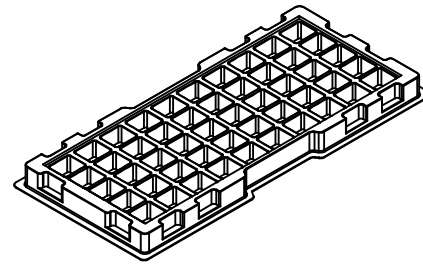

50 SET PER TRAY  
 TRAY P/N 89707-0343  
 OUTSIDE DIMENSION  
 360MM REF X 165MM REF X 22MM REF

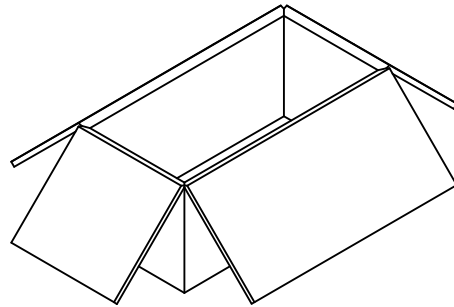

400 SET PER INNER  
 CARTON BOX  
 P/N 96707-0001  
 OUTSIDE DIMENSION  
 371MM REF X 184MM REF X 192MM REF

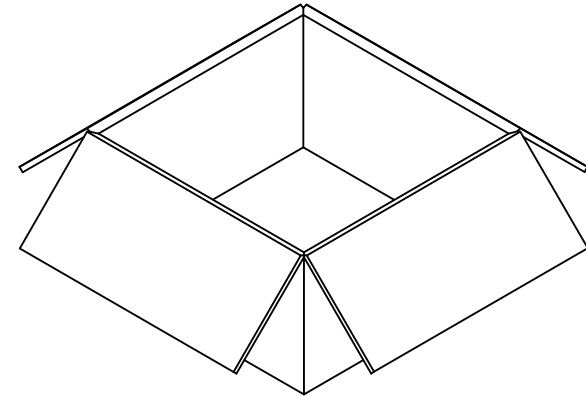

800 SET PER OUTER  
 CARTON BOX  
 P/N 96708-0005  
 OUTSIDE DIMENSION  
 394MM REF X 391MM REF X 212MM REF

CHG: NEW RELEASED  
 PER PDR0904267

|     |                     |            |             |
|-----|---------------------|------------|-------------|
| REV | EC NO: URF2010-0019 | 2009/07/14 | DESCRIPTION |
|     | DRWINCHAN05         | 2009/07/14 |             |
|     | CHKD:               | 2009/07/14 |             |
|     | APPR:MHUANG         | 2009/07/14 |             |

|                 |
|-----------------|
| QUALITY SYMBOLS |
| ▽=0             |
| ▽=0             |

|  |             |
|--|-------------|
| GENERAL TOLERANCES (UNLESS SPECIFIED)                |             |
|  | mm INCH     |
| 4 PLACES   | ± --- ± --- |
| 3 PLACES   | ± --- ± --- |
| 2 PLACES   | ± --- ± --- |
| 1 PLACE  | ± --- ± --- |
| ANGULAR ± 2 °  |             |
| DRAFT WHERE APPLICABLE MUST REMAIN WITHIN DIMENSIONS |             |

|                 |            |
|-----------------|------------|
| DIMENSION STYLE |            |
| MM/IN           |            |
| DRAWN BY        | DATE       |
| JOYCE           | 2009/04/27 |
| CHECKED BY      | DATE       |
| KERRIE          | 2009/04/27 |
| APPROVED BY     | DATE       |
| MISEN           | 2009/04/27 |
| MATERIAL NO.    | -----      |

|   |              |                        |
|---|--------------|------------------------|
| SCALE   | DESIGN UNITS | THIRD ANGLE PROJECTION |
|   | METRIC       |                        |
| TITLE   |              |                        |
| PACKAGING FOR 73403-529X  |              |                        |
| MOLEX INCORPORATED  |              | SHEET NO.              |
| SD-73403-529-PKG  |              | 1 OF 1                 |
| THIS DRAWING CONTAINS INFORMATION THAT IS PROPRIETARY TO MOLEX INCORPORATED AND SHOULD NOT BE USED WITHOUT WRITTEN PERMISSION |              |                        |