

THIS DRAWING IS A CONTROLLED DOCUMENT FOR SOURIAU USA, INC. IT IS SUBJECT TO CHANGE WITHOUT NOTICE. CONTACT THE DOCUMENT CONTROL CENTER FOR THE LATEST REVISION.

DWG. NO. **JBXFH2C**

C

B

THE INFORMATION CONTAINED IN THIS DRAWING IS CONFIDENTIAL AND MAY NOT BE DISCLOSED WITHOUT WRITTEN CONSENT FROM SOURIAU USA, INC.

**ELECTRICAL:**

EMI SHIELDING : SHIELDED FOR THE RANGE 55dB UP TO 100MHZ  
 INSULATION RESISTANCE : >500MΩ PER ANSI-EIA-364-D METHOD 21  
 MAX. CURRENT RATING : SEE INSULATOR DRAWING  
 CONNECTOR TESTING VOLTAGE : SEE INSULATOR DRAWING  
 CONNECTOR WORKING VOLTAGE : SEE INSULATOR DRAWING

**PHYSICAL:**

MAXIMUM WIRE SIZE USED : SEE INSULATOR DRAWING  
 CABLE DIAMETER WITH PLASTIC COLLET SET SUPPLIED: Ø3.5mm MIN. TO Ø9.7mm MAX.

**ENVIRONMENTAL:**

ENDURANCE: 1000 CYCLES AS PER MIL-STD 1344A, METHOD 2016.1  
 SHOCK: 50 g , DURATION 6 ms; AS PER MIL-STD 1344A, METHOD 2004.1  
 VIBRATIONS: 10 TO 2000Hz g = 15g, AS PER MIL-STD 1344A, METHOD 2005.1  
 PROTECTION INDEX: IP 67 AS PER CEI 529  
 ROHS COMPLIANT  
 SALT MIST : 48Hr PER SAE AS 1344 METHOD 1001.1 CEI 529  
 OPERATING TEMPERATURE:  
 WITH PLASTIC COLLETS: -40°C TO +80°C (-40°F TO +176°F)

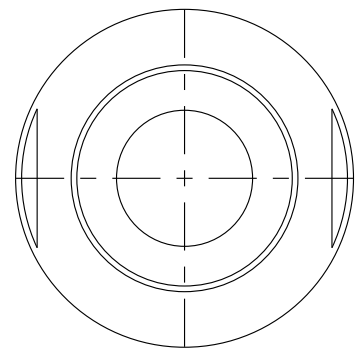

WIRE SIDE VIEW

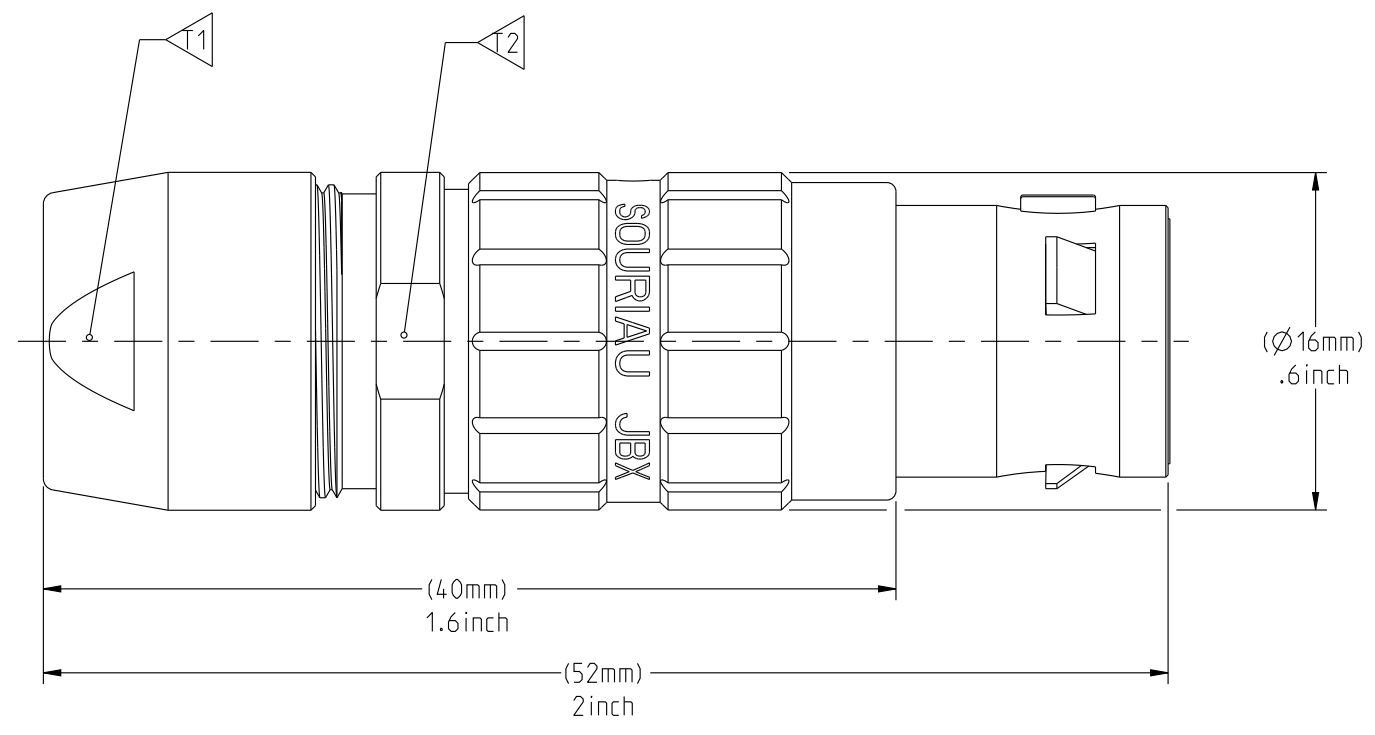

(ASSEMBLED VIEW FOR INFORMATION ONLY)

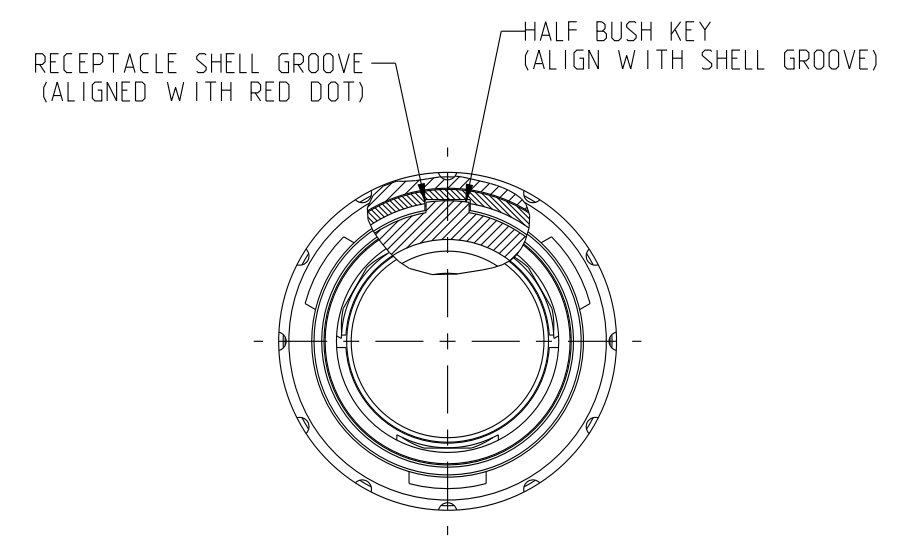

MATING SIDE VIEW

| PART LIST |  |
|-----------|--|
| ITEM NO.  | DESCRIPTION                                    |
| 1         | SLEEVE   |
| 2         | HALF BUSH WITH WINDOW                          |
| 3         | HALF BUSH WITHOUT WINDOW                       |
| 4         | INSULATOR                                      |
| 5         | Ø3.5-Ø9.7 CABLE COLLET (CHOOSE PER CABLE SIZE) |
| 6         | STANDARD BACK NUT                              |
| 6a        | BACK NUT FOR PROTECTIVE BOOT (OPTIONAL)        |

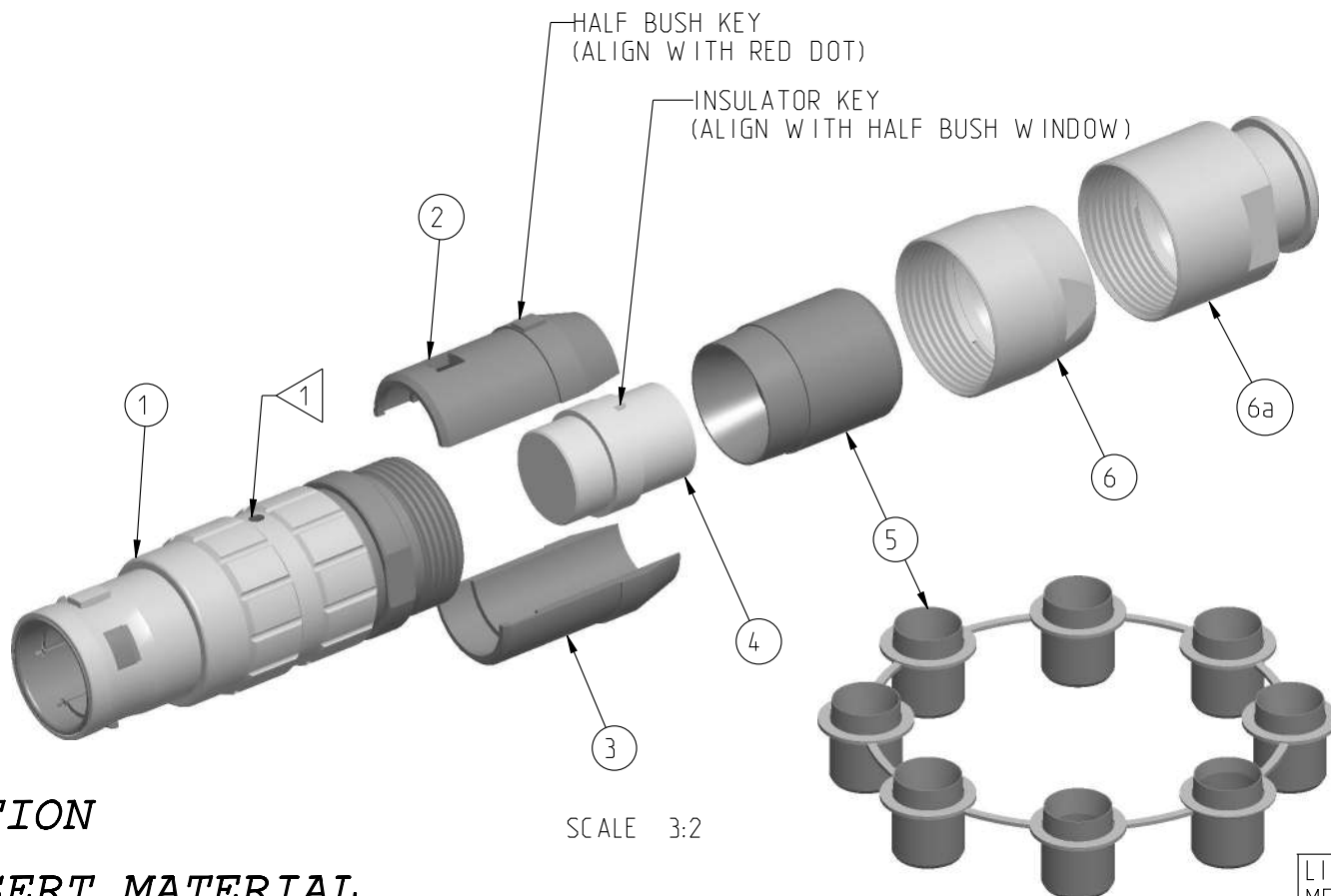

SCALE 3:2

COLLET SET SCALE 4:5

|    | TOOLS (JAW DIMENSION) | ADVISED TORQUE IN Nm |
|----|-----------------------|----------------------|
| T1 | 13                    | 1.5                  |
| T2 | 14                    | -                    |

**CATALOG NUMBER DESCRIPTION**

**JBX FH 2 XXXXXDXX**

**BASIC SERIES** \_\_\_\_\_ **OPTION**  
**SHELL TYPE** \_\_\_\_\_ **INSERT MATERIAL**  
**SHELL SIZE** \_\_\_\_\_ **COLLET OPTION**  
**KEYING** \_\_\_\_\_ **SURFACE PLATING**  
**SEE INSULATOR DRAWING**

| ORIGIN | COUNTRY | JURISDICTION | CLASSIFICATION |
|--------|---------|--------------|----------------|
| X      | FR      | Not listed   | N/A            |
|        | US      | EAR          | ECCN =EAR99    |

These commodities, technology or software are exported from the United States in accordance with the Export Administration Regulations. Diversion contrary to U.S. law is prohibited.

LINEAR MEASURE:  $\frac{mm}{(INCH)}$  mm (INCH)  
 THIRD ANGLE PROJECTION  
 TOLERANCES UNLESS OTHERWISE SPECIFIED  
 No. OF PLACES mm [INCH]  
 WHOLE No. ±0.5 [±.02]  
 ONE PLACE ±0.2 [±.008]  
 TWO PLACES ±0.1 [±.004]  
 ANGLES ±1°

| A   | RELEASED PER ECN 12280 | TJS 06-10-15 | EV 06-10-15 |
|-----|------------------------|--------------|-------------|
| REV | DESCRIPTION            | BY DATE      | CHKD DATE   |

DRAWING TITLE: **JBX, SIZE 2, SEALED STRAIGHT PLUG**

CAT NO. **JBXFH2**

CAGE NO: 09922 SIZE: C

**CUSTOMER**

INTERPRET THIS DRAWING IN ACCORDANCE WITH ASME Y14.5M - 1994.

**SOURIAU**  
www.souriau.com

APPROVAL  
 DRAWN: TJS 05-08-15  
 CHKD : EV 05-08-15  
 DSGN : EV 05-08-15  
 MFG : DH 05-08-15  
 QC : BB 05-08-15  
 DRAWING SCALE: 4:1  
 DRAWING NO. REV  
**JBXFH2C** A

1 OF 1

4

3

2

1

PRO-E

DWG. NO.  
JBX2INSMCC

**MALE INSULATOR, CRIMP CONTACT**

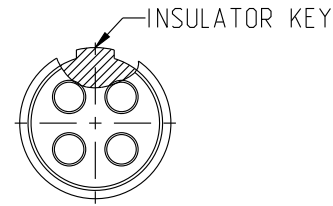
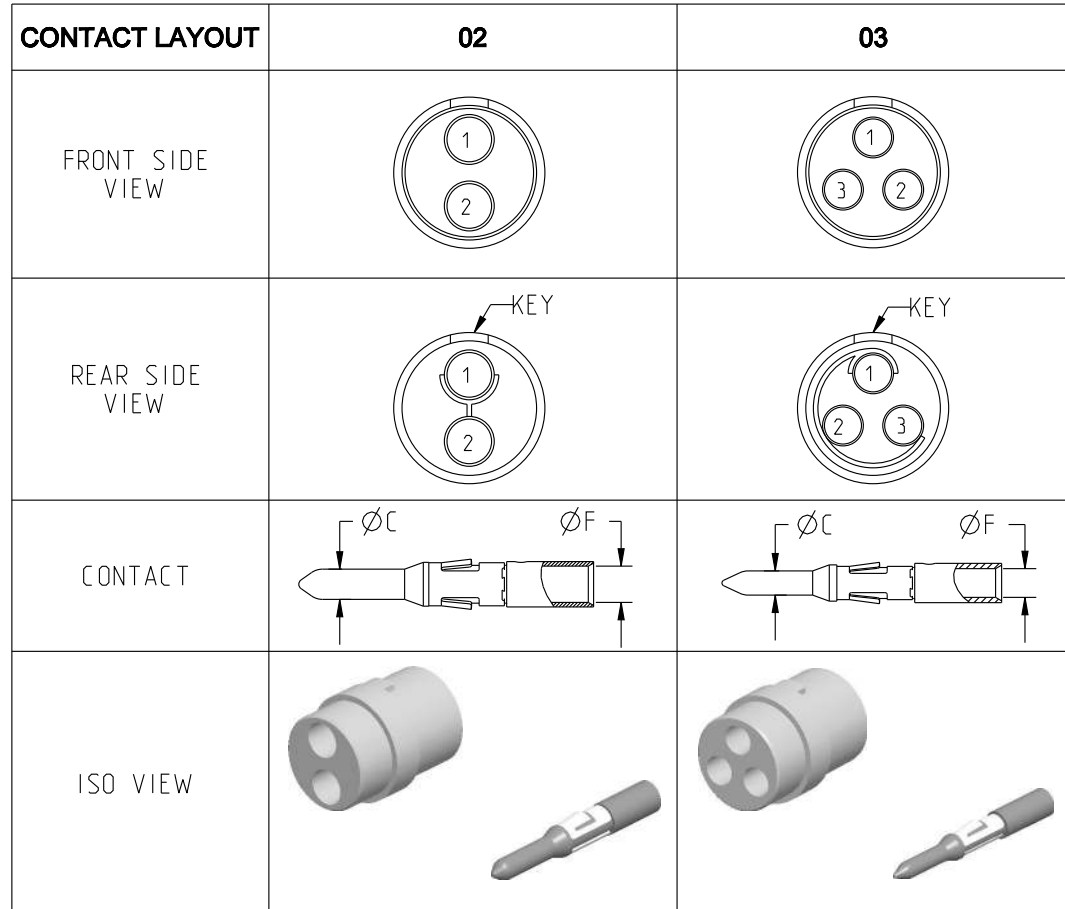

**CONTACT TYPE :** M (MALE)  
**CONTACT TERMINATION :** C (CRIMP)  
**MATERIAL :**  
 CONTACT: BRASS  
 CLIP: COPPER ALLOY  
 INSULATOR: PEEK  
**FINISH :**  
 CONTACTS: GOLD

**CATALOG NUMBER DESCRIPTION**

**JBXXX 2 XYYM CXXXX**

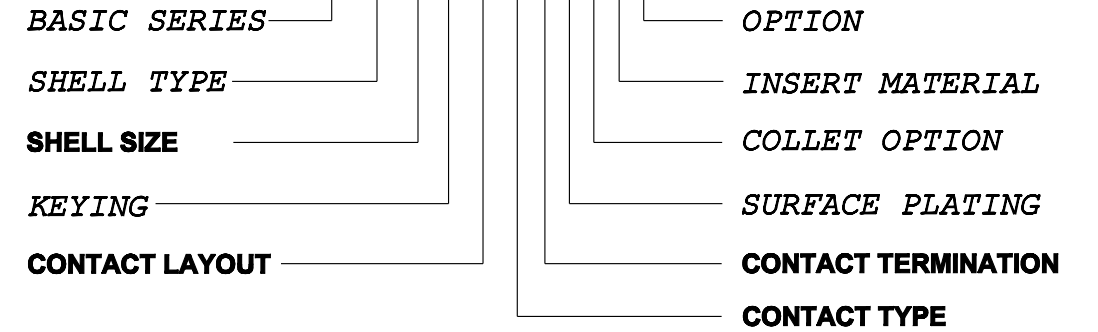

|                            | 02       | 03      |
|----------------------------|----------|---------|
| CONTACT                    |          |         |
| ØC                         | 2        | 1.6     |
| ØF                         | 2.4      | 1.9     |
| MAX. AWG                   | 12       | 14      |
| MAX. CURRENT RATING (A)    | 30       | 17      |
| CONTACT RESISTANCE (mΩ)    | 2.5      | 2.5     |
| INSULATOR                  |          |         |
| NUMBER OF CAVITY           | 2        | 3       |
| MAX. CURRENT RATING        | 30       | 17      |
| TEST VOLTAGE (Vrms)        | 2100     | 1700    |
| WORKING VOLTAGE (Vdc/Vrms) | 1000/700 | 830/560 |

| REV | DESCRIPTION            | BY DATE      | CHKD DATE   |
|-----|------------------------|--------------|-------------|
| B   | REVISED PER ECN 12286  | RSK 06-10-15 | EV 06-10-15 |
| A   | RELEASED PER ECN 12264 | SKV 03-10-15 | EV 03-10-15 |

THIS DRAWING IS A CONTROLLED DOCUMENT FOR SOURIAU USA, INC. IT IS SUBJECT TO CHANGE WITHOUT NOTIFICATION. CONTACT THE DOCUMENT CONTROL CENTER FOR THE LATEST REVISION.

THE INFORMATION CONTAINED IN THIS DRAWING IS CONFIDENTIAL AND MAY NOT BE DISCLOSED WITHOUT WRITTEN CONSENT FROM SOURIAU USA, INC.

B

A

LINEAR MEASURE:  $\frac{mm}{INCH}$  mm (INCH)

THIRD ANGLE PROJECTION

TOLERANCES UNLESS OTHERWISE SPECIFIED

| No. OF PLACES | mm [INCH]     |
|---------------|---------------|
| ONE PLACE     | ±3 [±.1]      |
| TWO PLACES    | ±0.5 [±.02]   |
| THREE PLACES  | ±0.25 [±.010] |

ANGLES ±1°

| ORIGIN | COUNTRY | JURISDICTION | CLASSIFICATION |
|--------|---------|--------------|----------------|
| X      | FR      | Not listed   | N/A            |
|        | US      | EAR          | ECCN =EAR99    |

These commodities, technology or software are exported from the United States in accordance with the Export Administration Regulations. Diversion contrary to U.S. law is prohibited

DRAWING TITLE  
**JBX, SIZE 2, MALE INSULATOR, CRIMP CONTACT**

CAT NO. **JBX2INSMC**

CAGE NO: 09922    SIZE: B

**CUSTOMER**

**SOURIAU**

WWW.SOURIAU.COM

INTERPRET THIS DRAWING IN ACCORDANCE WITH ASME Y14.5M - 1994.

| APPROVAL | DRAWN:            | SKV | 02-02-15 |
|----------|-------------------|-----|----------|
|          | CHKD :            | EV  | 02-02-15 |
|          | DSGN :            | EV  | 02-02-15 |
|          | MFG :             | DH  | 02-02-15 |
|          | QC :              | BB  | 02-02-15 |
|          | DRAWING SCALE: NA |     |          |
|          | DRAWING NO.       |     | REV      |
|          | JBX2INSMCC        |     | B        |
|          | 1 OF 3            |     |          |

THIS DRAWING IS A CONTROLLED DOCUMENT FOR SOURIAU USA, INC. IT IS SUBJECT TO CHANGE WITHOUT NOTIFICATION. CONTACT THE DOCUMENT CONTROL CENTER FOR THE LATEST REVISION.

THE INFORMATION CONTAINED IN THIS DRAWING IS CONFIDENTIAL AND MAY NOT BE DISCLOSED WITHOUT WRITTEN CONSENT FROM SOURIAU USA, INC.

DWG. NO.  
JBX2INSMCC

|                            | 2                       |         |         |         | 1       |         |  |
|----------------------------|-------------------------|---------|---------|---------|---------|---------|--|
| CONTACT LAYOUT             | 04                      | 05      | 06      | 07      | 08      | 10      |  |
| FRONT SIDE VIEW            |                         |         |         |         |         |         |  |
| REAR SIDE VIEW             |                         |         |         |         |         |         |  |
| CONTACT                    |                         |         |         |         |         |         |  |
| ISO VIEW                   |                         |         |         |         |         |         |  |
| CONTACT                    | ØC                      | 1.3     | 1.3     | 1.3     | 0.9     | 0.9     |  |
|                            | ØF                      | 1.4     | 1.4     | 1.4     | 1.1     | 1.1     |  |
|                            | MAX. AWG                | 18      | 18      | 18      | 20      | 20      |  |
|                            | MAX. CURRENT RATING (A) | 15      | 15      | 15      | 10      | 10      |  |
| INSULATOR                  | CONTACT RESISTANCE (mΩ) | 3       | 3       | 3       | 3.5     | 3.5     |  |
|                            | NUMBER OF CAVITY        | 4       | 5       | 6       | 7       | 10      |  |
|                            | MAX. CURRENT RATING     | 15      | 14      | 12      | 11      | 10      |  |
|                            | TEST VOLTAGE (Vrms)     | 2400    | 1900    | 1900    | 1500    | 1700    |  |
| WORKING VOLTAGE (Vdc/Vrms) | 1000/700                | 900/630 | 900/630 | 730/500 | 830/560 | 830/560 |  |

| ORIGIN | COUNTRY | JURISDICTION | CLASSIFICATION |
|--------|---------|--------------|----------------|
| X      | FR      | Not listed   | N/A            |
|        | US      | EAR          | ECCN =EAR99    |

These commodities, technology or software are exported from the United States in accordance with the Export Administration Regulations. Diversion contrary to U.S. law is prohibited.

LINEAR MEASURE:

THIRD ANGLE PROJECTION

TOLERANCES UNLESS OTHERWISE SPECIFIED

| No. OF PLACES | mm [INCH]     |
|---------------|---------------|
| ONE PLACE     | ±3 [±.1]      |
| TWO PLACES    | ±0.5 [±.02]   |
| THREE PLACES  | ±0.25 [±.010] |

ANGLES ±1°

DRAWING TITLE  
**JBX, SIZE 2, MALE INSULATOR, CRIMP CONTACT**

CAT NO. **JBX2INSMC**

CAGE NO: 09922      SIZE: B

**CUSTOMER**

**SOURIAU**

WWW.SOURIAU.COM

INTERPRET THIS DRAWING IN ACCORDANCE WITH ASME Y14.5M - 1994.

|          |                   |          |
|----------|-------------------|----------|
| APPROVAL | DRAWN: SKV        | 02-02-15 |
|          | CHKD : EV         | 02-02-15 |
|          | DSGN : EV         | 02-02-15 |
|          | MFG : DH          | 02-02-15 |
|          | QC : BB           | 02-02-15 |
|          | DRAWING SCALE: NA |          |
|          | DRAWING NO.       | REV      |
|          | JBX2INSMCC        | B        |

2 OF 3

B

A

DWG. NO.  
JBX2INSMCC

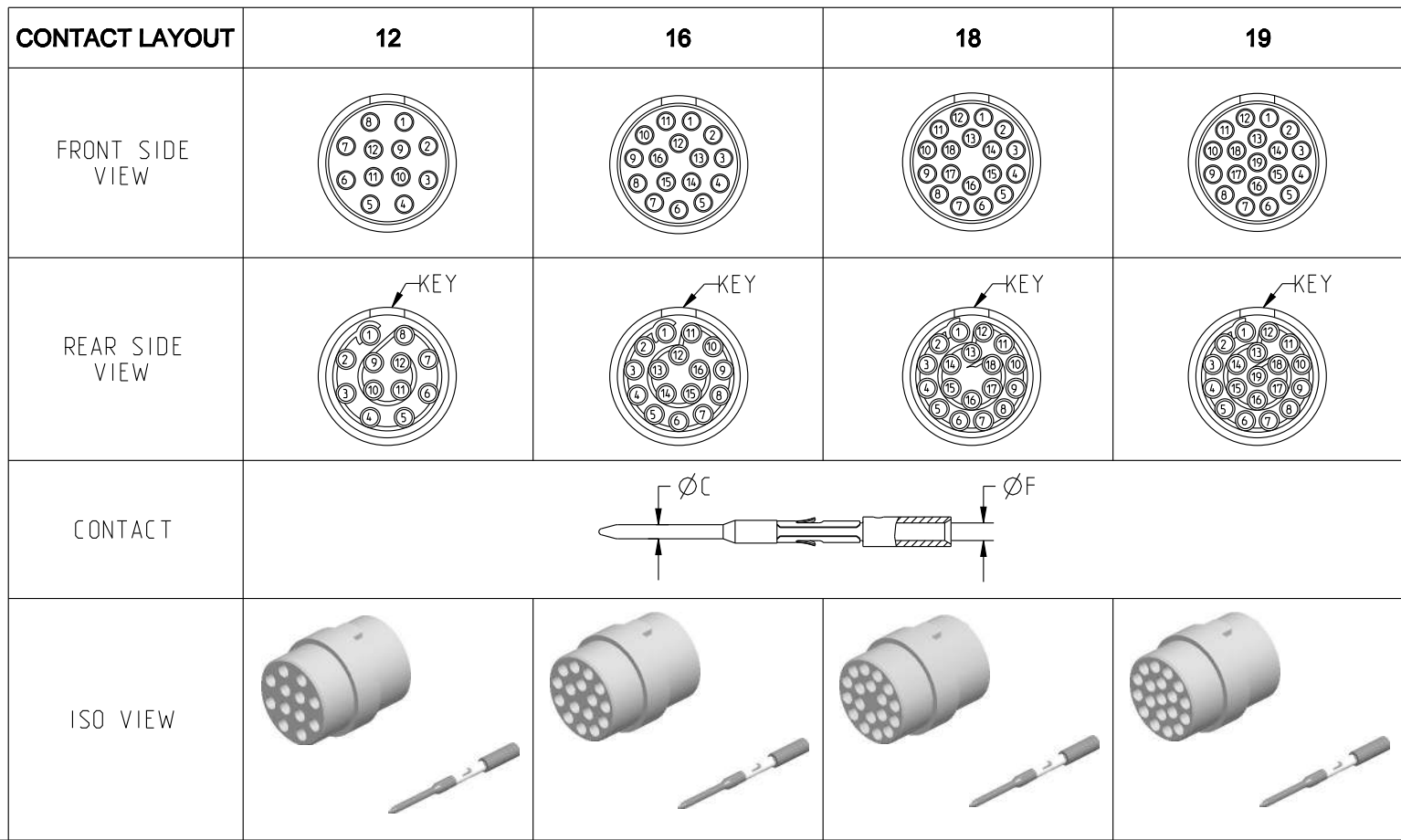

|           |                            |         |         |         |         |
|-----------|----------------------------|---------|---------|---------|---------|
| CONTACT   | ØC                         | 0.7     | 0.7     | 0.7     | 0.7     |
|           | ØF                         | 0.85    | 0.85    | 0.85    | 0.85    |
|           | MAX. AWG                   | 22      | 22      | 22      | 22      |
|           | MAX. CURRENT RATING (A)    | 7       | 7       | 7       | 7       |
| INSULATOR | CONTACT RESISTANCE (mΩ)    | 5       | 5       | 5       | 5       |
|           | NUMBER OF CAVITY           | 12      | 16      | 18      | 19      |
|           | MAX. CURRENT RATING        | 7       | 6       | 5.5     | 5       |
|           | TEST VOLTAGE (Vrms)        | 1700    | 1500    | 1400    | 1400    |
|           | WORKING VOLTAGE (Vdc/Vrms) | 830/560 | 730/500 | 660/460 | 660/460 |

THIS DRAWING IS A CONTROLLED DOCUMENT FOR SOURIAU USA, INC. IT IS SUBJECT TO CHANGE WITHOUT NOTIFICATION. CONTACT THE DOCUMENT CONTROL CENTER FOR THE LATEST REVISION.

THE INFORMATION CONTAINED IN THIS DRAWING IS CONFIDENTIAL AND MAY NOT BE DISCLOSED WITHOUT WRITTEN CONSENT FROM SOURIAU USA, INC.

B

A

|   |                     |   |                |
|---|---------------------|---|----------------|
| DRAWING TITLE   |                     | <b>JBX, SIZE 2, MALE INSULATOR, CRIMP CONTACT</b> |                |
| CAT NO.   |                     | <b>JBX2INSMC</b>                                  |                |
| CAGE NO: 09922  | SIZE: B             | <b>CUSTOMER</b>                                   | <b>SOURIAU</b> |
| INTERPRET THIS DRAWING IN ACCORDANCE WITH ASME Y14.5M - 1994. |                     |   |                |
| APPROVAL  | DRAWN: SKV 02-02-15 | DRAWING SCALE: NA                                 |                |
|   | CHKD : EV 02-02-15  | DRAWING NO. REV                                   |                |
|   | DSGN : EV 02-02-15  | JBX2INSMCC B                                      |                |
|   | MFG : DH 02-02-15   | 3 OF 3  |                |
|   | QC : BB 02-02-15    | <b>PRO-E</b>                                      |                |

LINEAR MEASURE:  $\frac{mm}{INCH}$  mm (INCH)

THIRD ANGLE PROJECTION

TOLERANCES UNLESS OTHERWISE SPECIFIED

|               |               |
|---------------|---------------|
| No. OF PLACES | mm [INCH]     |
| ONE PLACE     | ±3 [±.1]      |
| TWO PLACES    | ±0.5 [±.02]   |
| THREE PLACES  | ±0.25 [±.010] |

ANGLES ±1°

| ORIGIN | COUNTRY | JURISDICTION | CLASSIFICATION |
|--------|---------|--------------|----------------|
| X      | FR      | Not listed   | N/A            |
|        | US      | EAR          | ECCN =EAR99    |

These commodities, technology or software are exported from the United States in accordance with the Export Administration Regulations. Diversion contrary to U.S. law is prohibited