

# FBS 3-4 BU - Plug-in bridge



3030130

<https://www.phoenixcontact.com/us/products/3030130>

Please be informed that the data shown in this PDF document is generated from our online catalog. Please find the complete data in the user documentation. Our general terms of use for downloads are valid.



Plug-in bridge, pitch: 4.2 mm, number of positions: 3, color: blue

## Your advantages

- The 2- to 50-pos. jumpers can bridge up to 50 terminal blocks in the two bridge shafts of the CLIPLINE complete system in one step

## Commercial data

Item number	3030130
Packing unit	1 pc
Minimum order quantity	50 pc
Sales key	BE29
Product key	BE2Z2X
Catalog page	Page 403 (C-1-2019)
GTIN	4046356661676
Weight per piece (including packing)	1.81 g
Weight per piece (excluding packing)	1.751 g
Customs tariff number	85366990
Country of origin	DE

## Technical data

### Product properties

Product type	Jumper
Number of positions	3
Pitch	4.2 mm

### Electrical properties

Maximum load current	17.5 A (The current values for the jumpers can deviate when used in different modular terminal blocks. The precise values can be found in the accessories data for the respective modular terminal blocks.)
----------------------	---

### Connection data

Maximum load current	17.5 A (The current values for the jumpers can deviate when used in different modular terminal blocks. The precise values can be found in the accessories data for the respective modular terminal blocks.)
----------------------	---

### Dimensions

Pitch	4.2 mm
-------	--------

### Material specifications

Color	blue
Material	Copper
Flammability rating according to UL 94	V0
Insulating material	PA

### Environmental and real-life conditions

#### Ambient conditions

Ambient temperature (operation)	-60 °C ... 105 °C
Ambient temperature (storage/transport)	-25 °C ... 60 °C (for a short time, not exceeding 24 h, -60 °C to +70 °C)
Ambient temperature (assembly)	-5 °C ... 70 °C
Ambient temperature (actuation)	-5 °C ... 70 °C
Permissible humidity (storage/transport)	30 % ... 70 %

### Mounting

Mounting type	Plug-in mounting
---------------	------------------

## Drawings

Schematic diagram

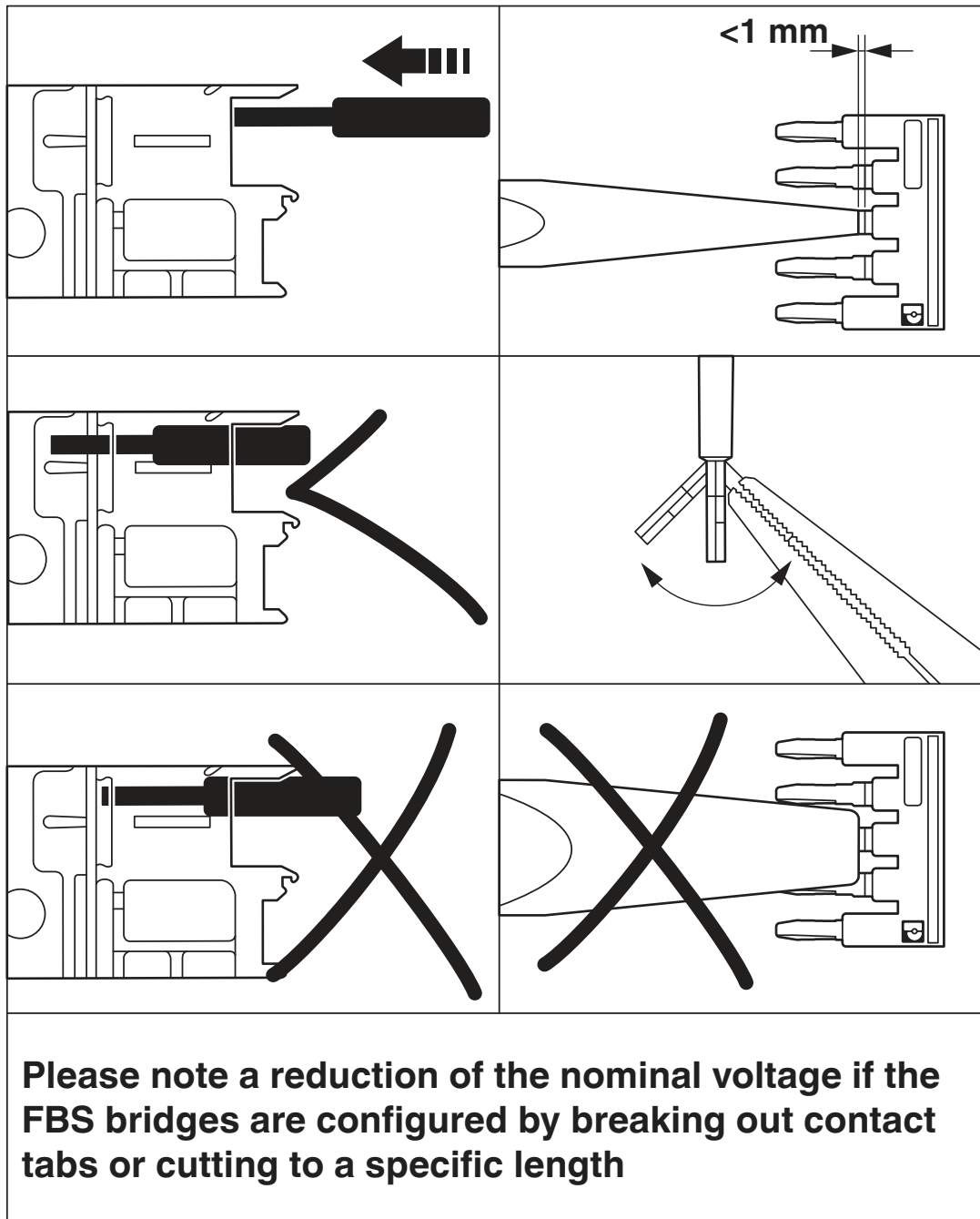

# FBS 3-4 BU - Plug-in bridge

3030130

<https://www.phoenixcontact.com/us/products/3030130>



## Classifications

### ECLASS

ECLASS-11.0	27141140
ECLASS-12.0	27141140
ECLASS-13.0	27250303

### ETIM

ETIM 8.0	EC000489
----------	----------

### UNSPSC

UNSPSC 21.0	39121400
-------------	----------

# FBS 3-4 BU - Plug-in bridge

3030130

<https://www.phoenixcontact.com/us/products/3030130>



## Environmental product compliance

China RoHS	Environmentally friendly use period: unlimited = EFUP-e No hazardous substances above threshold values
------------	---

# FBS 3-4 BU - Plug-in bridge

3030130

<https://www.phoenixcontact.com/us/products/3030130>



## Accessories

### CUTFOX-FBS - Front cutter

1212124

<https://www.phoenixcontact.com/us/products/1212124>



**Cutting tool**, for separating individual jumper bars from FBS ... plug-in bridges and EB ... insertion bridges

---

Phoenix Contact 2023 © - all rights reserved  
<https://www.phoenixcontact.com>

Phoenix Contact USA  
586 Fulling Mill Road  
Middletown, PA 17057, United States  
(+717) 944-1300  
[info@phoenixcon.com](mailto:info@phoenixcon.com)