

| ITEM | Q'TY | PART NUMBER | PART DESCRIPTION  |
|------|------|-------------|---|
| 1    | 1    | FLPR2-XX    | Flexible Light Pipe 2mm Adapter, Right Angle w/ LED, See page 2 |
| 2    | 1    | FLP25-XX.X  | Flexible Light Pipe Lens Cap Assembly, 2mm                      |

| REV. | DESCRIPTION                            | DATE     | APPROVED |
|------|--|----------|----------|
| A    | Engineering Release                    | 09/14/09 | T. Y.    |
| B    | Replaced 3UWC-0.6K-F with 3UWC1.035C-F | 04/26/12 | T. Y.    |
| C    | Updated Table For Length "L"           | 11/16/12 | T. Y.    |
| D    | Updated LED Optical Characteristics    | 09/15/15 | J. C.    |
| E    | Updated LED Tables                     | 08/15/18 | M. C.    |
| F    | Updated LED Tables                     | 11/13/18 | M. C.    |
| G    | Updated per EOL Notice                 | 07/10/20 | A. V.    |

**NOTE: FLPR2-XX ADAPTER SHIPPED NON-ASSEMBLED**

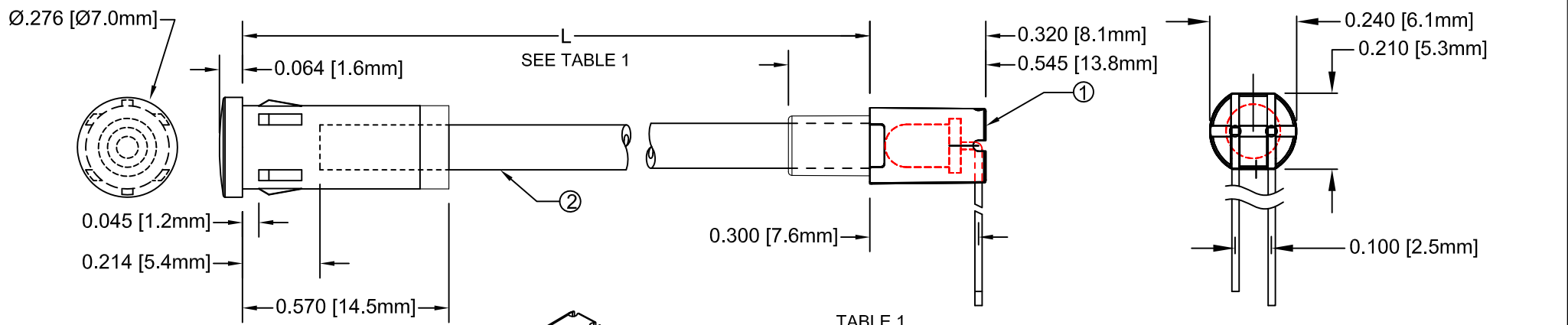
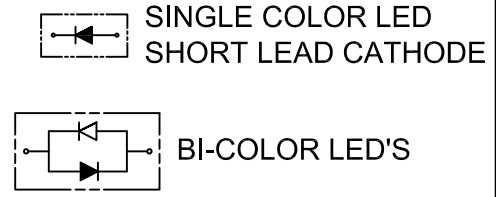

TABLE 1

| " L " *          | Tolerance |
|------------------|-----------|
| 1.0" ~ 16.0"     | ±0.050"   |
| 16.1" ~ 40.0"    | ±0.15"    |
| 40.1" ~ 80.0"    | ±0.30"    |
| 80.1" ~ 3,940.0" | ±0.5%     |

\* Available in 0.1" increments only



| SHORT LEAD CATHODE | LED PART NO. | LONG LEAD CATHODE |
|--------------------|--------------|-------------------|
| RED                | 3xBCC-F      | GREEN             |
| YELLOW             | 3BC-Y/G-F    | GREEN             |

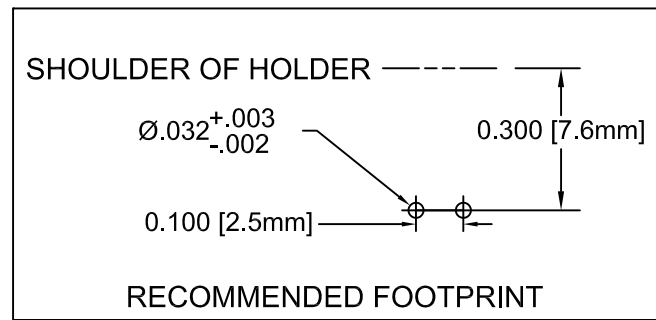
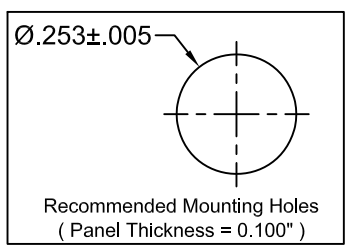

### ABSOLUTE MAXIMUM RATINGS (Ta=25°C)

|  |                      |
|--|----------------------|
| REVERSE VOLTAGE _____                              | 5V                   |
| REVERSE CURRENT _____                              | 100uA                |
| OPERATING TEMPERATURE RANGE _____                  | -25° C - 85° C       |
| STORAGE TEMPERATURE _____                          | -30° C - 100° C      |
| LEAD SOLDERING TEMPERATURE (1/16" FROM BODY) _____ | 260° C FOR 5 SECONDS |

|   |                |  |                |
|---|----------------|--|----------------|
| STANDARD TOLERANCE (UNLESS OTHERWISE SPECIFIED) |                | <br>4 THOMAS, IRVINE, CA. 92618<br>TEL: (949) 951-8808 FAX: (949) 951-3974 |                |
| DECIMALS  | ANGULAR        |  |                |
| .X ± .1   | X° ± 1°        | <br>TITLE: FLEXIBLE LIGHT PIPE ASSY,<br>7mm ROUND, RIGHT ANGLE             |                |
| .XX ± .02                                       |                |  |                |
| .XXX ± .010                                     |                |  |                |
| DESIGNED: B. OLIVER                             | DATE: 09/14/09 | PART NO: FLP25RX.X-XX  | REVISION: G    |
| REVISED: V. Chavez                              | DATE: 07/10/20 | CAGE CODE: 32559   |                |
| CHECKED: A. Valdez                              | DATE: 07/10/20 | SCALE: NONE  | SHEET # 1 OF 3 |

CAD GENERATED DOCUMENT, DO NOT MEASURE DRAWING

| FLEXIBLE LP ASSY<br>Part No. | ADAPTER Part<br>No. | LED Part No. | Peak Wave<br>Length | Emitted Color | Electro-Optical<br>Data @ 20mA |     |             |
|------------------------------|---------------------|--------------|---------------------|---------------|--------------------------------|-----|-------------|
|                              |                     |              | $\lambda_p$ (nm)    |               | Vf<br>(V)                      |     | Iv<br>(mcd) |
|                              |                     |              |                     |               | TYP                            | MAX | TYP         |
| FLP25RX.X-SG                 | FLPR2-SG            | 3SGC-F       | 568                 | SUPER GREEN   | 2.1                            | 2.8 | 50          |
| FLP25RX.X-SY                 | FLPR2-SY            | 3SYC-F       | 590                 | SUPER YELLOW  | 2.0                            | 2.8 | 50          |
| FLP25RX.X-SR                 | FLPR2-SR            | 3SRC-F       | 645                 | SUPER RED     | 1.7                            | 2.4 | 60          |
| FLP25RX.X-UT                 | FLPR2-UT            | 3UTC-F       | 500                 | TURQUOISE     | 3.5                            | 4.0 | 800         |
| FLP25RX.X-UG                 | FLPR2-UG            | 3UGC-F       | 570                 | GREEN         | 2.1                            | 2.4 | 200         |
| FLP25RX.X-SUG                | FLPR2-SUG           | 3SUGC-F      | 570                 | GREEN         | 2.1                            | 2.4 | 300         |
| FLP25RX.X-UY                 | FLPR2-UY            | 3UYC-F       | 590                 | YELLOW        | 2.0                            | 2.4 | 300         |
| FLP25RX.X-UR                 | FLPR2-UR            | 3URC-F       | 645                 | RED           | 1.7                            | 2.4 | 200         |
| FLP25RX.X-SUR                | FLPR2-SUR           | 3SURC-F      | 640                 | RED           | 1.8                            | 2.4 | 200         |
| FLP25RX.X-UW                 | FLPR2-UW            | 3UWC1.035C-F | -                   | WHITE         | 3.2                            | 3.6 | 6000        |

VISIT [WWW.BIVAR.COM](http://WWW.BIVAR.COM) FOR CURRENT LED DATASHEETS  
LED DETAILS ON DATASHEETS TAKE PRECEDENCE OVER DETAILS SHOWN HERE

FLEXIBLE LIGHT PIPE SERIES FLP25R X.X - XXX

Emitted Colors

"L" LENGTH, inches  
available in 0.1" increments only  
e.g. 6.0, 11.5

| FLEXIBLE LP ASSY<br>Part No. | Adapter Part No. | LED Part No. | Peak Wave<br>Length<br>$\lambda_p$ (nm) | Emitted Color | Electro-Optical Data<br>@ 20mA |     |             |
|------------------------------|------------------|--------------|---|---------------|--------------------------------|-----|-------------|
|                              |                  |              |   |               | Vf<br>(V)                      |     | Iv<br>(mcd) |
|                              |                  |              |   |               | TYP                            | MAX | TYP         |
| FLP25RX.X-BC                 | FLPR2-BC         | 3BCC-F       | 625                                     | HE RED        | 2.0                            | 2.8 | 8           |
|                              |                  |              | 568                                     | GREEN         | 2.1                            | 2.8 | 8           |
| FLP25RX.X-SBC                | FLPR2-SBC        | 3SBCC-F      | 645                                     | SUPER RED     | 1.7                            | 2.4 | 100         |
|                              |                  |              | 568                                     | HE GREEN      | 2.1                            | 2.8 | 60          |

VISIT [WWW.BIVAR.COM](http://WWW.BIVAR.COM) FOR CURRENT LED DATASHEETS  
LED DETAILS ON DATASHEETS TAKE PRECEDENCE OVER DETAILS SHOWN HERE

FLEXIBLE LIGHT PIPE SERIES FLP25R X.X - XXX

Emitted Colors  
"L" LENGTH, inches  
available in 0.1" increments only  
e.g. 6.0, 11.5