

REV.	DATE	DESCRIPTION
A	08/25/04	MODIFY COUPLING NUT PLATING

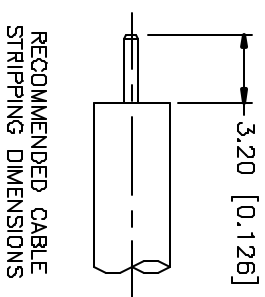
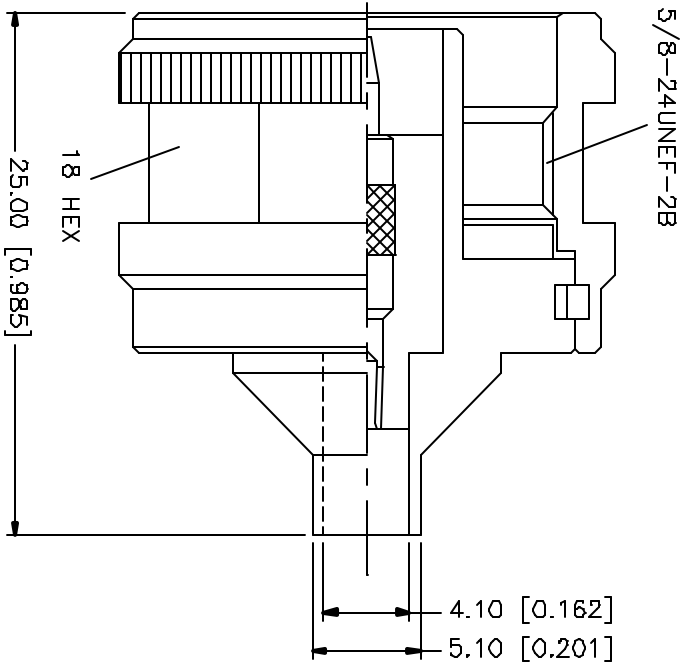

REV.	DESCRIPTION	MATERIAL	FINISH	QTY	UNLESS OTHERWISE SPECIFIED DIMENSIONS ARE IN INCHES AND FOR DIMENSIONS REFER TO THE DATA SHEET	APPROVALS	DATE	PART DESCRIPTION	DWG. NO.	REV.	SIZE	SCALE
B					UNLESS OTHERWISE SPECIFIED DIMENSIONS ARE IN INCHES AND FOR DIMENSIONS REFER TO THE DATA SHEET			Amphenol Connex N DIRECT SOLDER PLUG (FOR .141" SEMI RIGID CABLE)	172133-11	A	A	NA
7				UNLESS OTHERWISE SPECIFIED DIMENSIONS ARE IN MILLIMETERS AND TOLERANCES FOR MILLIMETERS ARE	DRAWN	08/25/04						
6	COUPLING NUT	BRASS	NECKOATE	1	0.5 - .8mm ± 0.20mm 8 - 30mm ± 0.40mm 30 - 120mm ± 0.50mm	CHECKED						
5	GASKET	SILICONE	RED	1	UNLESS OTHERWISE SPECIFIED DIMENSIONS FOR METRIC ARE	ISSUED						
4	CONTACT PIN	PHOS. BRONZE	GOLD	1	.020 - .315 ± ± 0.007 .315 - 1.180 ± ± 0.015 1.180 - 4.724 ± ± 0.020	SHEET	1 OF 1					
3	INSULATOR	TEFLON	NATURAL	1								
2	BODY	BRASS	GOLD	1								
1	DESCRIPTION	MATERIAL	FINISH	QTY	DO NOT SCALE DRAWING	CAD FILE						