

# CTSPMA4010F Series

From .47 $\mu$ H to 10 $\mu$ H



## SPECIFICATIONS

Parts are available in  $\pm 20\%$  inductance tolerance only

Part Number	Inductance ( $\mu$ H)	L Test Condition	DCR Max. (m $\Omega$ )	Isat Max. (A)	Irms Max. (A)
CTSPMA4010F-R47M	0.47	100KHz, 1V	35.3	8.2	4.6
CTSPMA4010F-R68M	0.68	100KHz, 1V	36.0	6.2	4.6
CTSPMA4010F-1R0M	1.00	100KHz, 1V	42.5	4.7	4.0
CTSPMA4010F-1R5M	1.50	100KHz, 1V	64.0	4.2	3.4
CTSPMA4010F-2R2M	2.20	100KHz, 1V	87.0	3.4	2.6
CTSPMA4010F-3R3M	3.30	100KHz, 1V	120.0	2.9	2.1
CTSPMA4010F-4R7M	4.70	100KHz, 1V	210.0	2.4	1.6
CTSPMA4010F-6R8M	6.80	100KHz, 1V	245.0	1.8	1.5
CTSPMA4010F-100M	10	100KHz, 1V	350.0	1.4	1.1

## PHYSICAL DIMENSIONS

Size	A	B	C	D	E	F
mm	4.4 $\pm$ 0.2	4.1 $\pm$ 0.2	4.4	1.0	1.60	1.60
inches	0.17 $\pm$ 0.008	0.16 $\pm$ 0.008	0.17	0.039	0.063	0.063
Size	G	H	I	J	K	
mm	1.0	1.10 $\pm$ 0.1	2.2	1.05 $\pm$ 0.1	2.0	
inches	0.039	0.043 $\pm$ 0.004	0.087	0.041 $\pm$ 0.004	0.079	

## CHARACTERISTICS

**Description:** SMD (shielded) Power Inductors

**Applications:** Smart phones, Notebook PC's, Tablets, HDD's, Servers, VRM's, Compact power supply modules, etc.

**Saturation Rated Current (Isat):** The DC current when the when the inductance becomes 30% lower than its initial value. (Ta=25°C)

**Temperature Rise Current (Irms):** The actual current when temperature of coil becomes  $\Delta T 40^\circ\text{C}$ . (Ta=25°C)

**Operating Temperature Range:** -55°C to 155°C

**Markings:** Inductance Code

**Miscellaneous:** RoHS compliant

**Samples available. See website for ordering information.**

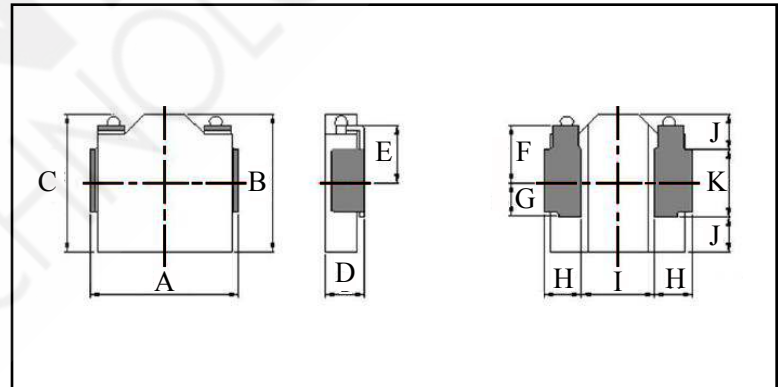

## PAD LAYOUT

