

Base strip - MC 1,5/12-G-3,5 THT-R72 - 1996760

Please be informed that the data shown in this PDF Document is generated from our Online Catalog. Please find the complete data in the user's documentation. Our General Terms of Use for Downloads are valid (<http://phoenixcontact.com/download>)



Header, Nominal current: 8 A, Rated voltage (III/2): 160 V, Number of positions: 12, Pitch: 3.5 mm, Color: black, Contact surface: Tin, Assembly: Taped SMD/THT/THR components, User information and design recommendations for through hole reflow technology can be found under "Downloads"

Product Features

- 3.5 mm pitch
- Low-profile THR headers with a compact pitch
- Plug-in direction parallel to the PCB
- Delivery form: box packaging, in bulk for small series
- Delivery form: tape-on-reel packing according to IEC 60286-3 for automated mounting
- Use in SMT reflow processes



Key commercial data

| | |
|--------------------------------------|----------|
| Packing unit | 1 pc |
| Minimum order quantity | 380 pc |
| Weight per Piece (excluding packing) | 4.72 GRM |
| Custom tariff number | 85366990 |
| Country of origin | Germany |

Technical data

Dimensions

| | |
|----------------|--------------|
| Length | 9.2 mm |
| Pitch | 3.5 mm |
| Dimension a | 38.5 mm |
| Pin dimensions | 0,8 x 0,8 mm |
| Hole diameter | 1.4 mm |

General

| | |
|-------------------|------------------|
| Range of articles | MC 1,5/...-G-THT |
|-------------------|------------------|

Base strip - MC 1,5/12-G-3,5 THT-R72 - 1996760

Technical data

General

| | |
|---|--------------------|
| Insulating material group | IIIa |
| Rated surge voltage (III/3) | 2.5 kV |
| Rated surge voltage (III/2) | 2.5 kV |
| Rated surge voltage (II/2) | 2.5 kV |
| Rated voltage (III/3) | 160 V |
| Rated voltage (III/2) | 160 V |
| Rated voltage (II/2) | 250 V |
| Connection in acc. with standard | EN-VDE |
| Nominal current I _N | 8 A |
| Maximum load current | 8 A (per position) |
| Insulating material | PA-GF |
| Inflammability class according to UL 94 | V0 |
| Color | black |
| Number of positions | 12 |

Classifications

eCl@ss

| | |
|------------|----------|
| eCl@ss 4.0 | 272607xx |
| eCl@ss 4.1 | 27260701 |
| eCl@ss 5.0 | 27260701 |
| eCl@ss 5.1 | 27260701 |
| eCl@ss 6.0 | 27260704 |
| eCl@ss 7.0 | 27440402 |
| eCl@ss 8.0 | 27440402 |

ETIM

| | |
|----------|----------|
| ETIM 3.0 | EC001121 |
| ETIM 4.0 | EC002637 |
| ETIM 5.0 | EC002637 |

UNSPSC

| | |
|---------------|----------|
| UNSPSC 6.01 | 30211810 |
| UNSPSC 7.0901 | 39121409 |
| UNSPSC 11 | 39121409 |
| UNSPSC 12.01 | 39121409 |
| UNSPSC 13.2 | 39121409 |

Base strip - MC 1,5/12-G-3,5 THT-R72 - 1996760

Approvals

Approvals

Approvals

UL Recognized / VDE Gutachten mit Fertigungsüberwachung / cUL Recognized / IEC60335-1 / IEC60335-2-1 / GOST / GOST / CCA / cULus Recognized

Ex Approvals

Approvals submitted

Approval details

| | | |
|--|-------|-------|
| UL Recognized  | | |
| | B | D |
| Nominal current I _N | 8 A | 8 A |
| Nominal voltage U _N | 300 V | 300 V |

| | |
|---|-------|
| VDE Gutachten mit Fertigungsüberwachung  | |
| Nominal current I _N | 8 A |
| Nominal voltage U _N | 160 V |

| | | |
|--|-------|-------|
| cUL Recognized  | | |
| | B | D |
| Nominal current I _N | 8 A | 8 A |
| Nominal voltage U _N | 300 V | 300 V |

Base strip - MC 1,5/12-G-3,5 THT-R72 - 1996760

Approvals

| | |
|-----------------------|-------|
| IECEE CB Scheme | |
| Nominal current I_N | 8 A |
| Nominal voltage U_N | 160 V |

| | |
|------|--|
| GOST | |
|------|--|

| | |
|------|--|
| GOST | |
|------|--|

| | |
|-----------------------|-------|
| CCA | |
| Nominal current I_N | 8 A |
| Nominal voltage U_N | 160 V |

| | |
|------------------|--|
| cULus Recognized | |
|------------------|--|

Drawings

Dimensioned drawing

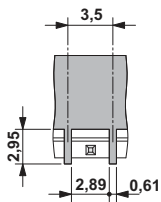

Drilling diagram

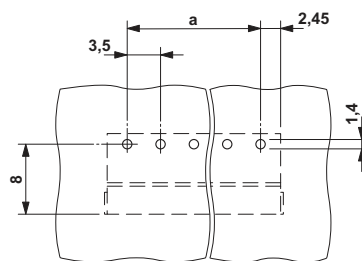

Base strip - MC 1,5/12-G-3,5 THT-R72 - 1996760

Dimensioned drawing

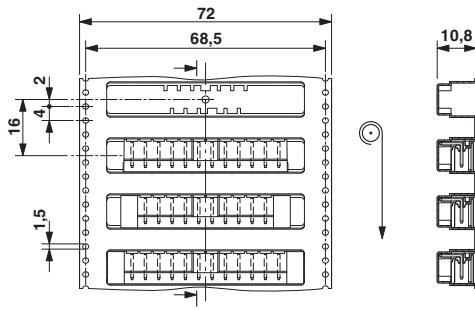

Dimensioned drawing

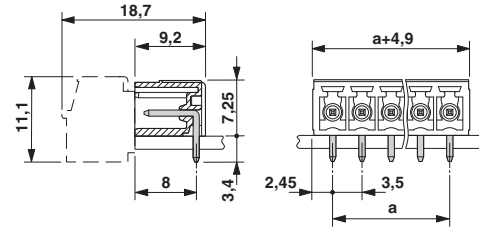

Dimensioned drawing

