

THIS DRAWING IS UNPUBLISHED. RELEASED FOR PUBLICATION
 © COPYRIGHT - By - ALL RIGHTS RESERVED.

REVISIONS					
P	LTR	DESCRIPTION	DATE	DWN	APVD
D1		REVISED PER ECO-12-008537	07MAY12	KH	DR
D2		REVISED PER ECO-16-017419	14MAR2017	RS	DR

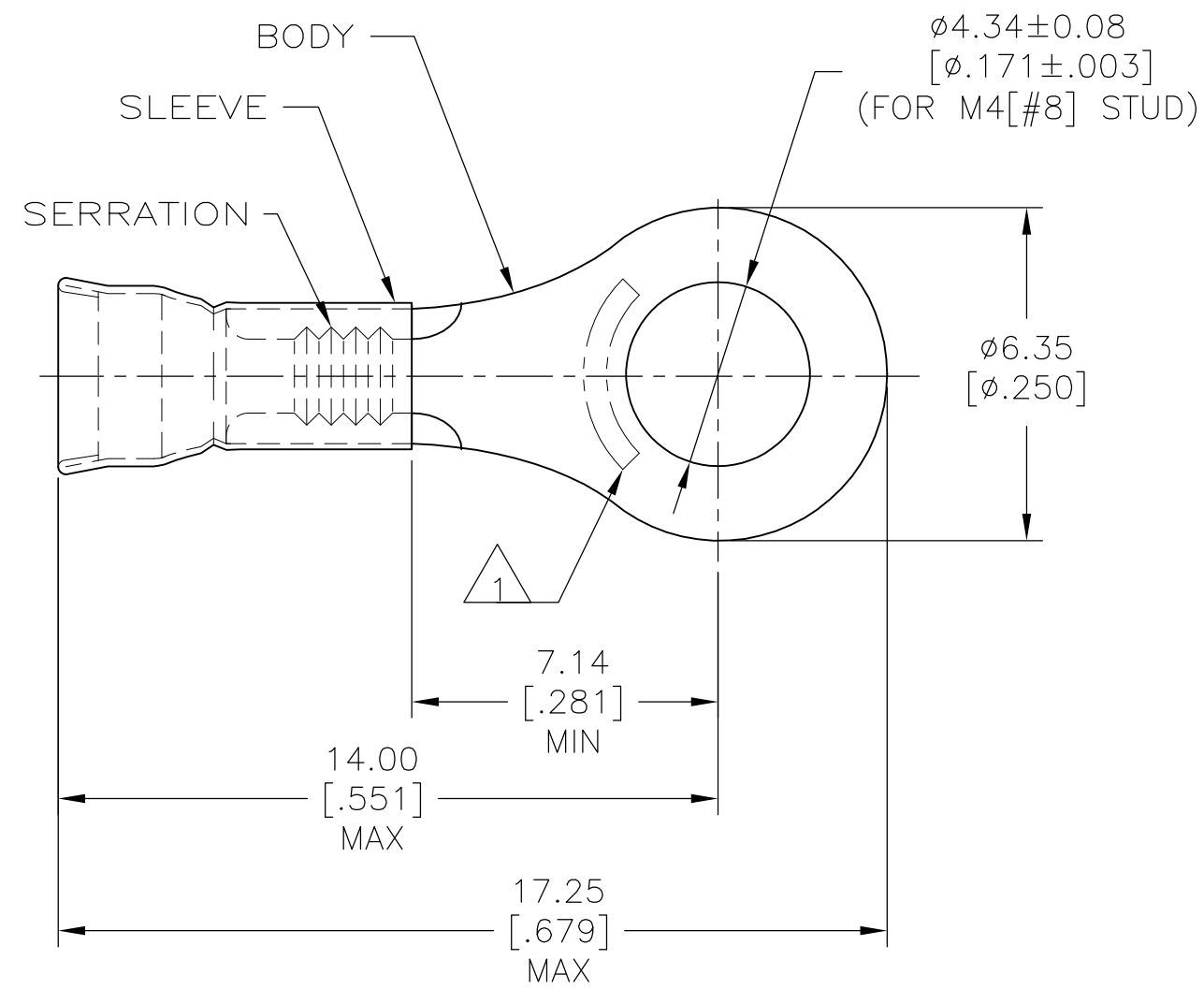

- △ 1 STAMP AMP LOCATE APPROX AS SHOWN.
- 2 WIRE INSUL DIA, $\phi 1.27-2.08[\phi.050-.082]$.
- 3 TONGUE MATL THK, $0.46\pm 0.05 [0.018\pm 0.002]$.
- 4 NOTE DELETED.
- 5 NOTE DELETED.
- △ 6 TIN PLATE PER ASTM B545.

1000	LOOSE PIECE	△ 6	32862
QTY	PACKAGE TYPE	FINISH	PART NO

AMP INCORPORATED
 CUSTOMER SERVICE SYSTEMS

FOR ADDITIONAL PRODUCT INFORMATION OR COPIES OF DRAWINGS AND TECHNICAL DOCUMENTS	PRODUCT INFORMATION CENTER 1-800-522-6752	RECOMMENDED OPERATING TEMPERATURE: -
FOR APPLICATION TOOLING INFORMATION	TOOLING ASSISTANCE CENTER 1-800-722-1111	VOLTAGE RATING: -
FOR ORDER ENTRY	1-800-526-5142	CIRCULAR MIL AREA: 0.10mm ² -0.41mm ² [202-810] STRANDED WIRE

THIS DRAWING IS A CONTROLLED DOCUMENT.	
DIMENSIONS: mm [INCHES]	TOLERANCES UNLESS OTHERWISE SPECIFIED:
	0 PLC ± -
	1 PLC ± -
	2 PLC ± 0.20 [.008]
	3 PLC ± -
	4 PLC ± -
ANGLES ± -	± -
MATERIAL BODY, CU, SLV, CU PER ASTM B152	FINISH SEE TABLE

DWN L OLMEDA 23JAN95	TE Connectivity			
CHK M ELLIS 23JAN95				
APVD S BORTNER 23JAN95	NAME TERMINAL, RING, DIAMOND GRIP, WIRE SIZE: 26-22 AWG			
PRODUCT SPEC -	SIZE	CAGE CODE	DRAWING NO	RESTRICTED TO
APPLICATION SPEC -	A3	00779	C-32862	-
WEIGHT -	CUSTOMER DRAWING		SCALE 6:1	SHEET 1 OF 1
				REV D2