

PART NUMBER	REV	FIRST USED	POWER UNIT	FEED TYPE	DESCRIPTION
1852233-1	A	122500-1	LEADMAKER	POST FEED	CUTS CARRIER
1852233-2	A	565435-5	BENCH MODEL K	PRE FEED	CUTS CARRIER
1852233-3	A	354500-1	BENCH MODEL G	PRE FEED	CUTS CARRIER
1852233-6	A	122500-1	LEADMAKER	POST FEED	CONTINUOUS CARRIER
7-1852233-7	A	-	-	-	SPARE PARTS

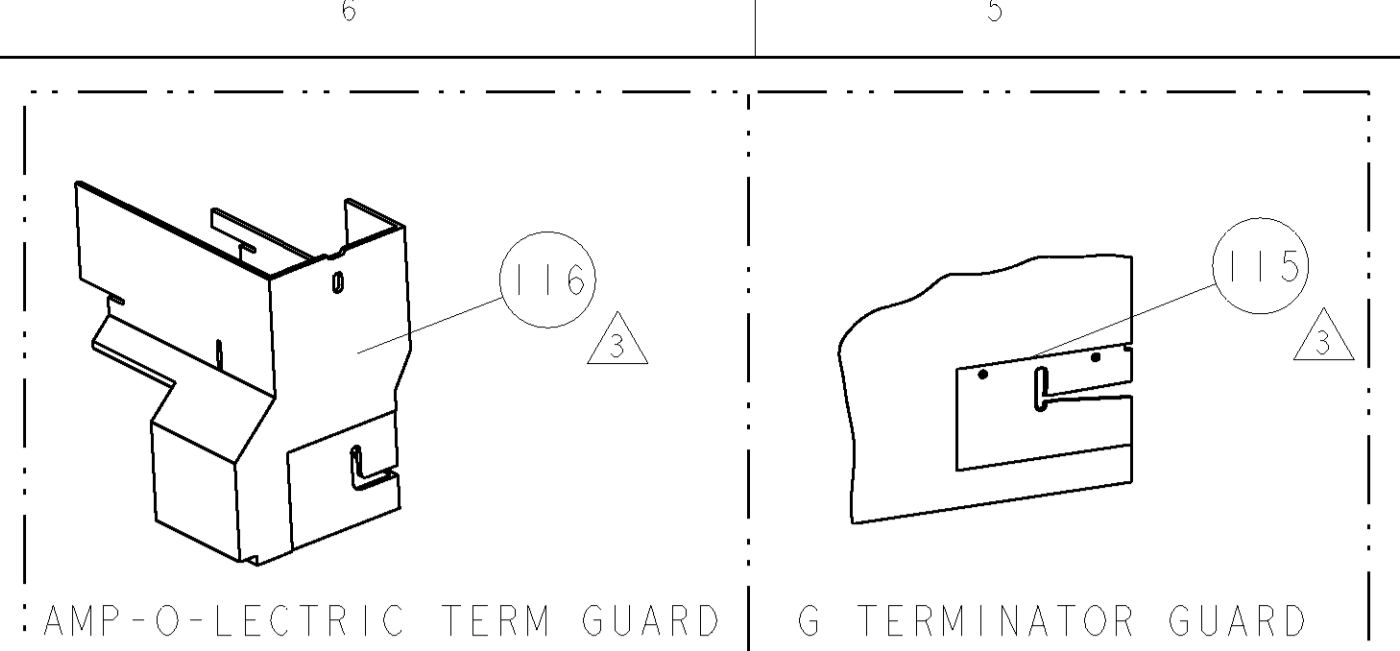

TERMINAL NAME: RECEPTACLE TERMINAL					
TYCO PN	MANUF PN	LEAR TERMINAL - AMP CRIMP SPECS			
1949009-1	771416-HK200	CRIMP HEIGHT		WIRE SIZE	
-	-	A	.083±.002[2.10±0.05mm]	14 AWG	
-	-	B	.074±.002[1.87±0.05mm]	16 AWG	
-	-	C	-	-	
-	-	D	-	-	
		CRIMP	SIZE	TYPE	RANGE
-	-	-	.110 [2.79mm]	F	16-14 AWG
-	-	INSUL	.120 [3.05mm]	F	∅.120 MAX
WIRE STRIP LENGTH	TERM APPL SPEC	FEED	APPL INSTRUCTIONS	SET UP GAGE	
.187 - .202	NONE	.735	408-8040	458637-1	

LOC	DIST	P	LTR	DESCRIPTION	DATE	BY	APPD
A	66			RELEASED	24APR2006	MEH	GB
		A1		ECR-07-012908	31MAY2007	MY	TE

- △ RECOMMENDED SPARE PARTS
- △ GREASE LIGHTLY
- △ GUARD MUST BE IN PLACE WHEN OPERATING APPLICATOR IN A BENCH MACHINE

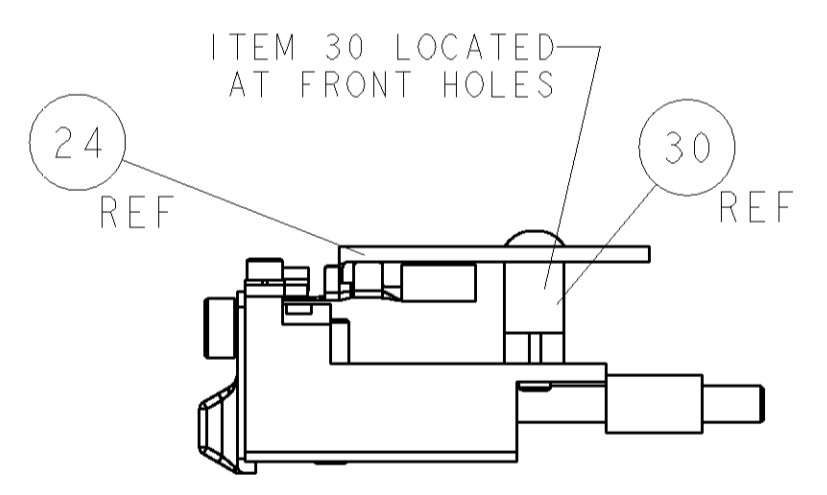
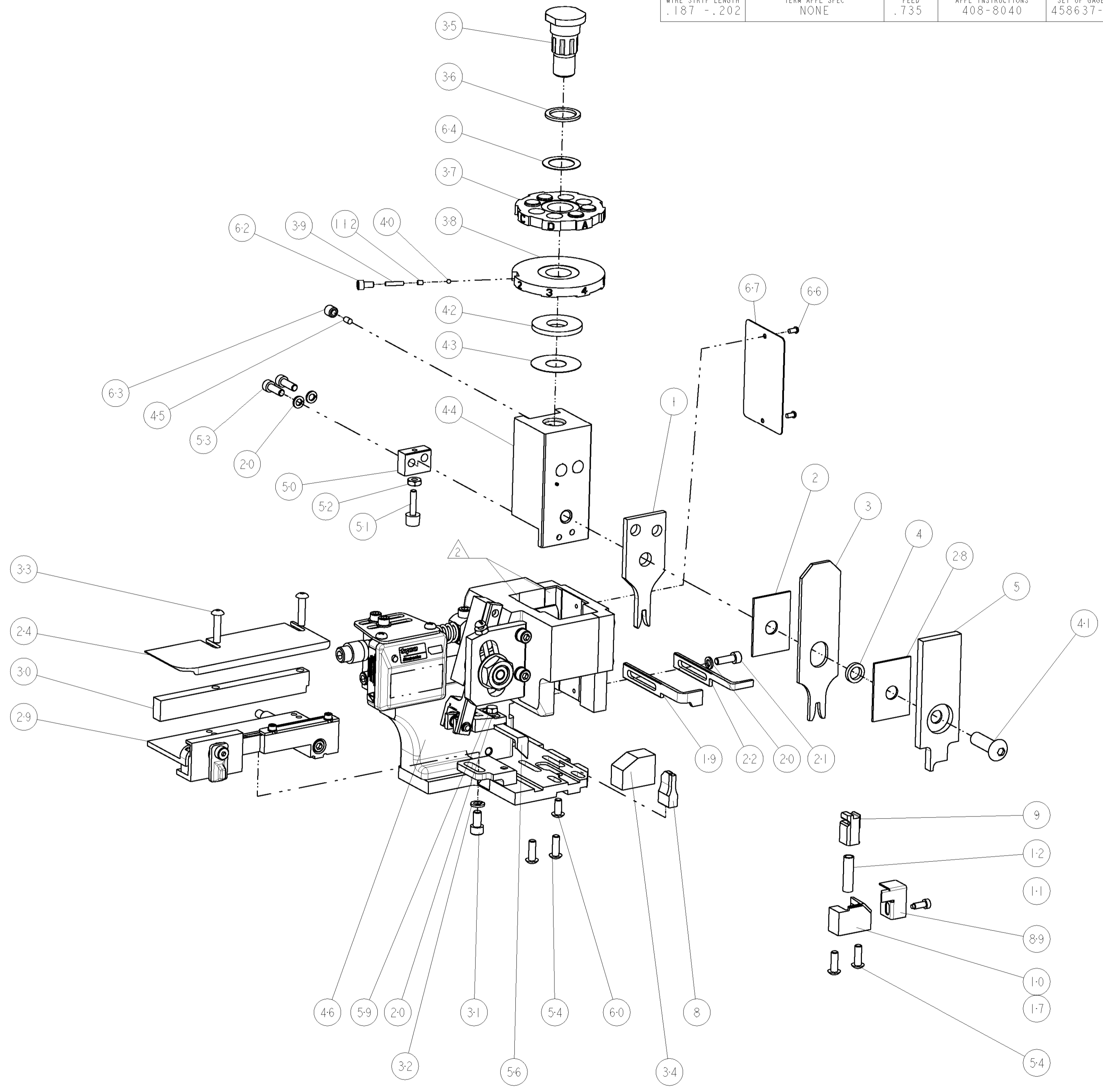
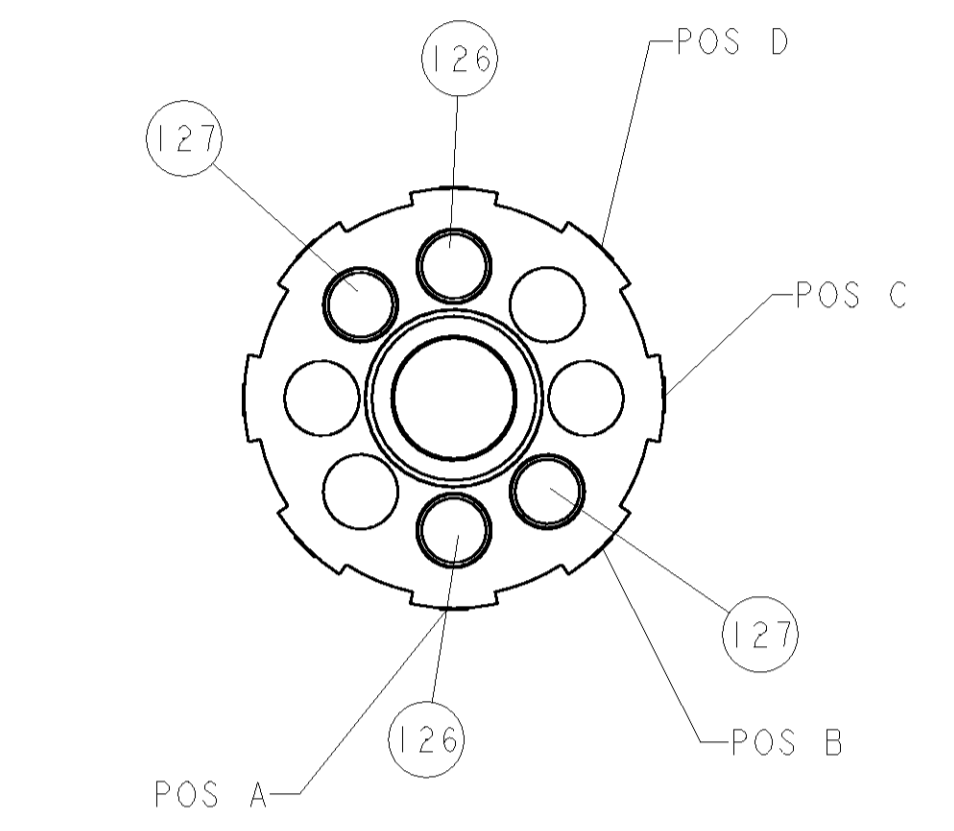

FEED TRACK POSITION

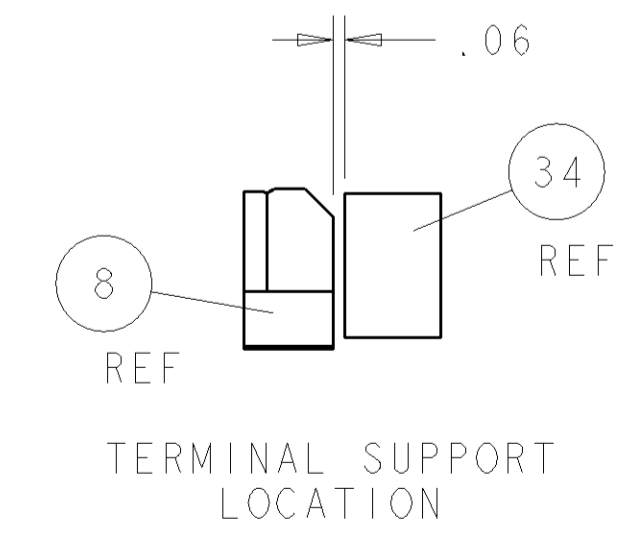

TERMINAL SUPPORT LOCATION

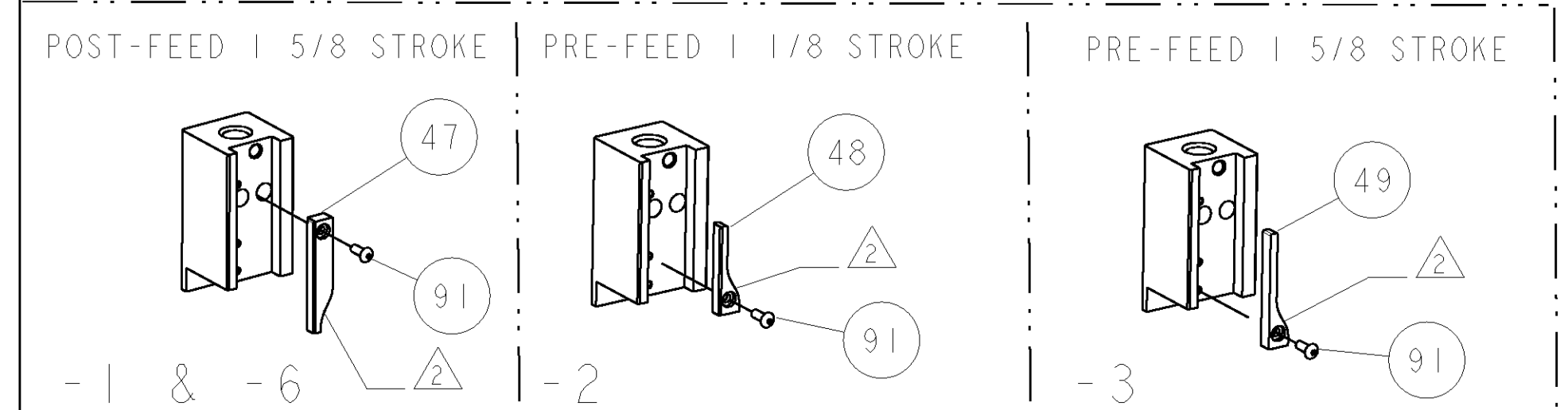

QTY	REV	DESCRIPTION	ITEM NO
-	2	1949009-1	-
-	2	7-354778-6	PIN, WIRE DISC, .2875
-	2	5-354778-8	PIN, WIRE DISC, .2785
-	-	455749-1	GUARD WINDOW
-	REF	679532-1	INSERT, GUARD
-	1	690603-1	SPRING ASSIST AMP-O-MATOR APPLICATOR
-	1	1-21002-7	SCR, BTN SKT HD CAP 6-32 X .375
-	1	318563-1	GUARD, FRONT CHIP
-	1	4088040	SF APPL INST 408-8040
-	1	217238-1	GENERAL INSTRUCTION PKG
-	1	461264-1	PLATE, IDENTIFICATION
-	2	21017-2	SCREW, DRIVE
-	1	986950-1	WASHER, FLAT PRECISION
-	1	21009-2	SCR, SET, SELF LOCKING 1/4-20 X .250
-	1	23030-1	SCR, SKT HD CAP 6-32 X .25
-	1	22733-8	SCR, BHSC, SELF-LOCKING, 8-32 X .375
-	1	2-22603-0	SCR, HEX HD CAP 8-32 X .312
-	1	458537-2	PAWL, FEED
-	4	2-21002-2	SCR, BTN SKT HD CAP 8-32 X .500
-	2	2-21000-7	SCR, SKT HD CAP 8-32 X .500
-	1	21018-5	NUT, HEX, REG 6-32
-	1	811242-2	BUMPER, HOLD DOWN
-	1	690753-1	SPACER, TONKER
-	-	690602-6	CAM, PRE FEED, 1 5/8
-	1	690501-4	CAM, POST FEED, 1 5/8
-	1	459456-1	APPL. BASIC SUB ASSY (SIDE WISE MOCA)
-	1	690191-1	PLUG, NYLON
-	1	455673-1	RAM, SIDE FEED
-	1	690125-1	SHIM SUB-ASSY
-	1	690124-1	WASHER, RAM (.115)
-	1	7-21002-9	SCR, BTN SKT HD CAP 5/16-24 X 1.00
-	1	23241-6	BALL, STEEL
-	1	690170-1	SPRING, COMPRESSION
-	1	690142-1	DISC, INSULATION
-	1	354777-1	WIRE DISC, ASSEMBLY
-	1	22480-5	SPRING, COMPRESSION
-	1	690212-1	POST, RAM
-	1	690786-6	TERMINAL SUPPORT
-	2	2-21002-4	SCR, BTN SKT HD CAP 8-32 X .750
-	1	21024-5	WASHER, SPRG LOCK, REG NO 10
-	1	3-21000-4	SCR, SKT HD CAP 10-32 X .375
-	1	1320908-2	SPACER, STRIP GUIDE
-	1	1633091-2	ASSEMBLY, STRIP GUIDE
-	1	1-455888-0	SPACER, CRIMPER
-	1	1320928-3	PLATE, STRIP GUIDE
-	1	690472-2	STRIPPER
-	1	2-21000-7	SCR, SKT HD CAP 8-32 X .500
-	4	21024-4	WASHER, SPRG LOCK, REG NO 8
-	-	691353-1	STRIPPER
-	1	679625-1	SHEAR HOLDER, FRONT (NO CUT)
-	1	3-22280-3	SPRING, COMPRESSION
-	1	690461-1	STOP, SHEAR
-	-	690459-1	SHEAR HOLDER, FRONT
-	1	1-454276-9	FLOATING SHEAR, FRONT
-	1	1633112-3	ANVIL, COMBINATION .110
-	1	1-455889-4	DEPRESSOR, SHEAR
-	1	1-238011-7	BLOCK, CRIMPER SPACER
-	1	1-456134-0	CRIMPER, INSULATION F PREMIUM
-	1	1-455888-1	SPACER, CRIMPER
-	1	456408-6	CRIMPER, WIRE PREMIUM

DIMENSIONS: INCHES		TOLERANCES UNLESS OTHERWISE SPECIFIED:		Tyco Electronics Harrisburg, PA 17105-3608	
0 PLC	±	1 PLC	±0.1	PRODUCT SPEC	
1 PLC	±0.01	2 PLC	±0.01	APPLICATION SPEC	
3 PLC	±0.001	4 PLC	±0.001	WEIGHT	
4 PLC	±0.0001	ANGLES	±0.0001	CUSTOMER DRAWING	
MATERIAL		FINISH		SCALE: 3:5 SHEET 1 OF 1 REV: A1	

CUSTOMER VIEWABLE ASSEMBLY