

DO NOT SCALE

METRIC

THIRD ANGLE
PROJECTION

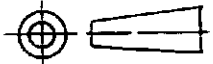

DIMENSIONS IN mm

| LTR. | REVISION RECORD | DR. | CHK. | DATE |
|------|-----------------|-----|------|---------|
| B1 | ECO-09-026346 | KK | AEG | 26NOV09 |

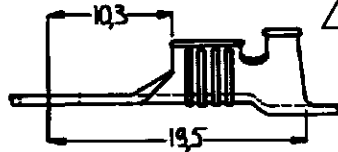
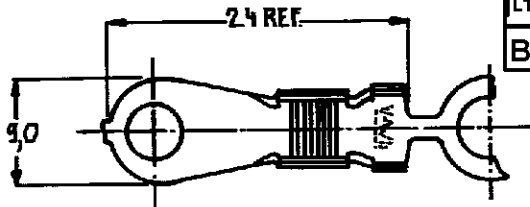

5 OBSOLETE PARTS: OBSOLETE CIS
STREAMLINING PER D.RENAUD/D.SINISI

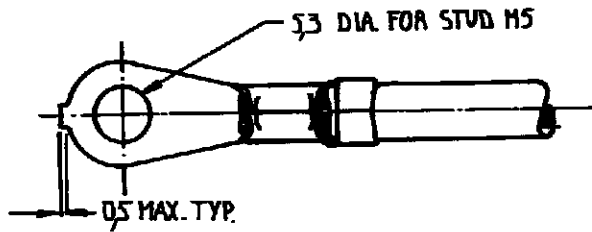

DOC. CENTRE
14 JUNI 1993

NOTES: Δ FOR USE ON STANDARD AND MINIATURE APPLICATORS

Δ FOR USE ON MINIATURE APPLICATORS. (AMP-O-MATOR APPLICATION)

Δ WITH PAPER COVER Δ WITH PAPER LAYER

| NOTES | FINISH | MATERIAL | PART NUMBER |
|-------------------|--------------------|-----------------|---------------------|
| Δ OBSOLETE | Δ UNPLATED | PHOSPHOR BRONZE | 160134-7 |
| | Δ TINPLATED | PHOSPHOR BRONZE | 160134-6 |
| | Δ UNPLATED | PHOSPHOR BRONZE | 160134-5 |
| Δ OBSOLETE | Δ UNPLATED | BRASS | 160134-4 |
| | Δ UNPLATED | PHOSPHOR BRONZE | 160134-3 |
| | Δ TINPLATED | BRASS | 160134-2 |
| | Δ UNPLATED | BRASS | 160134-1 |

**CUSTOMER
DRAWING**

FOR REFERENCE ONLY
WILL NOT BE UPDATED

AMP

AMP-HOLLAND B.V.
's-Hertogenbosch, The Netherlands

THIS DRAWING IS UNPUBLISHED

RELEASED FOR PUBLICATION

12

© COPYRIGHT 19 BY AMP-HOLLAND B.V.
ALL INTERNATIONAL RIGHTS RESERVED.
AMP PRODUCTS MAY BE COVERED BY U.S. AND FOREIGN PATENTS AND/OR PATENTS PENDING.

| | | | |
|---------------|--------------------------------|--|--------------------------------|
| DR. 21/83 | WIRE RANGE 3,1 - 3,3 mm | NAME RINGTONGUE WITH INSULATION SUPPORT | REV. DATE D M Y 26 11 09 |
| CHK. 24/83 | INSUL. RANGE 3,0 - 3,3 DIA. | | |
| APP. 22.1.83 | SIZE A4 | SHEET 1 OF 1 | DRAWING NO C-160134 |
| | | | REV. LTR. B1 |