

PART NUMBER	REV	FIRST USED
567256-6	F	122500-1

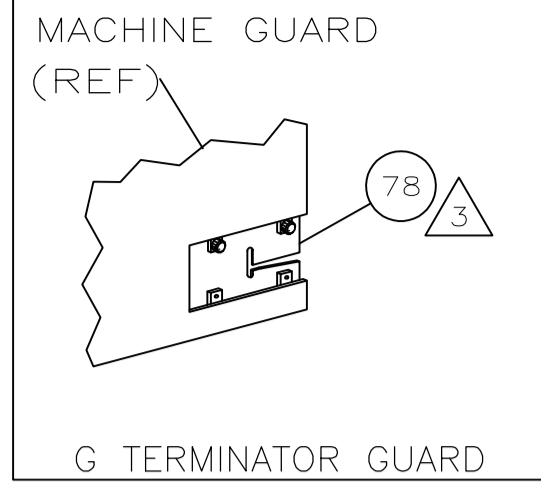
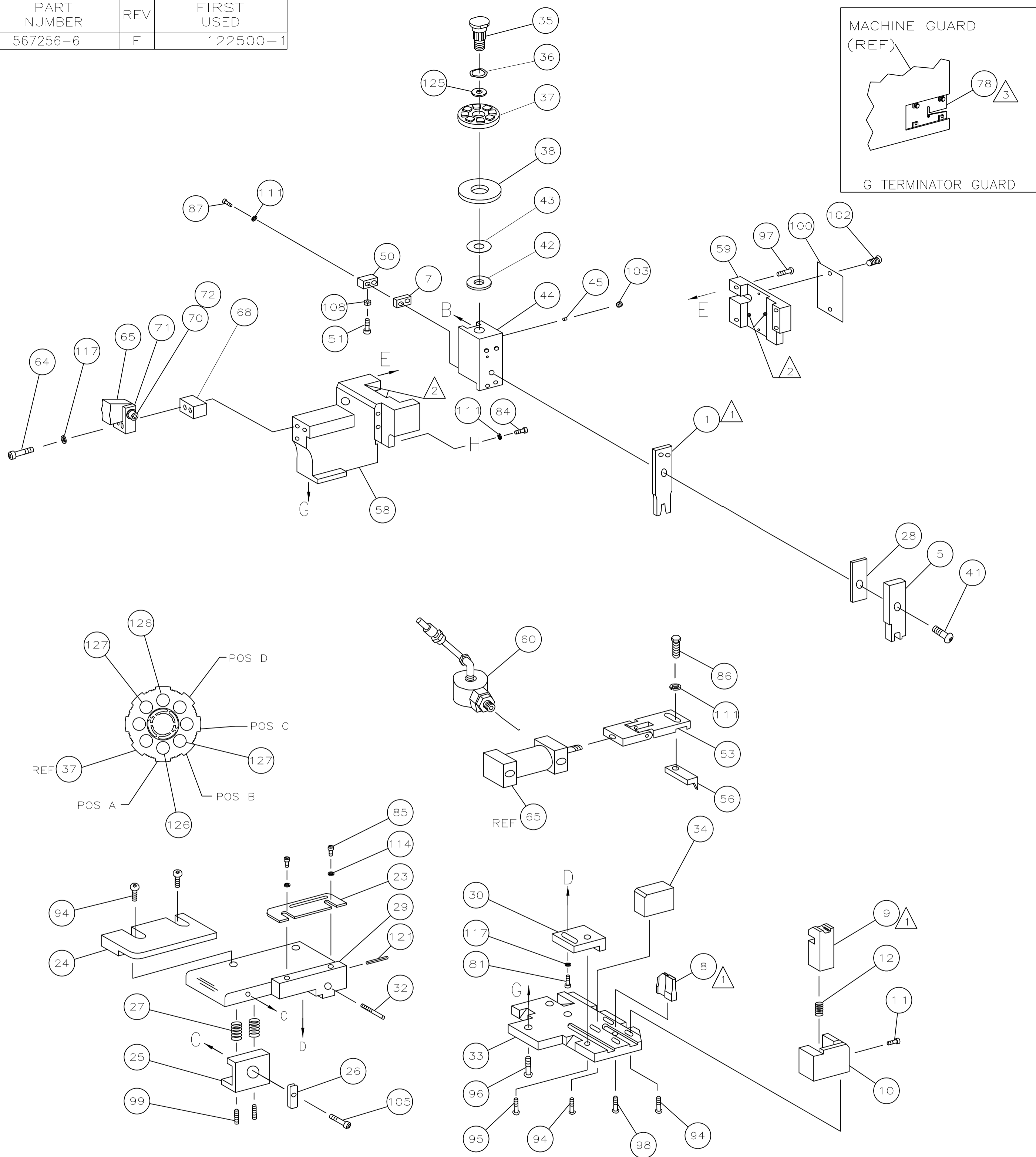

TERMINAL NAME: CONTACT, DUAL BEAM, 10-12 AWG AMPIN		CRIMP DATA (AMP TERMINAL)	
PAD LTR	CRIMP HEIGHT	WIRE SIZE	
556880-2	A .129 ±.002 [3.28 ±0.05mm]	10	
556136-1	B .115 ±.002 [2.92 ±0.05mm]	12	
555485-1	C	USED	
555928-1	D	USED	
555928-2			
CRIMP	SIZE	TYPE	RANGE
	WIRE .180 [4.57mm]	F	12-10
	INSUL -	-	-

QTY	REV	DESCRIPTION	MEH NO
1	-	129	
1	-	128	
2	-	2-354779-4 PIN, WIRE DISC (.3110)B	127
2	-	9-354778-3 PIN, WIRE DISC (.2960)A	126
1	-	986950-1 WASHER, FLAT PRECISION	125
1	-	217238-1 GENERAL INSTRUCTION PACKAGE	124
1	-	4088040 SF APPL INST 408-8040	123
1	-		122
1	-	4-21028-0 PIN,SLT SPR(Ø.093x.75)ST GDE PL	121
			120
			119
			118
3	-	21024-5 WASHER, LOCK(#10)ADJ BLOCK	117
			116
			115
2	-	21024-2 WASHER,LOCK(#4)FRONT STP GUIDE	114
			113
			112
4	-	21024-4 WASHER,LOCK(#8)STRIPPER	111
			110
			109
1	-	21018-5 NUT,HEX(NO.6)HOLDDOWN	108
			107
			106
1	-	22353-8 SCR,SHLD(Ø.187x.25)DRAG LEVER	105
			104
1	-	21009-2 SCR,SKT SET(1/4-20x.25 LW)RAM	103
2	-	21017-2 SCR,DRIVE(#2x.19)ID PLATE	102
			101
1	-	461264-1 PLATE, IDENTIFICATION	100
2	-	5-21006-6 SCR,SET(10-32x.75)DRAG	99
1	-	22733-8 SCR,BHC(8-32x.38 LW)ANVIL	98
4	-	2-21002-9 SCR,BHC(10-32x.75)CAP	97
3	-	2-22733-8 SCR,BHC(1/4-20x.62)HSG	96
1	-	2-21002-7 SCR,BHC(10-32x.50)SG ADJ BLK	95
6	-	2-21002-2 SCR,BHC(8-32x.50)TERM H DWN	94
			93
			92
			91
			90
			89
			88
2	-	2-21000-8 SCR,SHC(8-32x1.00)DEP-HOLD	87
1	-	2-22603-1 SCR,HEX HD(8-32x.38)FEED FINGER	86
2	-	1-21000-3 SCR,SHC(4-40x.25)F ST GUIDE	85
1	-	2-21000-7 SCR,SHC(8-32x.50)STRIPPER	84
			83
			82
1	-	3-21000-4 SCR,SHC(10-32x.38)SG ADJ BL	81
			80
			79
REF	-	679532-1 INSERT, GUARD	78
			77
			76
			75
			74
			73
1	-	4-21002-8 SCR,BHC(3/8x1.00)FEED MT	72
1	-	459610-3 MOUNT, FEED BRACKET	71

- 1 RECOMMENDED SPARE PARTS.
- 2 GREASE LIGHTLY.
- 3 GUARD MUST BE IN PLACE WHEN OPERATING APPLICATOR IN A BENCH MACHINE.
- 4 SEE DRAWING FOR COMPONENTS

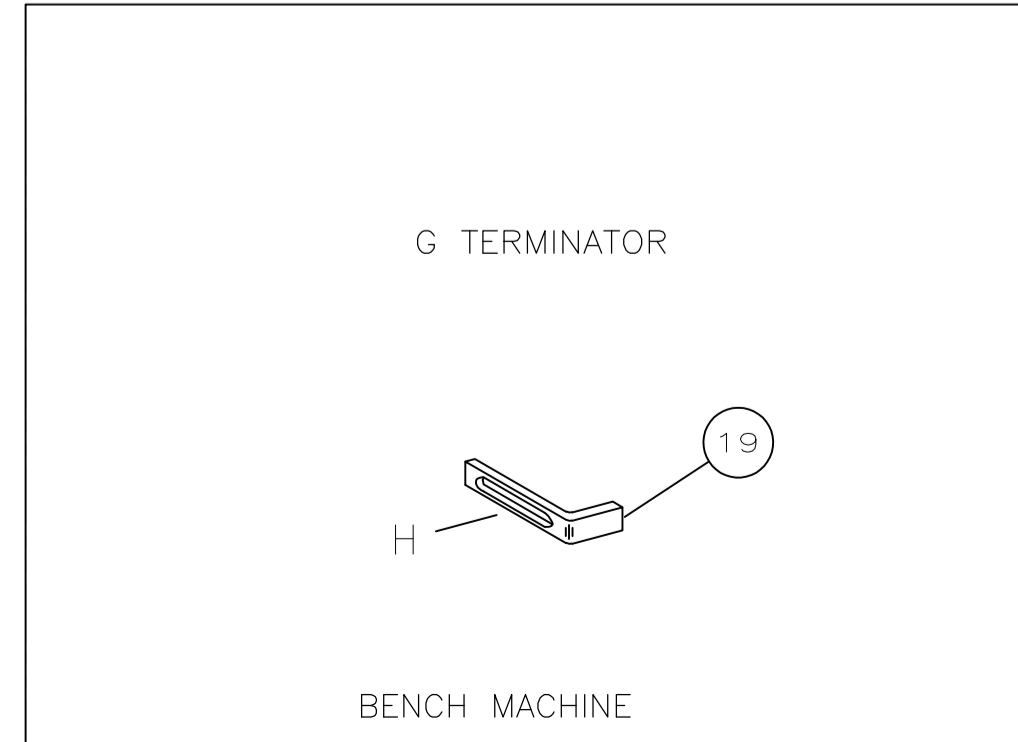

QTY	REV	DESCRIPTION	MEH NO
1	-	21024-8 WASHER,LOCK(3/8)FEED BRKT	70
			69
1	-	461690-3 SPACER, AIR FEED	68
			67
			66
1	-	461065-2 AIR FEED ASSY (2 INCH)	65
2	-	4-21000-2 SCR,SHC(10-32x2.00)AIR ASSY	64
			63
			62
			61
1	-	692655-7 AIR FEED VALVE ASSY	60
1	-	454220-1 CAP, RAM	59
1	-	454485-1 HOUSING	58
			57
1	-	458537-2 PAWL, FEED	56
			55
			54
1	-	461062-1 FEED FINGER ASSY	53
			52
1	-	811242-2 BUMPER, HOLDDOWN	51
1	-	690753-1 SPACER, TONKER	50
			49
			48
			47
			46
1	-	690191-1 PLUG, NYLON	45
1	-	455673-1 RAM	44
1	-	690125-1 WASHER, LAMINATED	43
1	-	690124-5 WASHER, RAM	42
1	-	7-21002-9 BOLT, CRIMPER(5/16x1.00)	41
			40
			39
1	-	690223-2 SPACER, INSULATION DISC	38
1	-	354777-1 WIRE DISC, PLASTIC	37
1	-	22480-5 WASHER, SPRING	36
1	-	690212-1 POST, RAM	35
1	-	690786-3 SUPPORT, TERMINAL	34
1	-	455675-1 PLATE, BASE	33
1	-	690432-3 SCREW, ADJUSTMENT	32
			31
1	-	455689-1 BLOCK, STRIP GUIDE ADJ	30
1	-	458144-1 PLATE, STRIP GUIDE	29
1	-	1-455888-9 SPACER, FRONT SHEAR DEP	28
2	-	1-22284-0 SPRING, DRAG	27
1	-	356835-1 LEVER, DRAG RELEASE	26
1	-	240792-1 DRAG, TERMINAL	25
1	-	6-690504-1 GUIDE, STRIP (REAR)	24
1	-	690438-1 GUIDE, STRIP (FRONT)	23
			22
			21
			20
1	-	691353-1 STRIPPER	19
			18
			17
			16
			15
			14
			13
1	-	3-22280-3 SPRING, SHEAR	12
1	-	690461-7 STOP, SHEAR	11
1	-	1-690459-0 HOLDER, SHEAR (FRONT)	10
1	-	1-454276-6 SHEAR, FLOAT (FRONT)	9
1	-	3-683403-6 ANVIL	8
1	-	240641-5 SPACER, DEPRESSOR (REAR)	7
			6
1	-	2-455889-1 DEPRESSOR, SHEAR (FRONT)	5
			4
			3
			2
1	-	456412-9 CRIMPER, WIRE	1

QTY	REV	DESCRIPTION	MEH NO
-6	U/M	679532-1 INSERT, GUARD	78

THIS DRAWING IS A CONTROLLED DOCUMENT.

RELEASED FOR PUBLICATION JAN 13 2000  
 BY AMP INCORPORATED. ALL RIGHTS RESERVED.  
 AMP 1756 REV 3-92  
 Transilvania 0409.2251A  
 Computations, Inc.  
 Copyright 2000  
 Revision 09-2002  
 us016926

LOC A  
DIST 66