

NOTES

- ALL DIMENSIONS ARE IN $\frac{\text{INCHES}}{\text{[MILLIMETERS]}}$
- DIMENSIONS APPEARING IN TABLE ARE AS FOLLOWS:
 - a - AS SUPPLIED
 - b - AFTER UNRESTRICTED RECOVERY

3. COATING (ADHESIVE): IS OPTIONAL AS SUPPLIED DIMENSIONS APPEARING IN TABLE ARE FOR UNCOATED PARTS. WHEN COATING IS ADDED, ENTRY DIAMETER WILL BE REDUCED BY .06 [1.5] MAX.

4. ORDERING INFORMATION

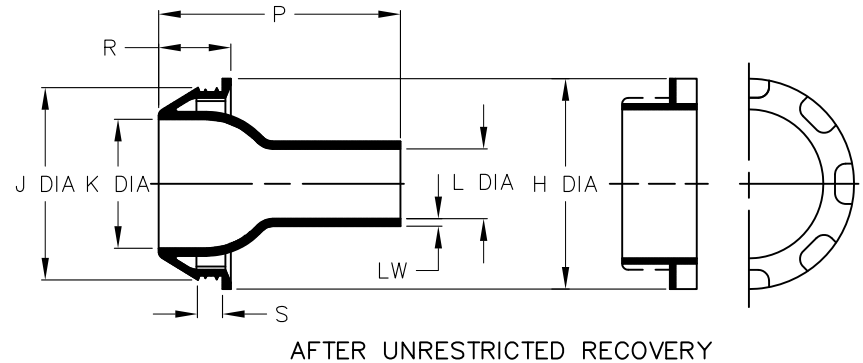
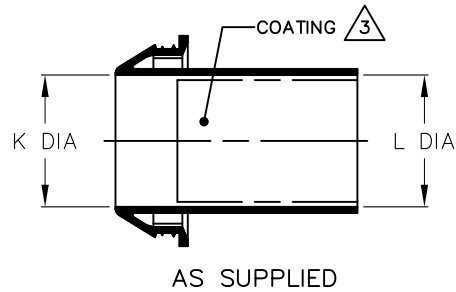
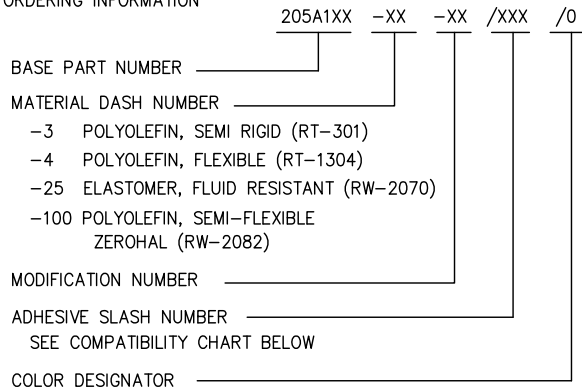

REVISIONS		
LTR	DESCRIPTION	DATE
F	REVISED PER ECO-11-007558	04/11/2011

TABLE OF DIMENSIONS

PART DESCRIPTION	TABLE OF DIMENSIONS										HOLE DIAMETER																			
	H		J		K		L		P	R	S	LW	CABLE O.D. RANGE		.063±.02	.125±.02	.250±.02													
	MAX	b	MAX	b	MIN	a	±8%	b	MIN	a	MAX	b	±10%	b	±10%	b	±10%	b	MIN	MAX	PANEL THICKNESS	PANEL THICKNESS	PANEL THICKNESS							
205A112	1.16	[29,5]	1.01	[25,7]	.44	[11,2]	.50	[12,7]	.44	[11,2]	.17	[4,3]	1.75	[44,5]	.65	[16,5]	.26	[6,6]	.06	[1,5]	.17	[4,3]	.40	[10,2]	.063±.02	[1,6±0,5]	.125±.02	[3,2±0,5]	.250±.02	[6,4±0,5]
205A123	1.50	[38,1]	1.34	[34,0]	.71	[18,0]	.78	[19,8]	.71	[18,0]	.38	[9,7]	2.20	[55,9]	.65	[16,5]	.26	[6,6]	.07	[1,8]	.38	[9,7]	.70	[17,8]	.063±.02	[1,6±0,5]	.125±.02	[3,2±0,5]	.250±.02	[6,4±0,5]
205A134	2.00	[50,8]	1.83	[46,5]	1.09	[27,7]	1.20	[30,5]	1.09	[27,7]	.65	[16,5]	2.25	[57,2]	.70	[17,8]	.26	[6,6]	.10	[2,5]	.65	[16,5]	1.05	[26,7]	.063±.02	[1,6±0,5]	.125±.02	[3,2±0,5]	.250±.02	[6,4±0,5]
205A145	2.30	[58,4]	2.15	[54,6]	1.39	[35,3]	1.50	[38,1]	1.39	[35,3]	.99	[25,2]	3.00	[76,2]	.69	[17,5]	.26	[6,6]	.09	[2,3]	1.00	[25,4]	1.35	[34,3]	.063±.02	[1,6±0,5]	.125±.02	[3,2±0,5]	.250±.02	[6,4±0,5]
205A155	3.06	[77,7]	2.97	[75,4]	1.82	[46,2]	1.98	[50,3]	1.82	[46,2]	1.28	[32,5]	3.60	[91,4]	.78	[19,8]	.27	[6,9]	.10	[2,5]	1.28	[32,5]	1.80	[45,7]	.063±.02	[1,6±0,5]	.125±.02	[3,2±0,5]	.250±.02	[6,4±0,5]
205A165	3.92	[99,6]	3.82	[97,0]	2.51	[63,8]	2.76	[70,1]	2.51	[63,8]	1.77	[45,0]	4.50	[114,3]	.83	[21,1]	.27	[6,9]	.12	[3,1]	1.77	[45,0]	2.50	[63,5]	.063±.02	[1,6±0,5]	.125±.02	[3,2±0,5]	.250±.02	[6,4±0,5]

If this document is printed it becomes uncontrolled. Check for the latest revision

Raychem Molded Parts
CUSTOMER DRAWING

COMPATIBILITY CHART

MATERIAL DASH NO.	ADHESIVE (COATING) SLASH NUMBER	ADHESIVE (COATING) S NUMBER
-3	/42; /86;	S-1017; S-1048;
-4	/42; /86;	S-1017; S-1048;
-25	/42; /86; /225	S-1017; S-1048; S-1206
-100	/86;	S-1048;

UNLESS OTHERWISE SPECIFIED DIMENSIONS ARE INCHES. METRIC DIMENSIONS ARE IN BRACKETS.

DECIMAL TOLERANCES
 .XXX ± 0.005 [0.13 mm]
 .XX ± 0.01 [0.25 mm]
 .X ± 0.1 [0.50 mm]

ANGLE TOLERANCE
 .X ± 1 DEG.

THIRD ANGLE PROJECTION

REVISED: UNGUYEN
 APPROVED: DHURRELL

TE Connectivity
STE

TITLE: FEEDTHROUGH, SEAL

SIZE: B
 CODE IDENT. NO.: 06090
 DWG. NO.: 205A112thru165

© 2001- 2011 Tyco Electronics Corporation. All rights reserved. SCALE: NTS DO NOT SCALE THIS DRAWING SHEET 1 OF 1