

## GM.A | Bent tubular handles

Aluminium and stainless steel



- 1
- 2
- 3
- 4
- 5
- 6
- 7
- 8
- 9
- 10
- 11
- 12
- 13
- 14
- 15
- 16
- 17
- 18

### HANDLE SHANKS

Aluminium, epoxy resin coating, RAL 9005 black colour, matte finish. Threaded blind holes.

### END CAPS

Fine ground AISI 304 stainless steel.

### STANDARD EXECUTION

Fine ground AISI 304 stainless steel tube, thickness 1.5 mm.

### DESIGN

The slightly bent shape of the tube provides GM.A handles a modern and refined design.



## GN 665 | Arch-shaped handles

Zinc alloy and aluminium



### HANDLE SHANKS

Die-cast zinc alloy, RAL 9006 grey colour.

Zinc-plated steel screws and washers included in the supply. Two pins between the handle shanks and the oval cross section bar offer a secure assembly and a fine positioning.

### STANDARD EXECUTION

Aluminium. Oval cross section bar, epoxy resin coating, RAL 9005 black colour, matte finish.

### SPECIAL EXECUTIONS ON REQUEST

- Different lengths.
- Surfaces with different finishes.
- Epoxy resin coating, RAL 9006 light-grey colour, matte finish (GN 665-SR).



Conversion Table			
1 mm = 0.039 inch			
L		l2	
mm	inch	mm	inch
600	23.62	526	20.71
700	27.56	632	24.88

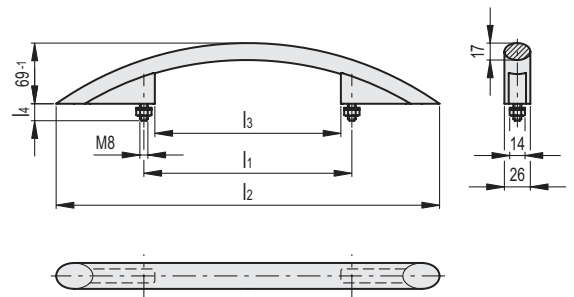
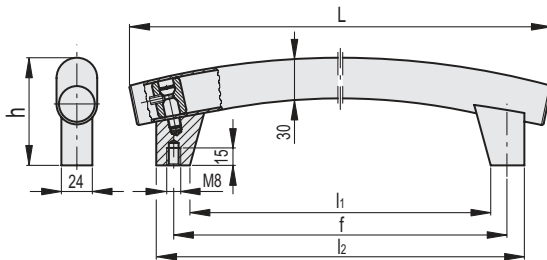

Code	Description	f	L	h	l1	l2	Δ
RHGM-30.A500.33	GM-30.A500.33	500	600	90	460	540	1050
RHGM-30.A600.33	GM-30.A600.33	600	700	100	560	640	1120

Code	Description	l1	l2	l3	l4	Δ
GN.27471	GN 665-26-350-SW	350±0.25	526	328	17	621
GN.27475	GN 665-26-450-SW	450±0.25	632	428	20	699