

THIS COPY IS PROVIDED ON A RESTRICTED BASIS AND IS NOT TO BE USED IN ANY WAY DETRIMENTAL TO THE INTERESTS OF PANDUIT CORP.

ALL DIMENSIONS ARE IN mm									
Part Number	Class 2r Wire Size	Class 5f & 6f Wire Size	Wire Strip Length	Panduit Die Index No. For Class 2r Wire Circumferential Dies	Panduit Die Index No. For Class 5f & 6f Wire Circumferential Dies	Panduit Die Index No. For Class 5f & 6f Wire Nest/Indenter Dies	$l \pm 2.76$	$o \pm .50$	$i \pm .50$
SCMS10-C	10mm ²	----	16.5	P21	----	----	30.0	6.20	4.50
SCMS16-C	16mm ²	10mm ²	19.0	P24	P21	P29/1	35.0	7.20	5.50
SCMS25-L	25mm ²	16mm ²	19.5	P29	P21	P29/1	36.0	8.80	6.90
SCMS35-L	35mm ²	25mm ²	19.5	P29	P29	P42/2	36.0	10.40	8.20
SCMS50-L	50mm ²	35mm ²	26.0	P37	P33	P50/2	49.0	12.30	9.80
SCMS70-L	70mm ²	50mm ²	27.5	P45	P37	P50/2	52.0	14.20	11.50
SCMS95-Q	95mm ²	70mm ²	28.5	P54	P45	P62/4	54.0	16.50	13.50
SCMS120-Q	120mm ²	95mm ²	30.0	P62	P50	P76/4	57.0	18.60	15.20
SCMS150-X	150mm ²	120mm ²	30.0	P66	----	P76/4	57.0	21.00	16.50
SCMS185-X	185mm ²	150mm ²	32.0	P76	----	P76/4	61.0	23.00	18.60
SCMS240-X	240mm ²	185mm ²	37.5	P87	----	P87/4	72.0	26.00	20.80
SCMS300-5	300mm ²	240mm ²	39.0	P94	----	P106/6	75.0	29.00	23.50
SCMSX300-5	----	300mm ² 5f ONLY	49.0	----	----	P32/6	95.0	33.00	26.20
SCMS400-5	400mm ²	-----	49.0	P106	----	----	95.0	34.50	27.00
SCMS500-6	500mm ²	-----	49.5	P125	----	----	96.0	40.00	31.00
SCMS630-6	630mm ²	-----	67.0	P125	----	----	131.0	44.00	34.50

NOTES:

1. Material: High conductivity seamless copper tube.
2. Plating: Parts are annealed and tin plated.
3. Wire Type: Class 2r, 5f & 6f Stranded Copper per DIN VDE 0295, IEC 60228 and HD 383.
4. UL Listed Wire Connector: Yes, for applications up to 35kv. Consult cable manufacturer for voltage stress relief instruction with applications greater than 2000 volts.
5. UL Temperature Rating: 90° C
6. C.S.A. Certified Wire Connector: Yes
7. Parts are CE and tested per EN 61238-1:2003/IEC 61238-1:2003 Class B, with Class 2r wire 10mm² - 630mm².

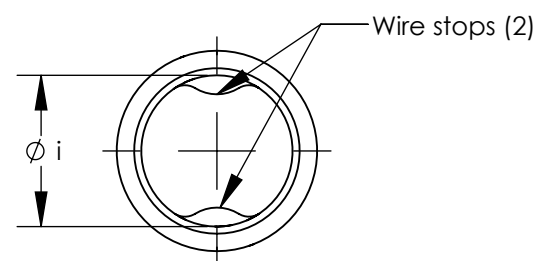
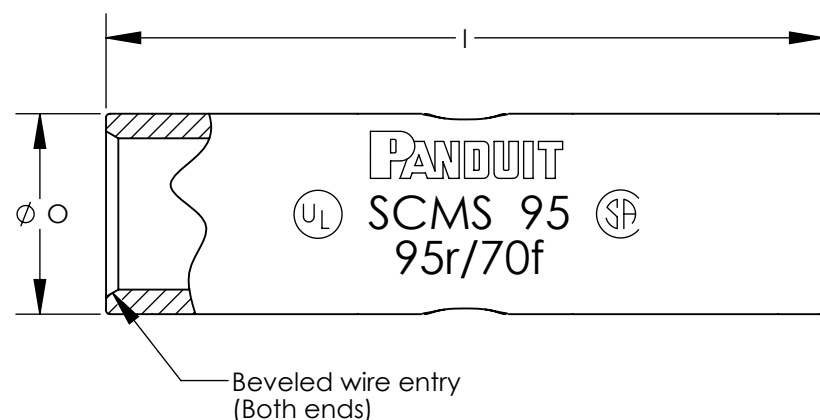

LISTED Wire Connector



CERTIFIED

REV	DATE	BY	CHK	APR	DESCRIPTION	ECN
02	7/14	JHNU	TLCO	RGB	ADDED 5f ONLY TO WIRE SIZE FOR SCMSX300 PART	13J059BI-JC
01	6/14	JHNU	TLCO	RGB	REVISED NOTE 7: 630 WAS 240	13J059BI-JC
00	6/14	JHNU	TLCO	RGB	DRAWING RELEASED	13J059BI-JC

TITLE		METRIC SPLICES - SCMS SERIES 10-630mm CUSTOMER DRAWING	
ITEM REVISION NAME	13J059BI/02		
DATASET FILE NAME	13J059BI-JC/02.SLDDRW		
UNLESS OTHERWISE SPECIFIED, DIMENSIONAL TOLERANCES ARE: IN [mm]			
.X ±	.XXX ±		
.XX ±	ANGLES ±	SEE NOTES	
		THIRD ANGLE PROJECTION	DRAWING NUMBER
DRAWN BY		12J059BI-JC	
JHNU	DATE	CHK	SCALE
6/14	TLCO	NONE	SHEET 1 OF 1
SIZE			B