

REV.	SPECIFICATION	ECN NO.	APPD.

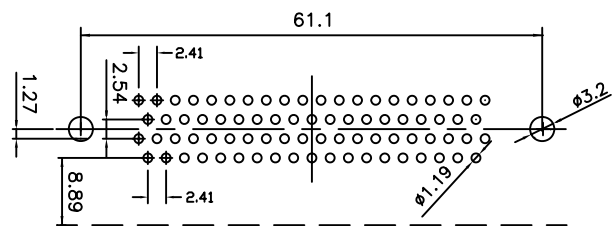
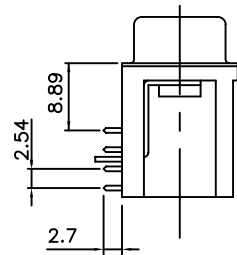
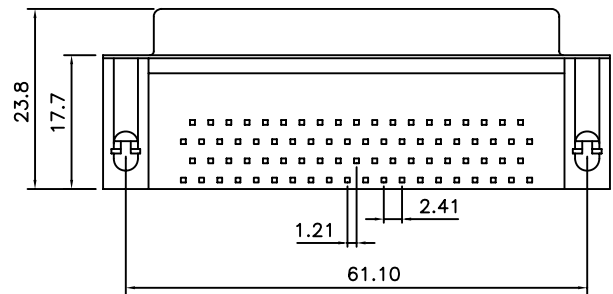
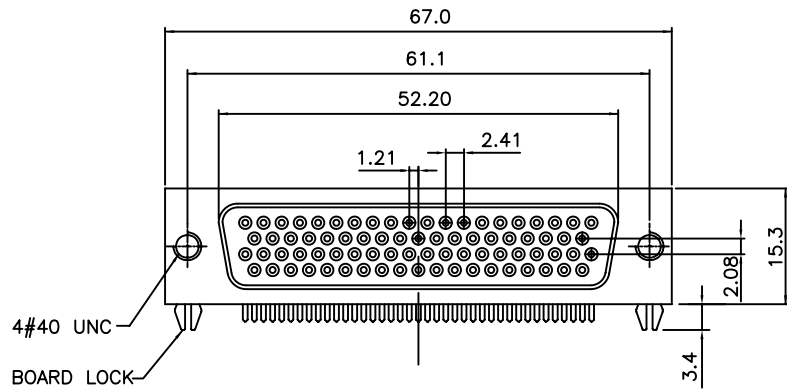

P.C. Board layout

Material:

Housing: 30% Glass filled PBT UL94V-0.
 Contacts: Brass.
 Board Lock: Copper Alloy.
 Shell: Steel.

Electrical Characteristics:

Current Rating: 1 AMP.
 Dielectric Withstanding Voltage: AC 1000V For 1 minute.
 Insulator Resistance: 1000MΩmin. at DC 500V.
 Contact Resistance: 30mΩmax. at DC 100mA.
 Operating Temperature: -55°C ~ +105°C.

***RoHS Compliant**

7916- 78 F B C 00 A
 Series Position F:Female C:Selective Gold Plated
 B: With Ground Forks and With Riveted Threaded Inserts.
 A: Tray Package
 00:G/F

Tolerances	Drawn No.	7916D02002
x = ±0.5	Projection	
.x = ±0.25	Unit	mm
.xx = ±0.15	Scale	1:1
	Drawn By	Pony 08/04'09

Title: 7916 Series
 H.D D-SUB
 Right Angle Type
 0512

OUPIN			
OUPIN ELECTRONIC(KUNSHAN) CO., LTD.			
P/N: 7916-78FBC00A			
SHEET	1/1	Ver.No.	A3