

NOTES:

1. FOR ILLUSTRATION PURPOSES, DRAWING SHOWS PART WITH 12 CIRCUIT SIZE.
2. MATERIAL:
HOUSING & CAP:
HIGH TEMPERATURE THERMOPLASTIC, UL RATED 94V-0 SUITABLE FOR SURFACE-MOUNT SOLDERING PROCESS.
COLOR BLACK
TERMINAL: PHOSPHOR BRONZE ALLOY.
3. PLATING- 0.76µm MINIMUM GOLD PLATE AT CONTACT AREA, AND 1.90µm MINIMUM TIN PLATE AT P.C TAIL AREA, BOTH OVER 1.27µm MINIMUM NICKEL OVERALL.
4. COPLANARITY OF P.C TAIL TO BE MEASURED BY RESTING THE PART ON A FLAT GAGE SURFACE.
5. THIS AREA OF PART TO BE HEAT-STAKED TO RETAIN CONTACTS.
6. POSITION OF CAP TO BE LOCATED AT CENTER OF DIMENSION "A" REGARDLESS OF CIRCUIT SIZE.
7. PRODUCT SPECIFICATION PS-87340 APPLIES.
8. PART TO BE PACKAGED IN TAPE-&-REEL. SEE SHEET 2 FOR PACKAGING DETAILS.
9. CONTACT FACTORY FOR PARTS AVAILABILITY.

PART NUMBER W/CAP IN TUBE	CKT. SIZE	DIM. A	DIM. B
87340-0497	4	4.00	2.00
87340-0697	6	6.00	4.00
87340-0897	8	8.00	6.00
87340-1097	10	10.00	8.00
87340-1297	12	12.00	10.00
87340-1497	14	14.00	12.00
87340-1697	16	16.00	14.00
87340-1897	18	18.00	16.00
87340-2097	20	20.00	18.00

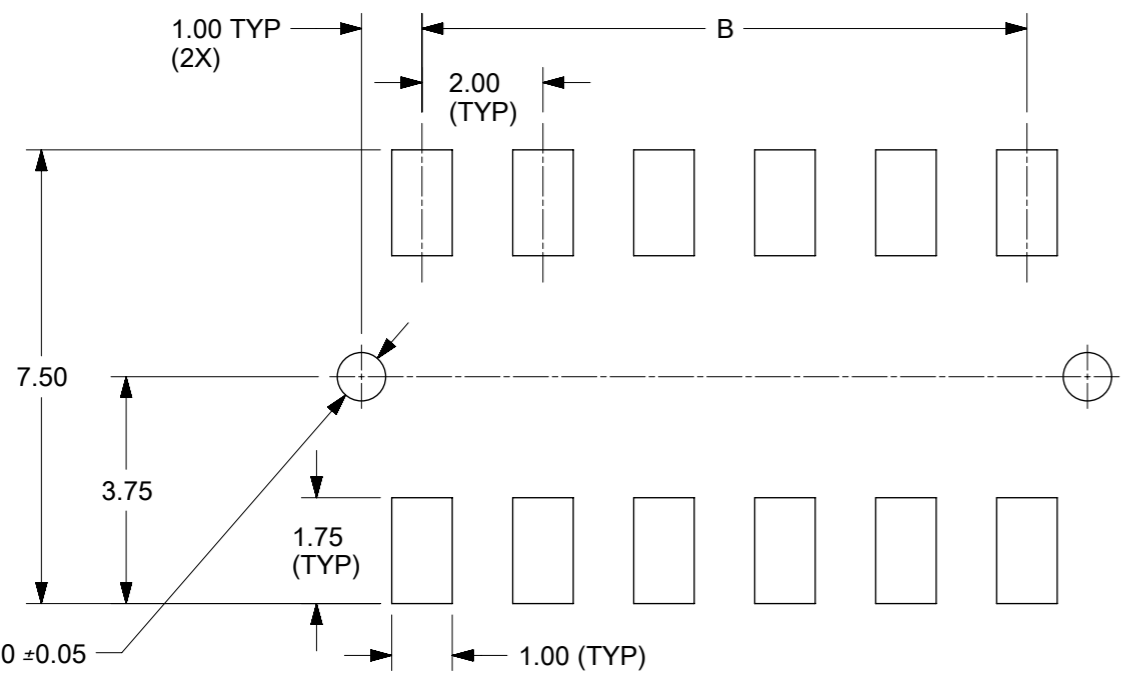
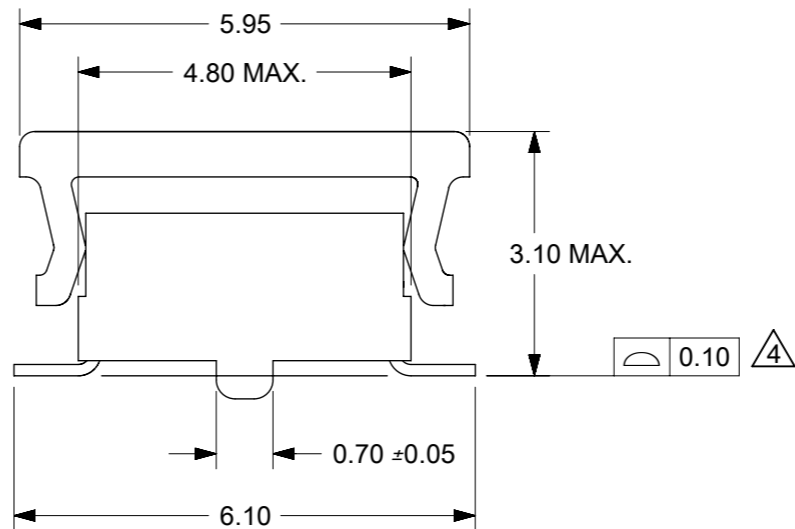
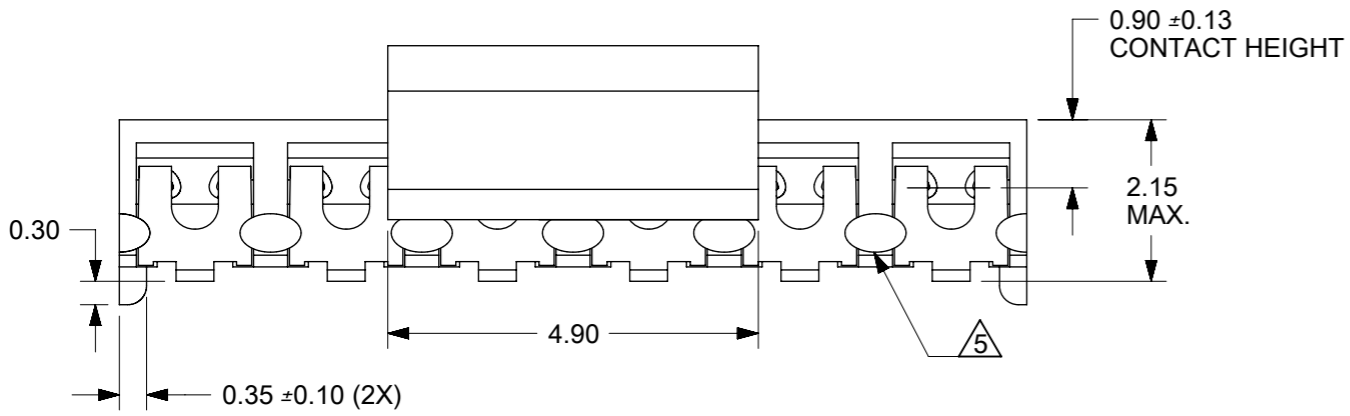

RECOMMENDED SOLDER PAD DESIGN

THIS DRAWING CONTAINS INFORMATION THAT IS PROPRIETARY TO MOLEX ELECTRONIC TECHNOLOGIES, LLC AND SHOULD NOT BE USED WITHOUT WRITTEN PERMISSION		CURRENT REV DESC: MIGRATED TO ECTR		molex	
GENERAL TOLERANCES (UNLESS SPECIFIED)		EC NO: 172635			
4 PLACES ±		DRWN: RMV02		TOP ENTRY RECEPT., SMT W/CAP FOR PICK-&-PLACE	
3 PLACES ±		CHK'D: CD		PRODUCT CUSTOMER DRAWING	
2 PLACES ± 0.2		APPR: GGA		DOCUMENT NUMBER	
1 PLACE ±		INITIAL REVISION:		SD-87340-XX94	
0 PLACES ±		DRWN: DSOH		DOC TYPE	
ANGULAR TOL ± 3.0°		APPR: SKTOH		PSD	
DRAFT WHERE APPLICABLE MUST REMAIN WITHIN DIMENSIONS		THIRD ANGLE PROJECTION		DOC PART	
		DRAWING		REVISION	
		A3-SIZE		D1	
		SERIES		SHEET NUMBER	
		87340		1 OF 2	
		MATERIAL NUMBER		CUSTOMER	
		SEE TABLE		GENERAL MARKET	

PART NUMBER W/CAP IN TAPE/REEL	CKT. SIZE	Ao	Bo	F	W	Ko
87340-0498	4	6.70	5.30	11.50	24.00	5.30
87340-0698	6	6.50	6.50	7.50	16.00	4.50
87340-0898	8	6.70	8.40	11.50	24.00	5.30
87340-1298	12	6.60	12.40	11.50	24.00	4.40
87340-1498	14	6.60	14.30	11.50	24.00	4.40
87340-1698	16	6.60	16.30	11.50	24.00	4.40
87340-2098	20	6.70	20.50	20.20	44.00	5.30

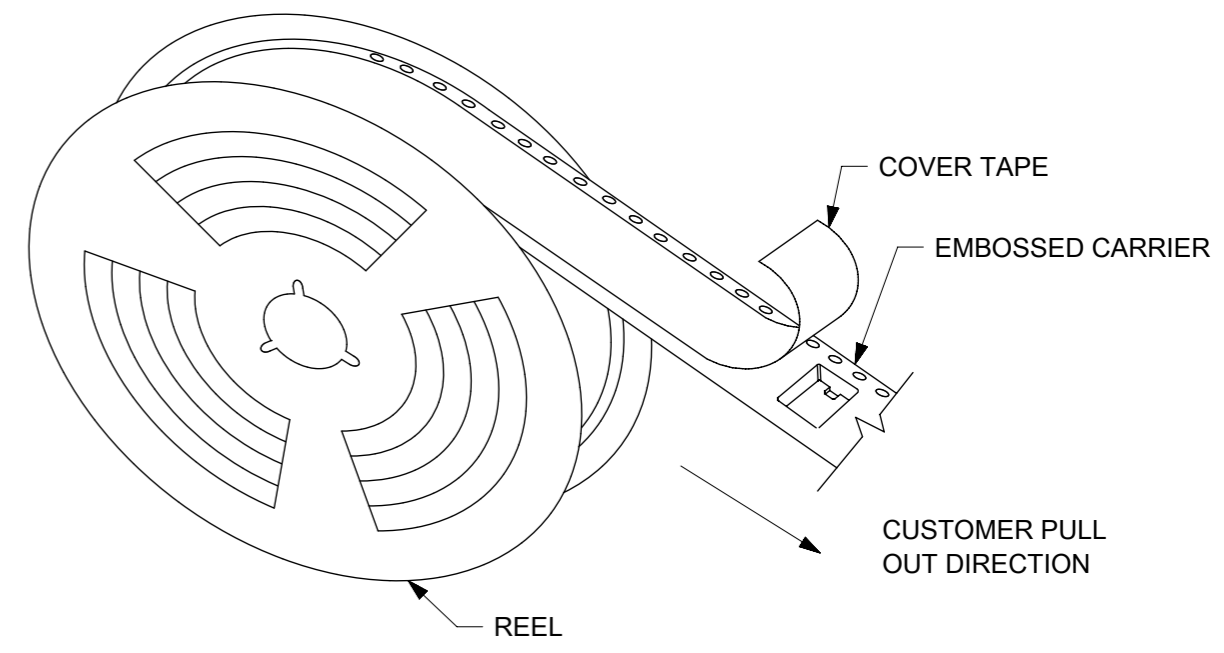
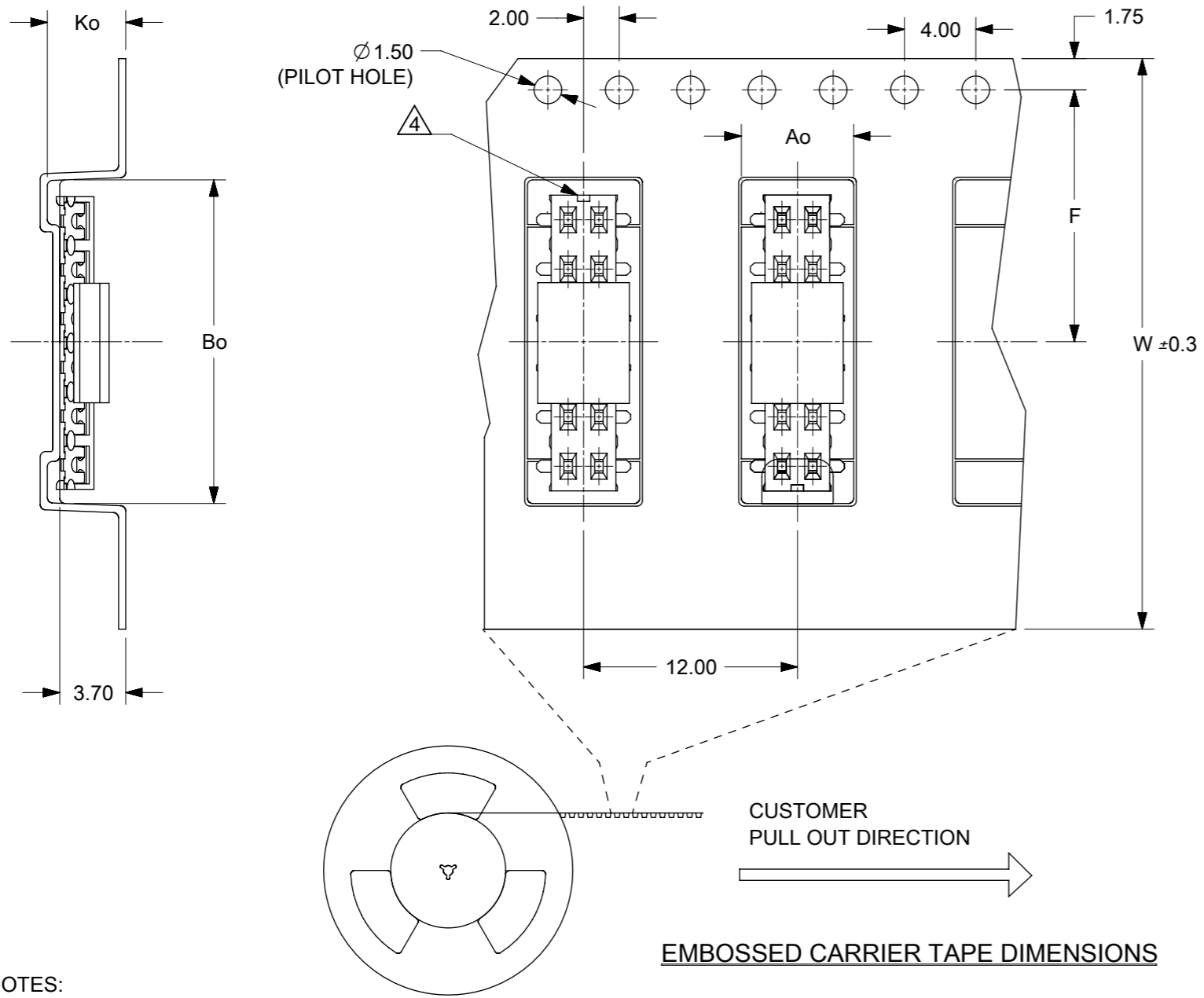

TAPE AND REEL ASSEMBLY SHOWN IS FOR ILLUSTRATION ONLY.

EMBOSSED CARRIER TAPE DIMENSIONS

NOTES:
1. LEADER AND TRAILER TAPE

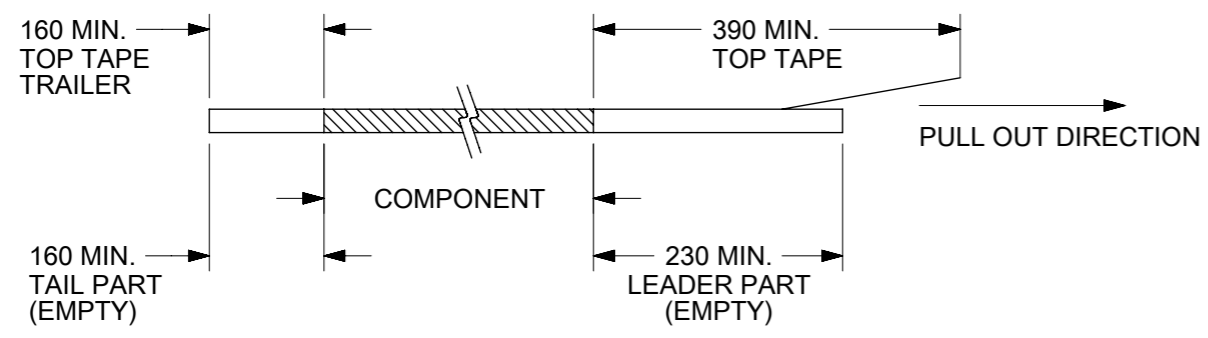

2. PEELING OFF FORCE OF THE TOP TAPE: 20-80gf.
(PEELING DIRECTION AS SHOWN IN FOLLOWING FIGURE)

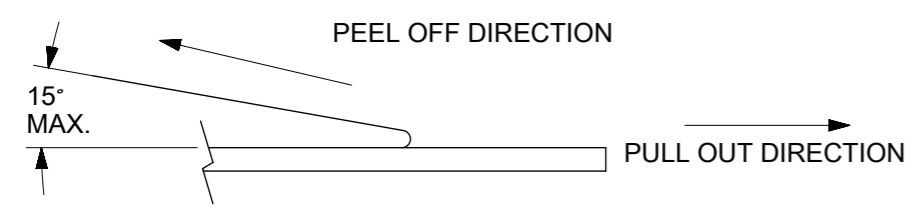

3. PACKAGING STANDARD IS AS PER EIA-481.
4. NO FIX ORIENTATION OF ASSEMBLY PART IN T&R.

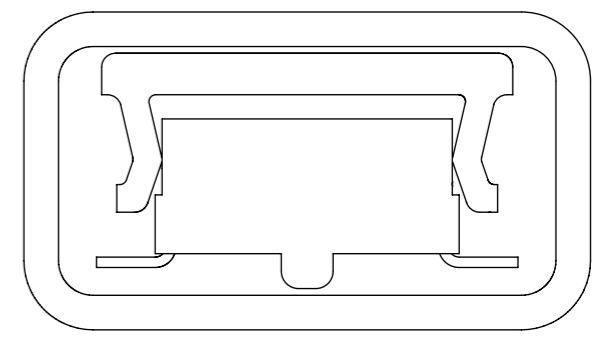

PART IN TUBE VIEW

THIS DRAWING CONTAINS INFORMATION THAT IS PROPRIETARY TO MOLEX ELECTRONIC TECHNOLOGIES, LLC AND SHOULD NOT BE USED WITHOUT WRITTEN PERMISSION											
DIMENSION UNITS		SCALE		CURRENT REV DESC: MIGRATED TO ECTR							
mm		NTS									
GENERAL TOLERANCES (UNLESS SPECIFIED)											
		MM	INCH	EC NO: 172635 DRWN: RMV02 2018/02/20 CHK'D: CD 2018/05/25 APPR: GGA 2018/05/30							
4 PLACES		±	±	PRODUCT CUSTOMER DRAWING DOCUMENT NUMBER: SD-87340-XX94 DOC TYPE: PSD DOC PART: 001 REVISION: D1							
3 PLACES		±	±								
2 PLACES		± 0.2	±	INITIAL REVISION: DRWN: DSOH 1997/06/19 APPR: SKTOH 1997/06/27							
1 PLACE		±	±								
0 PLACES		±	±	MATERIAL NUMBER: SEE TABLE CUSTOMER: GENERAL MARKET SHEET NUMBER: 2 OF 2							
ANGULAR TOL		± 3.0°									
DRAFT WHERE APPLICABLE MUST REMAIN WITHIN DIMENSIONS				THIRD ANGLE PROJECTION		DRAWING		SERIES		MATERIAL NUMBER	
						A3-SIZE		87340		SEE TABLE	