

REVISIONS					
P	LTR	DESCRIPTION	DATE	DWN	APVD
C		ECR-20-005011	06APR2020	QY	JB
D		ECR-20-007704	03JUN2020	QY	JB
D1		ECR-20-016724	25NOV2020	QY	JB

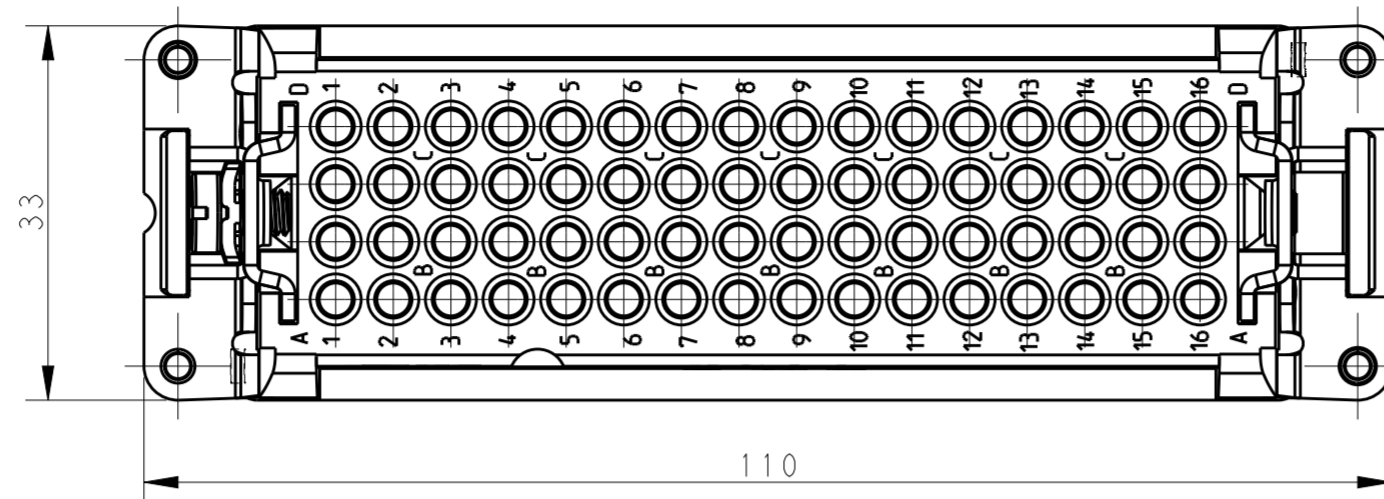

NOTES:  
 1. TECHNICAL CHARACTERISTICS:  
 INSULATION MATERIAL: PC  
 RATED VOLTAGE: 250V  
 RATED CURRENT: 10A  
 INSULATION RESISTANCE:  $\geq 400M\Omega$   
 RATED IMPULSE VOLTAGE: 4KV  
 POLLUTION DEGREE: 3  
 MATING CYCLES: 500 CYCLES  
 TEMPERATURE RANGE:  $-40\sim+125^{\circ}C$   
 WIRE RANGE:  $0.14mm^2\sim 2.5mm^2$  (AWG26-AWG14)  
 2. CONTACT NEED TO BE ORDERED SEPARATELY.

注释:  
 1. 技术参数:  
 绝缘材料: PC  
 额定电压: 250V  
 额定电流: 10A  
 绝缘电阻:  $\geq 400M\Omega$   
 脉冲电压: 4KV  
 污染等级: 3  
 插拔次数: 500 次  
 温度范围:  $-40\sim+125^{\circ}C$   
 接线范围:  $0.14mm^2\sim 2.5mm^2$  (AWG26-AWG14)  
 2. 端子需要单独订购.

M4 SCREW RECOMMENDED  
 TIGHTENING TORQUE 1.2Nm  
 M4螺丝, 推荐锁紧力矩1.2Nm

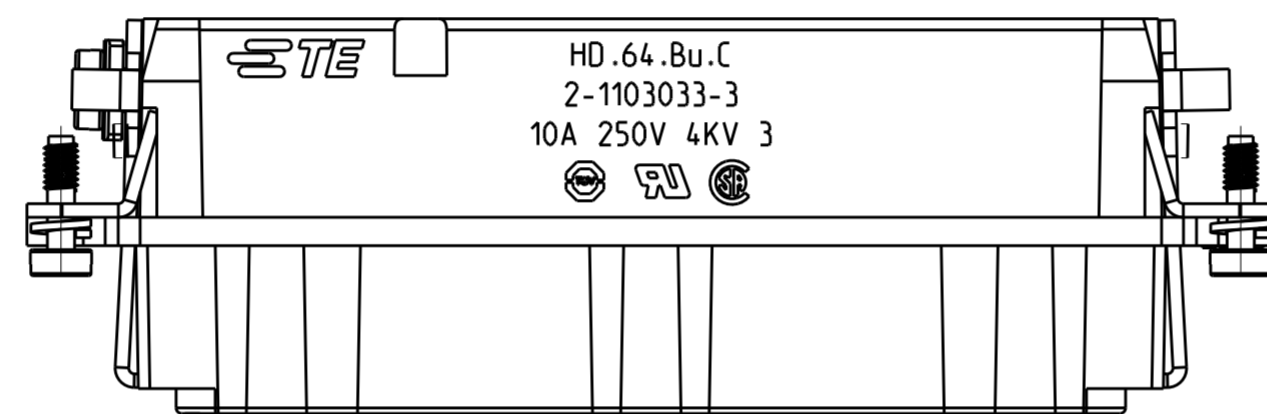
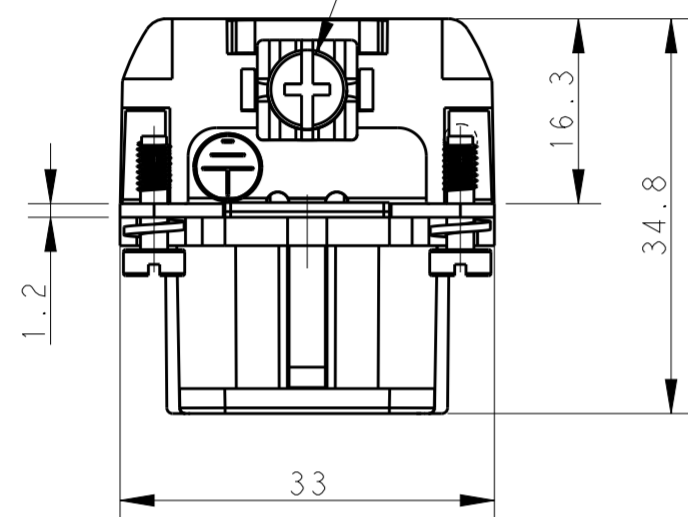

4X M3 SCREW  
 RECOMMENDED TIGHTENING TORQUE 0.5Nm  
 4X M3 螺丝, 推荐锁紧力矩0.5Nm

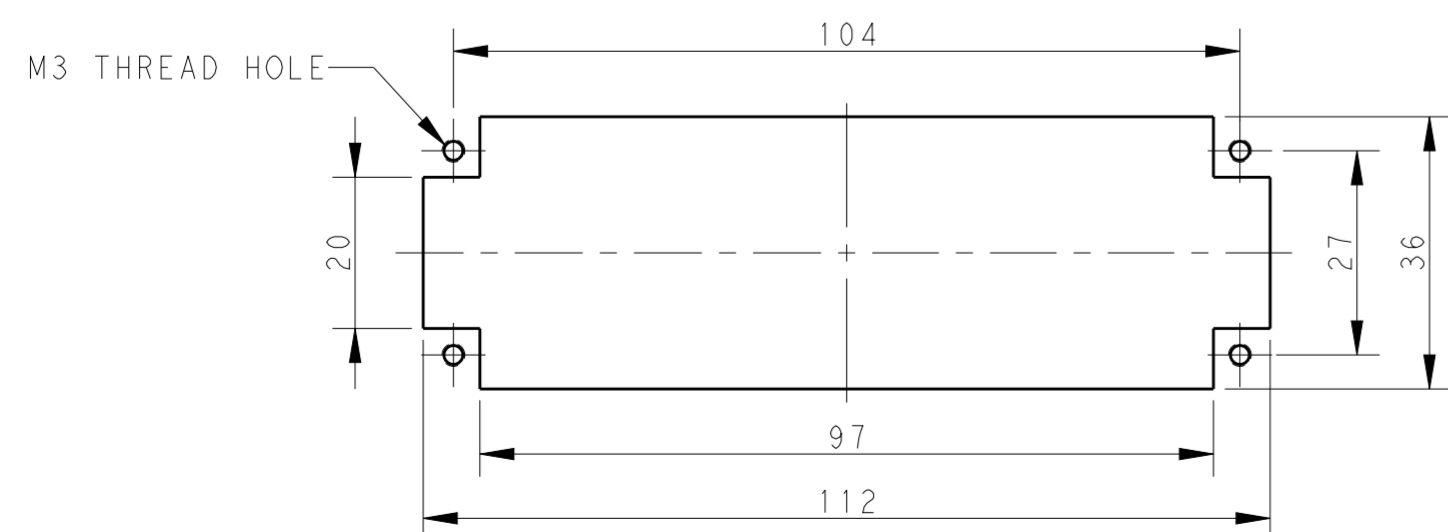
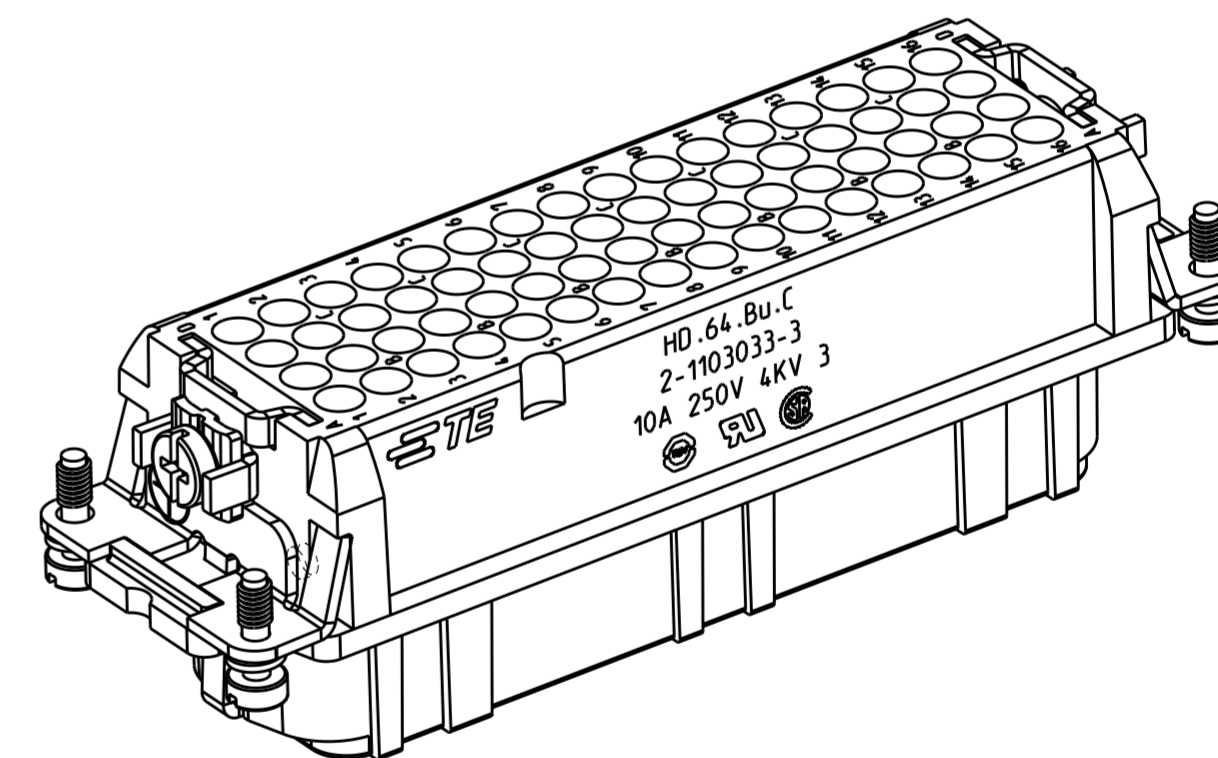
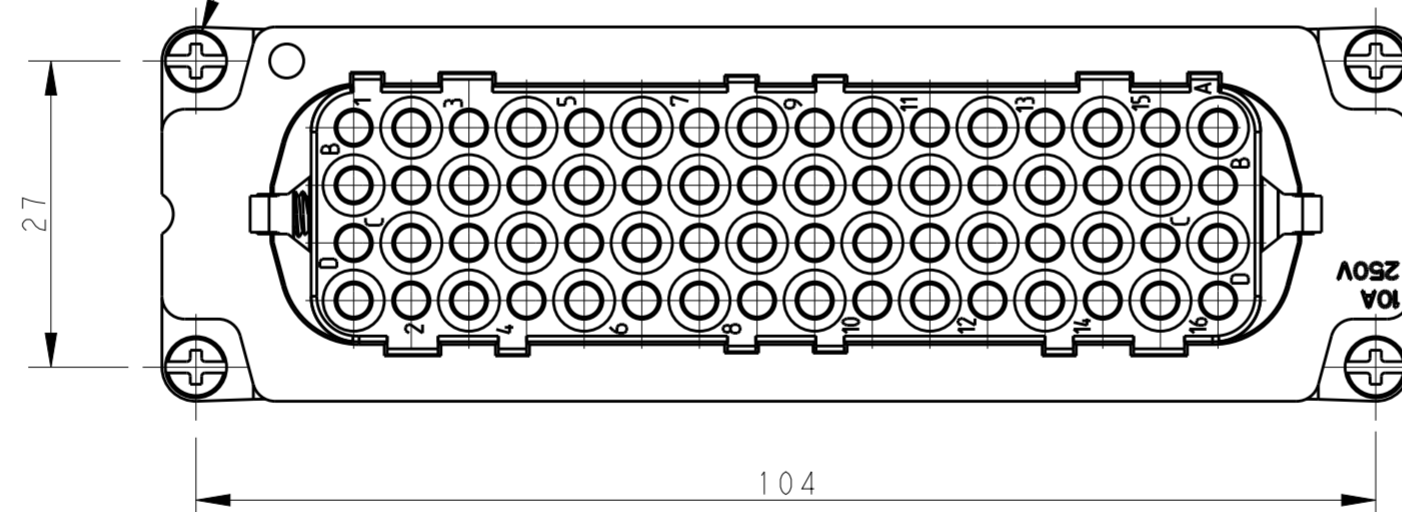

PANEL CUT FOR INSERTS FOR USE  
 WITHOUT HOODS/ HOUSINGS  
 不使用防护外壳时芯件的安装开孔图

2-1103033-3	HD.64.Bu.C	HD-064 FEMALE INSERT FOR STAMPED CONTACT TYPE HD-064 母插, 卷皮针型(HTS)
PART NUMBER 料号		PART DESCRIPTION 描述

THIS DRAWING IS A CONTROLLED DOCUMENT.		DWN 08JAN2020 CHK 08JAN2020 APVD 08JAN2020		
DIMENSIONS: mm		PRODUCT SPEC: 108-74002 APPLICATION SPEC: 114-74000 MATERIAL: - FINISH: -		
TOLERANCES UNLESS OTHERWISE SPECIFIED: 0 PLC ±- 1 PLC ±- 2 PLC ±- 3 PLC ±- 4 PLC ±- ANGLES ±- FINISH		NAME: HD.64.Bu.C SIZE: A2 CAGE CODE: 00779 DRAWING NO: C-1103033 RESTRICTED TO: -		SCALE: 3:2 SHEET: 1 OF 1 REV: D1
CUSTOMER DRAWING				