

## Flush-type connector - SACC-DSI-MINMS-4CON-UNF PCB - 1455010

Please be informed that the data shown in this PDF Document is generated from our Online Catalog. Please find the complete data in the user's documentation. Our General Terms of Use for Downloads are valid (<http://download.phoenixcontact.com>)



Sensor/actuator flush-type plug, 4-pos., 7/8", PCB mounting with 7/8" fastening thread

The illustration shows the 3-pos. version



### Key commercial data

Packing unit	1 1
Weight per Piece (excluding packing)	40.0 GRM
Custom tariff number	85366990
Country of origin	Germany

### Technical data

#### Ambient conditions

Ambient temperature (operation)	-40 °C ... 85 °C (Plug)
Degree of protection	IP67

#### General

Rated current at 40°C	9 A
Rated voltage	250 V
Number of positions	4
Contact resistance	≤ 5 mΩ
Insulation resistance	≥ 100 MΩ
Status display	No
Surge voltage category	II
Pollution degree	3
Connection method	Solder pins
Mounting type	PCB mounting 7/8"

#### Material

# Flush-type connector - SACC-DSI-MINMS-4CON-UNF PCB - 1455010

## Technical data

### Material

Inflammability class according to UL 94	HB
Contact material	CuZn
Contact surface material	Au
Contact carrier material	PUR
Material, knurls	Zinc die-cast, nickel-plated
Sealing material	Viton

## Classifications

### eCl@ss

eCl@ss 4.0	27140815
eCl@ss 4.1	27140815
eCl@ss 5.0	27143423
eCl@ss 5.1	27143423
eCl@ss 6.0	27143423
eCl@ss 7.0	27449001
eCl@ss 8.0	27449001

### ETIM

ETIM 4.0	EC002061
ETIM 5.0	EC002061

### UNSPSC

UNSPSC 6.01	31251501
UNSPSC 7.0901	31251501
UNSPSC 11	31251501
UNSPSC 12.01	31251501
UNSPSC 13.2	31251501

## Approvals

### Approvals

---

#### Approvals

UL Recognized / cUL Recognized / GOST / cULus Recognized

---

#### Ex Approvals

# Flush-type connector - SACC-DSI-MINMS-4CON-UNF PCB - 1455010

## Approvals

Approvals submitted

### Approval details

UL Recognized	
mm <sup>2</sup> /AWG/kcmil	20
Nominal current I <sub>N</sub>	8 A
Nominal voltage U <sub>N</sub>	600 V

cUL Recognized	
mm <sup>2</sup> /AWG/kcmil	20
Nominal current I <sub>N</sub>	8 A
Nominal voltage U <sub>N</sub>	600 V

GOST	
------	--

cULus Recognized	
------------------	--

## Drawings

Dimensioned drawing

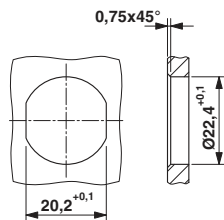

Schematic diagram

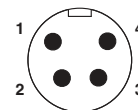

Connector pin assignment

# Flush-type connector - SACC-DSI-MINMS-4CON-UNF PCB - 1455010

Drilling diagram

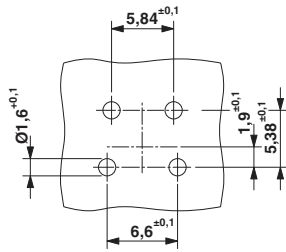

Dimensioned drawing

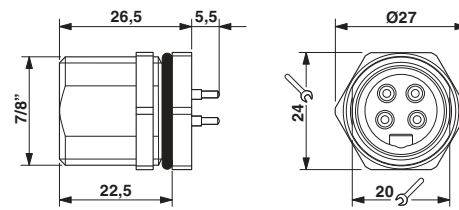

7/8" flush-type plug