

SPECIFICATION CONTROL DRAWING

THIS DRAWING CONTAINS INFORMATION PROPRIETARY TO RF INDUSTRIES, LTD. ANY UNAUTHORIZED USE OF THIS DRAWING IS EXPRESSLY PROHIBITED. ANY VIOLATION IS PUNISHABLE UNDER U.S. COPYRIGHT LAWS.

REV	DESCRIPTION	DWN	DATE	APPROVED
A	ENGINEERING RELEASE	KMM	9/1/93	C. JONES
B	CHANGE PART NUMBER FROM RSA-2387 \ ADD ELEC SPECS	KMM	9/3/96	R. RICE

008974

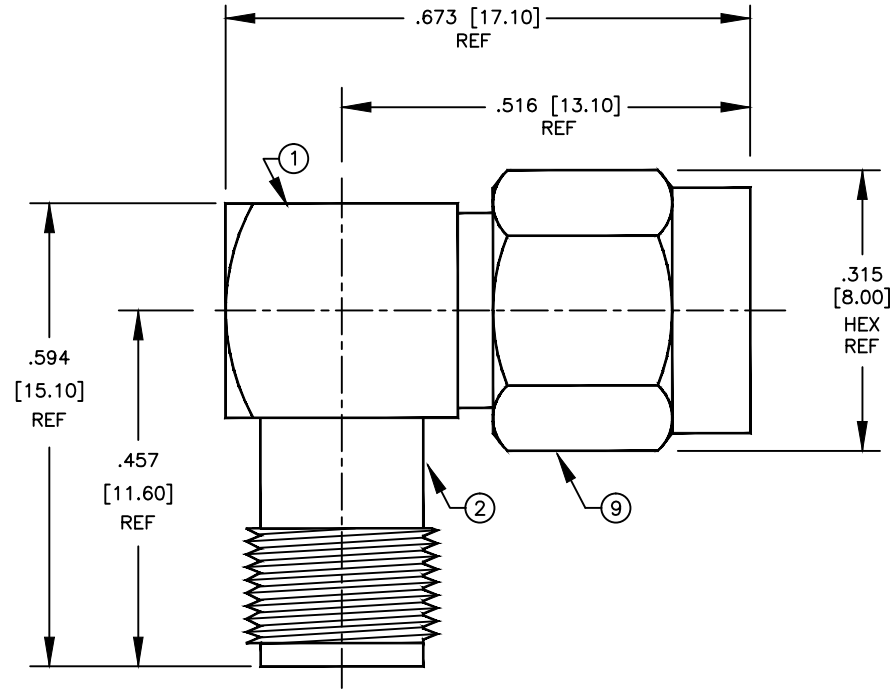

SPECIFICATIONS:

IMPEDANCE: 50 OHMS
 WORKING VOLTAGE: 335 VRMS @ SEA LEVEL
 FREQUENCY RANGE: 0-12.4 GHz

ITEM	DESCRIPTION	QTY	MATERIAL	FINISH
10	END CAP	1	BRASS	NICKEL
9	SHELL	1	BRASS	NICKEL
8	RETAINING RING	1	BeCu	NONE
7	GASKET	1	S.I. RUBBER	RED
6	DIELECTRIC	1	PTFE	NONE
5	DIELECTRIC	1	PTFE	NONE
4	CONTACT	1	BeCu	GOLD
3	PIN	1	BRASS	GOLD
2	FEMALE BODY	1	BRASS	NICKEL
1	MALE BODY	1	BRASS	NICKEL

DIMENSIONS ARE IN INCHES AND [MILLIMETERS]

UNLESS OTHERWISE NOTED TOLERANCES ARE:

DECIMALS DIAMETER

DRAWN
K. MAXWELL 9/3/96

CHECKED

ORJ DRAWN
K. MAXWELL 9/1/93

APPROVALS DATE

*RF*connectors

DIVISION OF RF INDUSTRIES, LTD.

7610 MIRAMAR RD
 SAN DIEGO, CA 92126
 (619)549-6340
 (619)549-6345 FAX

RSA-3402

SMA FEMALE TO SMA MALE R/A ADAPTER

SIZE A	CABLE GROUP N/A	DWG NO. 8204	REV B
------------------	---------------------------	------------------------	-----------------

SCALE: 4:1 CAD FILE 13ARC B SHEET 1 OF 1