

Silicon Carbide Schottky Diode

- Worlds first 600V Schottky diode
- Revolutionary semiconductor material - Silicon Carbide
- Switching behavior benchmark
- No reverse recovery
- No temperature influence on the switching behavior
- Ideal diode for Power Factor Correction up to 800W¹⁾
- No forward recovery
- Pb-free lead plating; RoHS compliant
- Qualified according to JEDEC⁰⁾ for target applications

thinQ!TM SiC Schottky Diode

Product Summary

| | | |
|-----------|-----|----|
| V_{RRM} | 600 | V |
| Q_C | 13 | nC |
| I_F | 4 | A |

PG-TO220-2-2.

P-TO252

P-TO220

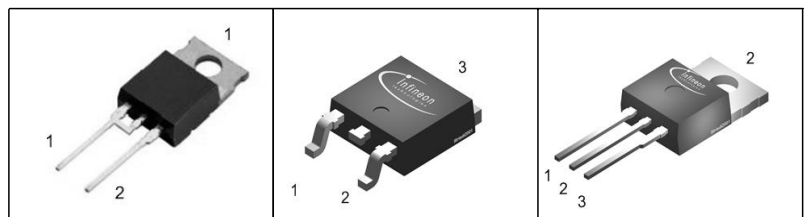

| Type | Package | Ordering Code | Marking | Pin 1 | Pin 2 | Pin 3 |
|----------|---------------|---------------|---------|-------|-------|-------|
| SDP04S60 | P-TO220-3 | Q67040-S4369 | D04S60 | n.c. | C | A |
| SDD04S60 | P-TO252-3 | Q67040-S4368 | D04S60 | n.c. | A | C |
| SDT04S60 | PG-TO220-2-2. | Q67040-S4445 | D04S60 | C | A | |

Maximum Ratings, at $T_j = 25^\circ\text{C}$, unless otherwise specified

| Parameter | Symbol | Value | Unit |
|---|----------------|-------------|------------------|
| Continuous forward current, $T_C=100^\circ\text{C}$ | I_F | 4 | A |
| RMS forward current, $f=50\text{Hz}$ | I_{FRMS} | 5.6 | |
| Surge non repetitive forward current, sine halfwave $T_C=25^\circ\text{C}$, $t_p=10\text{ms}$ | I_{FSM} | 12.5 | |
| Repetitive peak forward current $T_j=150^\circ\text{C}$, $T_C=100^\circ\text{C}$, $D=0.1$ | I_{FRM} | 18 | |
| Non repetitive peak forward current $t_p=10\mu\text{s}$, $T_C=25^\circ\text{C}$ | I_{FMAX} | 40 | |
| i^2t value, $T_C=25^\circ\text{C}$, $t_p=10\text{ms}$ | $\int i^2 dt$ | 0.78 | A ² s |
| Repetitive peak reverse voltage | V_{RRM} | 600 | V |
| Surge peak reverse voltage | V_{RSM} | 600 | |
| Power dissipation, $T_C=25^\circ\text{C}$ | P_{tot} | 36.5 | W |
| Operating and storage temperature | T_j, T_{stg} | -55... +175 | $^\circ\text{C}$ |

Thermal Characteristics

| Parameter | Symbol | Values | | | Unit |
|---|------------|--------|------|----------|------|
| | | min. | typ. | max. | |
| Characteristics | | | | | |
| Thermal resistance, junction - case | R_{thJC} | - | - | 4.1 | K/W |
| Thermal resistance, junction - ambient, leaded | R_{thJA} | - | - | 62 | |
| SMD version, device on PCB: PG-TO252-3-1: @ min. footprint PG-TO252-3-1: @ 6 cm ² cooling area ²⁾ | R_{thJA} | - | - | 75 50 | |

Electrical Characteristics, at $T_j = 25^\circ\text{C}$, unless otherwise specified

| Parameter | Symbol | Values | | | Unit |
|--|--------|--------|----------|-------------|------|
| | | min. | typ. | max. | |
| Static Characteristics | | | | | |
| Diode forward voltage $I_F=4\text{A}$, $T_j=25^\circ\text{C}$ $I_F=4\text{A}$, $T_j=150^\circ\text{C}$ | V_F | - | 1.7 2 | 1.9 2.4 | V |
| Reverse current $V_R=600\text{V}$, $T_j=25^\circ\text{C}$ $V_R=600\text{V}$, $T_j=150^\circ\text{C}$ | I_R | - | 15 40 | 200 1000 | |

⁰J-STD20 and JESD22

¹CCM, $V_{IN} = 85\text{VAC}$, $T_j = 150^\circ\text{C}$, $T_C = 100^\circ\text{C}$, $\eta = 93\%$, $\Delta I_{IN} = 30\%$

²Device on 40mm*40mm*1.5mm epoxy PCB FR4 with 6cm² (one layer, 70 μm thick) copper area for drain connection. PCB is vertical without blown air.

Electrical Characteristics, at $T_j = 25\text{ °C}$, unless otherwise specified

| Parameter | Symbol | Values | | | Unit |
|--|----------|--------|----------------|------|------|
| | | min. | typ. | max. | |
| AC Characteristics | | | | | |
| Total capacitive charge $V_R=400\text{V}$, $I_F=4\text{A}$, $di_F/dt=200\text{A}/\mu\text{s}$, $T_j=150\text{°C}$ | Q_C | - | 13 | - | nC |
| Switching time $V_R=400\text{V}$, $I_F=4\text{A}$, $di_F/dt=200\text{A}/\mu\text{s}$, $T_j=150\text{°C}$ | t_{rr} | - | n.a. | - | ns |
| Total capacitance $V_R=0\text{V}$, $T_C=25\text{°C}$, $f=1\text{MHz}$ $V_R=300\text{V}$, $T_C=25\text{°C}$, $f=1\text{MHz}$ $V_R=600\text{V}$, $T_C=25\text{°C}$, $f=1\text{MHz}$ | C | - | 150 10 7 | - | pF |

1 Power dissipation

$$P_{\text{tot}} = f(T_C)$$

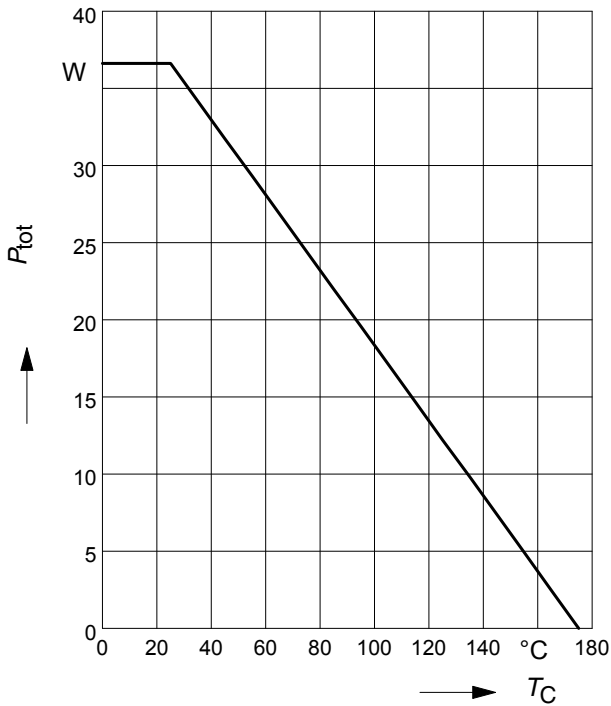

2 Diode forward current

$$I_F = f(T_C)$$

parameter: $T_j \leq 175^{\circ}\text{C}$

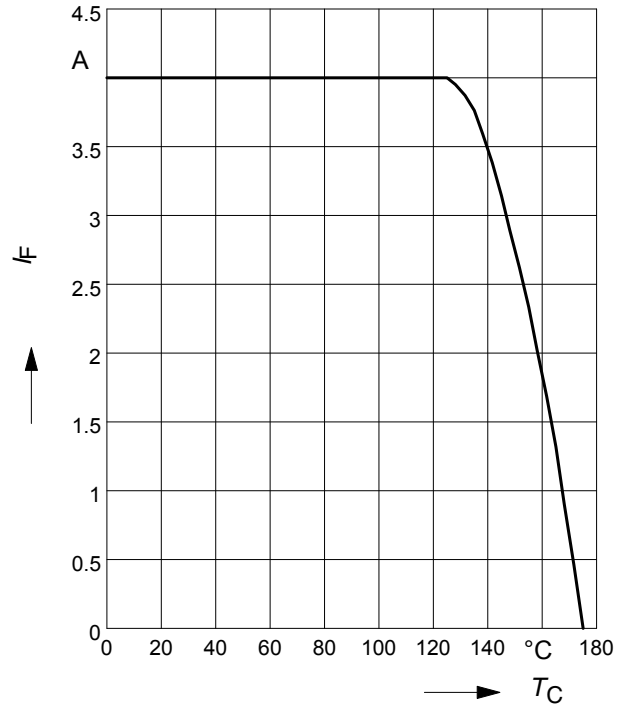

3 Typ. forward characteristic

$$I_F = f(V_F)$$

parameter: T_j , $t_p = 350 \mu\text{s}$

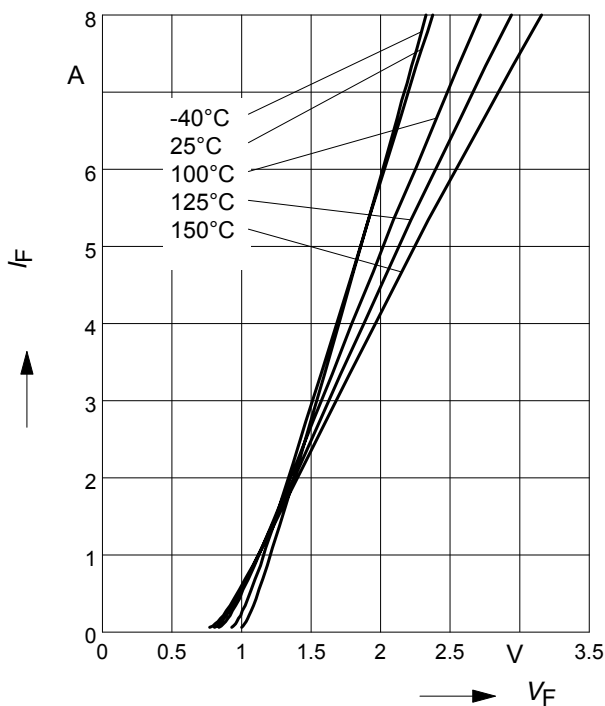

4 Typ. forward power dissipation vs. average forward current

$$P_{F(\text{AV})} = f(I_F) \quad T_C = 100^{\circ}\text{C}, d = t_p/T$$

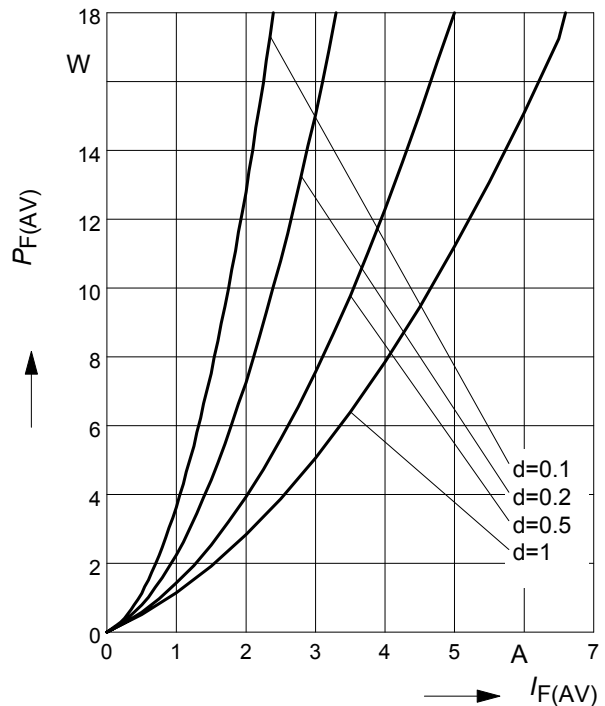

5 Typ. reverse current vs. reverse voltage

$$I_R = f(V_R)$$

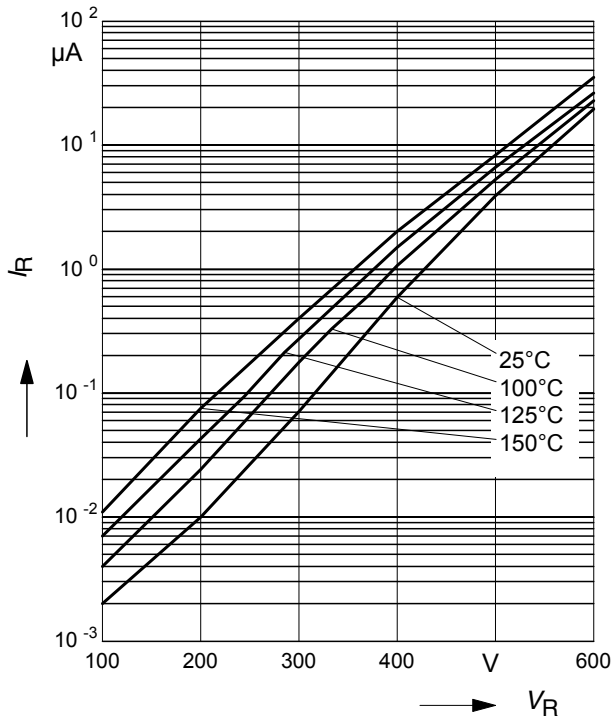

6 Transient thermal impedance

$$Z_{thJC} = f(t_p)$$

parameter : $D = t_p/T$

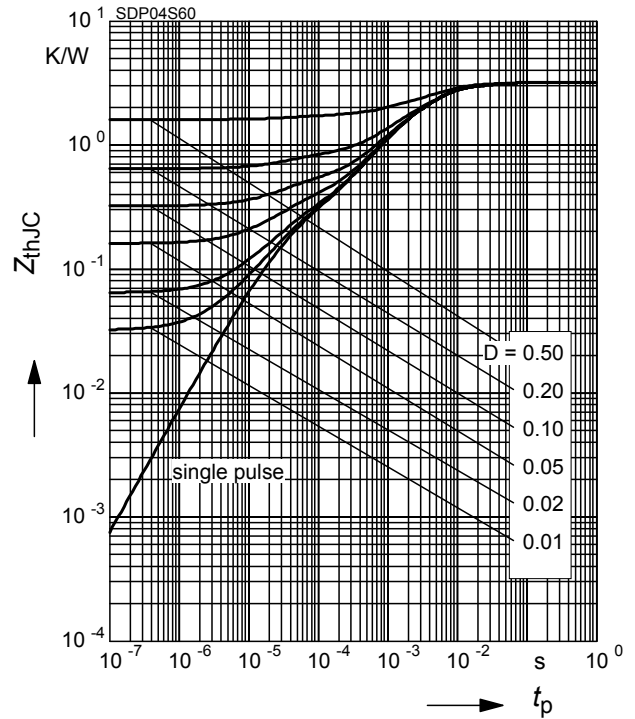

7 Typ. capacitance vs. reverse voltage

$$C = f(V_R)$$

parameter: $T_C = 25\text{ }^\circ\text{C}$, $f = 1\text{ MHz}$

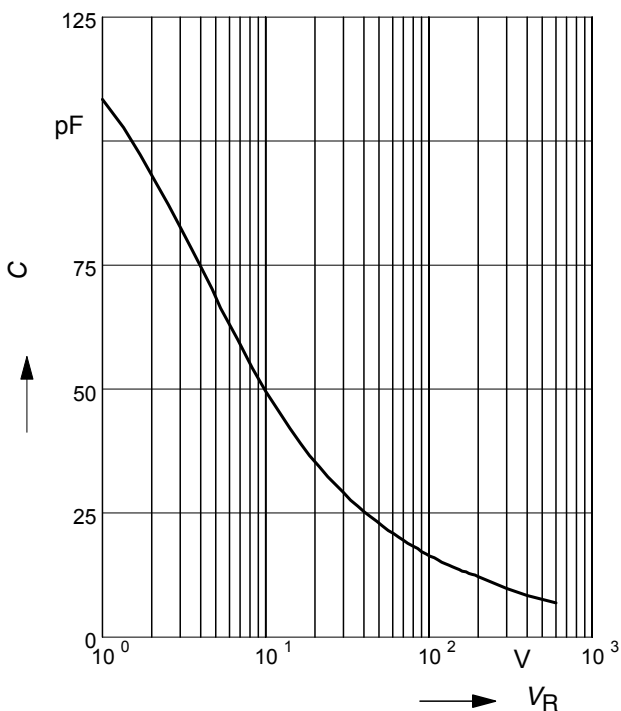

8 Typ. C stored energy

$$E_C = f(V_R)$$

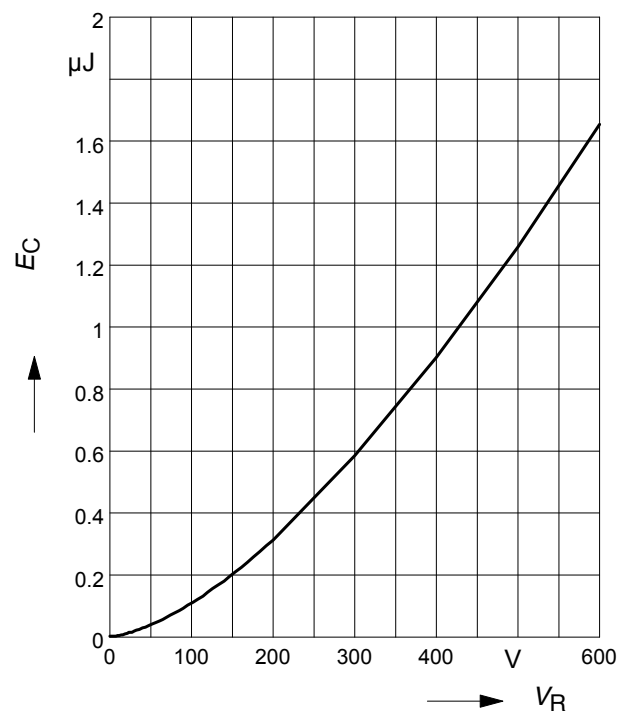

9 Typ. capacitive charge vs. current slope

$$Q_C = f(di_F/dt)$$

parameter: $T_j = 150\text{ }^\circ\text{C}$

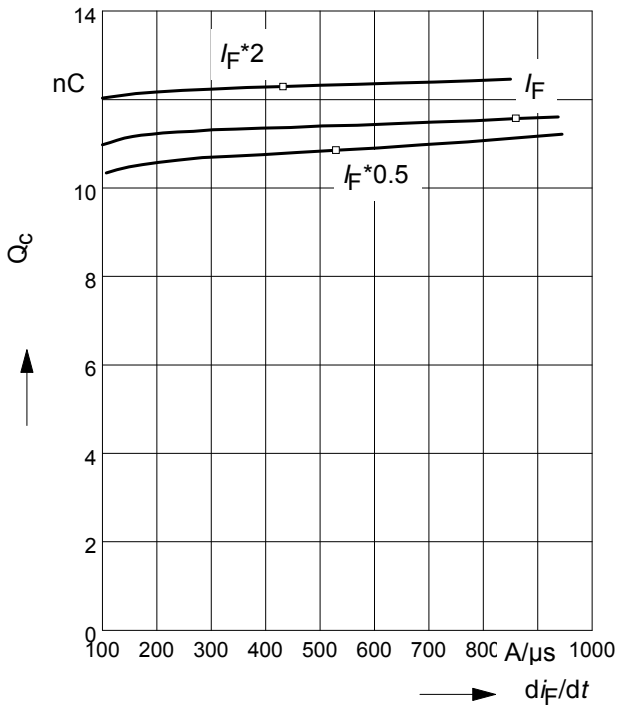

P-TO220-3-1, P-TO220-3-21

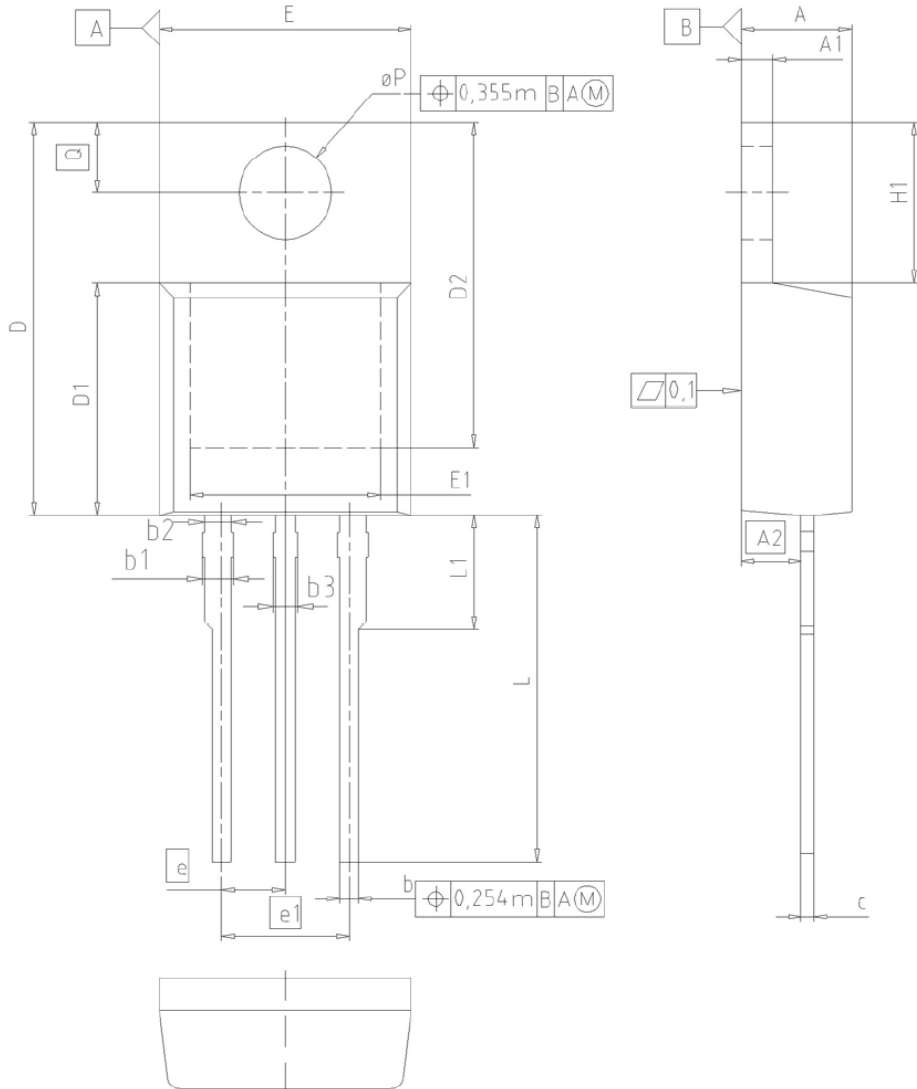

| DIM | MILLIMETERS | | INCHES | |
|----------|-------------|-------|--------|-------|
| | MIN | MAX | MIN | MAX |
| A | 4.30 | 4.57 | 0.169 | 0.180 |
| A1 | 1.17 | 1.40 | 0.046 | 0.055 |
| A2 | 2.15 | 2.72 | 0.085 | 0.107 |
| b | 0.65 | 0.86 | 0.026 | 0.034 |
| b1 | 0.95 | 1.40 | 0.037 | 0.055 |
| b2 | 0.95 | 1.15 | 0.037 | 0.045 |
| b3 | 0.65 | 1.15 | 0.026 | 0.045 |
| c | 0.33 | 0.60 | 0.013 | 0.024 |
| D | 14.81 | 15.95 | 0.583 | 0.628 |
| D1 | 8.51 | 9.45 | 0.335 | 0.372 |
| D2 | 12.19 | 13.10 | 0.480 | 0.516 |
| E | 9.70 | 10.36 | 0.382 | 0.408 |
| E1 | 6.50 | 8.60 | 0.256 | 0.339 |
| e | 2.54 | | 0.100 | |
| e1 | 5.08 | | 0.200 | |
| N | 3 | | 3 | |
| H1 | 5.90 | 6.90 | 0.232 | 0.272 |
| L | 13.00 | 14.00 | 0.512 | 0.551 |
| L1 | - | 4.80 | - | 0.189 |
| ϕP | 3.60 | 3.89 | 0.142 | 0.153 |
| Q | 2.60 | 3.00 | 0.102 | 0.118 |

DOCUMENT NO.
Z8B00003318

SCALE

EUROPEAN PROJECTION

ISSUE DATE
23-08-2007

REVISION
05

P-TO252-3-1, P-TO252-3-11, P-TO252-3-21 (D-Pak)

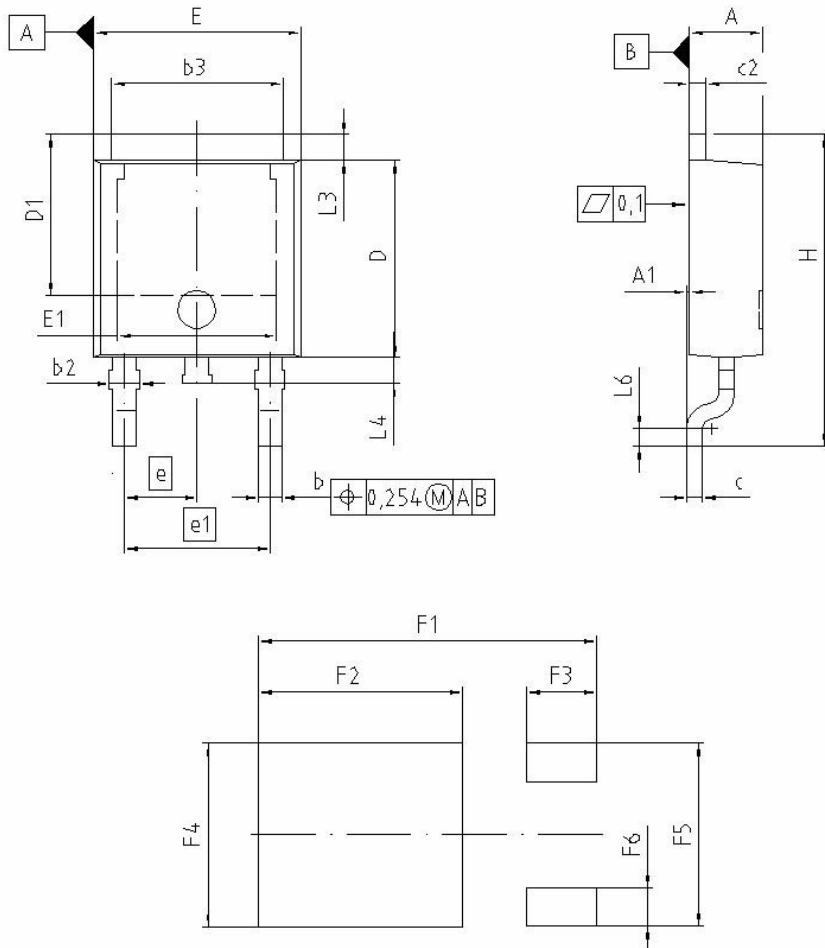

| DIM | MILLIMETERS | | INCHES | |
|-----|-------------|--------|--------|-------|
| | MIN | MAX | MIN | MAX |
| A | 2.159 | 2.413 | 0.085 | 0.095 |
| A1 | 0.000 | 0.150 | 0.000 | 0.006 |
| b | 0.635 | 0.889 | 0.025 | 0.035 |
| b2 | 0.650 | 1.150 | 0.026 | 0.045 |
| b3 | 5.004 | 5.500 | 0.197 | 0.217 |
| c | 0.457 | 0.580 | 0.018 | 0.023 |
| c2 | 0.460 | 0.980 | 0.018 | 0.039 |
| D | 5.969 | 6.223 | 0.235 | 0.245 |
| D1 | 5.020 | 5.842 | 0.198 | 0.230 |
| E | 6.400 | 6.731 | 0.252 | 0.265 |
| E1 | 4.850 | 5.207 | 0.191 | 0.205 |
| e | 2.286 | | 0.090 | |
| e1 | 4.572 | | 0.180 | |
| N | 3 | | 3 | |
| H | 9.400 | 10.480 | 0.370 | 0.413 |
| L3 | 0.900 | 1.143 | 0.035 | 0.045 |
| L4 | 0.584 | 0.950 | 0.023 | 0.037 |
| L6 | 0.510 | 0.686 | 0.020 | 0.027 |
| F1 | 10.500 | 10.700 | 0.413 | 0.421 |
| F2 | 6.300 | 6.500 | 0.248 | 0.256 |
| F3 | 2.100 | 2.300 | 0.083 | 0.091 |
| F4 | 5.700 | 5.900 | 0.224 | 0.232 |
| F5 | 5.660 | 5.860 | 0.222 | 0.231 |
| F6 | 1.100 | 1.300 | 0.043 | 0.051 |

REFERENCE
JEDEC TO252

SCALE

EUROPEAN PROJECTION

ISSUE DATE
21-09-2005

FILE
TO252_1

PG-TO-220-2-2

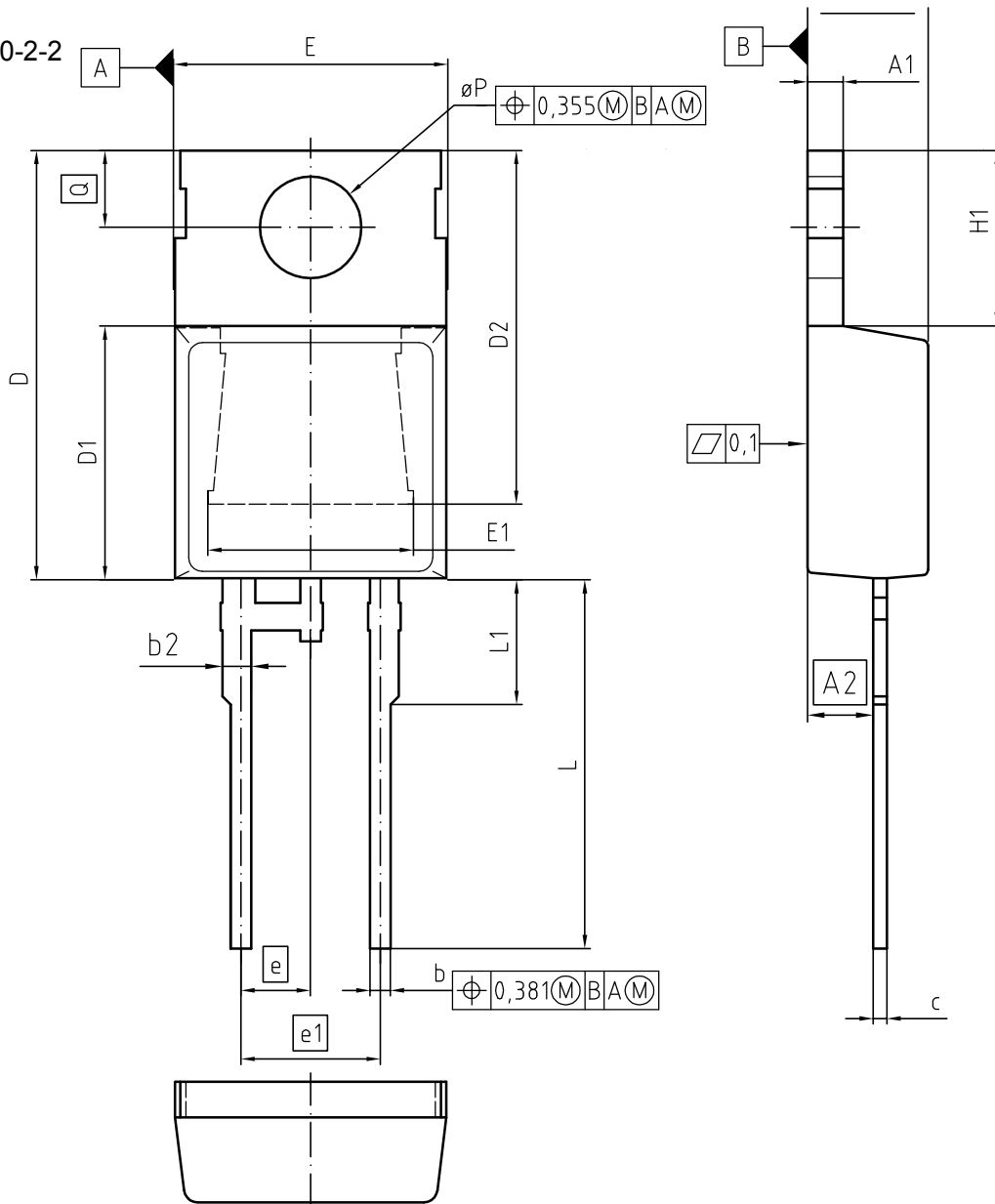

| DIM | MILLIMETERS | | INCHES | |
|-----|-------------|--------|--------|-------|
| | MIN | MAX | MIN | MAX |
| A | 4.191 | 4.699 | 0.165 | 0.185 |
| A1 | 1.170 | 1.400 | 0.046 | 0.055 |
| A2 | 2.215 | 2.718 | 0.087 | 0.107 |
| b | 0.635 | 0.889 | 0.025 | 0.035 |
| b2 | 0.950 | 1.651 | 0.037 | 0.065 |
| c | 0.330 | 0.635 | 0.013 | 0.025 |
| D | 14.808 | 15.950 | 0.583 | 0.628 |
| D1 | 8.509 | 9.450 | 0.335 | 0.372 |
| D2 | 12.850 | 14.245 | 0.506 | 0.561 |
| E | 9.677 | 10.363 | 0.381 | 0.408 |
| E1 | 6.500 | 8.788 | 0.256 | 0.346 |
| e | 2.540 | | 0.100 | |
| e1 | 5.080 | | 0.200 | |
| N | 2 | | 2 | |
| H1 | 5.900 | 6.900 | 0.232 | 0.272 |
| L | 12.700 | 14.000 | 0.500 | 0.551 |
| L1 | 3.048 | 4.800 | 0.120 | 0.189 |
| øP | 3.550 | 3.886 | 0.140 | 0.153 |
| Q | 2.540 | 3.048 | 0.100 | 0.120 |

DOCUMENT NO.
Z8B00003320

SCALE

EUROPEAN PROJECTION

ISSUE DATE
28-02-2007

REVISION
02

**Published by
Infineon Technologies AG
81726 Munich, Germany
© 2008 Infineon Technologies AG
All Rights Reserved.**

Legal Disclaimer

The information given in this document shall in no event be regarded as a guarantee of conditions or characteristics. With respect to any examples or hints given herein, any typical values stated herein and/or any information regarding the application of the device, Infineon Technologies hereby disclaims any and all warranties and liabilities of any kind, including without limitation, warranties of non-infringement of intellectual property rights of any third party.

Information

For further information on technology, delivery terms and conditions and prices, please contact the nearest Infineon Technologies Office (www.infineon.com).

Warnings

Due to technical requirements, components may contain dangerous substances. For information on the types in question, please contact the nearest Infineon Technologies Office. Infineon Technologies components may be used in life-support devices or systems only with the express written approval of Infineon Technologies, if a failure of such components can reasonably be expected to cause the failure of that life-support device or system or to affect the safety or effectiveness of that device or system. Life support devices or systems are intended to be implanted in the human body or to support and/or maintain and sustain and/or protect human life. If they fail, it is reasonable to assume that the health of the user or other persons may be endangered.