



# SERIES MDP-16 SWITCHES

## PUSHBUTTON SWITCHES - MODULAR



### SPECIFICATIONS

Contact Rating:	5A, 250VAC; 8A, 125VAC UL and VDE
Life Expectancy (Mechanical):	50,000 cycles
Life Expectancy (Electrical):	6,000 cycles
Contact Resistance:	100mΩ (initial max)
Insulation Resistance:	50MΩ @ 100V min.
Dielectric Strength:	2000VDC
Actuation Force:	500 grams SPDT 800 grams DPDT
Operating Temperature:	-25°C to 55°C
Storage Temperature:	-40°C to 70°C

### FEATURES & BENEFITS

- ▶ Modular interface design
- ▶ Attractive front panel design
- ▶ Illuminated options available
- ▶ Robust product for industrial applications

### APPLICATIONS/MARKETS

- ▶ Industrial controls
- ▶ Instrumentation
- ▶ Transportation
- ▶ Telecommunications

### ▶ ▶ ▶ HOW TO ORDER

SERIES	FUNCTION STYLE	ACTUATOR CONFIGURATION	ACTUATOR STYLE	CIRCUIT CONFIGURATION	LAMP	ACTUATOR COLOR
MDP-16	EE = Latching OA = Momentary	R = Round S = Square T = Rectangular	1 = Low Bezel 2 = High Bezel 3 = Flush Mount 5 = Full Guard*	1 = SPDT 2 = DPDT	00 = None 01 = 6VAC Incandescent 02 = 14VAC Incandescent 03 = 28VAC Incandescent 04 = 48VAC Incandescent 05 = 60VAC Incandescent 06 = 48VDC Incandescent 07 = Neon 110VAC 08 = Neon 220VAC 09 = LED 6VDC 10 = LED 12VDC 11 = LED 24VDC	R = Red B = Blue G = Green O = Orange Y = Yellow W = White

\* Note: Only offered in square

▶ ▶ ▶ Example Ordering Number  
MDP-16-OA-S-5-2-09-R

Specifications subject to change without notice.

TACT SWITCHES

NAVIGATION SWITCHES

PUSHBUTTON SWITCHES

TOGGLE SWITCHES

ROCKER SWITCHES

SLIDE SWITCHES

SNAP-ACTION SWITCHES

DIP SWITCHES

KEYLOCK SWITCHES

ROTARY SWITCHES

DETECTOR SWITCHES

CAP OPTIONS

# SERIES MDP-16 SWITCHES

## PUSHBUTTON SWITCHES - MODULAR

### LOW BEZEL ACTUATOR STYLE

#### RECTANGULAR

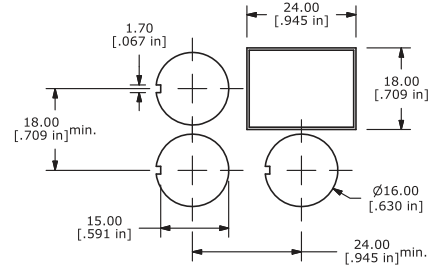
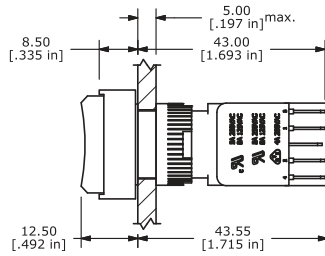
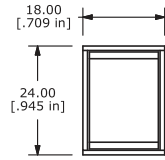

#### SQUARE

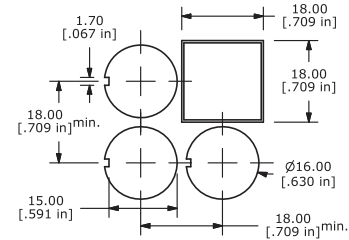
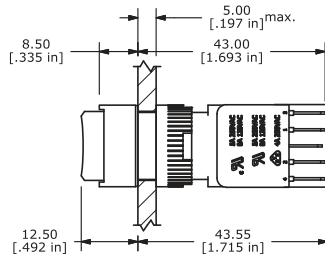
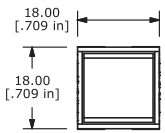

#### ROUND

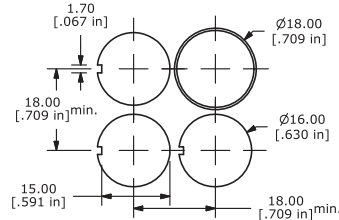
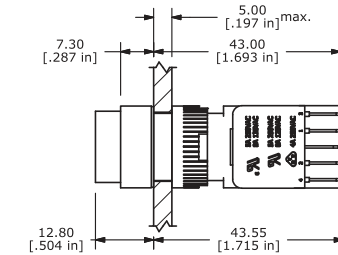
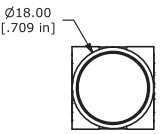

### HIGH BEZEL ACTUATOR STYLE

#### RECTANGULAR

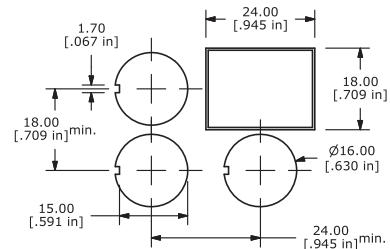
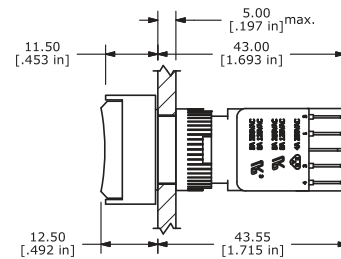
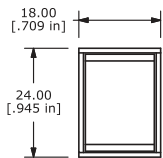

#### SQUARE

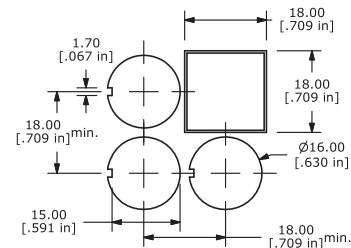
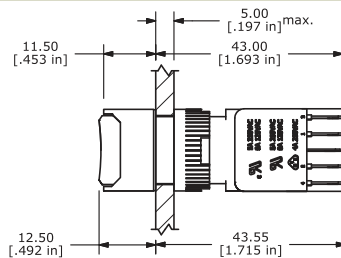
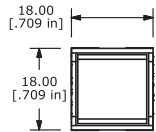

#### ROUND

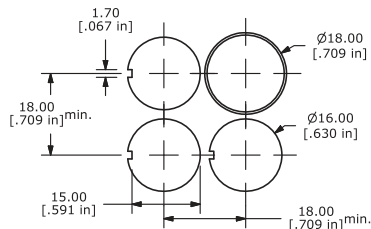
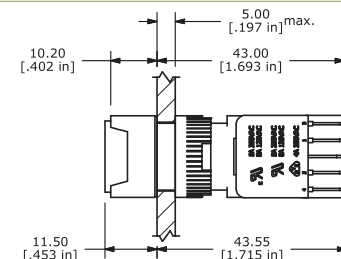
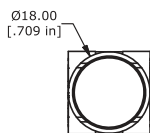

TACT SWITCHES

NAVIGATION SWITCHES

PUSHBUTTON SWITCHES

TOGGLE SWITCHES

ROCKER SWITCHES

SLIDE SWITCHES

SNAP-ACTION SWITCHES

DIP SWITCHES

KEYLOCK SWITCHES

ROTARY SWITCHES

DETECTOR SWITCHES

CAP OPTIONS



### FLUSH MOUNT ACTUATOR STYLE

#### RECTANGULAR

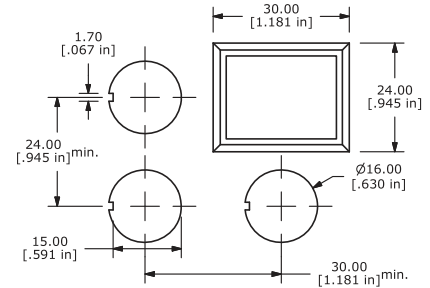
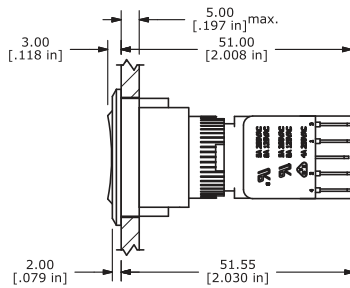
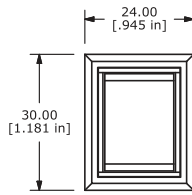

#### SQUARE

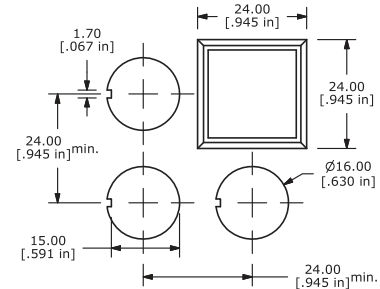
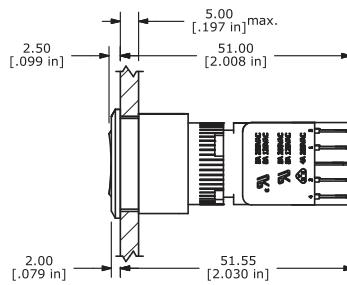
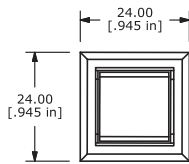

#### ROUND

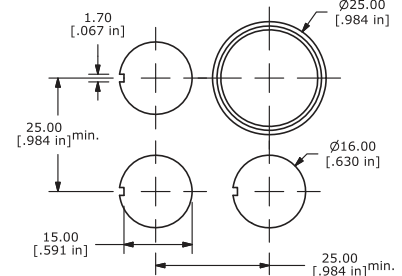
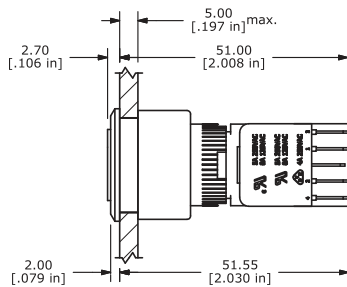
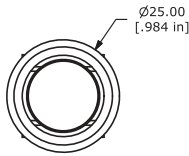

### FULL GUARD ACTUATOR STYLE

#### SQUARE

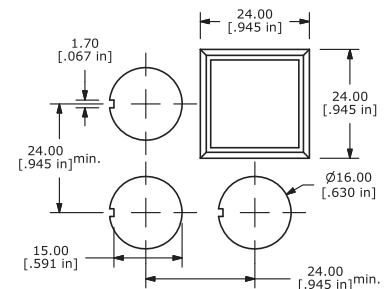
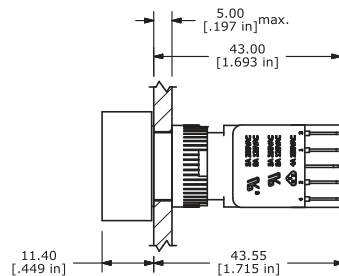
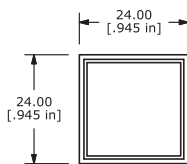

### SCHEMATIC

#### SPDT

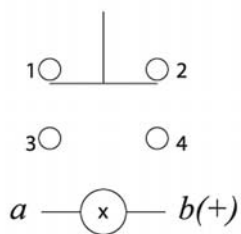

#### DPDT

