

P	LTR	DESCRIPTION	DATE	DWN	APVD
0		RELEASED EC 0G3B-0612-04	02JUN2005	SW	CR
A		PART STATUS UPDATED	20OCT2021	SCB	SS

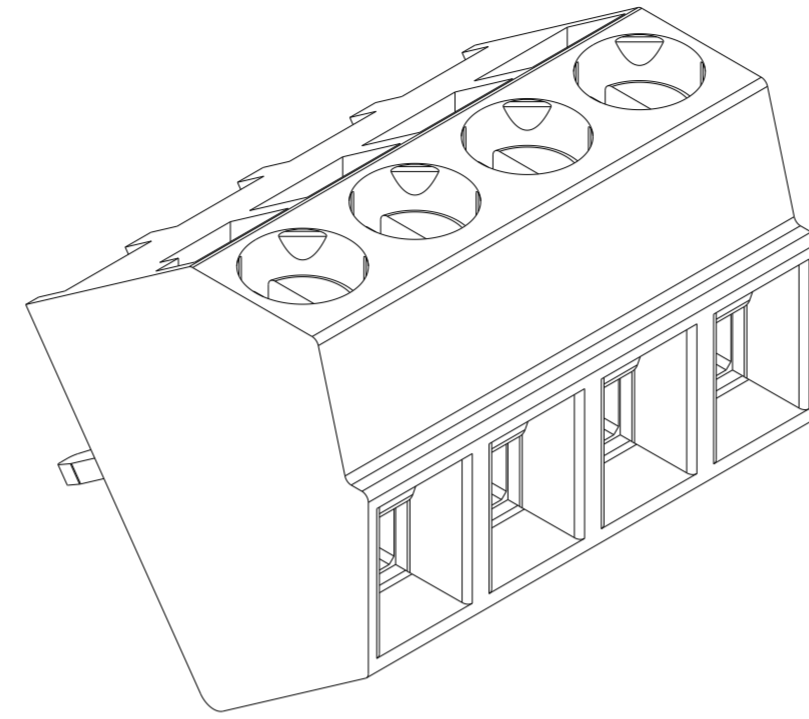

- ⚠ MATERIALS AND FINISH:  
 HOUSING: HIGH TEMPERATURE POLYAMIDE, UL 94V-0 RATED, COLOR: BLACK.  
 TERMINAL: COPPER ALLOY, TIN PLATED.  
 CLAMP: COPPER ALLOY, NICKEL PLATED.  
 CLAMPING SCREW: COPPER ALLOY, NICKEL PLATED.
- WIRE SIZE RANGE: 16-30 AWG.
  - CURRENT RATING: 12A, 300V  
OPERATING TEMPERATURE: -40°C TO +110°C
  - SUITABLE FOR 2.4mm MAX PC BOARD THICKNESS.

1776115-4 AS SHOWN

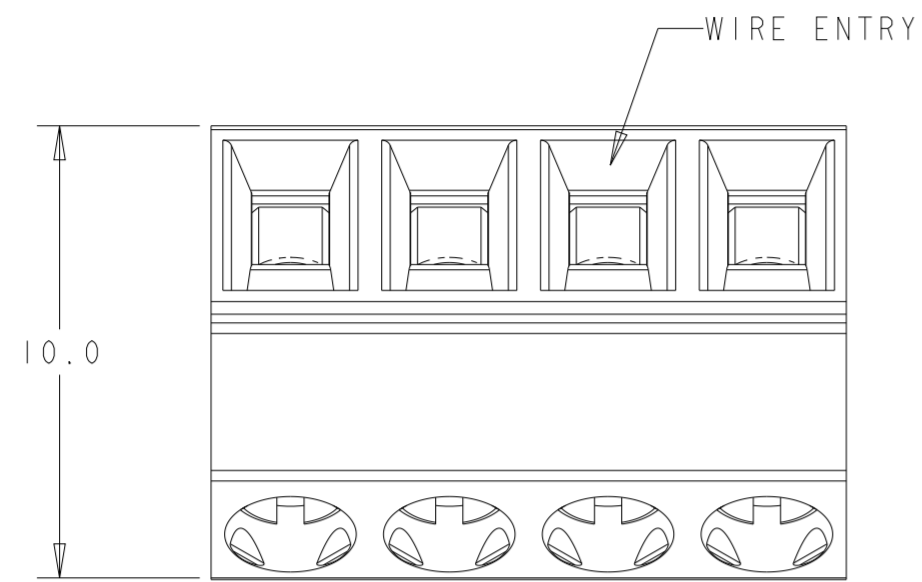
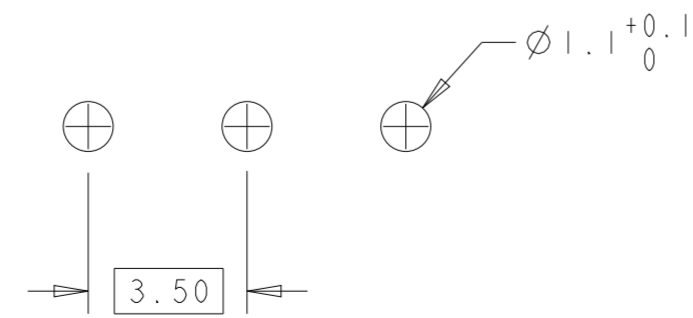
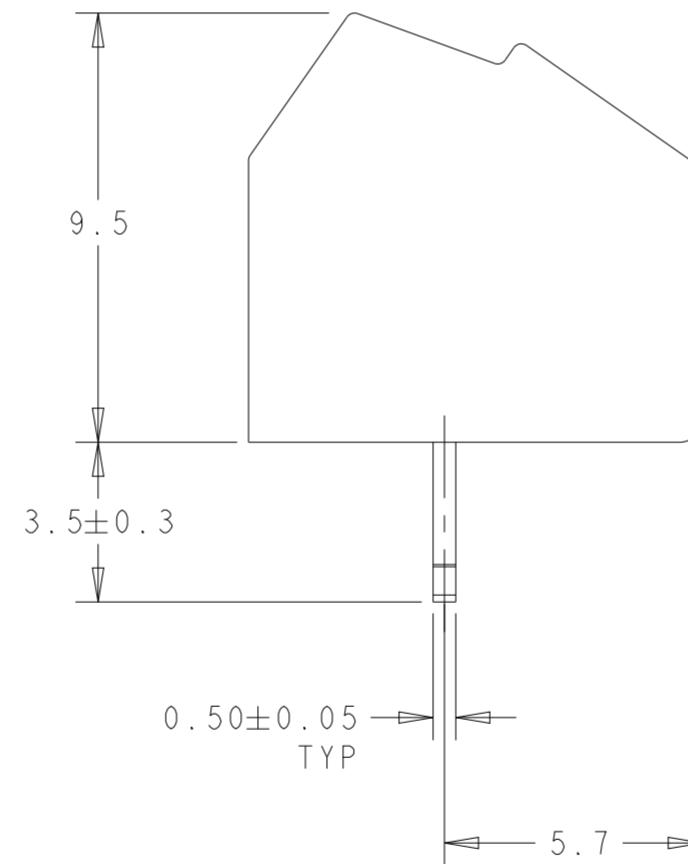
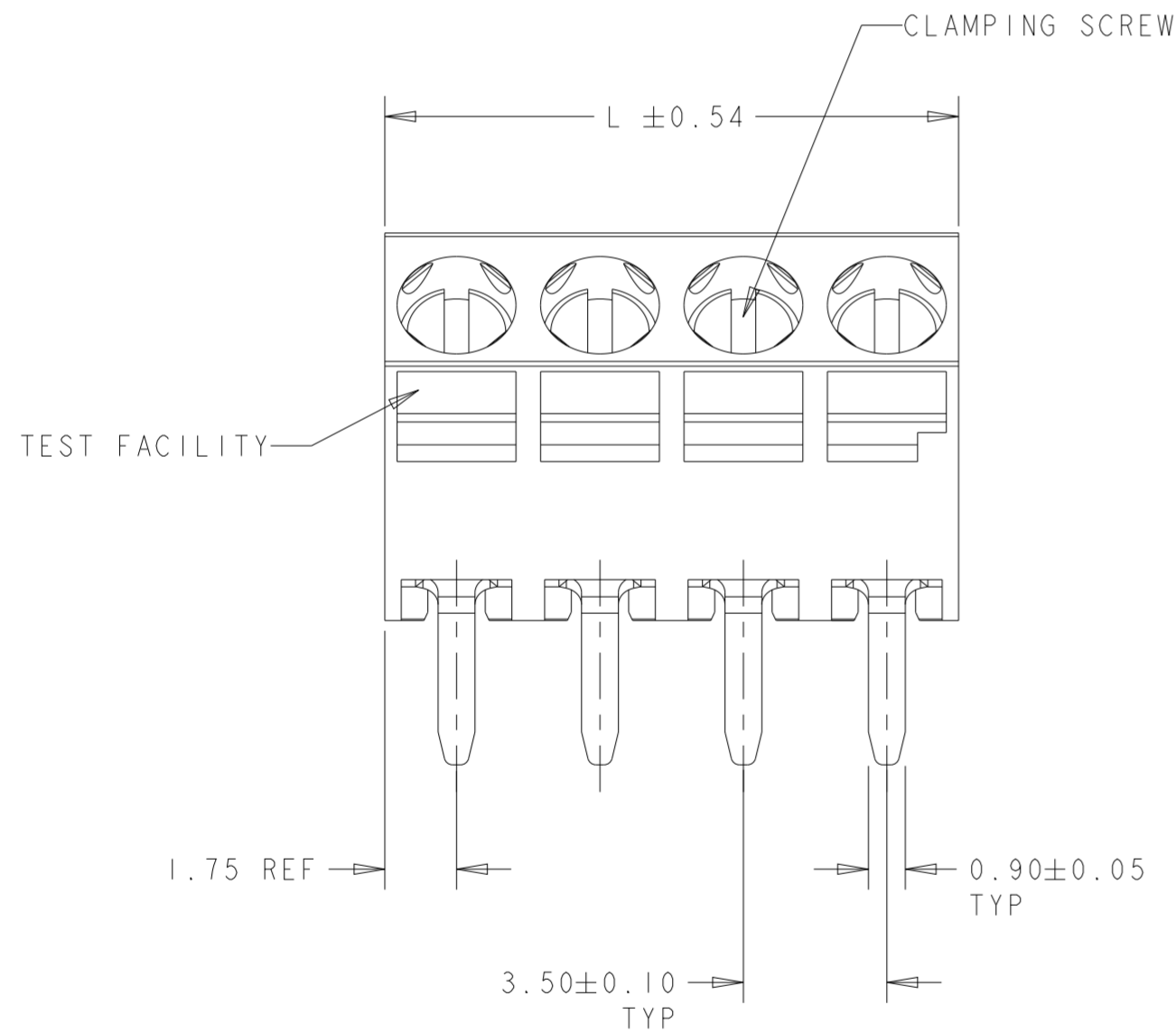

RECOMMENDED PC BOARD LAYOUT

	42.00	12	1-1776115-2
	38.50	11	1-1776115-1
	35.00	10	1-1776115-0
	31.50	9	1776115-9
OBSOLETE	28.00	8	1776115-8
	24.50	7	1776115-7
	21.00	6	1776115-6
OBSOLETE	17.50	5	1776115-5
	14.00	4	1776115-4
	10.50	3	1776115-3
	7.00	2	1776115-2
L	NO OF POSN	PART NUMBER	

THIS DRAWING IS A CONTROLLED DOCUMENT.

DWN S. WELDON 02JUN2005  
 CHK C. RICHARD 02JUN2005  
 APVD C. RICHARD 02JUN2005

**STE** TE Connectivity

DIMENSIONS: mm  
 TOLERANCES UNLESS OTHERWISE SPECIFIED:  
 0 PLC ±  
 1 PLC ±0.2  
 2 PLC ±0.25  
 3 PLC ±0.000  
 4 PLC ±0.000  
 ANGLES ±  
 FINISH

PRODUCT SPEC -  
 APPLICATION SPEC -  
 WEIGHT -

NAME: TERMINAL BLOCK, ANGLED ENTRY, 55 DEGREE, STACKABLE, 3.5mm PITCH

MATERIAL ⚠

CUSTOMER DRAWING

SIZE: A2  
 CAGE CODE: 00779  
 DRAWING NO: C-1776115  
 RESTRICTED TO: -  
 SCALE: 6:1  
 SHEET: 1 OF 1  
 REV: A