

REV.	DATE	DESCRIPTION
A	01/25/04	UPDATE DRAWING FORMAT
B	12/31/05	MODIFY PART DESCRIPTION TO "COUPLING NUT"

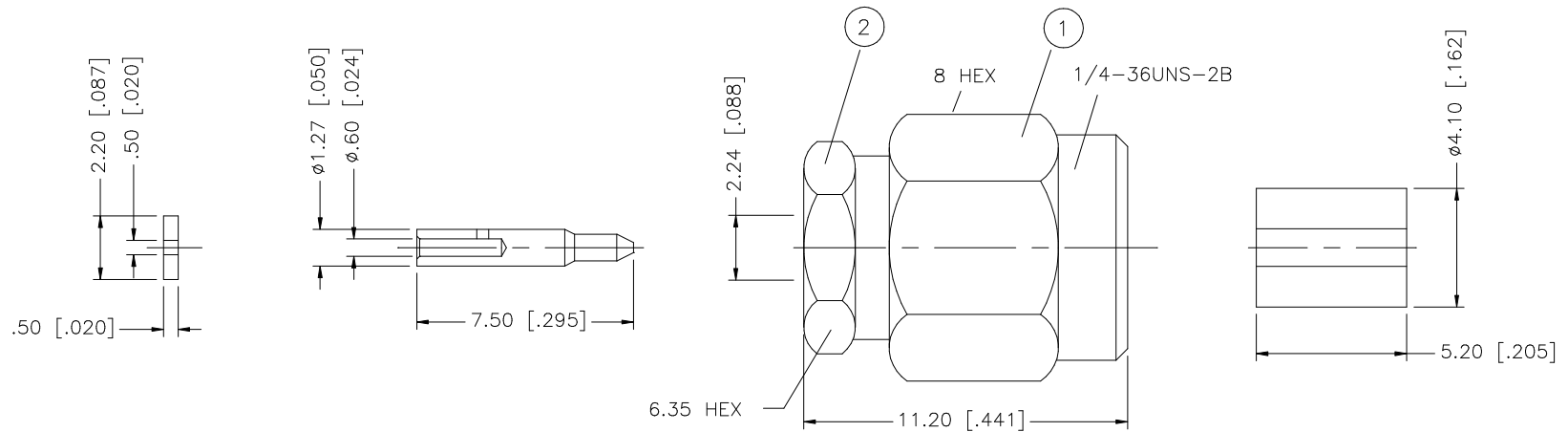
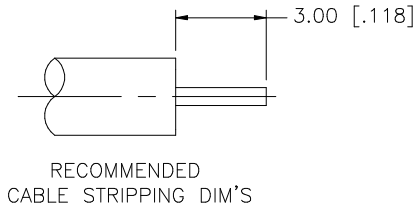

1. CONTACT PIN TO SOLDER

DESCRIPTION	MATERIAL	FINISH	QTY	DO NOT SCALE DRAWING	APPROVALS	DATE	PART DESCRIPTION							
8							<h1 style="text-align: center; color: blue;">Amphenol Connex</h1> <p style="text-align: center; font-weight: bold;">SMA DIRECT SOLDER PLUG (FOR .085", .086" CABLE)</p> <p style="text-align: center; font-weight: bold;">132188</p>							
7														
6	RETAINER RING	BER. COPPER	NATURAL	1	DRAWN	G.R.S.					12/31/05			
5	GASKET	SILICONE	RED	1	CHECKED									
4	CONTACT PIN	BRASS	GOLD	1	ISSUED									
3	INSULATOR	TEFLON	NATURAL	1	SHEET	1 OF 1								
2	BODY	BRASS	GOLD	1										
1	COUPLING NUT	STAINLESS STEEL	PASSIVATED S.S.	1										
					CAD FILE	C:/132/132188.DWG	DWG. NO.	132188.DWG	REV.	B	SIZE	A	SCALE	NA

UNLESS OTHERWISE SPECIFIED DIMENSIONS ARE IN MILLIMETERS. DIMENSIONS IN [] ARE IN INCHES AND FOR CUSTOMER REFERENCE ONLY.

UNLESS OTHERWISE SPECIFIED TOLERANCES FOR MILLIMETERS ARE:
0.5 - 8mm ± 0.20mm
8 - 30mm ± 0.40mm
30 - 120mm ± 0.50mm

UNLESS OTHERWISE SPECIFIED TOLERANCES FOR INCHES ARE:
.020 - .315 = ± 0.007"
.315 - 1.180 = ± 0.015"
1.180 - 4.724 = ± 0.020"