

THIS DRAWING CONTAINS INFORMATION PROPRIETARY TO RF INDUSTRIES.  
 ANY UNAUTHORIZED USE OF THIS DRAWING IS EXPRESSLY PROHIBITED  
 WITHOUT WRITTEN PERMISSION FROM RF INDUSTRIES.  
 ANY VIOLATION IS PUNISHABLE UNDER U.S. COPYRIGHT LAWS.

ALL DIMENSIONS ARE REFERENCE ONLY

PART NO.

**RFU-600-3**

| REV | DESCRIPTION   | DWN | DATE    | APPROVED |
|-----|---|-----|---------|----------|
| B   | ENGINEERING RELEASE                                     | KMM | 2/21/94 | C. JONES |
| C   | CHANGE FER AND FER STUD DIMS \ CHG INSERT TO NYLON      | KMM | 3/29/95 | R. RICE  |
| D   | CHANGE DIMS: DIELECTRIC, PIN, BODY \ ADDED BRASS INSERT | BMA | 1/15/97 | R. RICE  |
| E   | CHG OVERALL & STRIPPING DIM \ UPDATE FORMAT             | CZS | 9/9/01  | JDMc     |

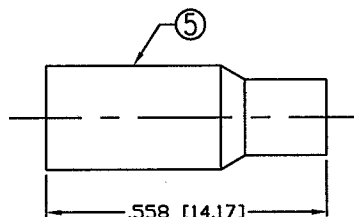
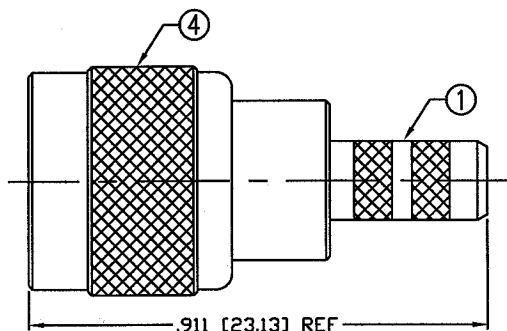

RECOMMENDED CRIMP DIE: .130 & .170

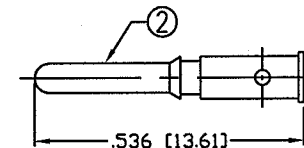

RECOMMENDED CRIMP DIE: .068

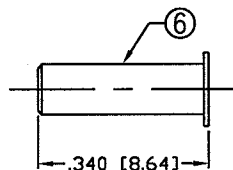

PLACE #7 (INSERT) OVER CABLE DIELECTRIC  
 BEFORE PIN IS SOLDERED/CRIMP

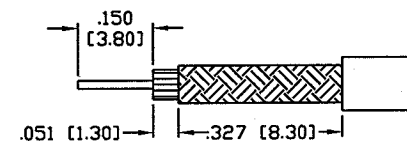

RECOMMENDED STRIPPING INSTRUCTIONS

**SPECIFICATIONS:**

IMPEDANCE: 50 Ohms  
 FREQUENCY RANGE: 0-2.5 GHz  
 VSWR: 1.25 MAX.  
 WORKING VOLTAGE: 335 V rms Max. @ Sea Level  
 INSULATION RESISTANCE: 5000 MegOhms  
 TEMPERATURE RANGE: -65°C TO 165°C  
 FOR RG-174, 188, 188A, 316/U, ALPHA 9174, 9316,  
 BELDEN 8216, 83269, 83284, 84316 & TIMES LMR-100A CABLE

|    |             |     |          |               |
|----|-------------|-----|----------|---------------|
| 1  | BODY        | 1   | BRASS    | NICKEL, 100μ" |
| 2  | PIN         | 1   | BRASS    | GOLD, 3μ"     |
| 3  | INSULATOR   | 1   | PTFE     | ---           |
| 4  | SHELL       | 1   | BRASS    | NICKEL, 100μ" |
| 5  | FERRULE     | 1   | BRASS    | NICKEL, 100μ" |
| 6  | INSERT      | 1   | BRASS    | NICKEL, 100μ" |
| 7  |             |     |          |               |
| 8  |             |     |          |               |
| 9  |             |     |          |               |
| 10 |             |     |          |               |
| 11 |             |     |          |               |
| 12 |             |     |          |               |
| 13 |             |     |          |               |
| 14 |             |     |          |               |
| #  | DESCRIPTION | QTY | MATERIAL | FINISH        |

|           |         |
|-----------|---------|
| 000486    |         |
| DRAWN     | 7/9/01  |
| C. ZUNIGA |         |
| CHECKED   | 7-9-01  |
| ORJ DRAWN |         |
| C. ZUNIGA | 4/22/91 |
| APPROVALS | DATE    |

UNLESS OTHERWISE SPECIFIED:  
 1. REMOVE ALL BURRS  
 2. BREAK ALL CORNERS & EDGES .005 R. MAX.  
 3. CHAMFER 1ST & LAST THREADS 45°  
 4. SURFACE ROUGHNESS 63 FINISH MIL-STD-10  
 5. DIAMETERS ON COMMON CENTERS TO BE CONCENTRIC WITHIN .002 T.I.R.  
 6. ALL DIMENSIONS ARE AFTER PLATING.

DIMENSIONS ARE IN INCHES AND [MILLIMETERS]  
 UNLESS OTHERWISE NOTED TOLERANCES ARE:

| DECIMALS        | DIAMETER        |
|-----------------|-----------------|
| .xxx±.003 [.08] | .xxx±.001 [.03] |
| .xx±.005 [.13]  | .xx±.003 [.08]  |

**RF connectors**  
 DIVISION OF RF INDUSTRIES, LTD.

7610 MIRAMAR RD  
 SAN DIEGO, CA 92126  
 (858) 549-6340  
 (858) 549-6345 FAX

**MINI UHF PLUG CRIMP**

|            |             |                  |              |
|------------|-------------|------------------|--------------|
| SIZE       | CABLE GROUP | DWG NO.          | REV          |
| A          | B           | RFU-600-3        | E            |
| SCALE: NTS |             | CAD FILE OUTLINE | SHEET 1 OF 1 |