

NOTES:

1. MATERIAL: 0.008" TIN PLATED STEEL PER ASTM A623/A624
2. PARTS PER REEL: 200

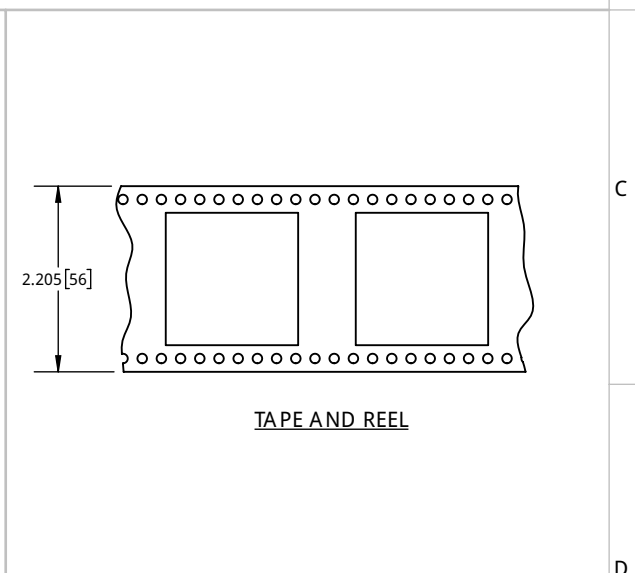
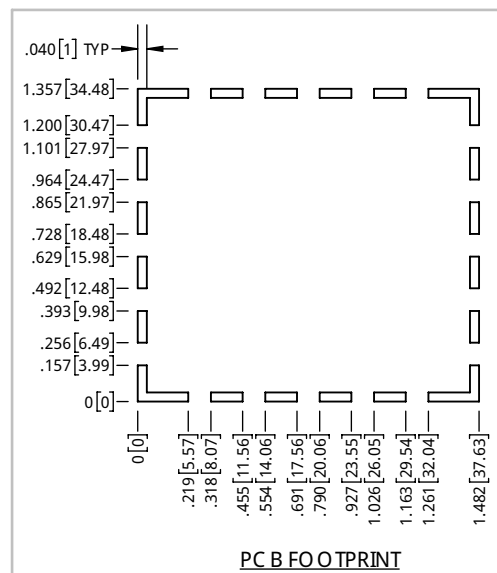
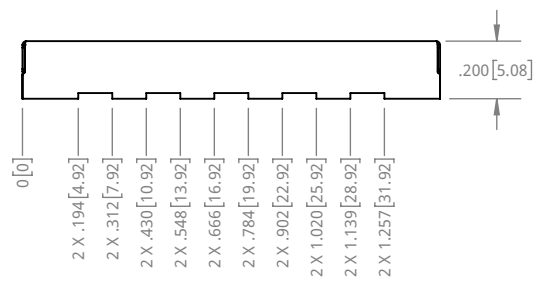
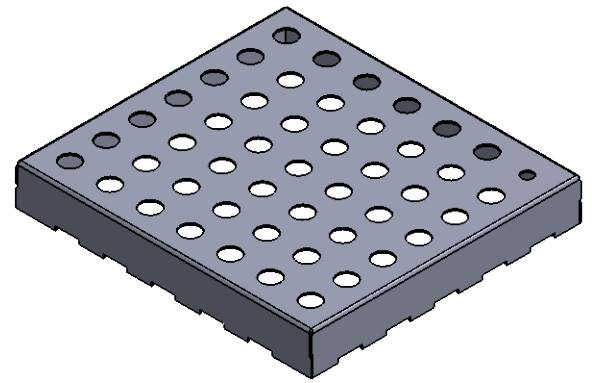
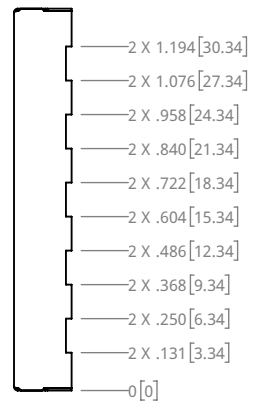
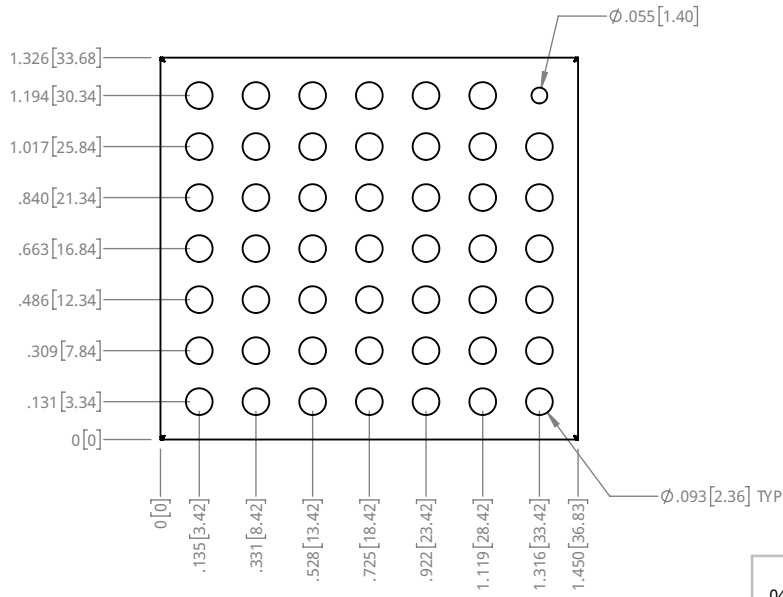

PROPRIETARY NOTICE: THESE DRAWINGS, LISTS OR SPECIFICATIONS ARE THE CONFIDENTIAL INFORMATION AND/OR TRADE SECRETS OF 3G SHIELDING SPECIALTIES, P., AND ISSUED IN STRICT CONFIDENCE. NO PARTS OR INFORMATION HEREIN ARE TO BE REPRODUCED, COPIED, TRANSMITTED, OR OTHERWISE DISCLOSED TO ANY OTHER PARTY WITHOUT THE WRITTEN PERMISSION OF 3G SHIELDING SPECIALTIES, P. FOR ANY OTHER PURPOSE OTHER THAN EVALUATION.

UNLESS OTHERWISE SPECIFIED
U/M TOLERANCE ± 0.005
INCHES

ROHS COMPLIANCE
2011/65/EU

DATE 16-01-26



PART NUMBER PIC-S-106	REV. 0
DESCRIPTION SHIELD CAN	
SCALE 1.5:1	SHEET 1 OF 1