

THIS DRAWING IS UNPUBLISHED. RELEASED FOR PUBLICATION . 19
 © COPYRIGHT 19 BY AMP INCORPORATED, HARRISBURG, PA. ALL INTERNATIONAL RIGHTS RESERVED. AMP PRODUCTS MAY BE COVERED BY U.S. AND FOREIGN PATENTS AND/OR PATENTS PENDING.

REVISIONS						
P	F	ZONE	LTR	DESCRIPTION	DATE	APPROVED
0			0	RELEASED	7-6-87	SD <i>[Signature]</i>

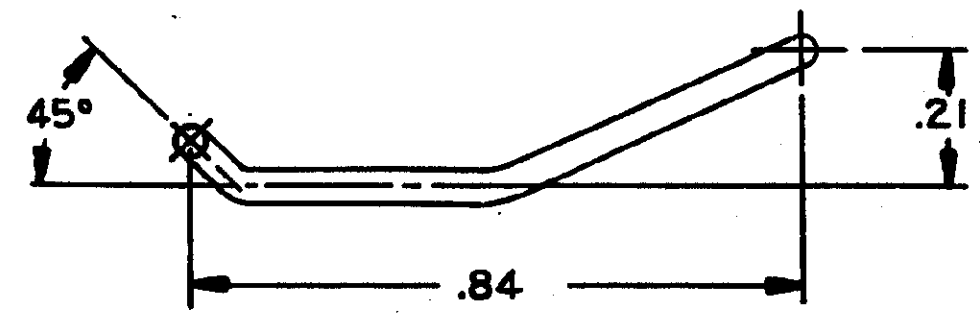

- 1. ALL DIMENSIONS SHOWN ARE REFERENCE UNLESS OTHERWISE SPECIFIED.
- 2. MATERIAL: PASSIVATED STAINLESS STEEL.

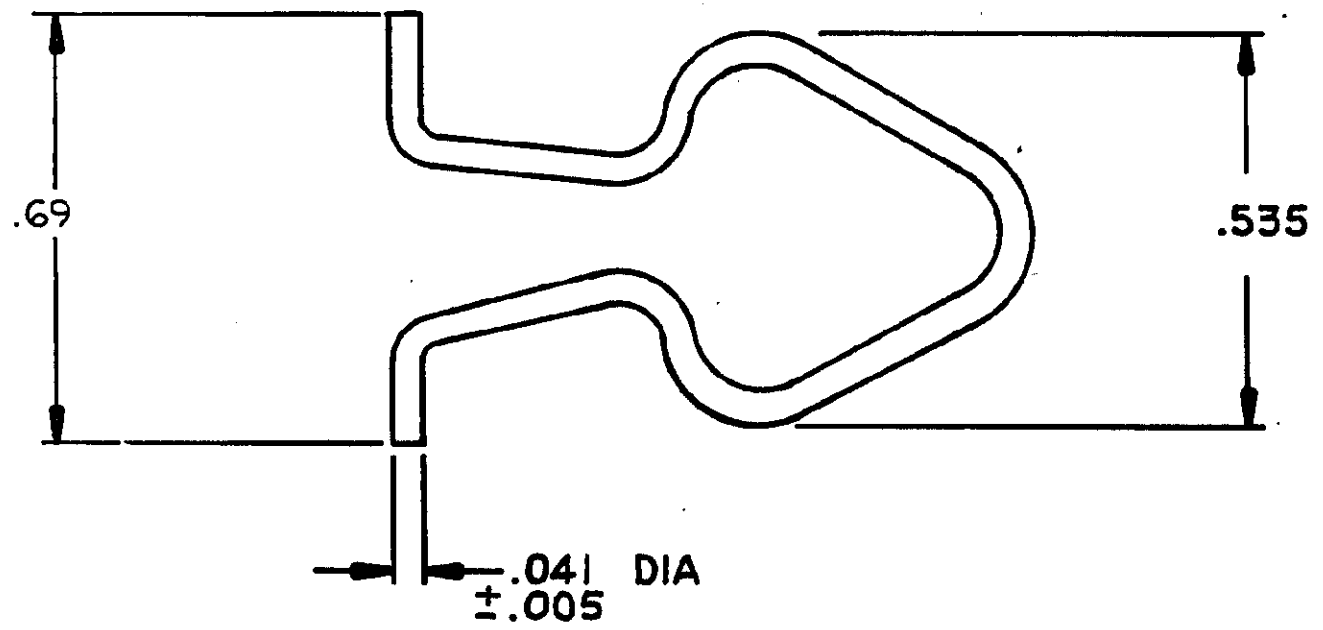

55380 /-1
PART NO

UNLESS OTHERWISE SPECIFIED DIMENSIONS ARE IN INCHES. TOLERANCES ON: DECIMALS ± ANGLES ±	CONTRACT NO	AMP AMP INCORPORATED Harrisburg, Pa.	
	DR <i>Stephen Dow</i> 7-6-87		
MATERIAL	CHK <i>R. Fox</i> 7-6-87	NAME	
	APPD <i>[Signature]</i> 7-7-87	CLIP, BAIL, OFF-SET	
FINISH	APPD <i>[Signature]</i> 7-7-87	SIZE	FSCM NO
	OTHER APPD	B	00779
		DRAWING NO	
		SCALE 4:1	DRAWING NO 553807
		SHEET 1 OF 1	

CUSTOMER DRAWING