

THIS DRAWING IS UNPUBLISHED. RELEASED FOR PUBLICATION
 © COPYRIGHT - TE Connectivity ALL RIGHTS RESERVED.

REVISIONS					
P	LR	DESCRIPTION	DATE	OWN	APP
F1		REV. ECO 17-011267	11SEP2017	HC	KR

- MUST BE ASSEMBLED WITH CAP REAR P/N 770046-1 BEFORE MATING. KIT P/N IS 770024-1.
- RECOMMENDED PANEL THICKNESS 0.76-2.29 [.030-.090].
- PANEL MUST BE PUNCHED SO THAT THE HOUSING ENTERS THE PANEL IN THE SAME DIRECTION AS THE PUNCH.
- OPTIONAL FOR KEYING HOUSING IN PANEL.
- CIRCUIT NUMBER 1 LOCATION.
- AMP LOGO LOCATED ONCE ON ANY INDICATED SURFACE FARSIDE.
- DIMENSION INDICATED IS AS MOLDED. ADDITIONAL GROWTH DUE TO SUBSEQUENT MOISTURE ABSORPTION MAY OCCUR.
- CSA LOGO LOCATED ONCE ON ANY INDICATED SURFACE

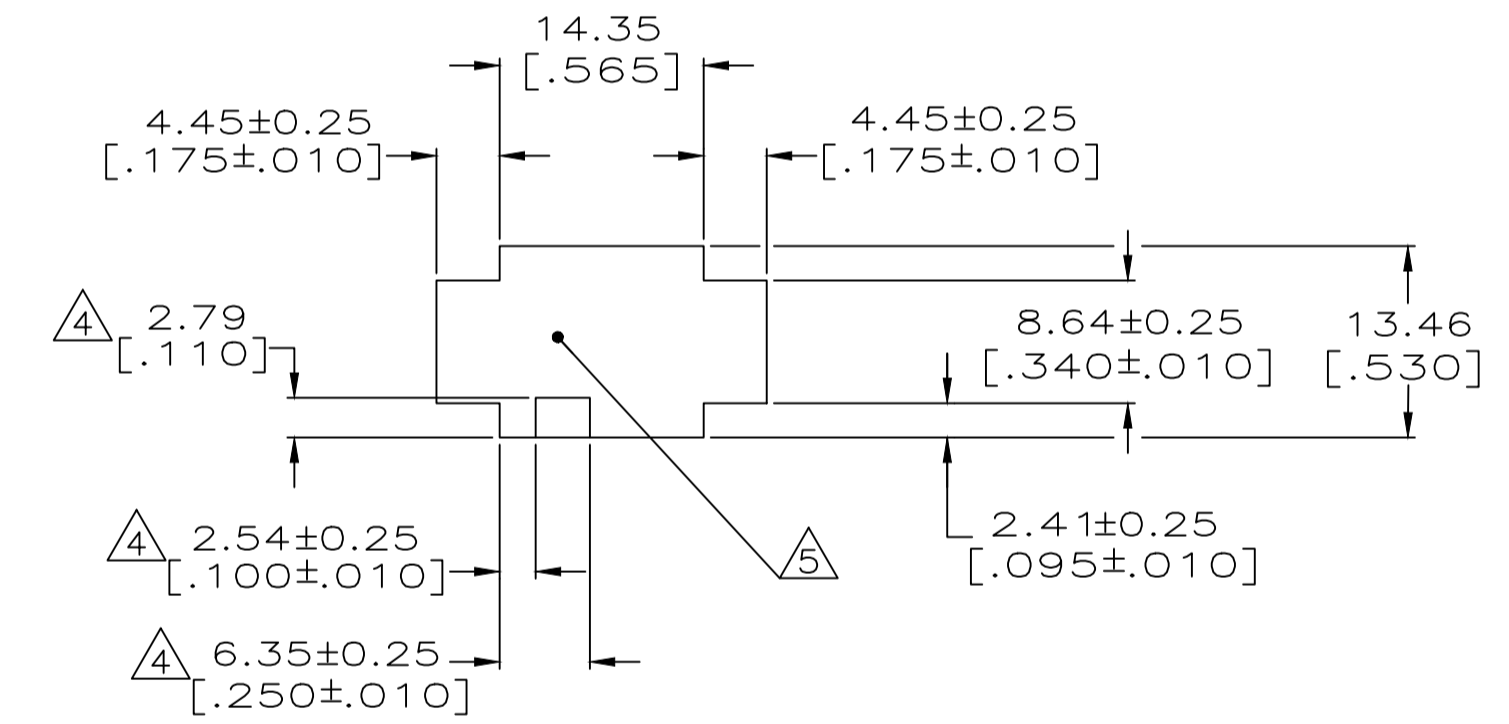
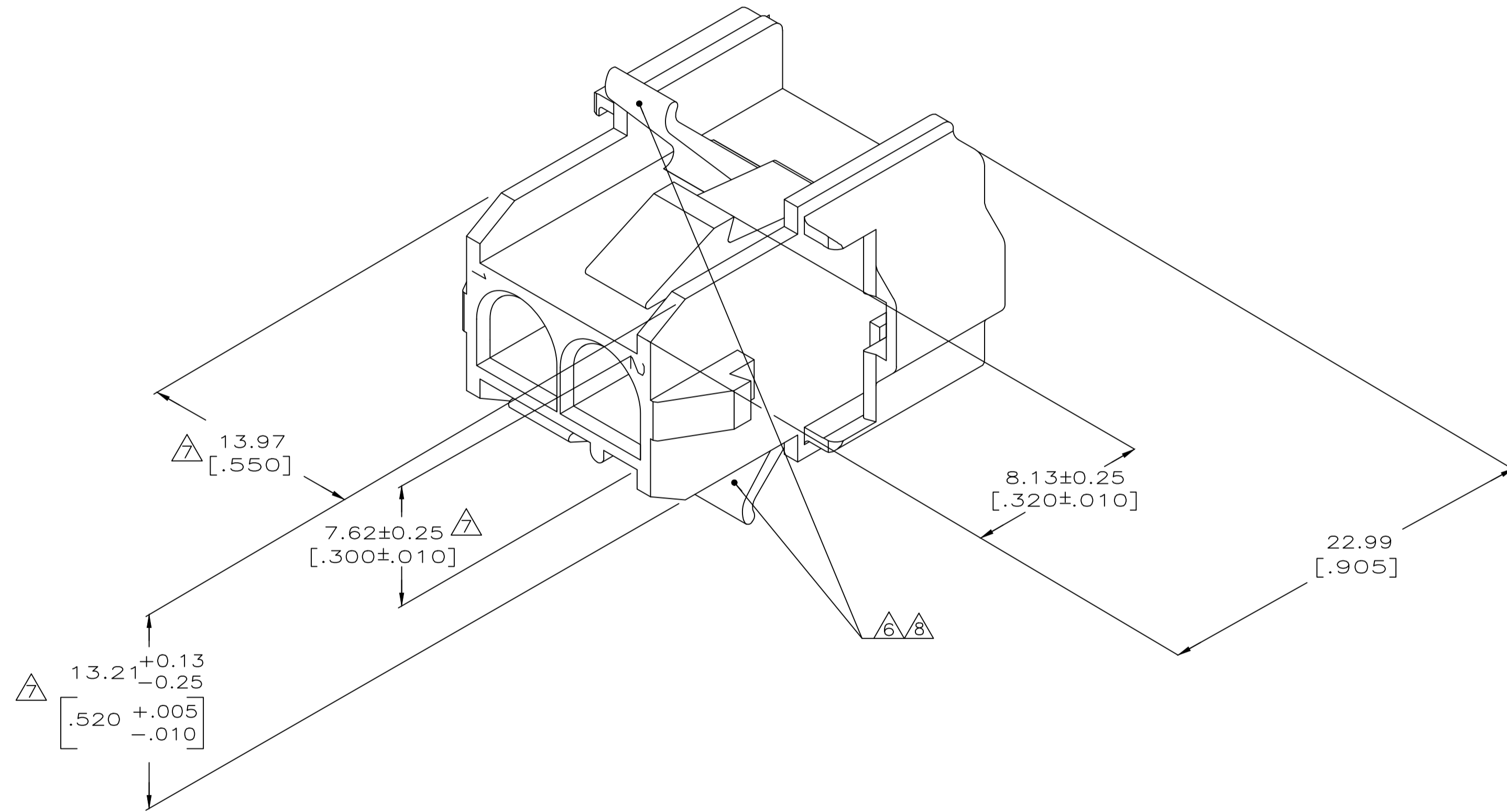

RECOMMENDED PANEL CUTOUT
 (HOUSING ENTRY SIDE)
 SCALE 2:1

770045-1
 PART NUMBER

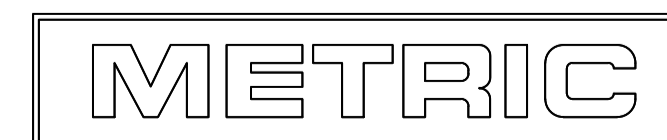

THIS DRAWING IS A CONTROLLED DOCUMENT.		DWN K. SALMON 1-15-92	770045-1	
DIMENSIONS: INCHES		CHK R. SWING 1-15-92	TE Connectivity	
TOLERANCES UNLESS OTHERWISE SPECIFIED:		APPD M. TRULL 1-16-92	CAP FRONT, 2 CIRCUIT, UNIVERSAL MATE-N-LOK™ II	
0 PLC ± -	1 PLC ± -	NAME	RESTRICTED TO	
2 PLC ± -	3 PLC ± 0.13 [.005]	SIZE	A1 00779 C=770045	
4 PLC ± -	ANGLES ± -	DRAWING NO	SCALE 5:1 SHEET 1 OF 1 REV F1	
MATERIAL NYLON,UL94V-0,	FINISH -	WEIGHT 1	CUSTOMER DRAWING	