

*Ø0.65 AT CONTACT PCB TERMINATION LOCATION

DIMENSIONS(mm)			
SIZE	A	B	C
15	39.50	25.00	16.30
26	48.00	33.30	24.60
44	61.50	47.05	38.40
62	77.80	63.50	54.80

NOTE:

MATERIAL

- HOUSING PBT UL94V-0, BLACK
- FLANGE PBT UL94V-0, BLACK
- CONTACT BRASS, PLATING P/N KEY BELOW
- SHELL STEEL, NICKEL
- O-RING SILICONE
- SEALING COMPOUND EPOXY
- HARDWARE BRASS; NICKEL PLATED

HARDWARE OPTIONS

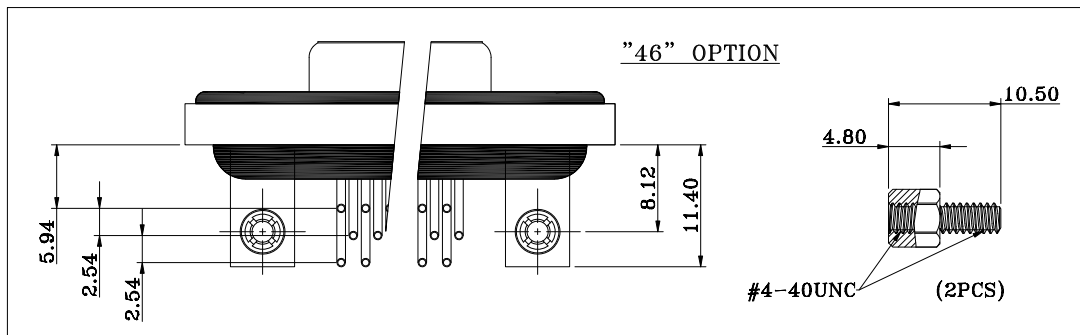
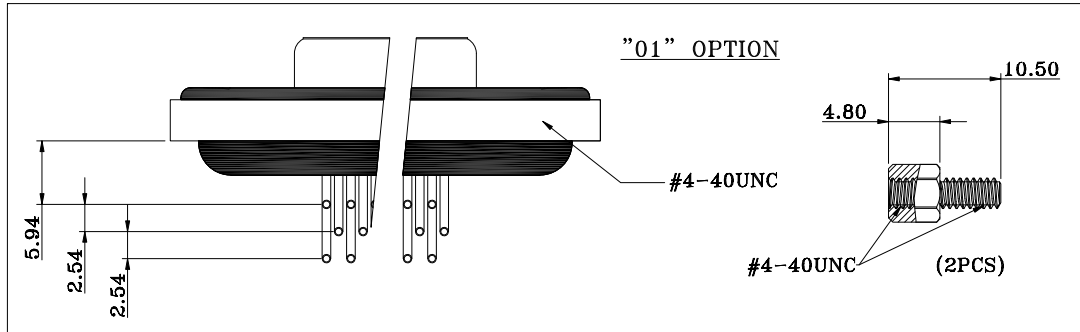

ELECTRICAL

- RATED CURRENT 3A
- VOLTAGE 1000 VAC 1 MIN
- INSULATOR RESISTANCE 5 Gohms MIN.
- CONTACT RESISTANCE 10 mOhms MAX.
- WATER PROOF IP67
- ENVIRONMENT OPERATION TEMPERATURE -25°C TO +85°C

HDF-RYY-213LYYY

SERIES

HDF = HD DSUB FLANGE

CONTACT TYPE

R = RIGHT ANGLE PCB MOUNT

POSITIONS

- 15
- 26
- 44
- 62

GENDER

2 = FEMALE

HARDWARE OPTIONS

- 01 = 4-40 THREADED INSERTS/4-40 JACKSCREWS
- 46 = 4-40 THREADED BRACKETS & BOARD LOCKS/4-40 JACKSCREWS

CONTACT PLATING OPTIONS

- 1 = GOLD FLASH
- 2 = 30u" GOLD PLATING

RoHS COMPLIANT



THESE DRAWINGS AND SPECIFICATIONS ARE THE PROPERTY OF NorComp AND SHALL NOT BE REPRODUCED, COPIED OR USED AS THE BASIS FOR THE MANUFACTURE OR SALE OF APPARATUS WITHOUT WRITTEN PERMISSION.

DRAWN:

J. KADEL

DATE:

03/02/2020

TOLERANCES

- X. ±0.40
- .X ±0.30
- .XX ±0.20
- .XXX ±0.10

UNITS = mm

DO NOT SCALE FROM DRAWING

NorComp

SCALE:

NTS

SHEET

OF 1 2

REV

1

DWG NO.

HDF-RYY-213LYYY

****ø3.20MM HOLES NOT NEEDED FOR "01" HARDWARE OPTION**

15 POSITION

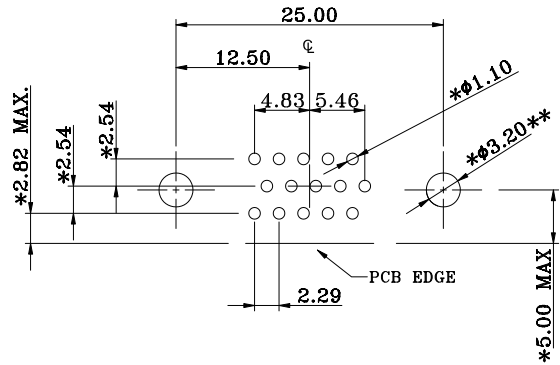

26 POSITION

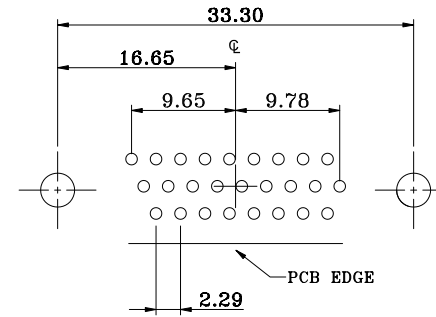

44 POSITION

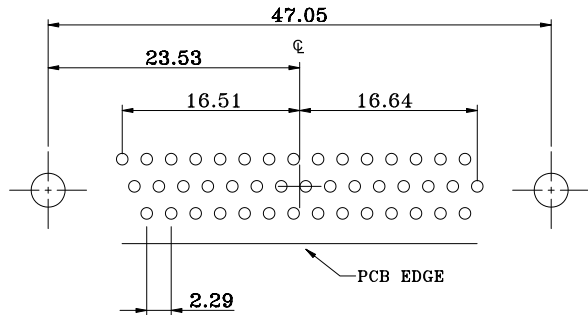

62 POSITION

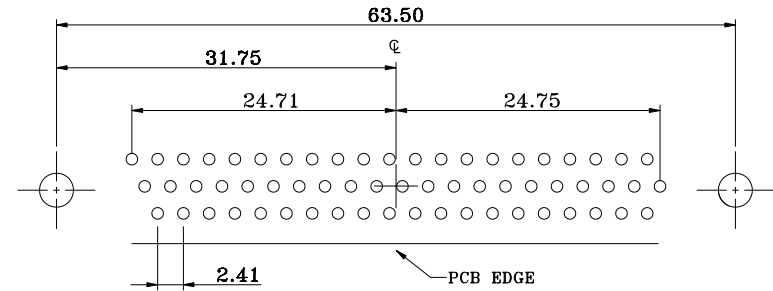

RECOMMENDED PCB LAYOUT

*TYPICAL // HOLE SIZE MAY NOT BE SUITABLE FOR YOUR SPECIFIC APPLICATION

RoHS COMPLIANT



THESE DRAWINGS AND SPECIFICATIONS ARE THE PROPERTY OF NorComp AND SHALL NOT BE REPRODUCED, COPIED OR USED AS THE BASIS FOR THE MANUFACTURE OR SALE OF APPARATUS WITHOUT WRITTEN PERMISSION.

DRAWN:

J. KADEL

DATE:

03/02/2020

TOLERANCES

X. ±0.40
 .X ±0.30
 .XX ±0.20
 .XXX ±0.10

UNITS = mm

DO NOT SCALE FROM DRAWING

NorComp

SCALE: NTS

SHEET 2 OF 2

REV 1

DWG NO.

HDF-RYY-213LYYY