

REVISIONS			
REV	DESCRIPTION, ECN, EAR NO.	DATE	APP'D
A	PROPOSAL	SEP09/19	L.CHAN

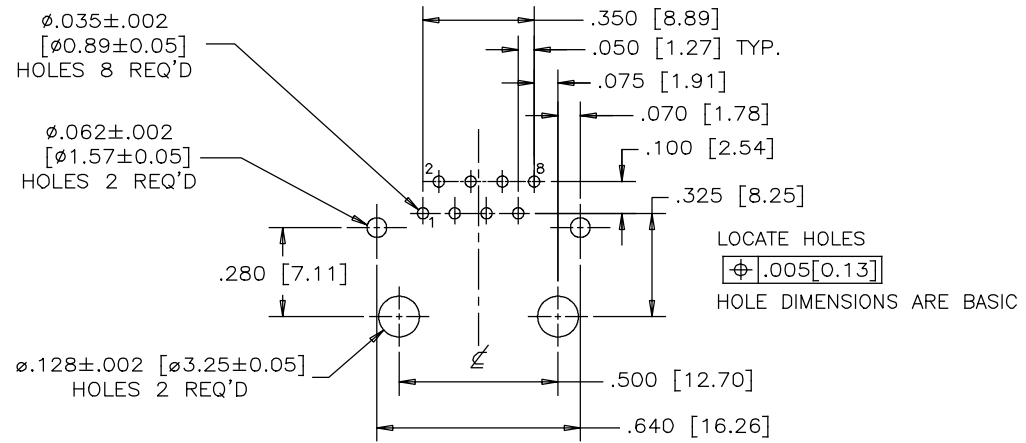
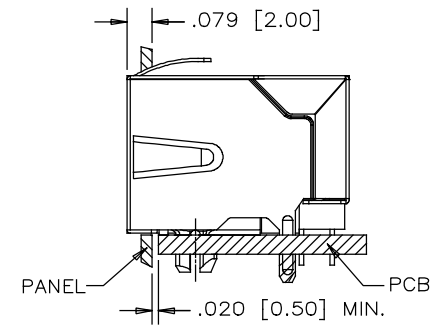
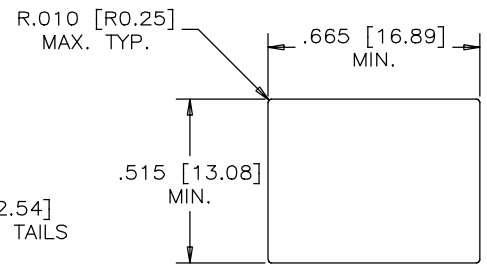
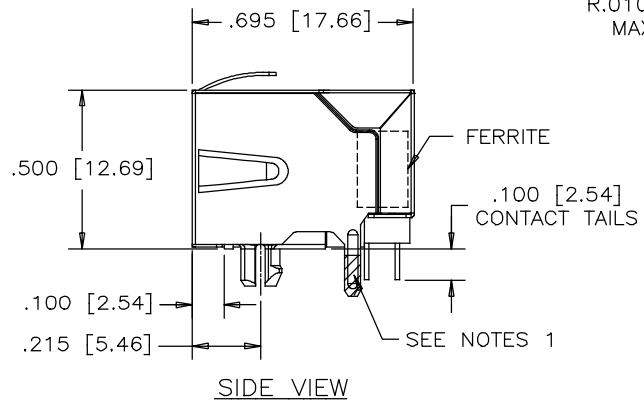
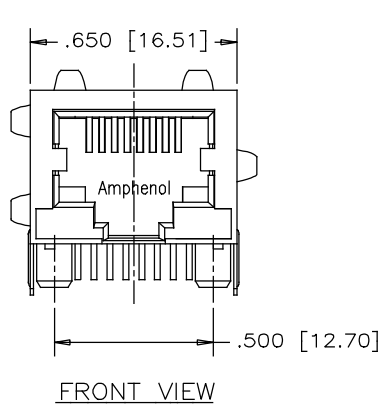

**NOTES:**

**1. MATERIALS:**

- CONTACTS:** PHOSPHOR BRONZE,  
PLATING: SELECTIVE GOLD PLATING ON MATING SURFACES. SEE PART NO. FOR THICKNESS.  
50 MICRO" MIN. NICKEL OVERALL.  
100 MICRO" MIN. MATTE TIN OR GOLD FLASH ON TAILS.
- HOUSING:** ENGINEERING THERMOPLASTIC  
COLOR - BLACK.  
FLAMMABILITY RATING UL 94V-0
- SHIELD:** COPPER ALLOY  
PLATING: NIVKEL WITH TIN FINISHED ON PCB TAILS.

**2. RECOMMENDED SOLDERING TEMPERATURE**

WAVE SOLDERING PEAKED AT 260°C MAX. FOR 5 SECONDS MAX.

AMPHENOL PART NO.: RJSBE-X280-C1

- GOLD PLATING OPTION:  
D = 6u" GOLD PLATING  
G = 15u" GOLD PLATING  
J = 30u" GOLD PLATING  
5 = 50u" GOLD PLATING



UNLESS SPECIFIED OTHERWISE	DRAWN	RONNIE.C	SEP09/19
PRIMARY UNITS INCHES	CHECKED	KELVIN.T	SEP09/19
SECONDARY MILLIMETERS	M.E. APP'D		
REFERENCE IN PARENTHESES	Q.A. APP'D		
GENERAL TOLERANCES	DWG APP'D		
1 DECIMAL PLACE	ENG. REL. NO.		
2 DECIMAL PLACES	REF.		
3 DECIMAL PLACES ±.015	THIRD ANGLE PROJECTION		
ANGULAR DEGREES ±1.5°	DO NOT SCALE DRAWING		

Amphenol Canada Corp. Commercial Products	
SINGLE PORT MODULAR JACK, 8 POSITION, 8 CONTACTS, WITHOUT LED, WITH FRRITE, SHIELDED WITH TOP AND SIDE TABS, - RoHS COMPLIANT	
DWG NO. P-RJSBE-X280-C1	REV A
CODE ID NO. 03554	DWG SIZE X SCALE N/A SHEET 1 OF 1